

Kin Shing Building



Yuen Long Mansion

Chung Sing Path

Existing Yuen Long Nullah

View REC6 – Existing Condition

Yuen Long Mansion

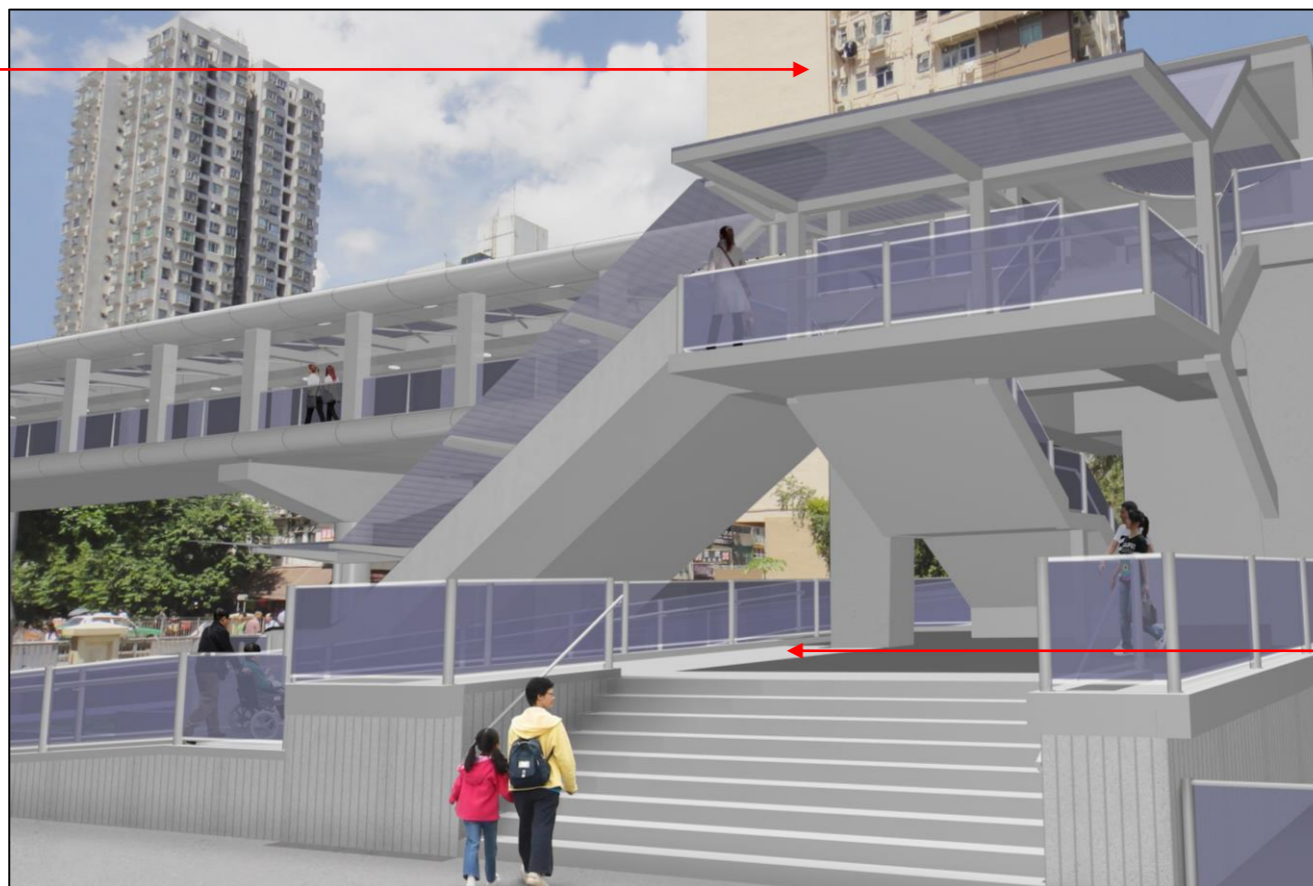

Proposed Interchange

View REC6 – Without Mitigation Measures

Rev	Description	By	Date
A	FIRST ISSUE	EN	03/15

Consultant  
**ARUP**

Contract No. and Title  
 Agreement No. CE 32/2014 (HY)  
 Elevated Pedestrian Corridor in  
 Yuen Long Town connecting with  
 Long Ping Station  
 – Investigation, Design and Construction

Drawing title  
 VIEWPOINT NO. 8 PHOTOMONTAGE  
 FROM REC6 EXISTING AND  
 WITHOUT MITIGATION MEASURES  
 Existing and Without Mitigation  
 Measures (Sheet 1 of 2)

Drawing no.		Rev.	
10.1716			
Drawn	Date	Checked	Approved
RY	01/15	KYL	EC
Scale		Status	
N.T.S.		PRELIMINARY	

COPYRIGHT RESERVED