

PRINTED BY: chreul8306 5/30/2015 2:37:49 PM
 FILENAME: F:\CHINA\Drainage_CADD\Project\54572\FIGURE\EIA-TAI O\tai o EIA (Built_Heritage)\4572-EIA-TO-10-10.dgn

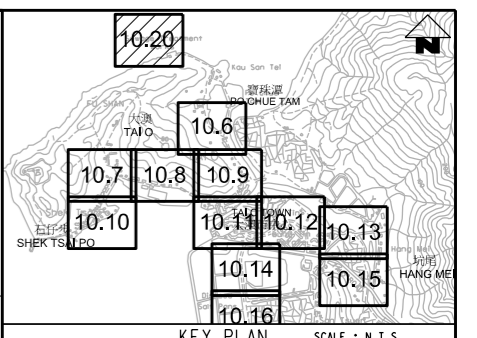

- NOTES :
1. Exact location of manholes to be determined on site by the Engineer.
 2. Tapping pipes and timber box for the proposed manhole for future house connection are not shown for clarity. Exact location of tapping pipes and timber boxes shall be determined on site by the Engineer.
 3. Details of existing sewers / drains shown are for information only and shall be confirmed on site by the contractor when necessary for the execution of works.

- LEGEND AND ABBREVIATION:
- Existing Manhole
 - Existing Sewer
 - RM — Existing Rising Main
 - Proposed Sewer
 - Proposed Manhole
 - RM — Proposed Rising Main
 - Proposed Tapping Pipe (subject to consultation with owners of houses with topographical problem)
 - PS □ Proposed Sewage Pumping Station
 - Location of Built Heritage Resources
 - Estimated Edge of Still House

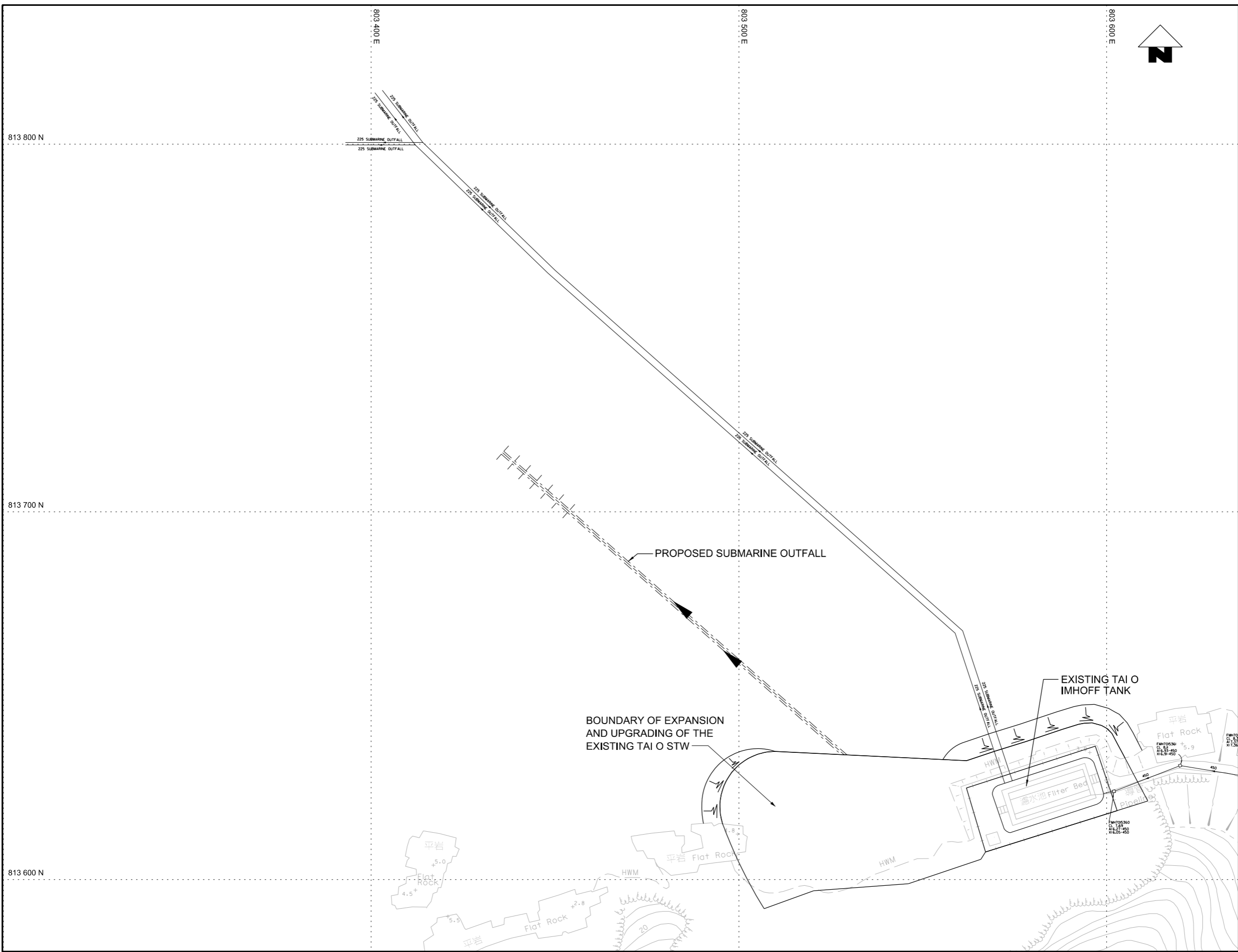
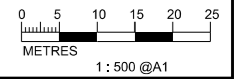

Agreement No. CE 15/2010 (DS)
 Upgrading of Cheung Chau and Tai O Sewage Collection, Treatment and Disposal Facilities - Design and Construction
 Outlying Islands Sewage Stage 2 -
 Upgrading of Tai O Sewage Collection, Treatment and Disposal Facilities

Title :	Location of Built Heritage Resources (Sheet 15 of 15)		
Date :	MAY 2015	Figure :	10.20