

KEY PLAN SCALE : N.T.S.

- NOTES :
1. Exact location of manholes to be determined on site by the Engineer.
  2. Tapping pipes and timber box for the proposed manhole for future house connection are not shown for clarity. Exact location of tapping pipes and timber boxes shall be determined on site by the Engineer.
  3. Details of existing sewers / drains shown are for information only and shall be confirmed on site by the contractor when necessary for the execution of works.

- LEGEND AND ABBREVIATION:
- Existing Manhole
  - Existing Sewer
  - Existing Rising Main
  - Proposed Sewer
  - Proposed Manhole
  - Proposed Rising Main
  - Proposed Tapping Pipe (subject to consultation with owners of houses with topographical problem)
  - Proposed Sewage Pumping Station
  - Location of Built Heritage Resources
  - Estimated Edge of Still House

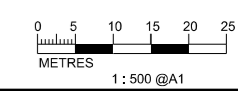

PRINTED BY: chow2843 19/11/2015 16:12:45  
 FILENAME: C:\Users\chow2843\Desktop\14572-ElA-T0-10\_6.dgn



Agreement No. CE 15/2010 (DS)  
 Upgrading of Cheung Chau and Tai O Sewerage Collection, Treatment and Disposal Facilities - Design and Construction  
**Outlying Islands Sewerage Stage 2 -**  
 Upgrading of Tai O Sewerage Collection, Treatment and Disposal Facilities

Title :	Location of Built Heritage Resources (Sheet 1 of 14)		
Date :	MAY 2015	Figure :	9.4

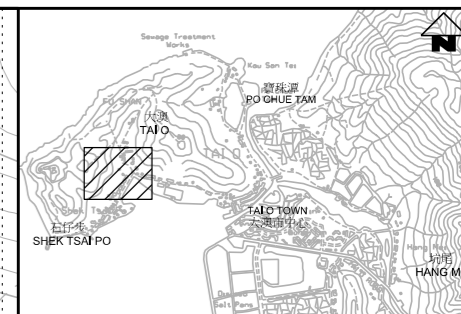
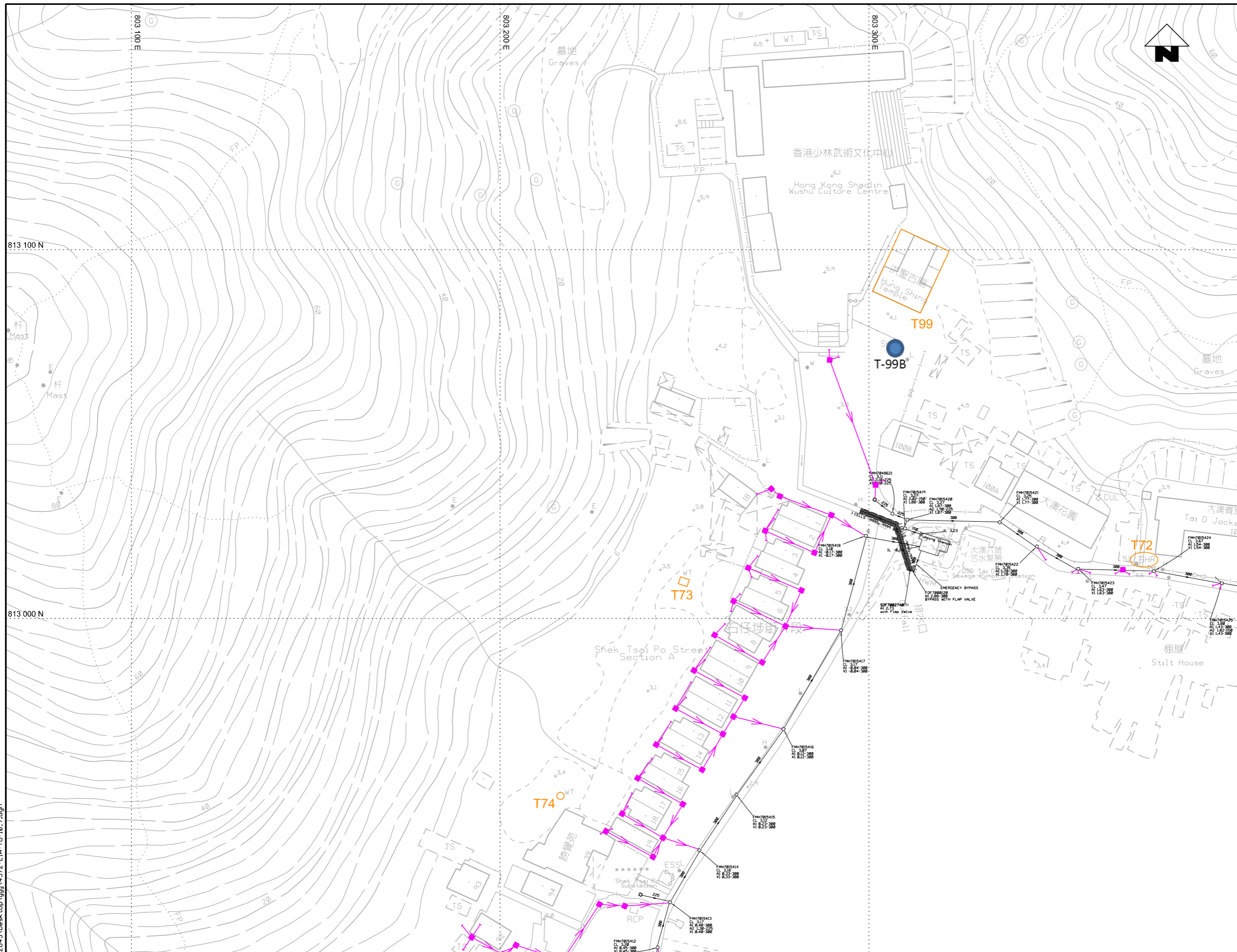

KEY PLAN SCALE : N.T.S.

- NOTES :
1. Exact location of manholes to be determined on site by the Engineer.
  2. Tapping pipes and timber box for the proposed manhole for future house connection are not shown for clarity. Exact location of tapping pipes and timber boxes shall be determined on site by the Engineer.
  3. Details of existing sewers / drains shown are for information only and shall be confirmed on site by the contractor when necessary for the execution of site works.

- LEGEND AND ABBREVIATION:
- Existing Manhole
  - Existing Sewer
  - Existing Rising Main
  - Proposed Sewer
  - Proposed Manhole
  - Proposed Rising Main
  - Proposed Tapping Pipe (subject to consultation with owners of houses with topographical problem)
  - Proposed Sewage Pumping Station
  - Location of Built Heritage Resources
  - Estimated Edge of Stilt House

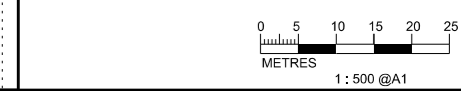

PRINTED BY: chow2843 19/11/2015 16:15:57 FILENAME: C:\Users\chow2843\Desktop\151572-ER-10-10\_7.dgn



Agreement No. CE 15/2010 (DS)  
 Upgrading of Cheung Chau and Tai O Sewerage Collection, Treatment and Disposal Facilities - Design and Construction  
 Outlying Islands Sewerage Stage 2 -  
 Upgrading of Tai O Sewerage Collection, Treatment and Disposal Facilities

Title :	Location of Built Heritage Resources (Sheet 2 of 14)		
Date :	MAY 2015	Figure :	9.5

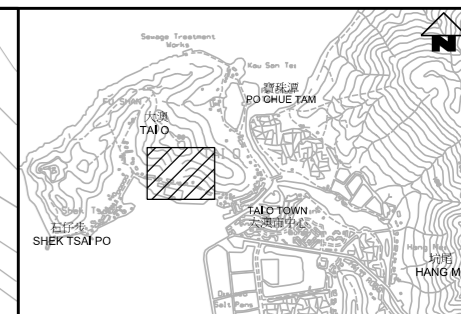
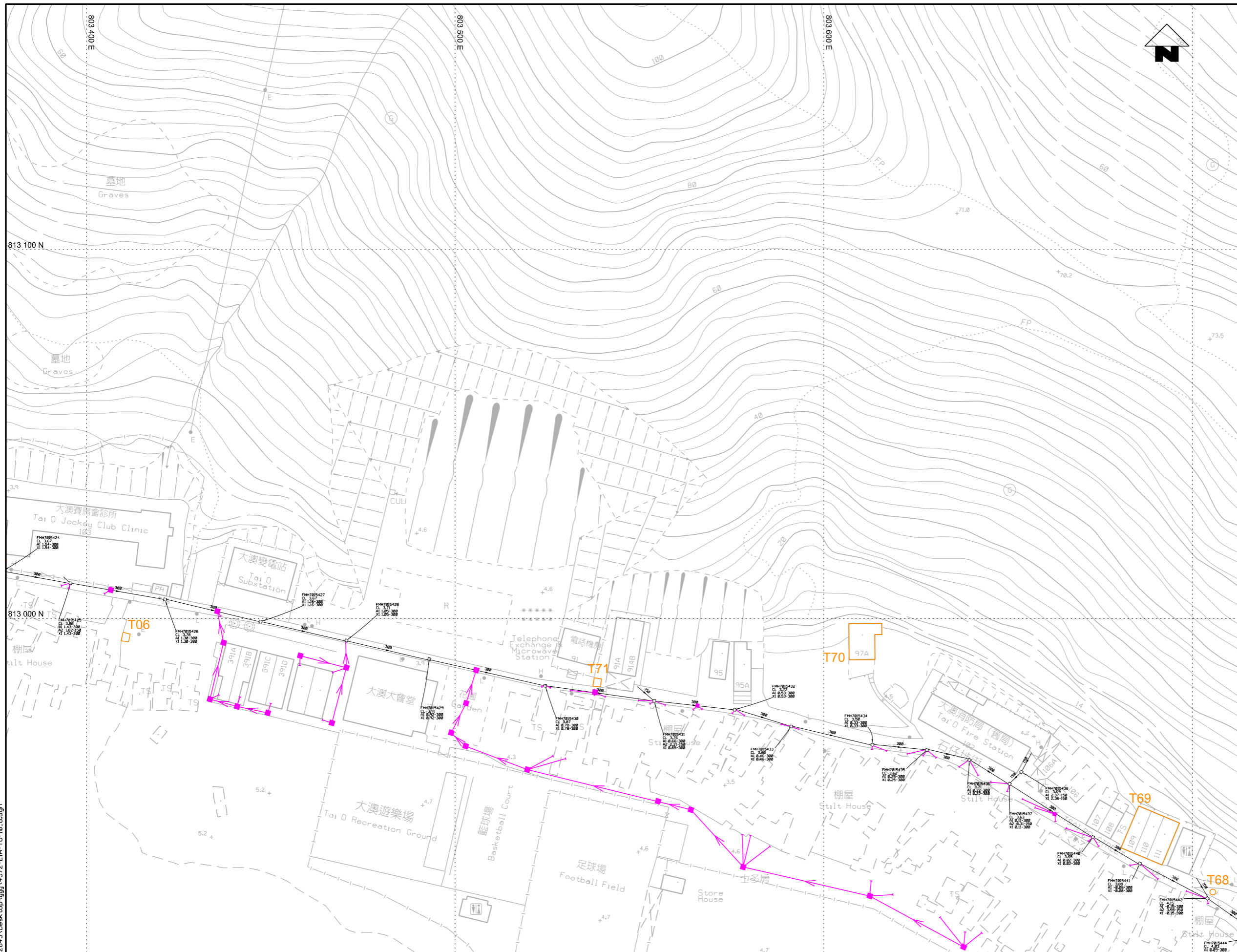

KEY PLAN SCALE : N.T.S.

- NOTES :
1. Exact location of manholes to be determined on site by the Engineer.
  2. Tapping pipes and timber box for the proposed manhole for future house connection are not shown for clarity. Exact location of tapping pipes and timber boxes shall be determined on site by the Engineer.
  3. Details of existing sewers / drains shown are for information only and shall be confirmed on site by the contractor when necessary for the execution of works.

- LEGEND AND ABBREVIATION:
- Existing Manhole
  - Existing Sewer
  - Existing Rising Main
  - Proposed Sewer
  - Proposed Manhole
  - Proposed Rising Main
  - Proposed Tapping Pipe (subject to consultation with owners of houses with topographical problem)
  - Proposed Sewage Pumping Station
  - Location of Built Heritage Resources
  - Estimated Edge of Stilt House

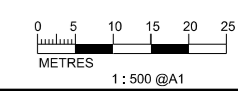

PRINTED BY: chow2843 19/11/2015 16:52:45  
FILE NAME: C:\Users\chow2843\Desktop\yujy14572-ElA-T0-10\_8.dgn



Agreement No. CE 15/2010 (DS)  
 Upgrading of Cheung Chau and Tai O Sewerage Collection, Treatment and Disposal Facilities - Design and Construction  
 Outlying Islands Sewerage Stage 2 -  
 Upgrading of Tai O Sewerage Collection, Treatment and Disposal Facilities

Title :	Location of Built Heritage Resources (Sheet 3 of 14)		
Date :	MAY 2015	Figure :	9.6

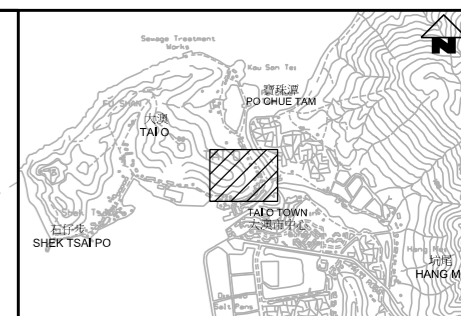
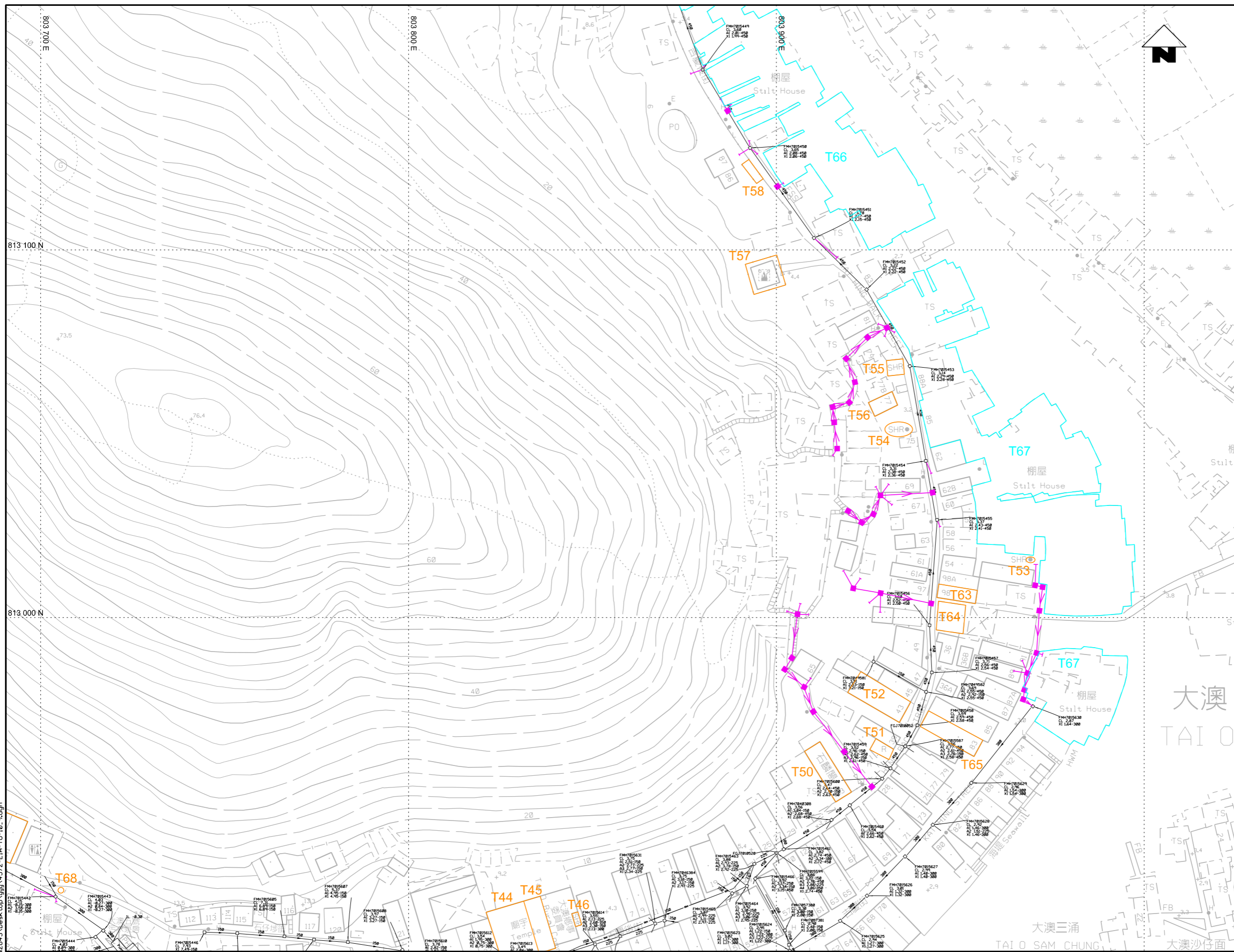

KEY PLAN SCALE :N.T.S.

- NOTES :
1. Exact location of manholes to be determined on site by the Engineer.
  2. Tapping pipes and timber box for the proposed manhole for future house connection are not shown for clarity. Exact location of tapping pipes and timber boxes shall be determined on site by the Engineer.
  3. Details of existing sewers / drains shown are for information only and shall be confirmed on site by the contractor when necessary for the execution of site works.

- LEGEND AND ABBREVIATION:
- Existing Manhole
  - Existing Sewer
  - Existing Rising Main
  - Proposed Sewer
  - Proposed Manhole
  - Proposed Rising Main
  - Proposed Tapping Pipe (subject to consultation with owners of houses with topographical problem)
  - Proposed Sewage Pumping Station
  - Location of Built Heritage Resources
  - Estimated Edge of Stilt House

PRINTED BY: chow2843 17/3/2015 17:33:21  
 FILENAME: C:\Users\chow2843\Desktop\July 14 15\72-ElA-10-10\_9.dgn



Agreement No. CE 15/2010 (DS)  
 Upgrading of Cheung Chau and Tai O Sewerage Collection, Treatment and Disposal Facilities - Design and Construction  
 Outlying Islands Sewerage Stage 2 -  
 Upgrading of Tai O Sewerage Collection, Treatment and Disposal Facilities

Title :	Location of Built Heritage Resources (Sheet 4 of 14)		
Date :	MAY 2015	Figure :	9.7

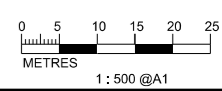

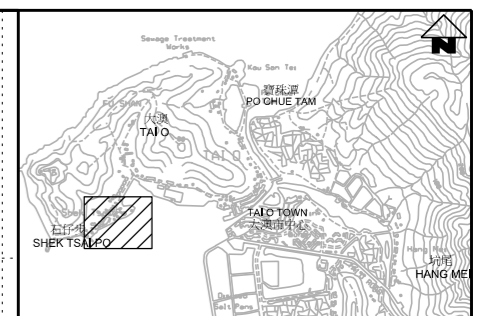
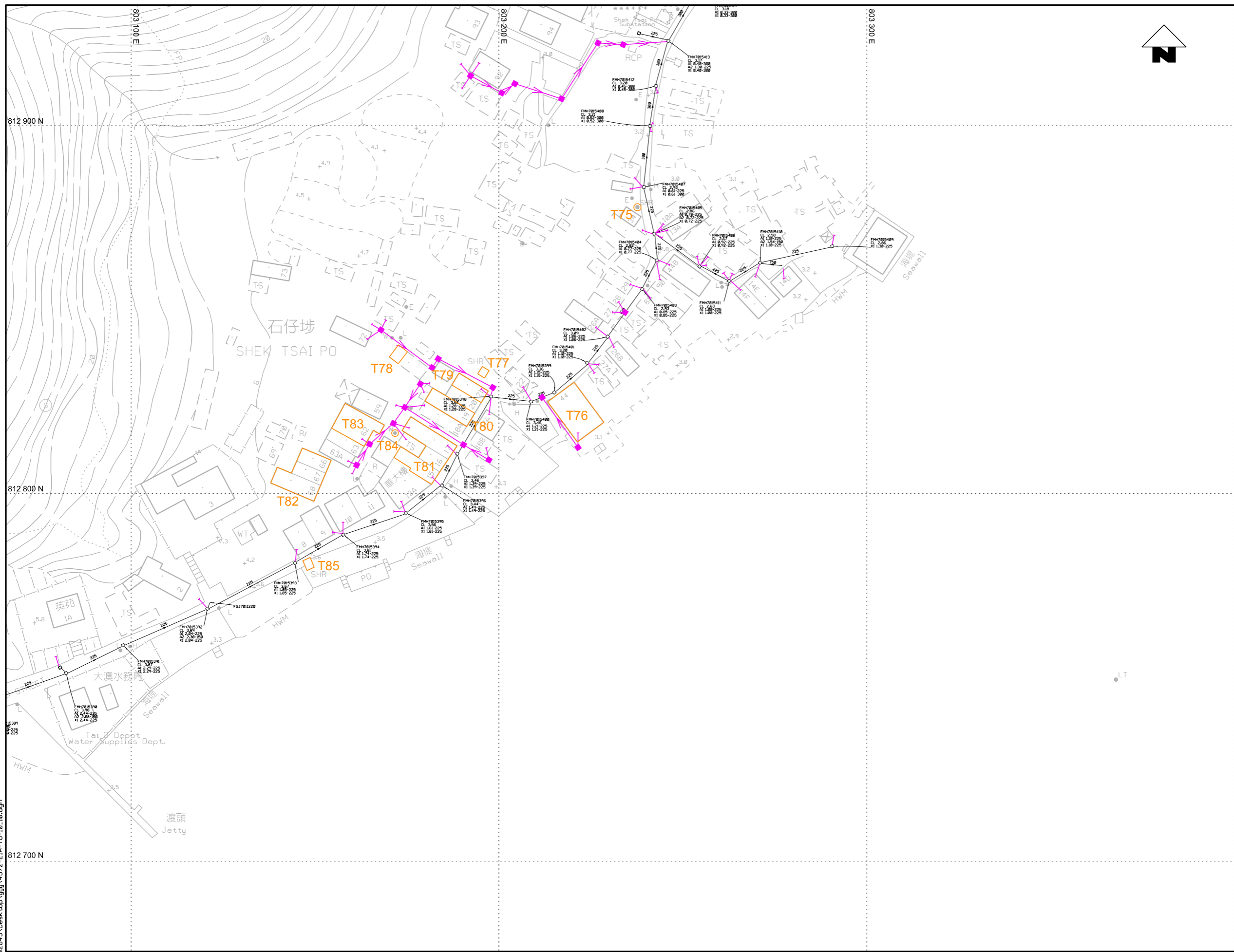

KEY PLAN SCALE : N.T.S.

- NOTES :
1. Exact location of manholes to be determined on site by the Engineer.
  2. Tapping pipes and timber box for the proposed manhole for future house connection are not shown for clarity. Exact location of tapping pipes and timber boxes shall be determined on site by the Engineer.
  3. Details of existing sewers / drains shown are for information only and shall be confirmed on site by the contractor when necessary for the execution of works.

- LEGEND AND ABBREVIATION:
- Existing Manhole
  - Existing Sewer
  - Existing Rising Main
  - Proposed Sewer
  - Proposed Manhole
  - Proposed Rising Main
  - Proposed Tapping Pipe (subject to consultation with owners of houses with topographical problem)
  - Proposed Sewage Pumping Station
  - Location of Built Heritage Resources
  - Estimated Edge of Still House

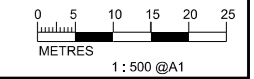

PRINTED BY: chow2843 19/11/2015 17:37:28  
 FILENAME: C:\Users\chow2843\Desktop\yujy\14572-ElR-T0-10.dgn



Agreement No. CE 15/2010 (DS)  
 Upgrading of Cheung Chau and Tai O Sewerage Collection, Treatment and Disposal Facilities - Design and Construction  
**Outlying Islands Sewerage Stage 2 -**  
 Upgrading of Tai O Sewerage Collection, Treatment and Disposal Facilities

Title :	Location of Built Heritage Resources (Sheet 5 of 14)		
Date :	MAY 2015	Figure :	9.8

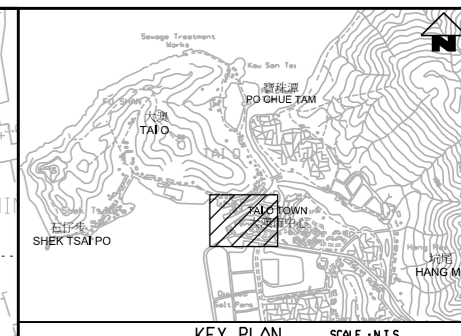
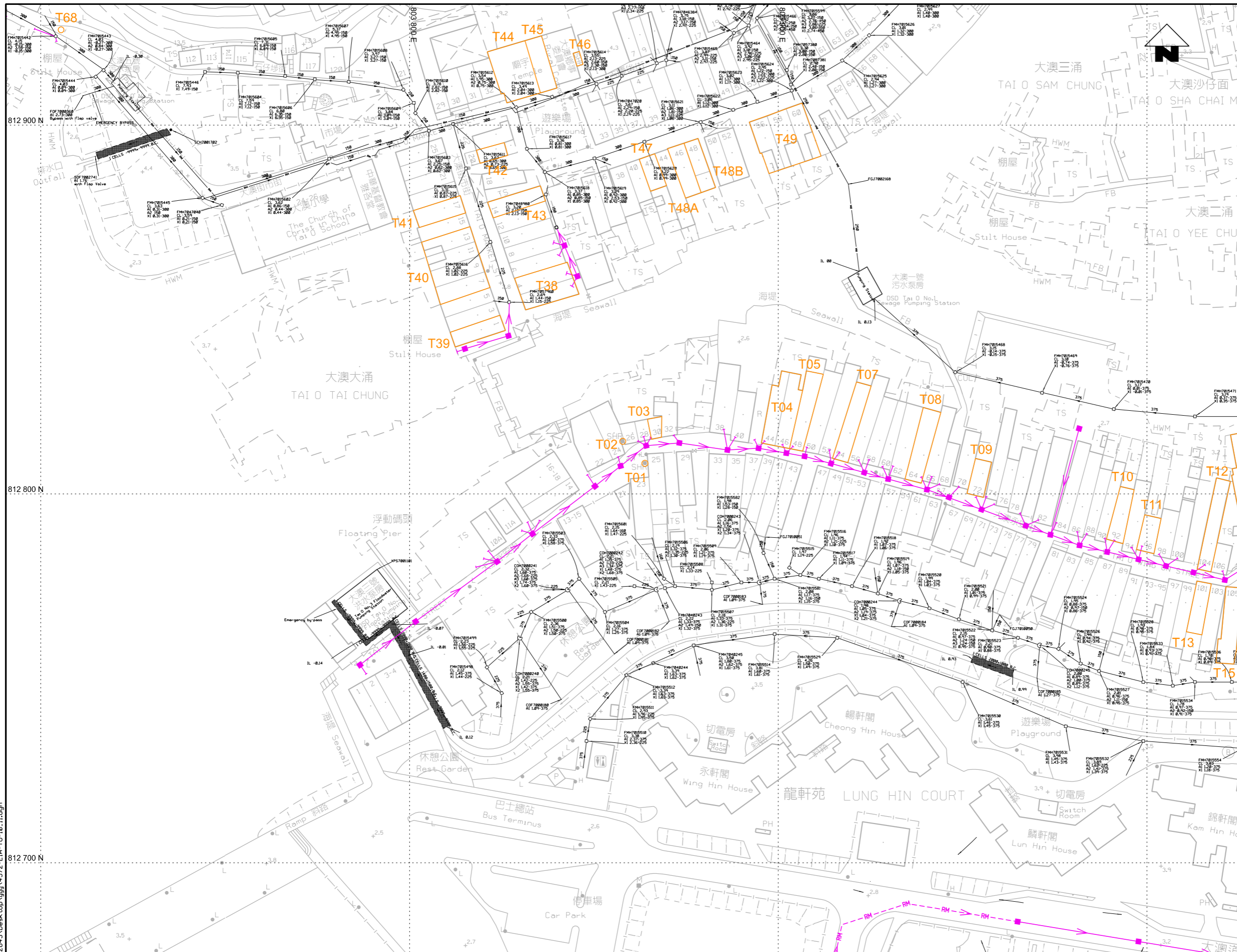

NOTES:

- Exact location of manholes to be determined on site by the Engineer.
- Tapping pipes and timber box for the proposed manhole for future house connection are not shown for clarity. Exact location of tapping pipes and timber boxes shall be determined on site by the Engineer.
- Details of existing sewers / drains shown are for information only and shall be confirmed on site by the contractor when necessary for the execution of works.

LEGEND AND ABBREVIATION:

- Existing Manhole
- Existing Sewer
- Existing Rising Main
- Proposed Sewer
- Proposed Manhole
- Proposed Rising Main
- Proposed Tapping Pipe (subject to consultation with owners of houses with topographical problem)
- Proposed Sewage Pumping Station
- Location of Built Heritage Resources
- Estimated Edge of Still House Existing Rising Main

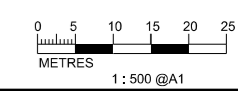

PRINTED BY: chow2843 17/4/2015 17:42:18 FILENAME: C:\Users\chow2843\Desktop\yuj\14572-ElR-T0-10-11.dgn



Agreement No. CE 15/2010 (DS)  
 Upgrading of Cheung Chau and Tai O Sewerage Collection, Treatment and Disposal Facilities - Design and Construction  
 Outlying Islands Sewerage Stage 2 -  
 Upgrading of Tai O Sewerage Collection, Treatment and Disposal Facilities

Title:	Location of Built Heritage Resources (Sheet 6 of 14)		
Date:	MAY 2015	Figure:	9.9

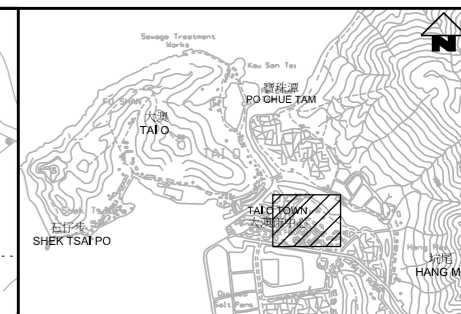
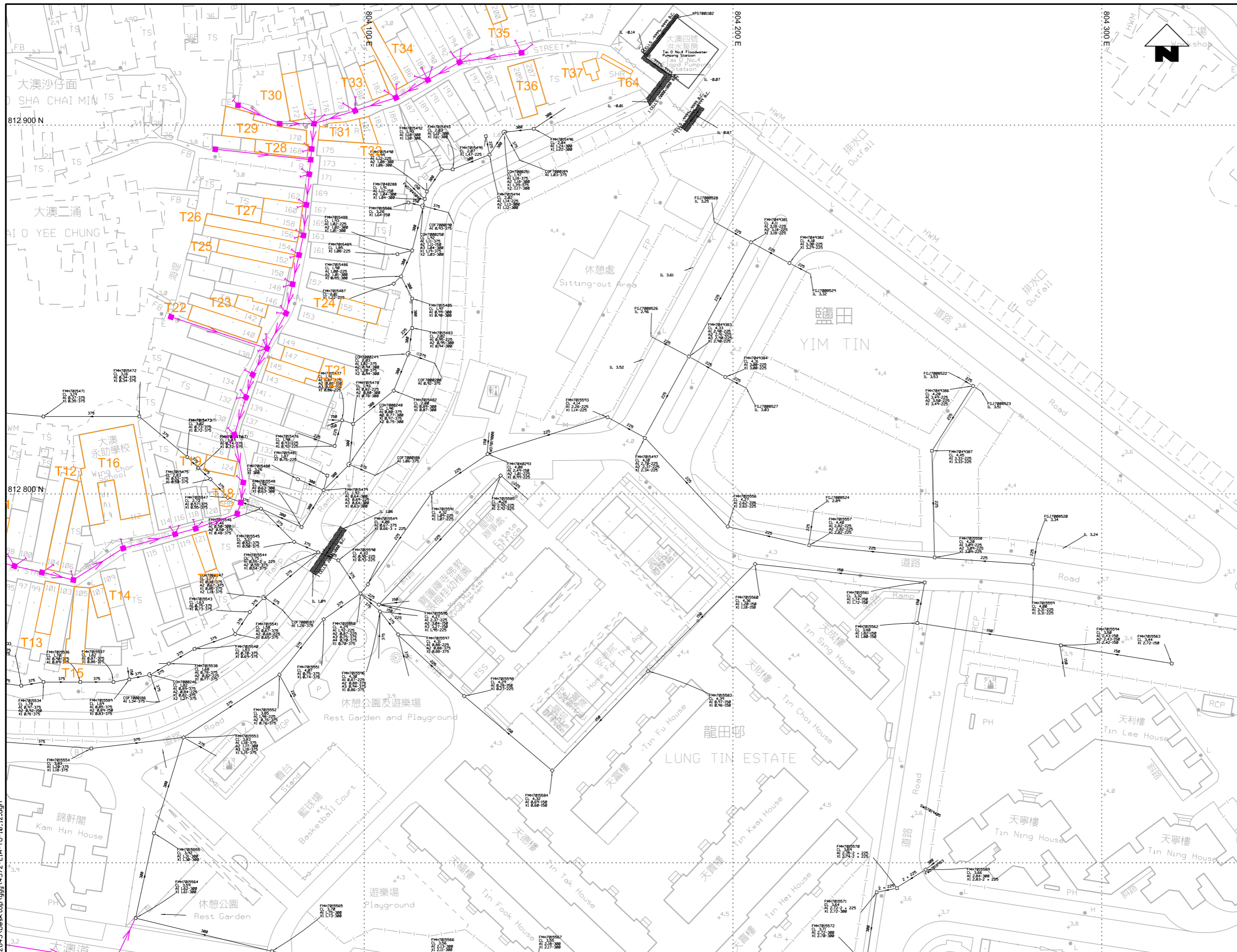

KEY PLAN SCALE : N.T.S.

- NOTES :
1. Exact location of manholes to be determined on site by the Engineer.
  2. Tapping pipes and timber box for the proposed manhole for future house connection are not shown for clarity. Exact location of tapping pipes and timber boxes shall be determined on site by the Engineer.
  3. Details of existing sewers / drains shown are for information only and shall be confirmed on site by the contractor when necessary for the execution of works.

- LEGEND AND ABBREVIATION:
- Existing Manhole
  - Existing Sewer
  - Existing Rising Main
  - Proposed Sewer
  - Proposed Manhole
  - Proposed Rising Main
  - Proposed Tapping Pipe (subject to consultation with owners of houses with topographical problem)
  - Proposed Sewage Pumping Station
  - Location of Built Heritage Resources
  - Estimated Edge of Still House

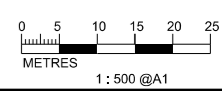

PRINTED BY: chow2843 19/11/2015 17:44:58  
FILENAME: C:\Users\chow2843\Desktop\yujy\1512-ER-10-10-12.dgn



Agreement No. CE 15/2010 (DS)  
 Upgrading of Cheung Chau and Tai O Sewerage Collection, Treatment and Disposal Facilities - Design and Construction  
 Outlying Islands Sewerage Stage 2 -  
 Upgrading of Tai O Sewerage Collection, Treatment and Disposal Facilities

Title :	Location of Built Heritage Resources (Sheet 7 of 14)		
Date :	MAY 2015	Figure :	9.10

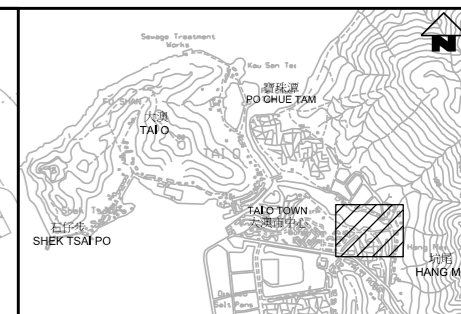
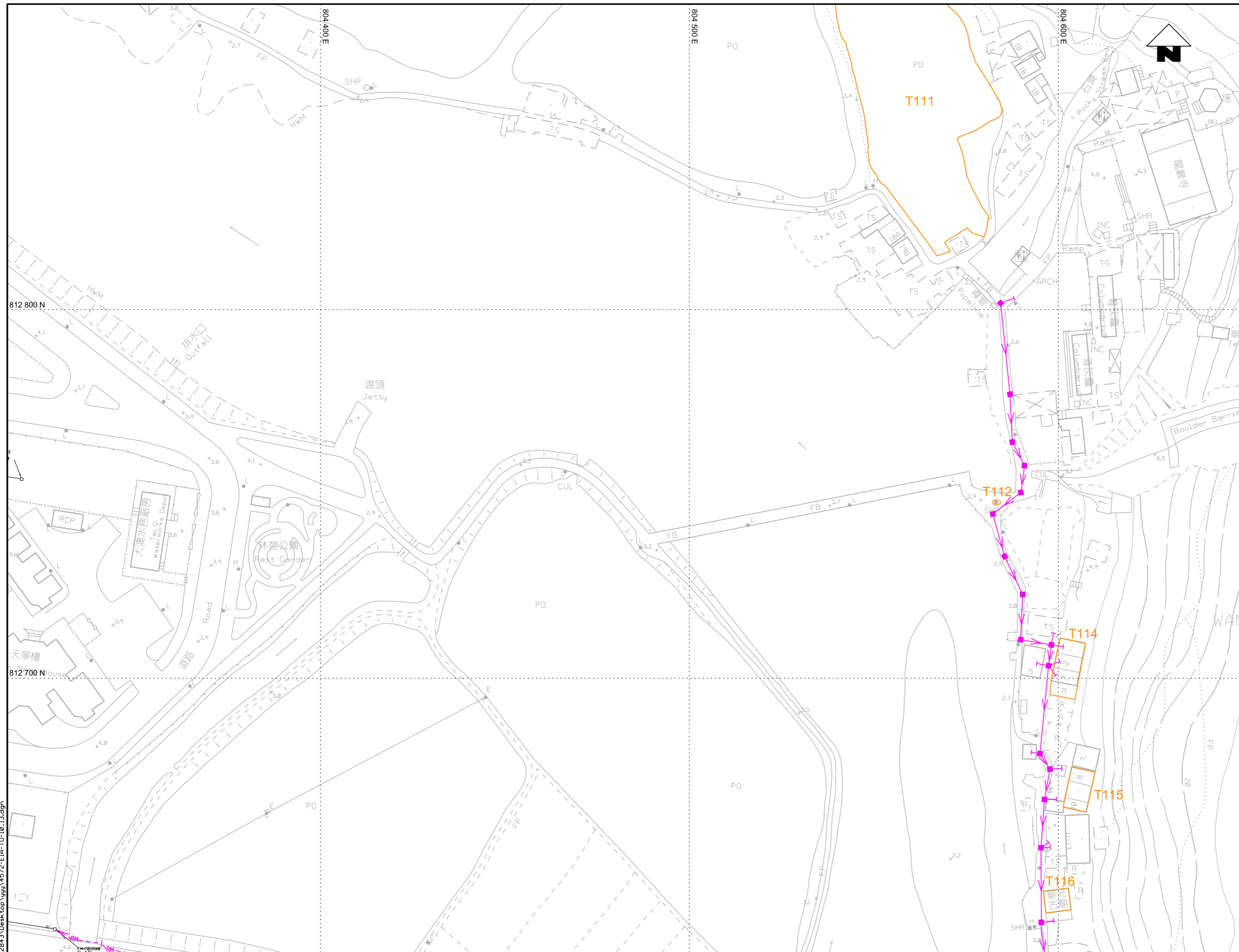

KEY PLAN SCALE : N.T.S.

- NOTES :
1. Exact location of manholes to be determined on site by the Engineer.
  2. Tapping pipes and timber box for the proposed manhole for future house connection are not shown for clarity. Exact location of tapping pipes and timber boxes shall be determined on site by the Engineer.
  3. Details of existing sewers / drains shown are for information only and shall be confirmed on site by the contractor when necessary for the execution of works.

- LEGEND AND ABBREVIATION:
- Existing Manhole
  - Existing Sewer
  - Existing Rising Main
  - Proposed Sewer
  - Proposed Manhole
  - Proposed Rising Main
  - Proposed Tapping Pipe (subject to consultation with owners of houses with topographical problem)
  - Proposed Sewage Pumping Station
  - Location of Built Heritage Resources
  - Estimated Edge of Still House

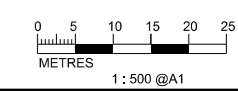

PRINTED BY: chow2843 19/11/2015 17:47:52  
 FILENAME: C:\Users\chow2843\Desktop\14572-ElA-T0-10-13.dgn



Agreement No. CE 15/2010 (DS)  
 Upgrading of Cheung Chau and Tai O Sewerage Collection, Treatment and Disposal Facilities - Design and Construction  
**Outlying Islands Sewerage Stage 2 -**  
 Upgrading of Tai O Sewerage Collection, Treatment and Disposal Facilities

Title :	Location of Built Heritage Resources (Sheet 8 of 14)		
Date :	MAY 2015	Figure :	9.11



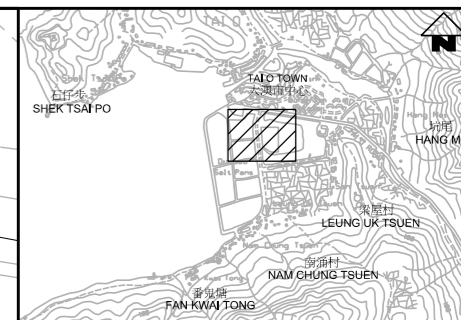
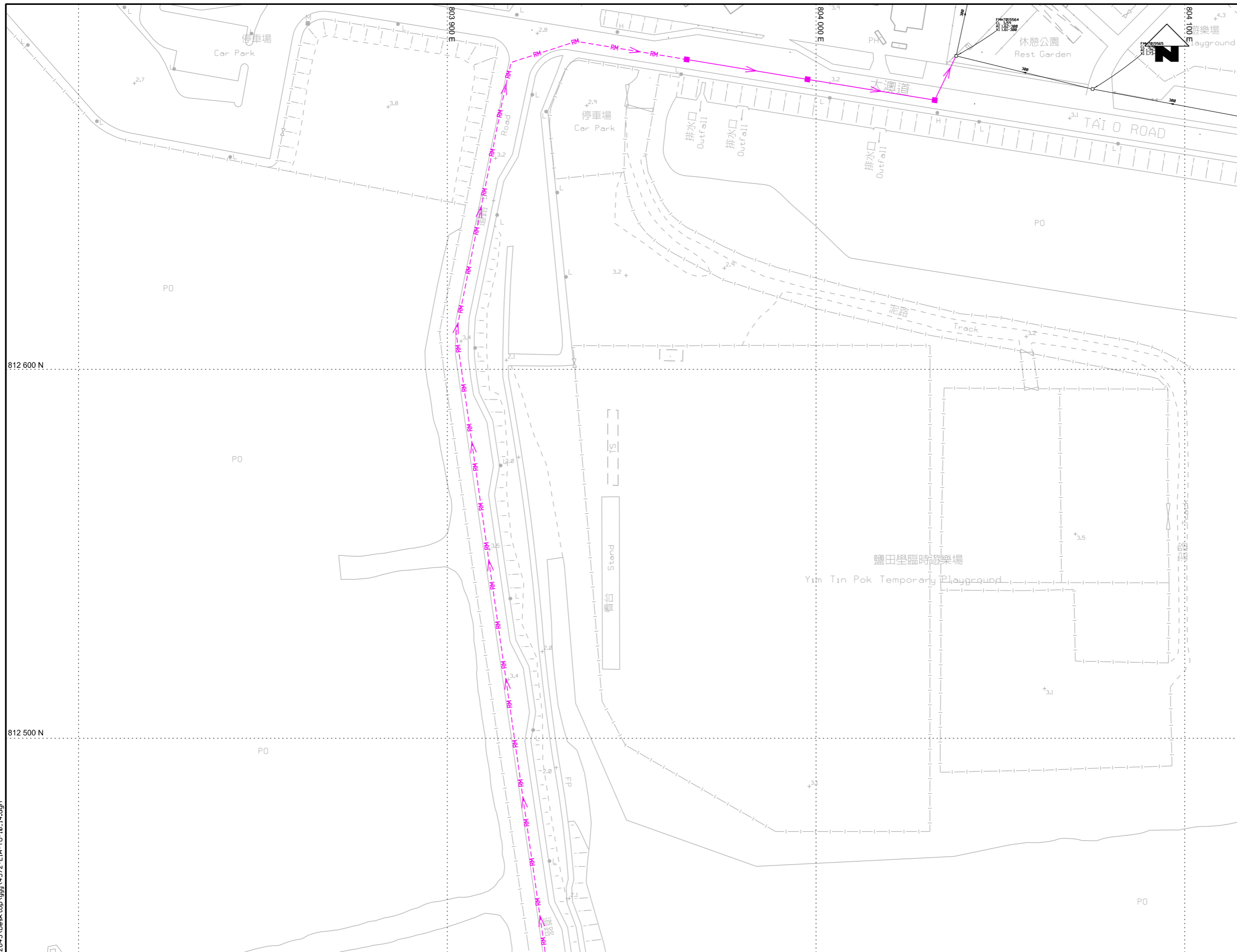

KEY PLAN SCALE : N.T.S.

- NOTES :
1. Exact location of manholes to be determined on site by the Engineer.
  2. Tapping pipes and timber box for the proposed manhole for future house connection are not shown for clarity. Exact location of tapping pipes and timber boxes shall be determined on site by the Engineer.
  3. Details of existing sewers / drains shown are for information only and shall be confirmed on site by the contractor when necessary for the execution of works.

- LEGEND AND ABBREVIATION:
- Existing Manhole
  - Existing Sewer
  - Existing Rising Main
  - Proposed Sewer
  - Proposed Manhole
  - Proposed Rising Main
  - Proposed Tapping Pipe (subject to consultation with owners of houses with topographical problem)
  - Proposed Sewage Pumping Station
  - Location of Built Heritage Resources
  - Estimated Edge of Stilt House

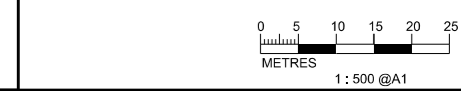

PRINTED BY: c:\nw2843 19/11/2015 17:51:40 FILENAME: C:\Users\c\nw2843\Desktop\yij\1572-ER-T0-10-14.dgn



Agreement No. CE 15/2010 (DS)  
 Upgrading of Cheung Chau and Tai O Sewerage Collection, Treatment and Disposal Facilities - Design and Construction  
 Outlying Islands Sewerage Stage 2 -  
 Upgrading of Tai O Sewerage Collection, Treatment and Disposal Facilities

Title :	Location of Built Heritage Resources (Sheet 9 of 14)		
Date :	MAY 2015	Figure :	9.12

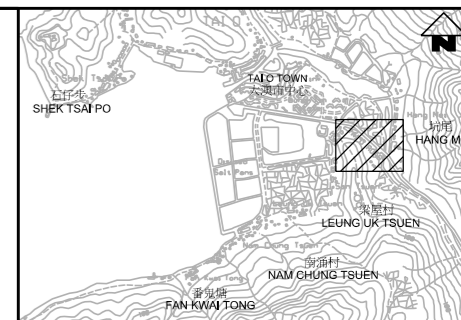
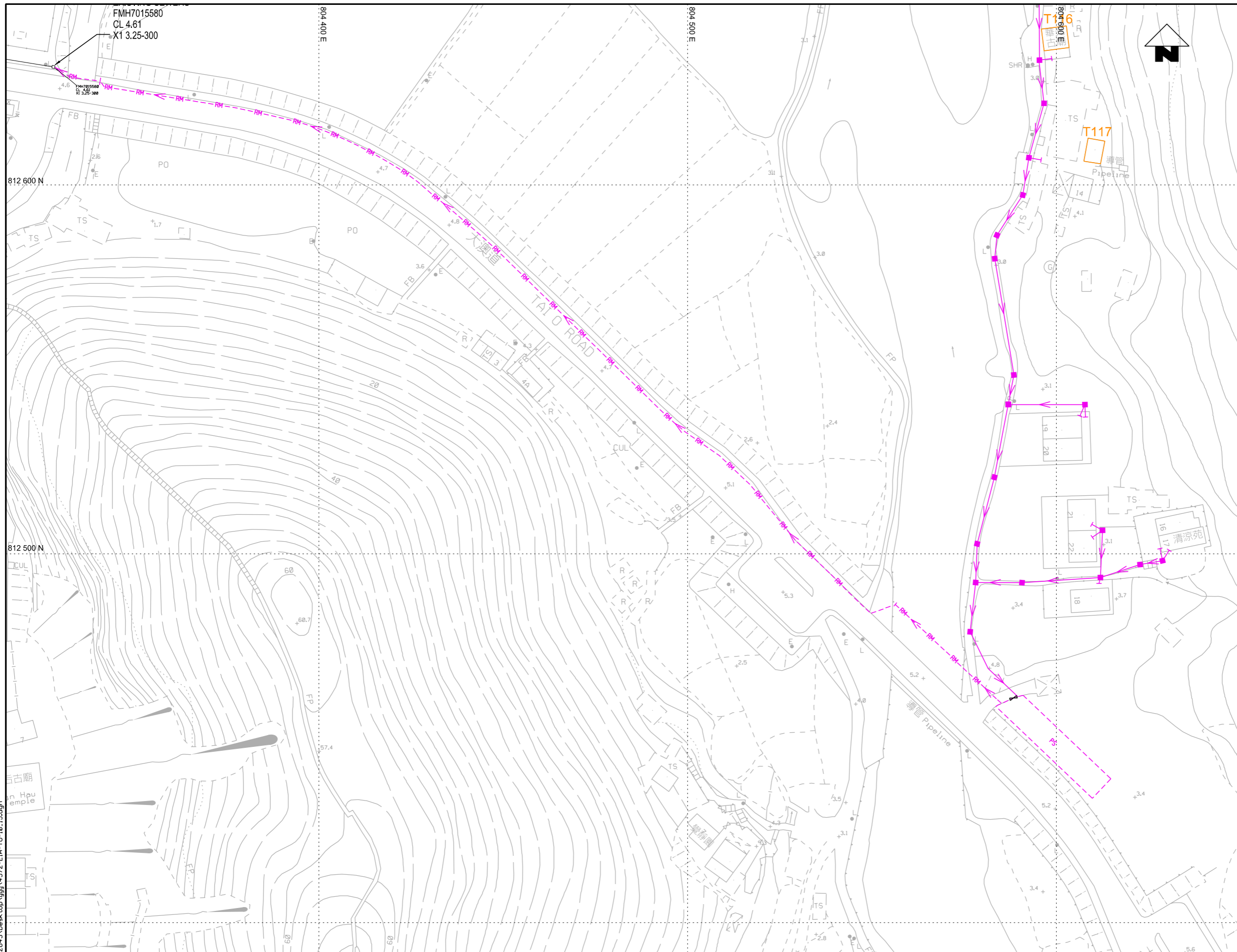

KEY PLAN SCALE : 1:10,000

- NOTES :
1. Exact location of manholes to be determined on site by the Engineer.
  2. Tapping pipes and timber box for the proposed manhole for future house connection are not shown for clarity. Exact location of tapping pipes and timber boxes shall be determined on site by the Engineer.
  3. Details of existing sewers / drains shown are for information only and shall be confirmed on site by the contractor when necessary for the execution of works.

- LEGEND AND ABBREVIATION:
- Existing Manhole
  - Existing Sewer
  - Existing Rising Main
  - Proposed Sewer
  - Proposed Manhole
  - Proposed Rising Main
  - Proposed Tapping Pipe (subject to consultation with owners of houses with topographical problem)
  - Proposed Sewage Pumping Station
  - Location of Built Heritage Resources
  - Estimated Edge of Stilt House

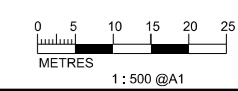

PRINTED BY: chow2843 17/5/2015 17:54:36  
 FILENAME: C:\Users\chow2843\Desktop\yujy\14572-ER-10-15.dgn



Agreement No. CE 15/2010 (DS)  
 Upgrading of Cheung Chau and Tai O Sewerage Collection, Treatment and Disposal Facilities - Design and Construction  
**Outlying Islands Sewerage Stage 2 -**  
 Upgrading of Tai O Sewerage Collection, Treatment and Disposal Facilities

Title :	Location of Built Heritage Resources (Sheet 10 of 14)		
Date :	MAY 2015	Figure :	9.13

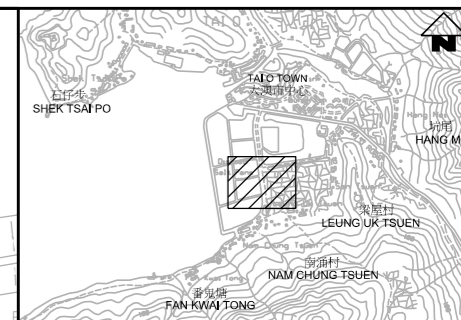

KEY PLAN SCALE : N.T.S.

- NOTES :
1. Exact location of manholes to be determined on site by the Engineer.
  2. Tapping pipes and timber box for the proposed manhole for future house connection are not shown for clarity. Exact location of tapping pipes and timber boxes shall be determined on site by the Engineer.
  3. Details of existing sewers / drains shown are for information only and shall be confirmed on site by the contractor when necessary for the execution of works.

- LEGEND AND ABBREVIATION:
- Existing Manhole
  - Existing Sewer
  - Existing Rising Main
  - Proposed Sewer
  - Proposed Manhole
  - Proposed Rising Main
  - Proposed Tapping Pipe (subject to consultation with owners of houses with topographical problem)
  - Proposed Sewage Pumping Station
  - Location of Built Heritage Resources
  - Estimated Edge of Stilt House

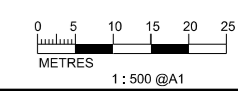

PRINTED BY: c:\nw2843 19/11/2015 17:58:15 FILENAME: C:\Users\c\nw2843\Desktop\yjj\14572-ER-T0-10-16.dgn



Agreement No. CE 15/2010 (DS)  
 Upgrading of Cheung Chau and Tai O Sewerage Collection, Treatment and Disposal Facilities - Design and Construction  
**Outlying Islands Sewerage Stage 2 -**  
 Upgrading of Tai O Sewerage Collection, Treatment and Disposal Facilities

Title :	Location of Built Heritage Resources (Sheet 11 of 14)		
Date :	MAY 2015	Figure :	9.14

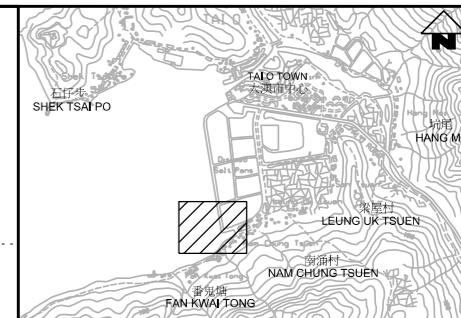
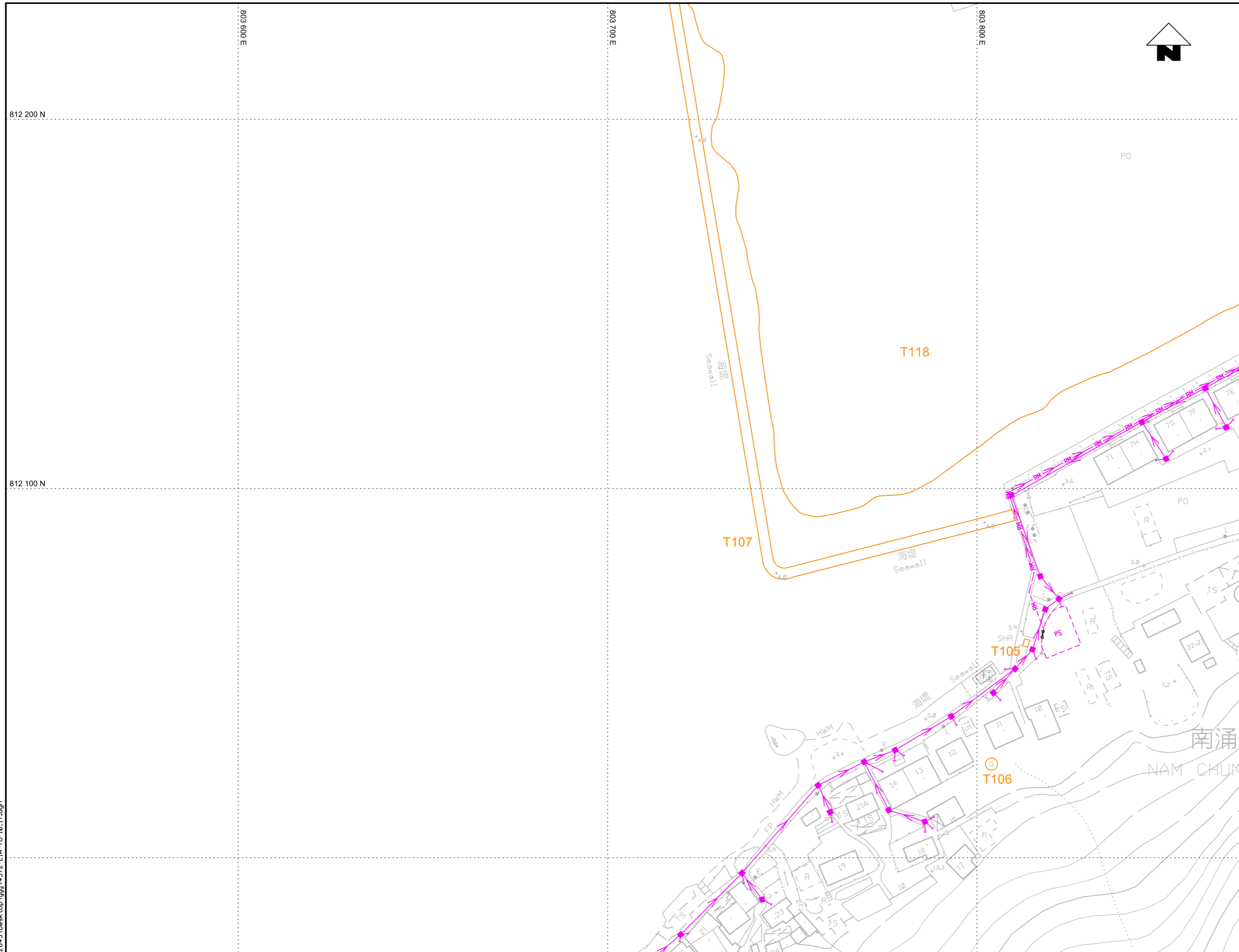

KEY PLAN SCALE : N.T.S.

- NOTES :
1. Exact location of manholes to be determined on site by the Engineer.
  2. Tapping pipes and timber box for the proposed manhole for future house connection are not shown for clarity. Exact location of tapping pipes and timber boxes shall be determined on site by the Engineer.
  3. Details of existing sewers / drains shown are for information only and shall be confirmed on site by the contractor when necessary for the execution of works.

- LEGEND AND ABBREVIATION:
- Existing Manhole
  - Existing Sewer
  - Existing Rising Main
  - Proposed Sewer
  - Proposed Manhole
  - RM Proposed Rising Main
  - Proposed Tapping Pipe (subject to consultation with owners of houses with topographical problem)
  - PS Proposed Sewage Pumping Station
  - Location of Built Heritage Resources
  - Estimated Edge of Stilt House

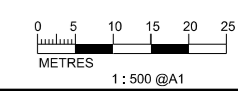

PRINTED BY: c:\hzw\2843 19/11/2015 18:01:45 FILENAME: C:\Users\c\hzw\2843\Desktop\14572-ER-T0-10-17.dgn



Agreement No. CE 15/2010 (DS)  
 Upgrading of Cheung Chau and Tai O Sewerage Collection, Treatment and Disposal Facilities - Design and Construction  
 Outlying Islands Sewerage Stage 2 -  
 Upgrading of Tai O Sewerage Collection, Treatment and Disposal Facilities

Title :	Location of Built Heritage Resources (Sheet 12 of 14)		
Date :	MAY 2015	Figure :	9.15

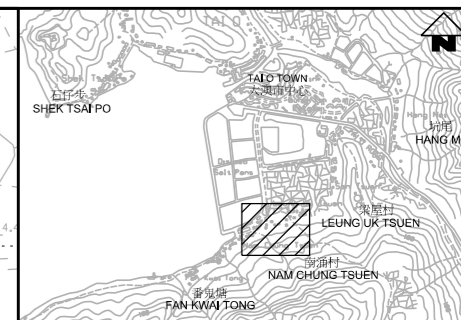
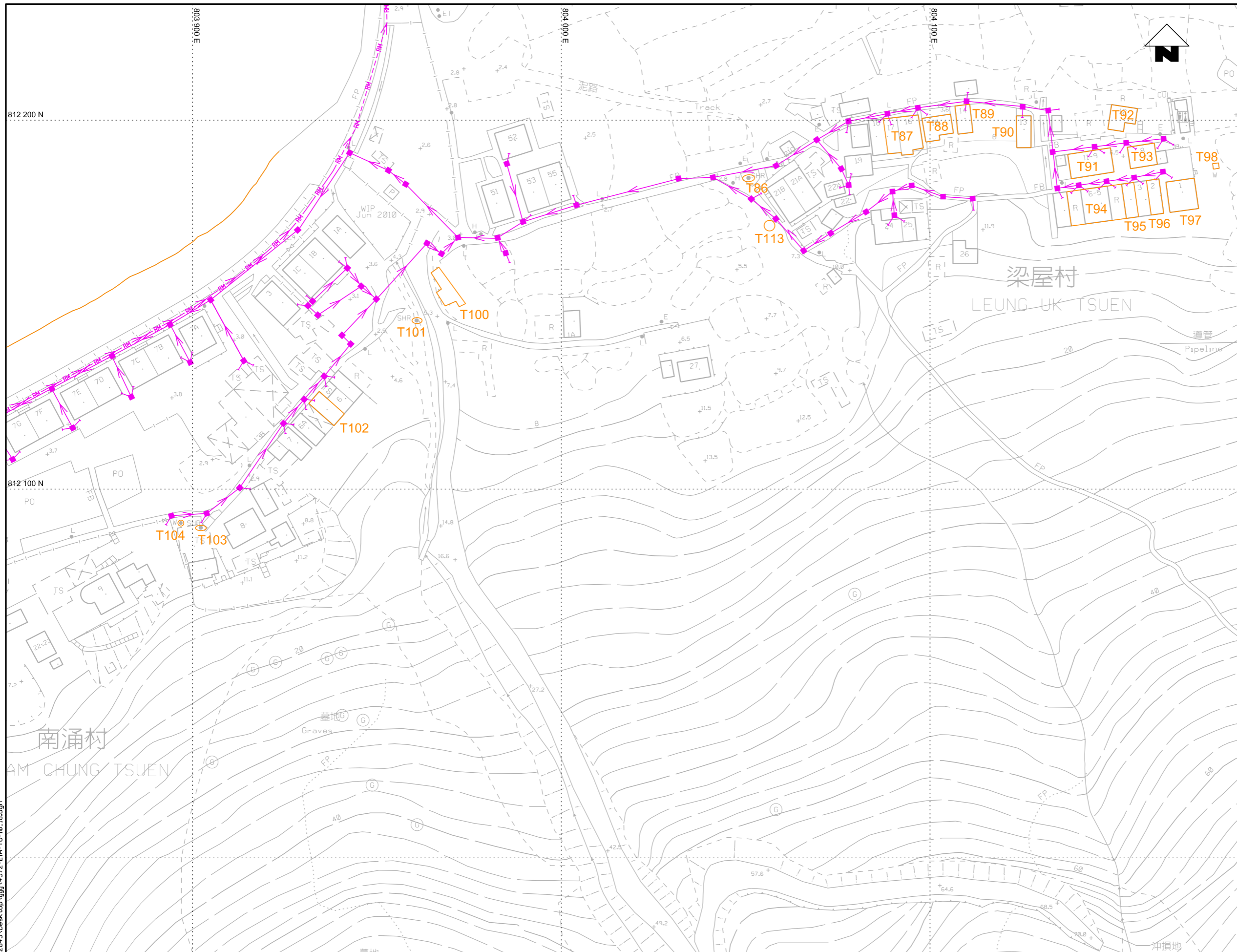

- NOTES :
1. Exact location of manholes to be determined on site by the Engineer.
  2. Tapping pipes and timber box for the proposed manhole for future house connection are not shown for clarity. Exact location of tapping pipes and timber boxes shall be determined on site by the Engineer.
  3. Details of existing sewers / drains shown are for information only and shall be confirmed on site by the contractor when necessary for the execution of site works.

- LEGEND AND ABBREVIATION:
- Existing Manhole
  - Existing Sewer
  - Existing Rising Main
  - Proposed Sewer
  - Proposed Manhole
  - Proposed Rising Main
  - Proposed Tapping Pipe (subject to consultation with owners of houses with topographical problem)
  - Proposed Sewage Pumping Station
  - Location of Built Heritage Resources
  - Estimated Edge of Still House

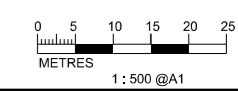

PRINTED BY: chow2843 18/05/2015 18:05:08  
 FILENAME: C:\Users\chow2843\Desktop\14572-ElA-T0-10-18.dgn



Agreement No. CE 15/2010 (DS)  
 Upgrading of Cheung Chau and Tai O Sewerage Collection, Treatment and Disposal Facilities - Design and Construction  
**Outlying Islands Sewerage Stage 2 -**  
 Upgrading of Tai O Sewerage Collection, Treatment and Disposal Facilities

Title :	Location of Built Heritage Resources (Sheet 13 of 14)		
Date :	MAY 2015	Figure :	9.16

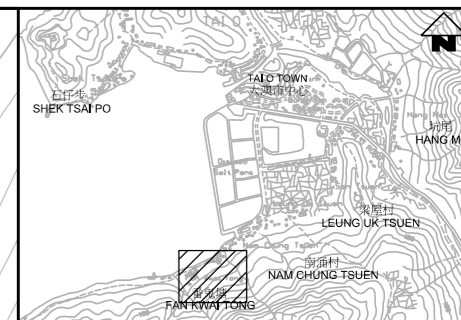
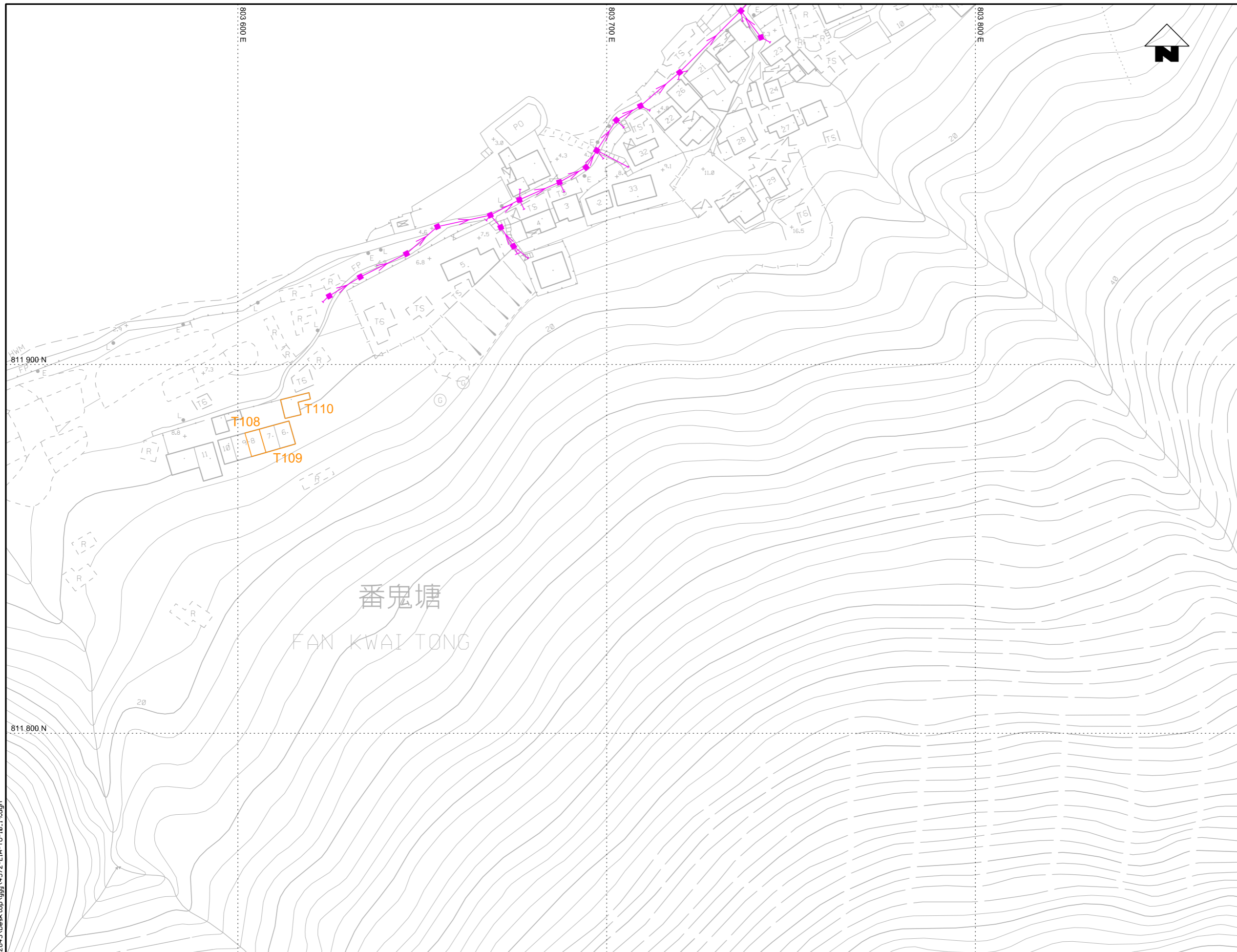

KEY PLAN SCALE : 1:500

- NOTES :
1. Exact location of manholes to be determined on site by the Engineer.
  2. Tapping pipes and timber box for the proposed manhole for future house connection are not shown for clarity. Exact location of tapping pipes and timber boxes shall be determined on site by the Engineer.
  3. Details of existing sewers / drains shown are for information only and shall be confirmed on site by the contractor when necessary for the execution of site works.

- LEGEND AND ABBREVIATION:
- Existing Manhole
  - Existing Sewer
  - Existing Rising Main
  - Proposed Sewer
  - Proposed Manhole
  - Proposed Rising Main
  - Proposed Tapping Pipe (subject to consultation with owners of houses with topographical problem)
  - Proposed Sewage Pumping Station
  - Location of Built Heritage Resources
  - Estimated Edge of Still House

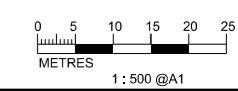

PRINTED BY: chow2843 19/11/2015 18:07:16 FILENAME: C:\Users\chow2843\Desktop\14572-ElA-T0-10-19.dgn