APPENDIX 2.1

**Alternative Options for the Extension of the Existing Lai Chi
Yuen Cemetery**

Appendix 2.1 Alternative Options for the Extension of the Existing Lai Chi Yuen Cemetery

The original scheme for the cemetery extension during the initial feasibility study in year 2011 was to provide the niches on the existing vacant platform within the cemetery. However, an extensive ramp along the slope (and outside the cemetery boundary) had to be constructed to connect the new niches to the cemetery entrance in order to fulfill the Barrier Free Access criteria (Scheme 1). Details is shown in enclosed **Figure A1**.

In view of the extensive site area and hence site formation works required, an alternative scheme for construction of a raised platform adjacent to the site entrance was then proposed (Scheme 2) and shown in **Figure A2**. The total area is about 340m².

However, during a pre-meeting with Agriculture, Fisheries and Conservation Department (AFCD) on Dec 2014 for the Country and Marine Parks Board (CMPB) consultation, AFCD suggested that the extension should be kept within the existing cemetery boundary as far as possible. In this connection, Scheme 3 (**Figure A3**) was further developed with only a small area (7.5 m²) outside the existing cemetery for site access.

In order to further minimize the environmental impact, the site area for Scheme 3 has been critically reviewed and reduced from the ~ 340 m² of Scheme 2 to ~ 233 m² only. The area of 233 m² is considered optimal to accommodate the following facilities:

- Provision of approx. 790 niches
- Joss paper burner and the ancillary facilities
- Adequate space for site access and visitor flow, in particular during the festival periods
- Area for compensatory tree planting

In April 2015, during the CMPB meeting, some committees concerned about the visual impact and the risk of hill fire incident during operation of the Project as the joss paper burner was located along the boundary adjacent to the country park under Scheme 3. Therefore, the design of Scheme 3 was further modified to become the current scheme (Scheme 4) as shown in **Figure A4**. This scheme not only minimized above issues but also considered the comments from the CMPB meeting.

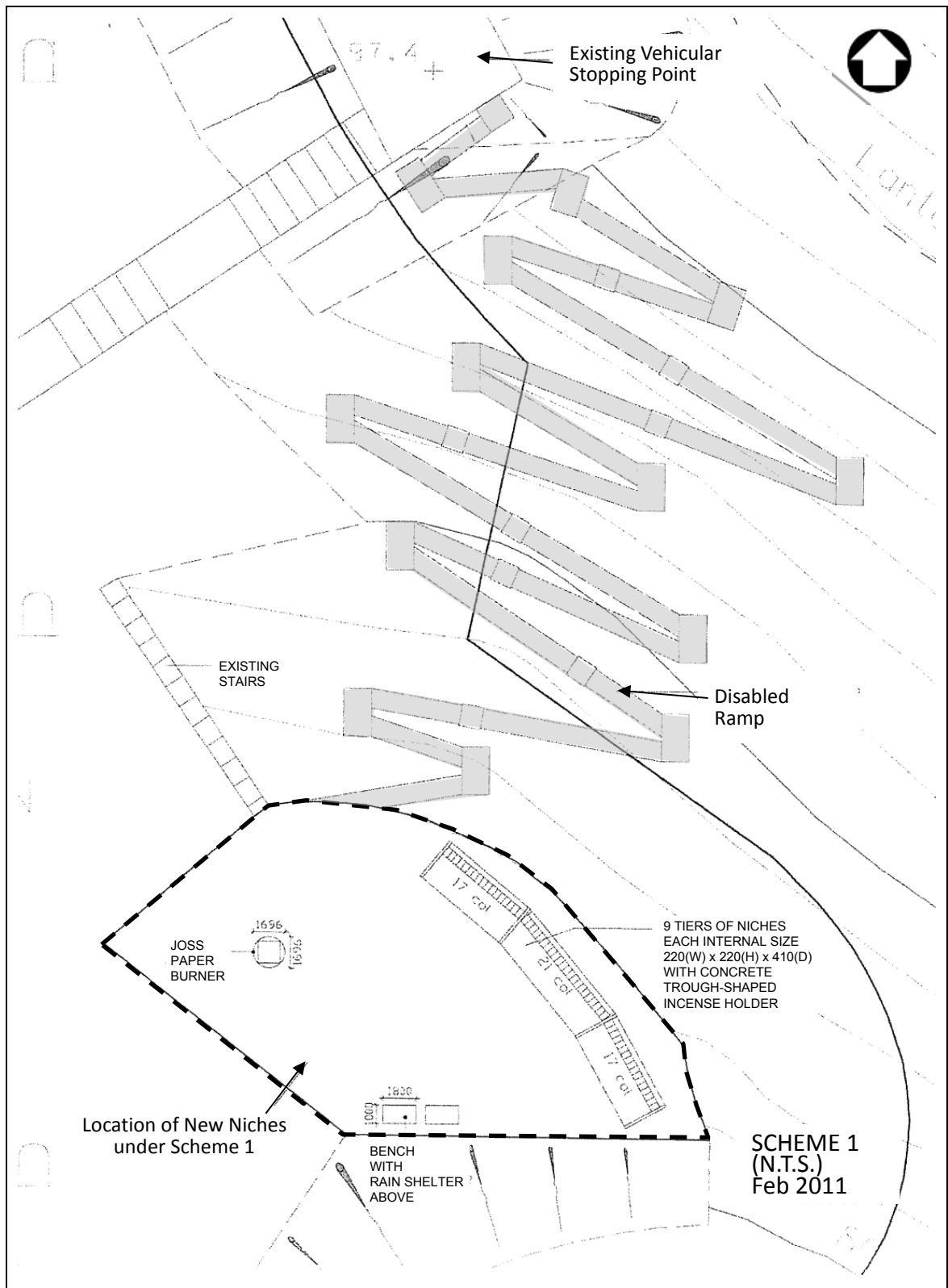

Figure A1 Considered Location of Scheme 1

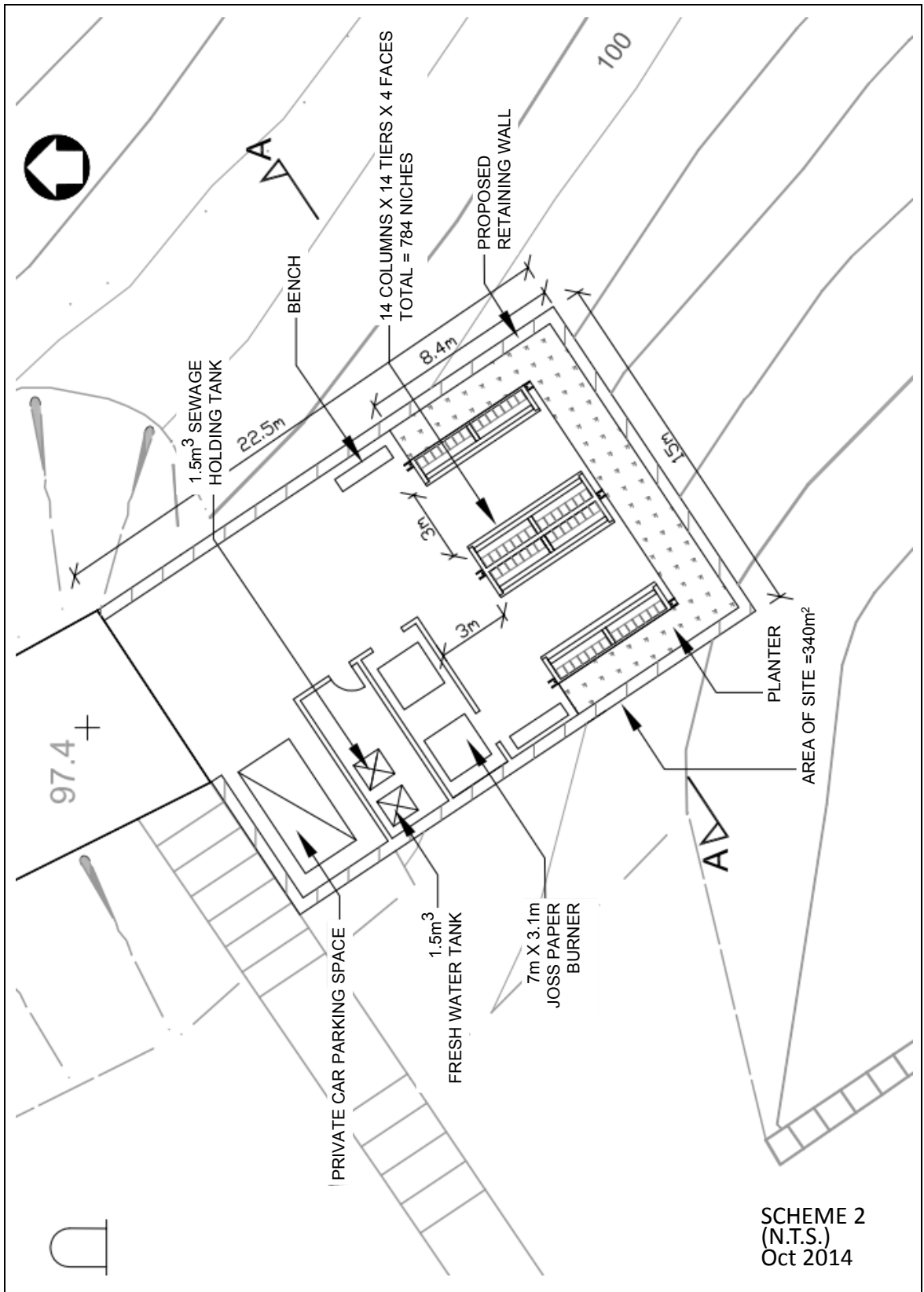

Figure A2 Considered Location of Scheme 2

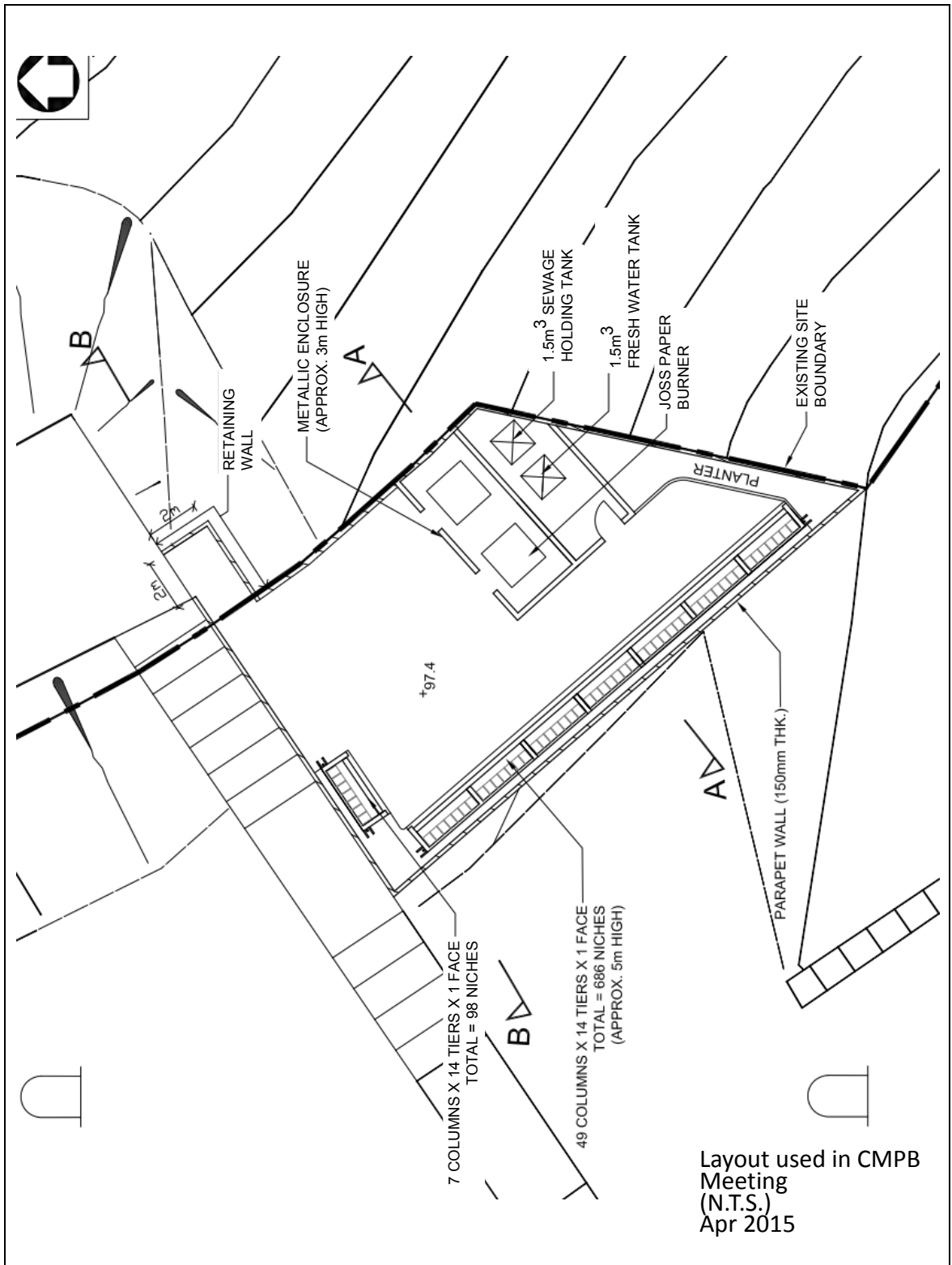

Figure A3 Considered Location of Scheme 3

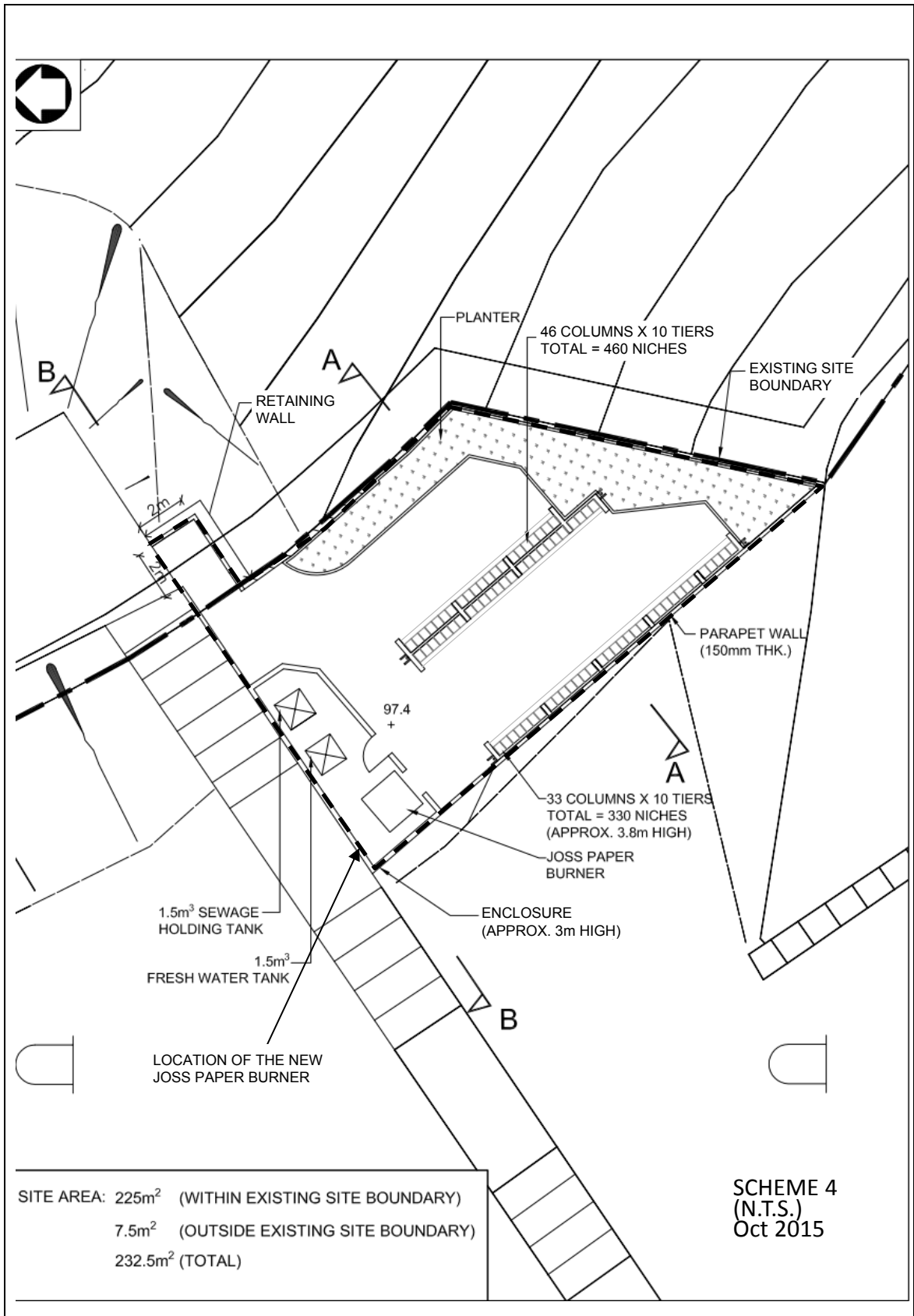

Figure A4 Considered Location of Scheme 4 (Current Scheme)