

ISO A1 594mm x 841mm
 Approved:
 Checked:
 Designer:
 Project Management Initials:

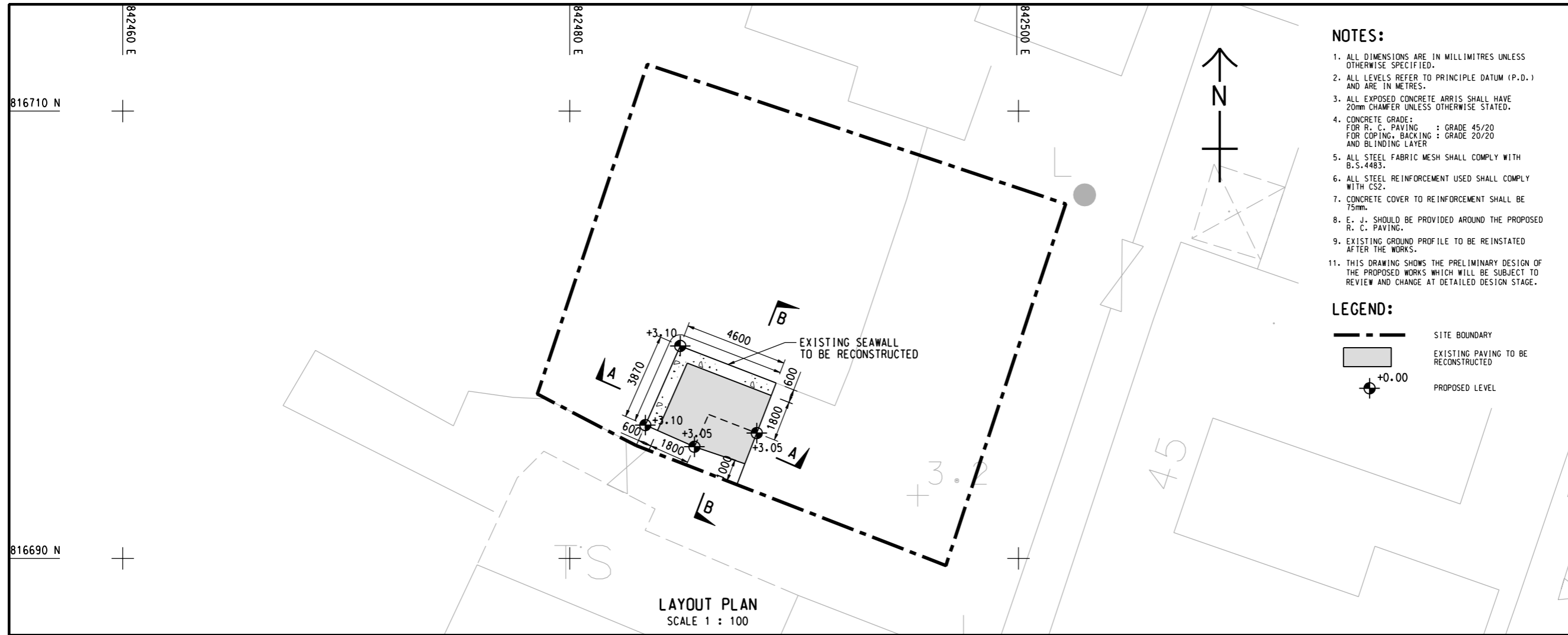

- NOTES:**
1. ALL DIMENSIONS ARE IN MILLIMETRES UNLESS OTHERWISE SPECIFIED.
 2. ALL LEVELS REFER TO PRINCIPLE DATUM (P.D.) AND ARE IN METRES.
 3. ALL EXPOSED CONCRETE ARRIS SHALL HAVE 20mm CHAMFER UNLESS OTHERWISE STATED.
 4. CONCRETE GRADE:
 FOR R. C. PAVING : GRADE 45/20
 FOR COPING, BACKING : GRADE 20/20
 AND BLINDING LAYER
 5. ALL STEEL FABRIC MESH SHALL COMPLY WITH B.S.4483.
 6. ALL STEEL REINFORCEMENT USED SHALL COMPLY WITH CS2.
 7. CONCRETE COVER TO REINFORCEMENT SHALL BE 75mm.
 8. E. J. SHOULD BE PROVIDED AROUND THE PROPOSED R. C. PAVING.
 9. EXISTING GROUND PROFILE TO BE REINSTATED AFTER THE WORKS.
 11. THIS DRAWING SHOWS THE PRELIMINARY DESIGN OF THE PROPOSED WORKS WHICH WILL BE SUBJECT TO REVIEW AND CHANGE AT DETAILED DESIGN STAGE.

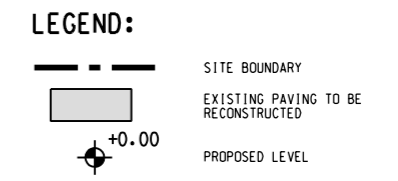

LAYOUT PLAN
 SCALE 1 : 100

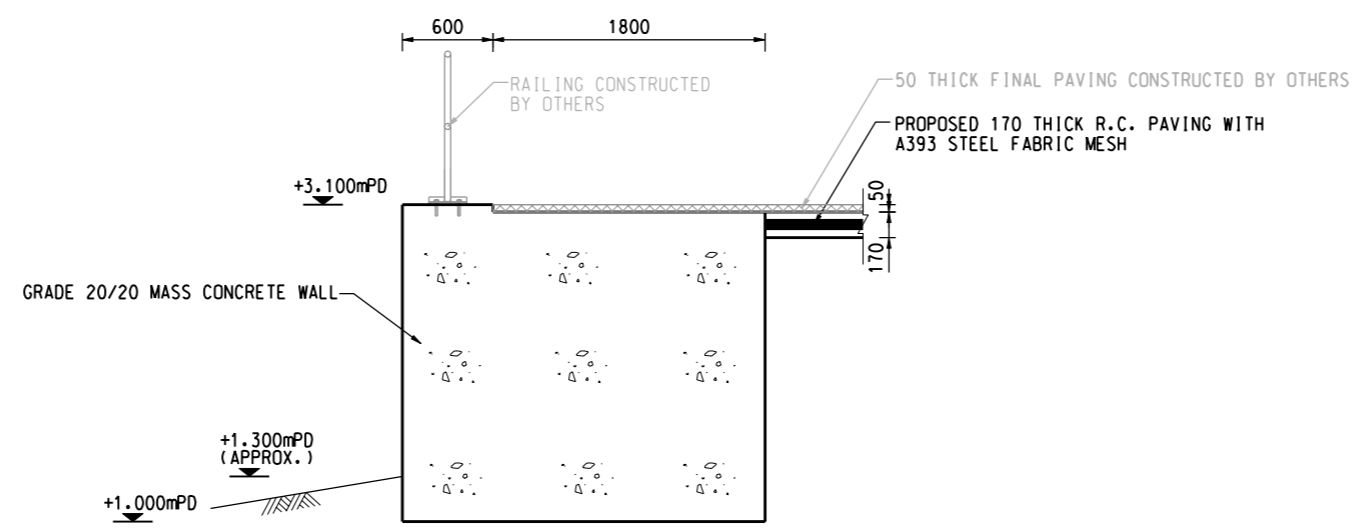

SECTION A - A
 (SECTION B - B SIMILAR)
 SCALE 1 : 25

AECOM

PROJECT
 项目
LEI YUE MUN WATERFRONT ENHANCEMENT PROJECT - ENVIRONMENTAL AND TRAFFIC IMPACT ASSESSMENT STUDIES - INVESTIGATION

CLIENT
 业主
CEDD 土木工程拓展署
 Civil Engineering and Development Department

CONSULTANT
 工程顾问公司
AECOM Asia Company Ltd.
 www.aecom.com

SUB-CONSULTANTS
 分包工程顾问公司

ISSUE/REVISION
 修订

I/R	DATE	DESCRIPTION	CHK.
修订	日期	内容描述	审核

STATUS
 阶段

SCALE 比例: A1 AS SHOWN
DIMENSION UNIT 尺寸单位: MILLIMETRES

KEY PLAN 索引图: A1 1 : 10000

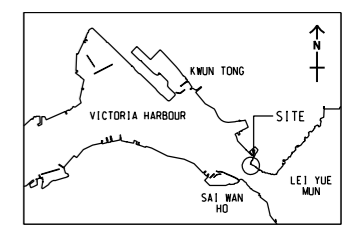

PROJECT NO. 项目编号: 60494885
AGREEMENT NO. 协议编号

SHEET TITLE 图名: IMPROVEMENT WORKS AT LOOKOUT POINT 1

SHEET NUMBER 图号: 60494885/EIA/APPENDIX 2.7

Pld File by: LVP 2018/01/15
 PATH: P:\PROJECTS\60494885\DRAWING\REPORT\EA\EA_407.dgn

This drawing has been prepared for the use of AECOM's client. It may not be used, modified, reproduced or relied upon by third parties, except as agreed by AECOM in writing. AECOM accepts no responsibility, and denies any liability whatsoever, for any party that uses or relies on this drawing without AECOM's express written consent. Do not scale this document. All measurements must be obtained from the stated dimensions.