

LEGEND :

- CHA 1+00.00 CHAINAGE
- PROPOSED ALIGNMENT
- Project Boundary
- Inaccessible Site
- Encroaching Area

Rev.	Description of Revision	Date	Ckd.

Client
 路政署
 HIGHWAYS DEPARTMENT
 WORKS DIVISION

The Engineer
 **MANNINGS**
 (Asia) Consultants Limited

Project
Agreement No. CE 76/2017 (HY)
Upgrading of Remaining
Sections of Kam Tin Road and
Lam Kam Road

Title
Location of Potential
Contamination Site
(Section of Kam Tin Road)

Scale 1:n A1
 As Shown

Drawing No.	Stage	Rev.
Figure 8.1a		

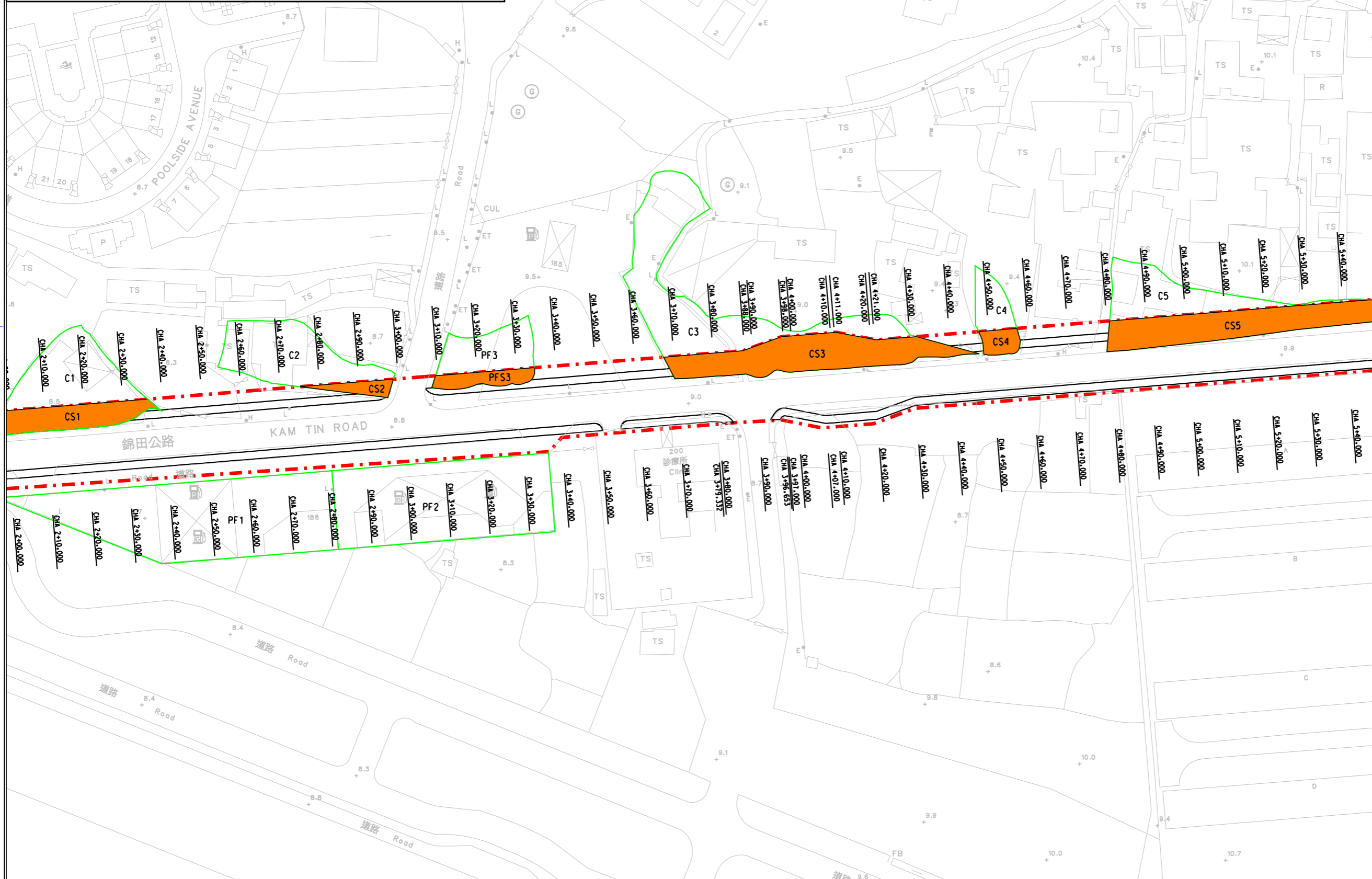
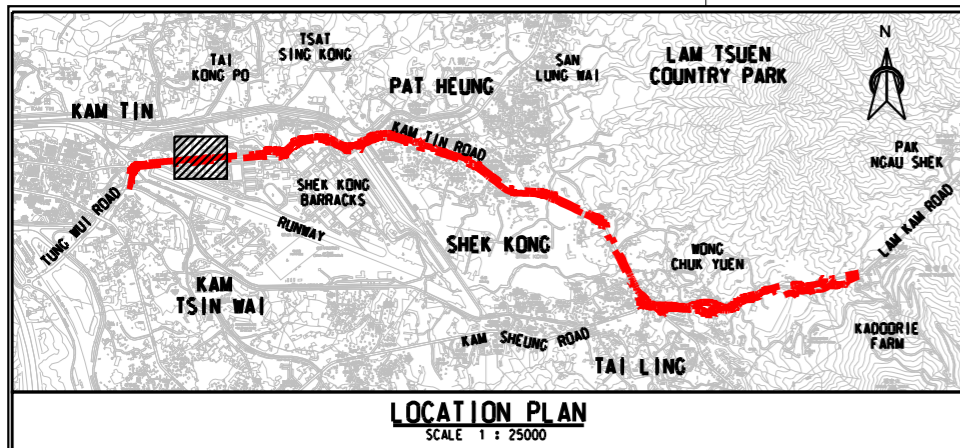

LEGEND :

- CHA 1+00.00 CHAINAGE
- PROPOSED ALIGNMENT
- Project Boundary
- Inaccessible Site
- Encroaching Area

Rev.	Description of Revision	Date	Ckd.

Client
 路政署
 HIGHWAYS DEPARTMENT
 WORKS DIVISION

The Engineer
MANNINGS
 (Asia) Consultants Limited

Project
 Agreement No. CE 76/2017 (HY)
 Upgrading of Remaining
 Sections of Kam Tin Road and
 Lam Kam Road

Title
 Location of Potential
 Contamination Site
 (Section of Kam Tin Road)

Scale in A1 As Shown
 Drawing No. **Figure 8.1b** Stage Rev.

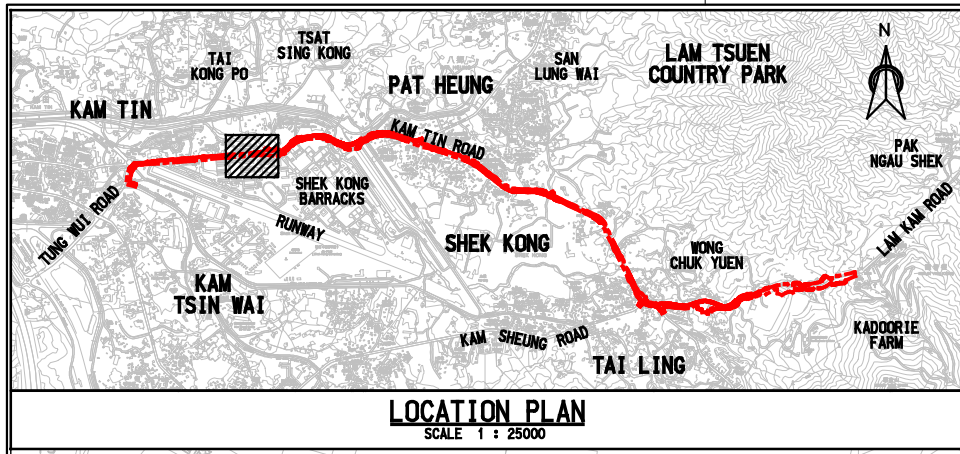

- LEGEND :**
- CHA 1+00.00 CHAINAGE
 - PROPOSED ALIGNMENT
 - Project Boundary
 - Inaccessible Site
 - Encroaching Area

Rev.	Description of Revision	Date	Ckd.

Client

路政署
HIGHWAYS DEPARTMENT
WORKS DIVISION

The Engineer

MANNINGS
(Asia) Consultants Limited

Project

Agreement No. CE 76/2017 (HY)
Upgrading of Remaining
Sections of Kam Tin Road and
Lam Kam Road

Title

Location of Potential
Contamination Site
(Section of Kam Tin Road)

(Sheet 3 of 18)

Scale 1:n A1 As Shown

Drawing No.	Stage	Rev.
Figure 8.1c		

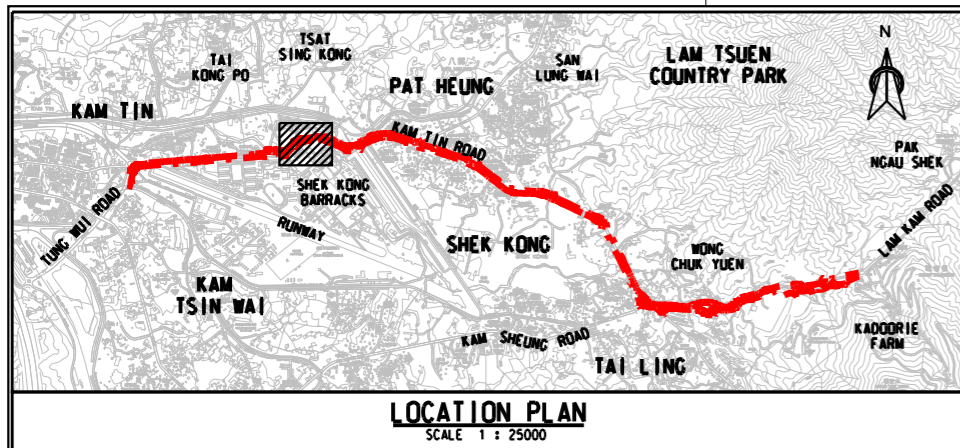

LEGEND :

- CHA 1+00.00 CHAINAGE
- PROPOSED ALIGNMENT
- Project Boundary
- Inaccessible Site
- Encroaching Area

Rev.	Description of Revision	Date	Ckd.

Client

路政署
HIGHWAYS DEPARTMENT
WORKS DIVISION

The Engineer

MANNINGS
(Asia) Consultants Limited

Project

**Agreement No. CE 76/2017 (HY)
Upgrading of Remaining
Sections of Kam Tin Road and
Lam Kam Road**

Title

**Location of Potential
Contamination Site
(Section of Kam Tin Road)**

Scale in A1 **As Shown**

Drawing No.	Stage	Rev.
Figure 8.1d		

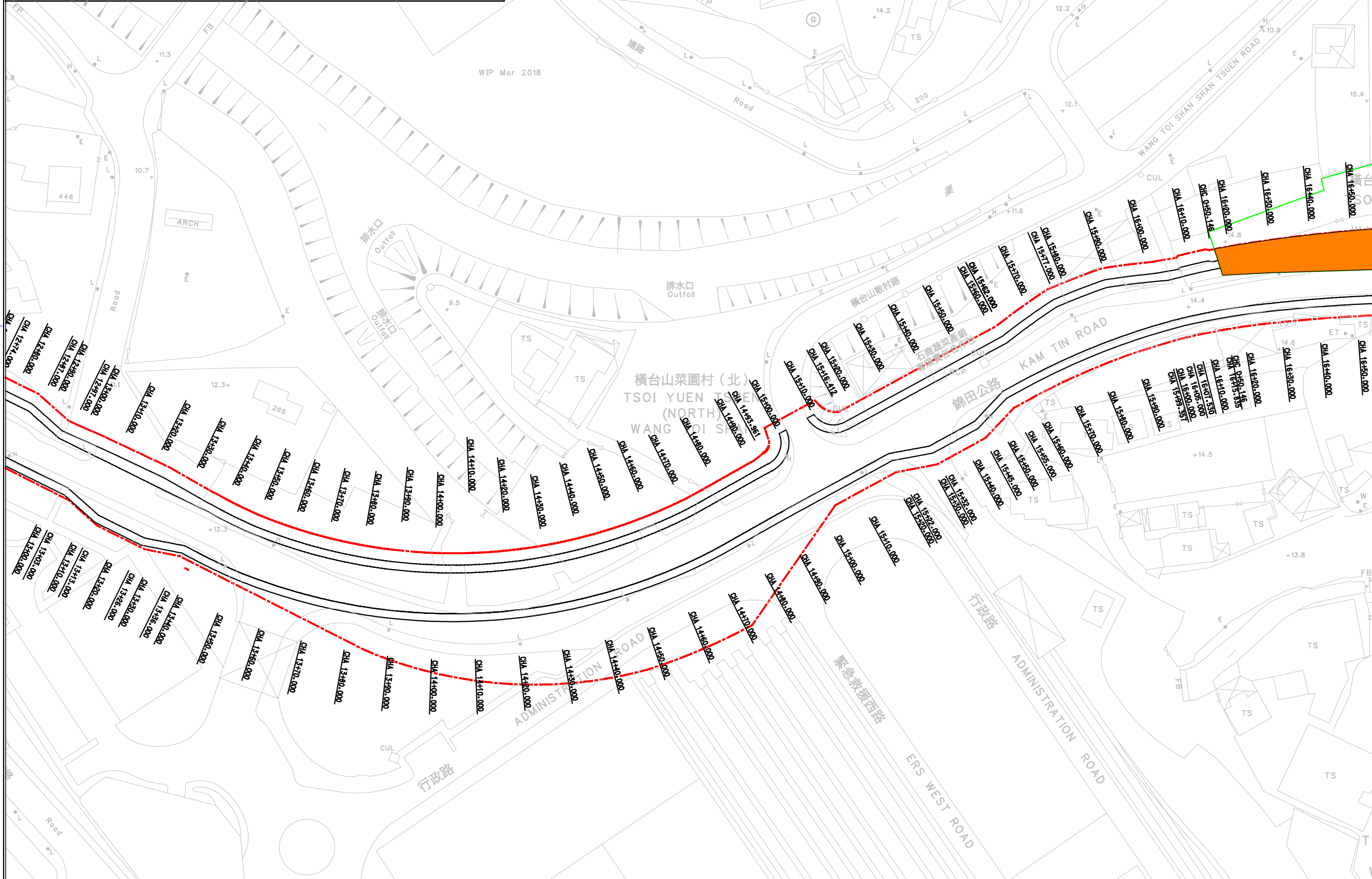
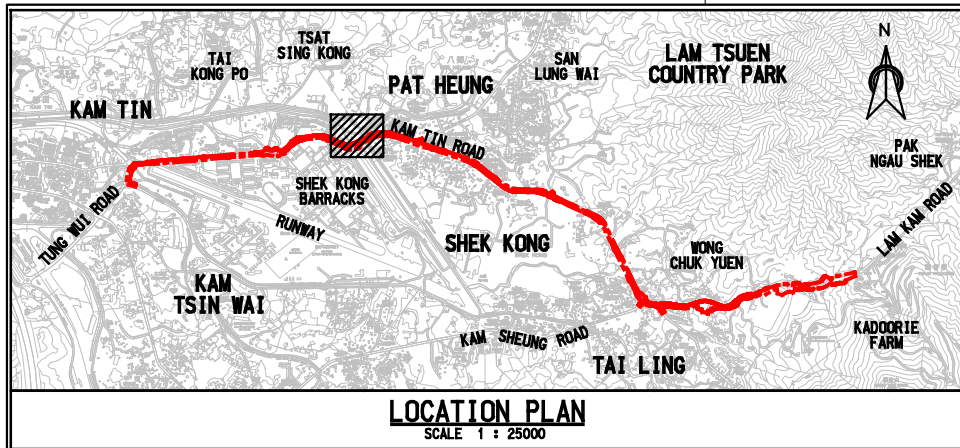

- LEGEND :**
- CHA 1+00.00 CHAINAGE
 - PROPOSED ALIGNMENT
 - Project Boundary
 - Inaccessible Site
 - Encroaching Area

Rev.	Description of Revision	Date	Ckd.

Client

路政署
HIGHWAYS DEPARTMENT
WORKS DIVISION

The Engineer

MANNINGS
(Asia) Consultants Limited

Project

Agreement No. CE 76/2017 (HY)
Upgrading of Remaining
Sections of Kam Tin Road and
Lam Kam Road

Title

Location of Potential
Contamination Site
(Section of Kam Tin Road)

Scale 1:n A1 As Shown

Drawing No. **Figure 8.1e** Stage Rev.

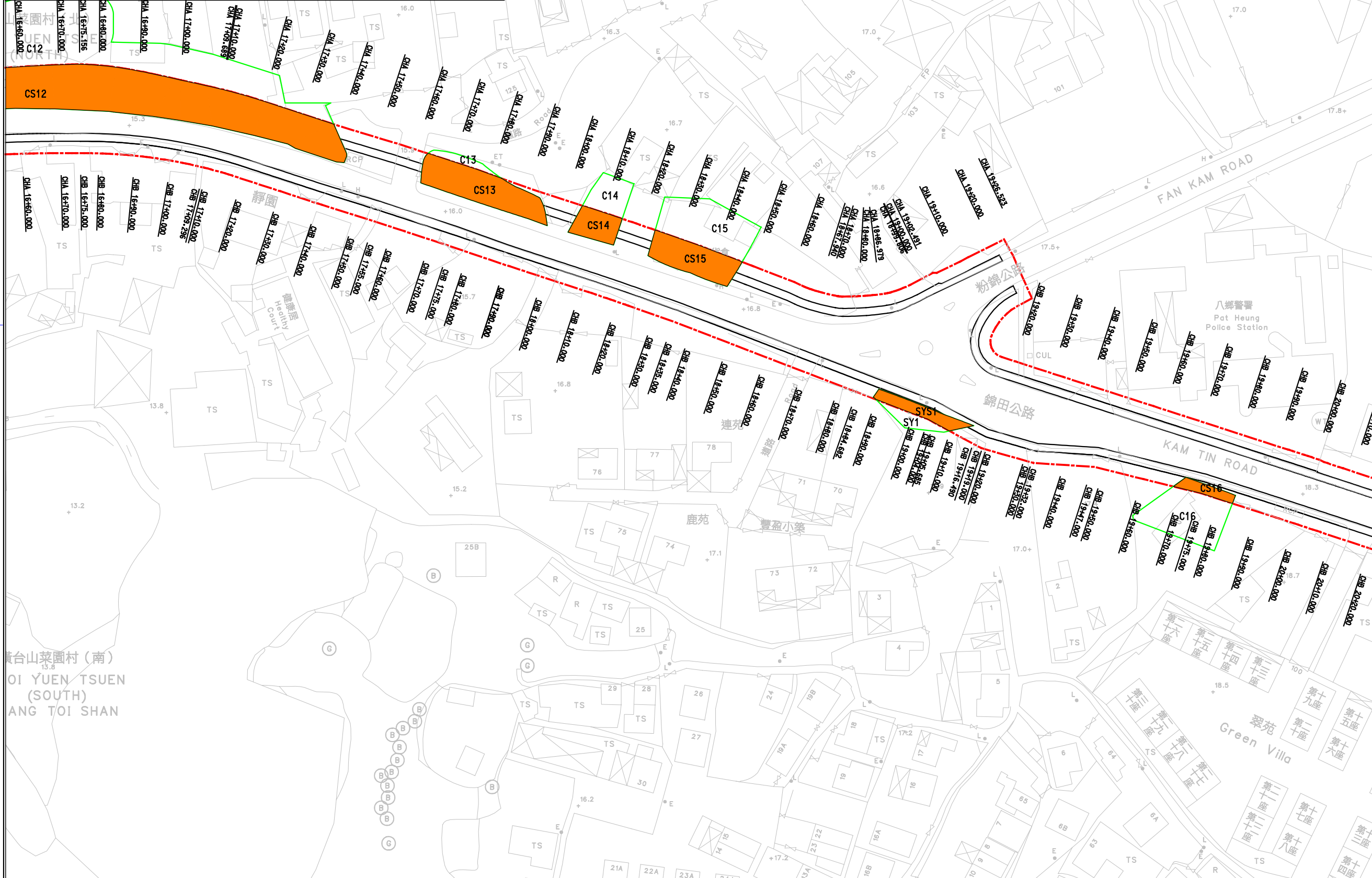
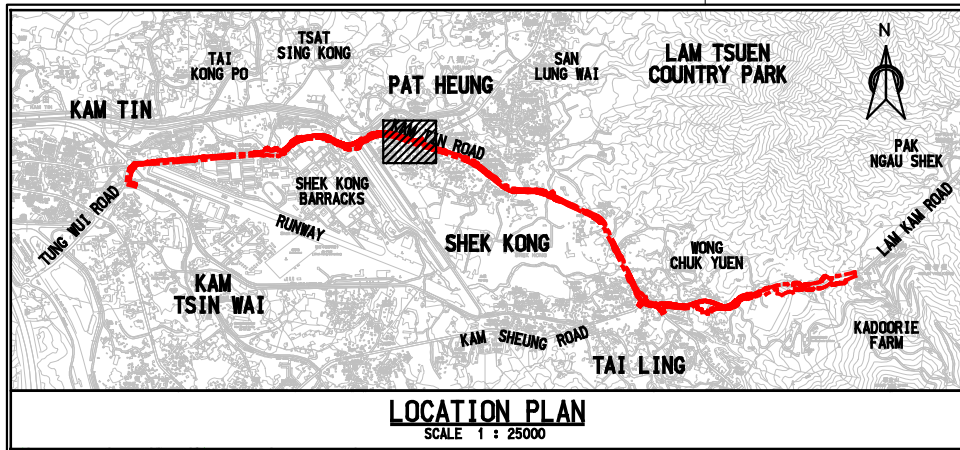

- LEGEND :**
- CHA 1+00.00 CHAINAGE
 - PROPOSED ALIGNMENT
 - Project Boundary
 - Inaccessible Site
 - Encroaching Area

Rev.	Description of Revision	Date	Ckd.

Client
 路政署
 HIGHWAYS DEPARTMENT
 WORKS DIVISION

The Engineer
MANNINGS
 (Asia) Consultants Limited

Project
Agreement No. CE 76/2017 (HY)
Upgrading of Remaining
Sections of Kam Tin Road and
Lam Kam Road

Title
Location of Potential
Contamination Site
(Section of Kam Tin Road)

Scale 1:n A1 As Shown
 Drawing No. **Figure 8.1f** Stage Rev.

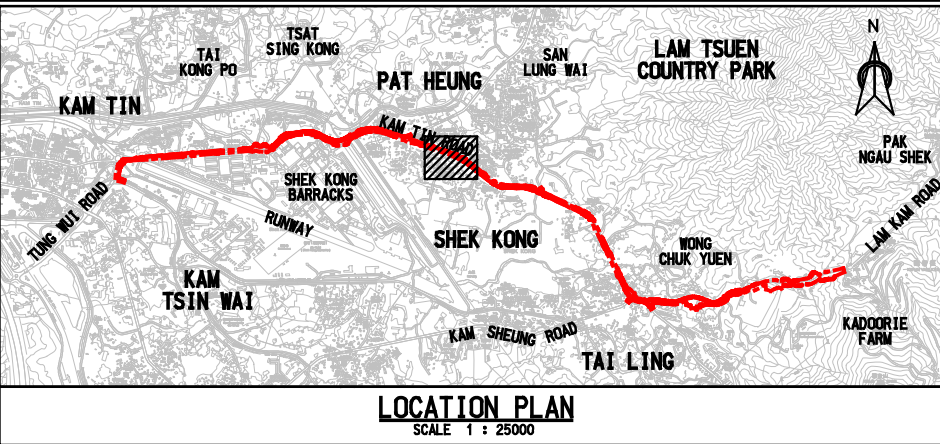
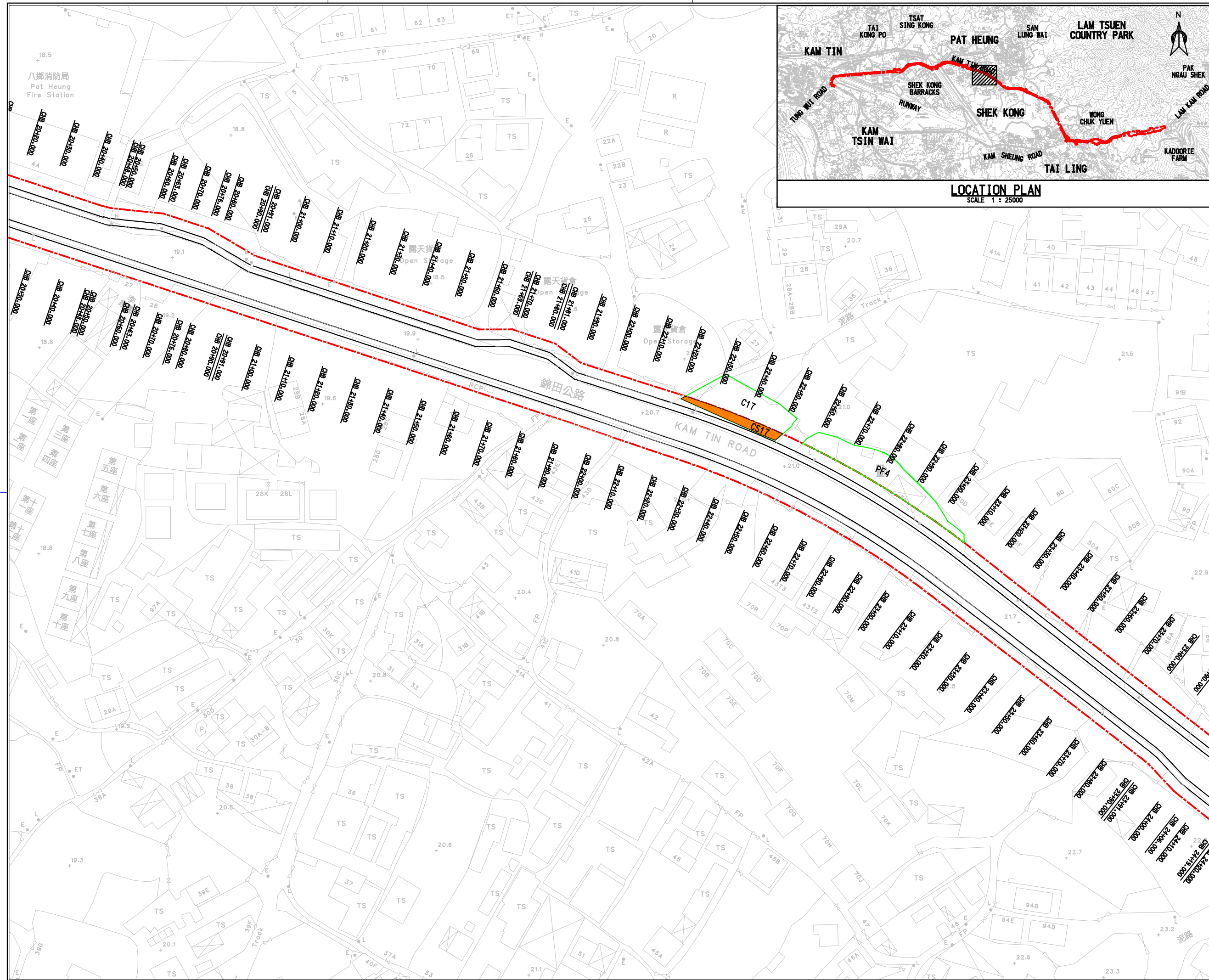

- LEGEND :**
- CHA 1+00.00 CHAINAGE
 - PROPOSED ALIGNMENT
 - Project Boundary
 - Inaccessible Site
 - Encroaching Area

Rev.	Description of Revision	Date	Ckd.

Client

路政署
HIGHWAYS DEPARTMENT
WORKS DIVISION

The Engineer

MANNINGS
(Asia) Consultants Limited

Project

Agreement No. CE 76/2017 (HY)
Upgrading of Remaining
Sections of Kam Tin Road and
Lam Kam Road

Title

Location of Potential
Contamination Site
(Section of Kam Tin Road)

Scale 1:n A1 As Shown

Drawing No.	Stage	Rev.
Figure 8.1g		

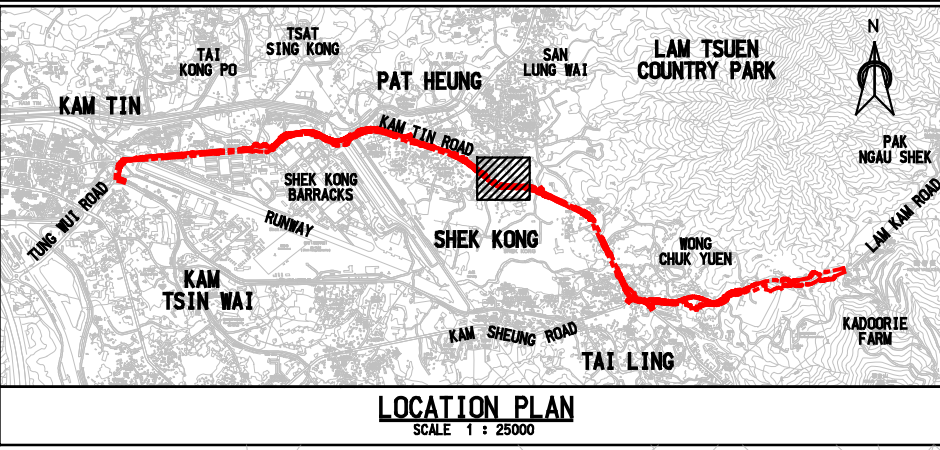
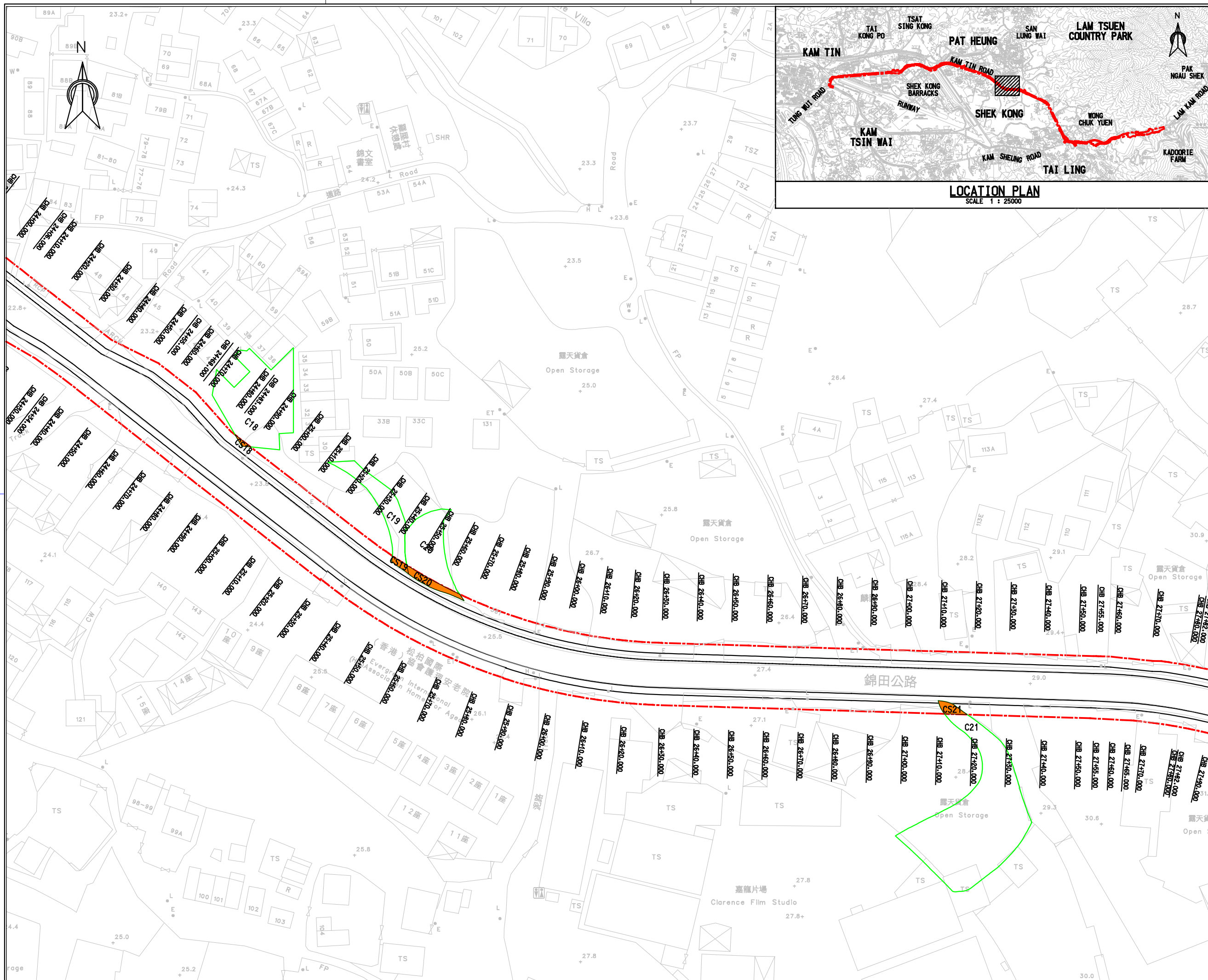

- LEGEND :**
- CHA 1+00.00 CHAINAGE
 - PROPOSED ALIGNMENT
 - Project Boundary
 - Inaccessible Site
 - Encroaching Area

Rev.	Description of Revision	Date	Ckd.

Client

路政署
HIGHWAYS DEPARTMENT
WORKS DIVISION

The Engineer

MANNINGS
(Asia) Consultants Limited

Project

Agreement No. CE 76/2017 (HY)
Upgrading of Remaining
Sections of Kam Tin Road and
Lam Kam Road

Title

Location of Potential
Contamination Site
(Section of Kam Tin Road)

(Sheet 8 of 18)

Scale 1:n A1	As Shown
Drawing No.	Stage Rev.
Figure 8.1h	

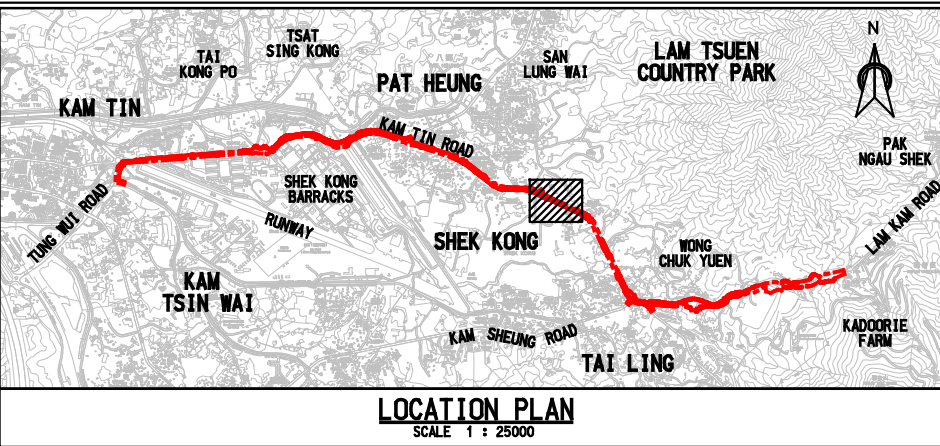
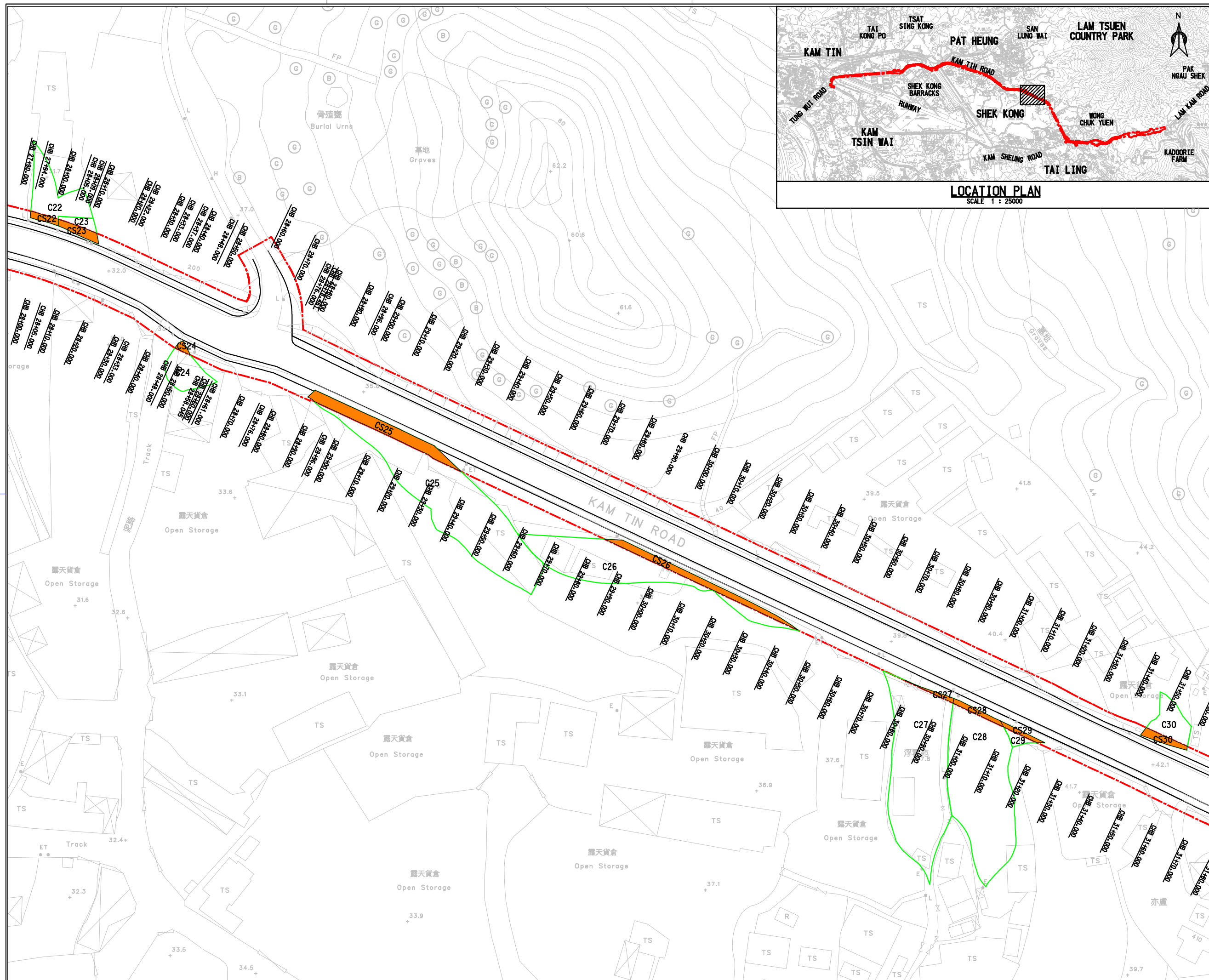

- LEGEND :**
- CHA 1+00.00 CHAINAGE
 - PROPOSED ALIGNMENT
 - Project Boundary
 - Inaccessible Site
 - Encroaching Area

Rev.	Description of Revision	Date	Ckd.

Client
 路政署
 HIGHWAYS DEPARTMENT
 WORKS DIVISION

The Engineer
MANNINGS
 (Asia) Consultants Limited

Project
Agreement No. CE 76/2017 (HY)
Upgrading of Remaining
Sections of Kam Tin Road and
Lam Kam Road

Title
Location of Potential
Contamination Site
(Section of Kam Tin Road)

Scale 1:n A1 As Shown
 Drawing No. **Figure 8.1i** Stage Rev.

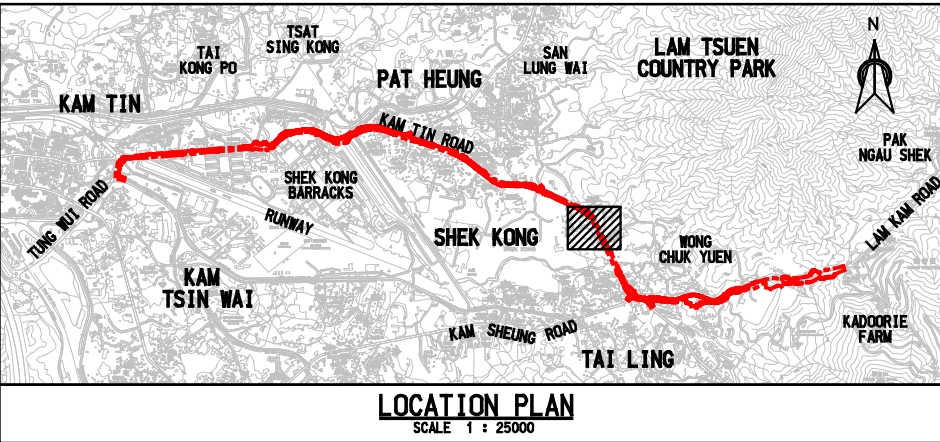
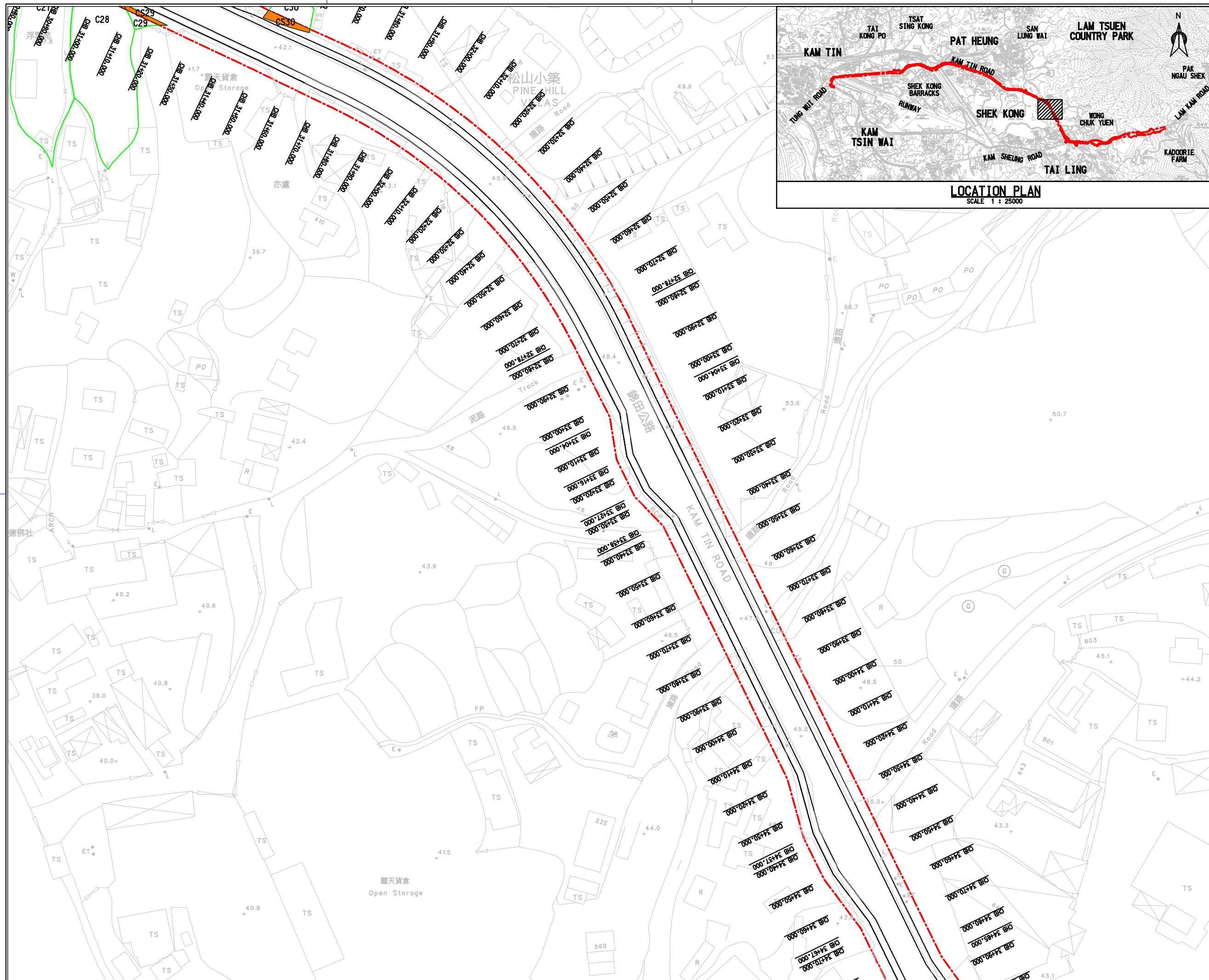

- LEGEND :**
- CHA 1+00.00 CHAINAGE
 - PROPOSED ALIGNMENT
 - Project Boundary
 - Inaccessible Site
 - Encroaching Area

Rev.	Description of Revision	Date	Ckd.

Client

路政署
HIGHWAYS DEPARTMENT
WORKS DIVISION

The Engineer

MANNINGS
(Asia) Consultants Limited

Project

Agreement No. CE 76/2017 (HY)
Upgrading of Remaining
Sections of Kam Tin Road and
Lam Kam Road

Title

Location of Potential
Contamination Site
(Section of Kam Tin Road)

Scale 1:n A1 As Shown

Drawing No. **Figure 8.1j** Stage Rev.

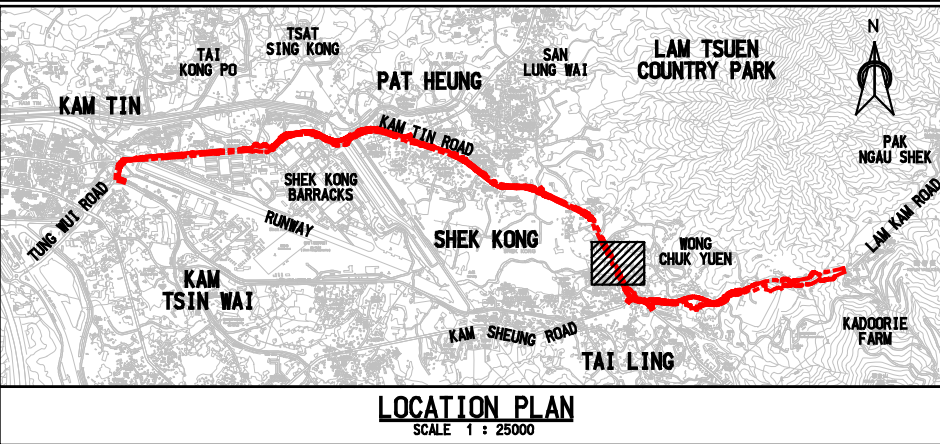
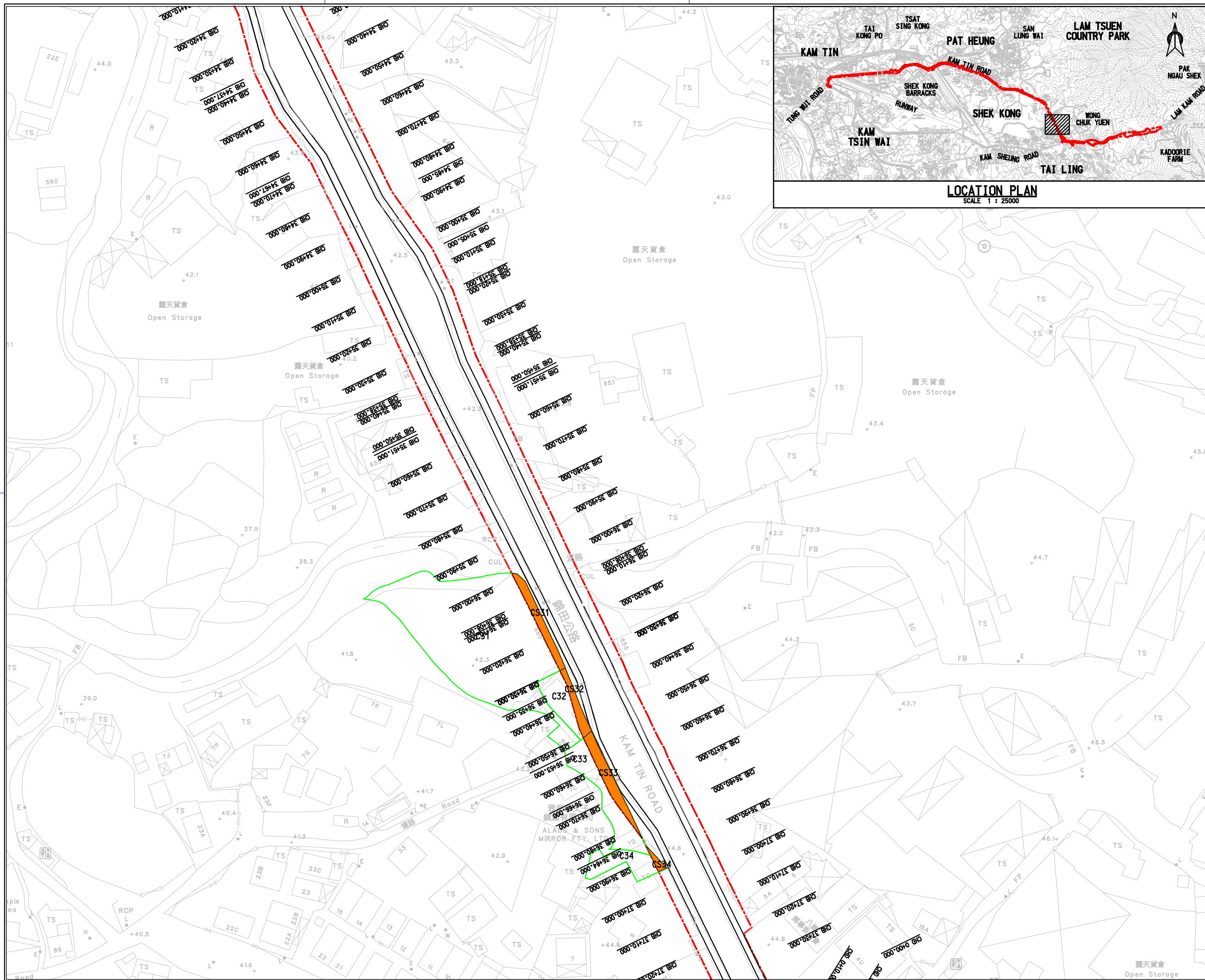

LEGEND :

- CHA 1+00.00 CHAINAGE
- PROPOSED ALIGNMENT
- - - Project Boundary
- ▭ Inaccessible Site
- ▭ Encroaching Area

Rev.	Description of Revision	Date	Ckd.

Client



The Engineer



Project

Agreement No. CE 76/2017 (HY)
Upgrading of Remaining
Sections of Kam Tin Road and
Lam Kam Road

Title

Location of Potential
Contamination Site
(Section of Kam Tin Road)

Scale 1:n A1 As Shown

Drawing No.	Stage	Rev.
Figure 8.1k		

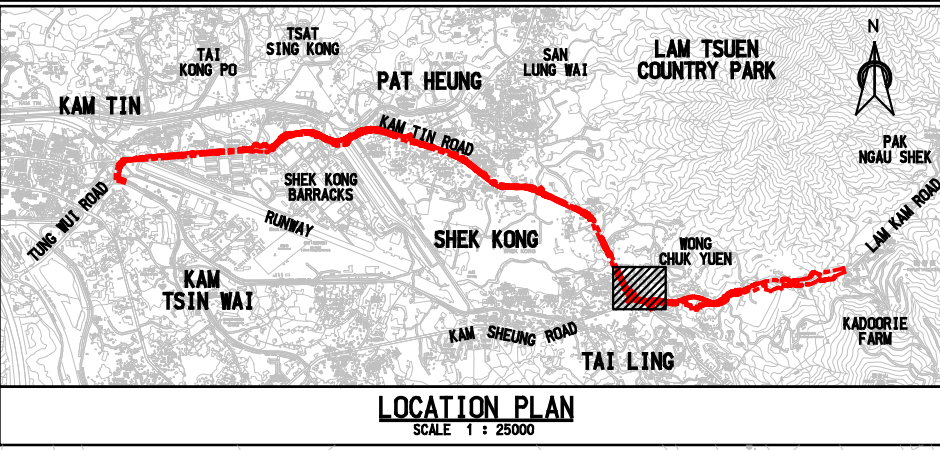
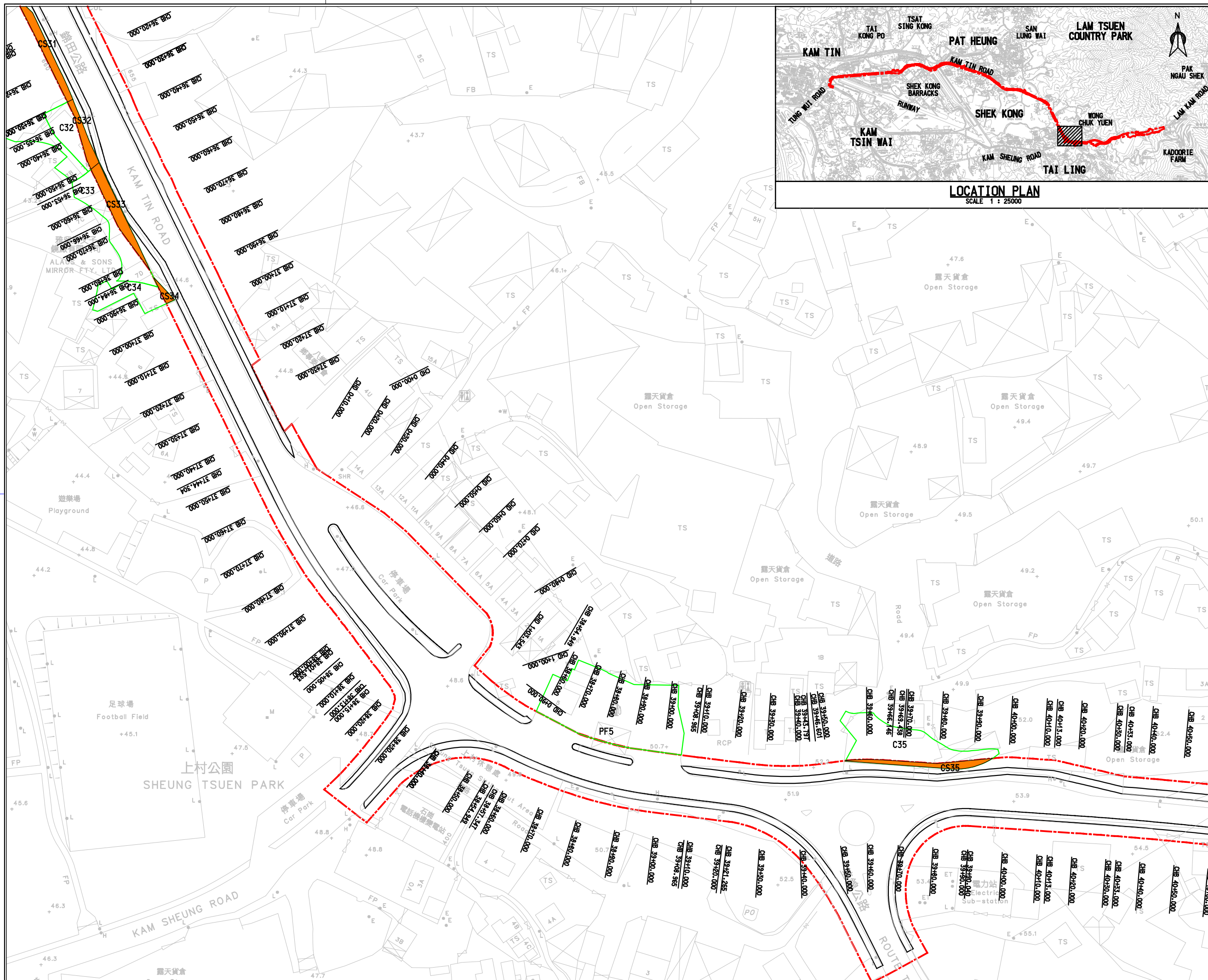

LEGEND :

- CHA 1+00.00 CHAINAGE
- PROPOSED ALIGNMENT
- Project Boundary
- Inaccessible Site
- Encroaching Area

Rev.	Description of Revision	Date	Ckd.

Client

路政署
HIGHWAYS DEPARTMENT
WORKS DIVISION

The Engineer

MANNINGS
(Asia) Consultants Limited

Project

Agreement No. CE 76/2017 (HY)
Upgrading of Remaining
Sections of Kam Tin Road and
Lam Kam Road

Title

Land Requirement Plan
(Section of Kam Tin Road)

Scale 1:n A1 As Shown

Drawing No.	Stage	Rev.
Figure 8.11		

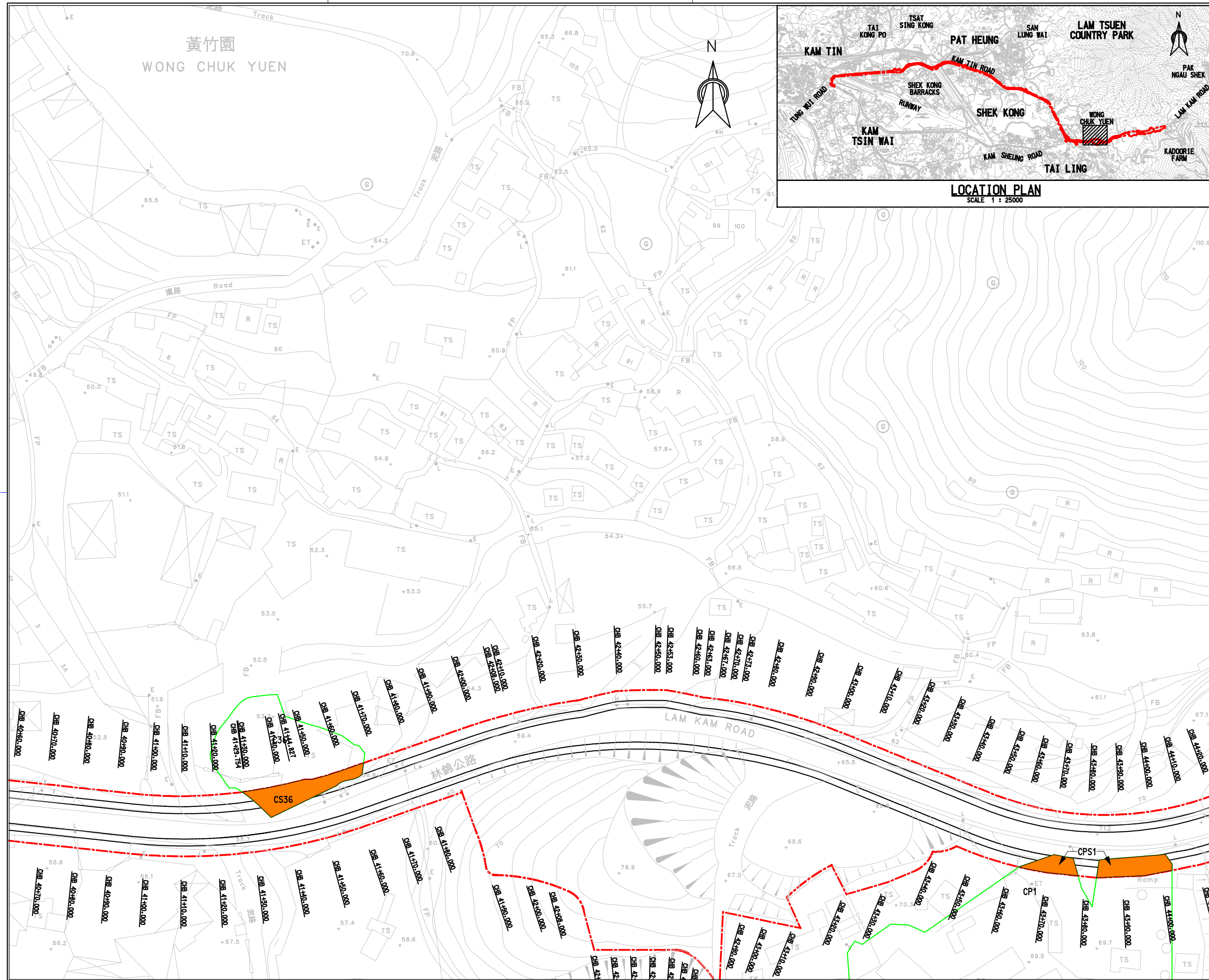

- LEGEND :**
- CHA 1+00.00 CHAINAGE
 - PROPOSED ALIGNMENT
 - - - Project Boundary
 - Inaccessible Site
 - Encroaching Area

Rev.	Description of Revision	Date	Ckd.
------	-------------------------	------	------

Client



路政署
HIGHWAYS DEPARTMENT
WORKS DIVISION

The Engineer



MANNINGS
(Asia) Consultants Limited

Project

Agreement No. CE 76/2017 (HY)
Upgrading of Remaining
Sections of Kam Tin Road and
Lam Kam Road

Title

Location of Potential
Contamination Site
(Section of Lam Kam Road)

(Sheet 13 of 18)

Scale 1:n A1	As Shown
Drawing No.	Stage Rev.
Figure 8.1m	

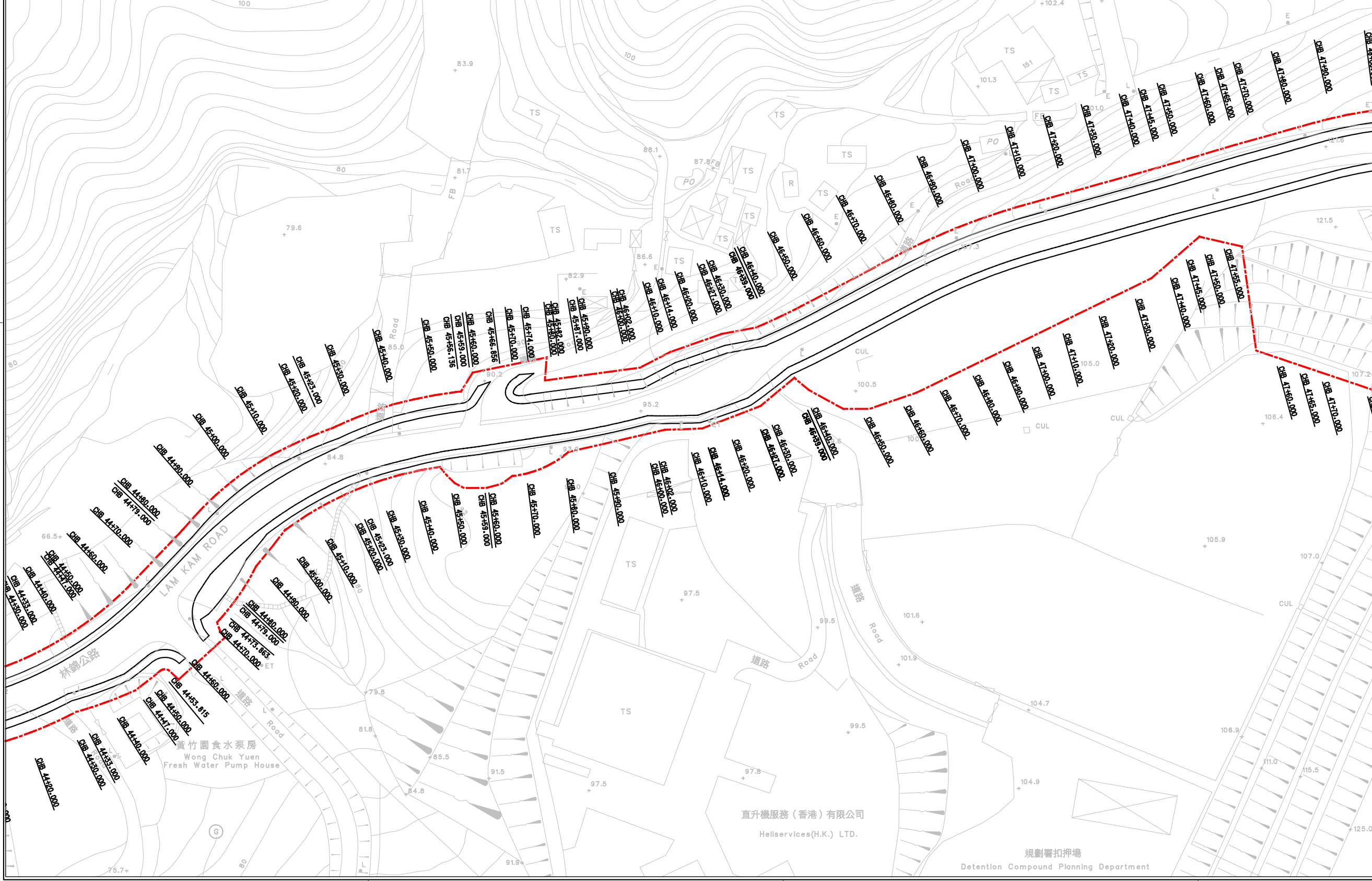
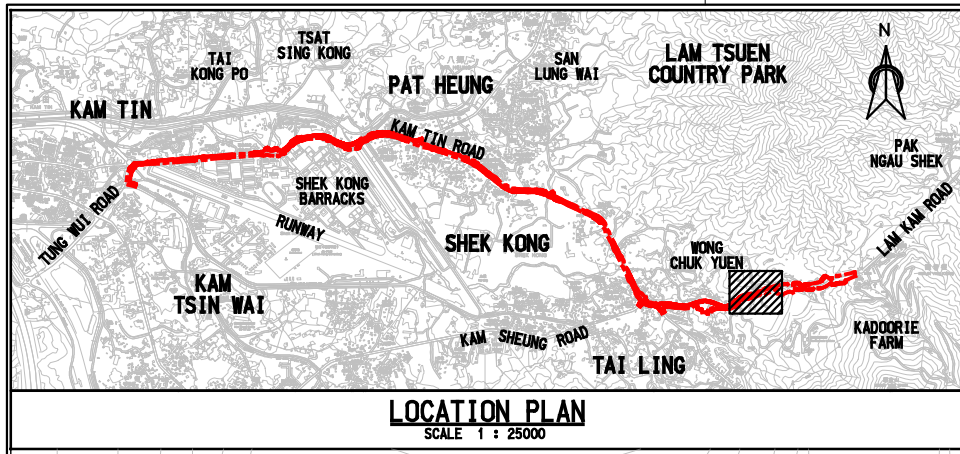

- LEGEND :**
- CHA 1+00.00 CHAINAGE
 - PROPOSED ALIGNMENT
 - Project Boundary
 - Inaccessible Site
 - Encroaching Area

Rev.	Description of Revision	Date	Ckd.

Client

路政署
HIGHWAYS DEPARTMENT
WORKS DIVISION

The Engineer

MANNINGS
(Asia) Consultants Limited

Project

**Agreement No. CE 76/2017 (HY)
Upgrading of Remaining
Sections of Kam Tin Road and
Lam Kam Road**

Title

**Location of Potential
Contamination Site
(Section of Lam Kam Road)**

(Sheet 14 of 18)

Scale 1:n A1 As Shown

Drawing No. **Figure 8.1n** Stage Rev.

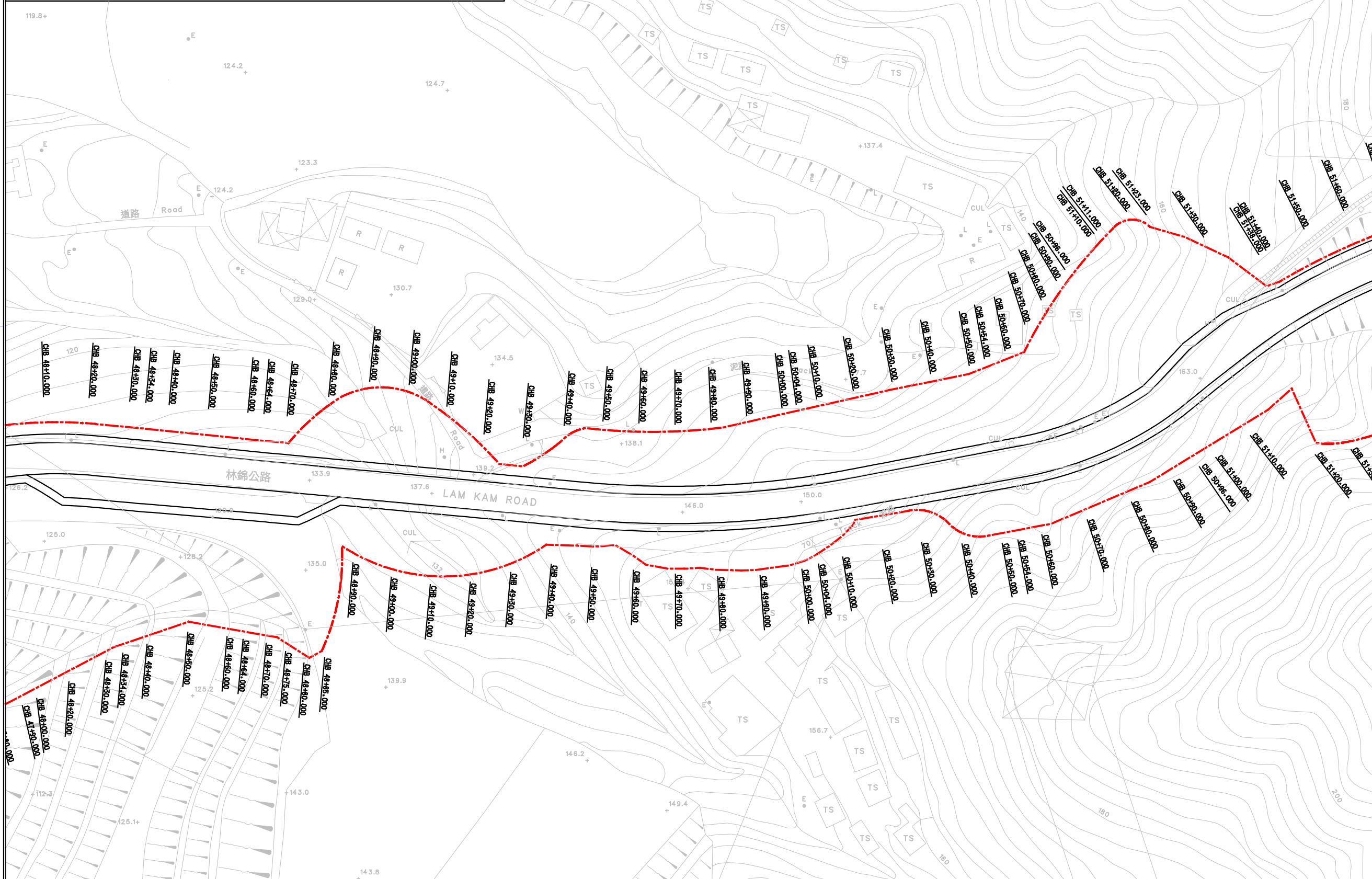
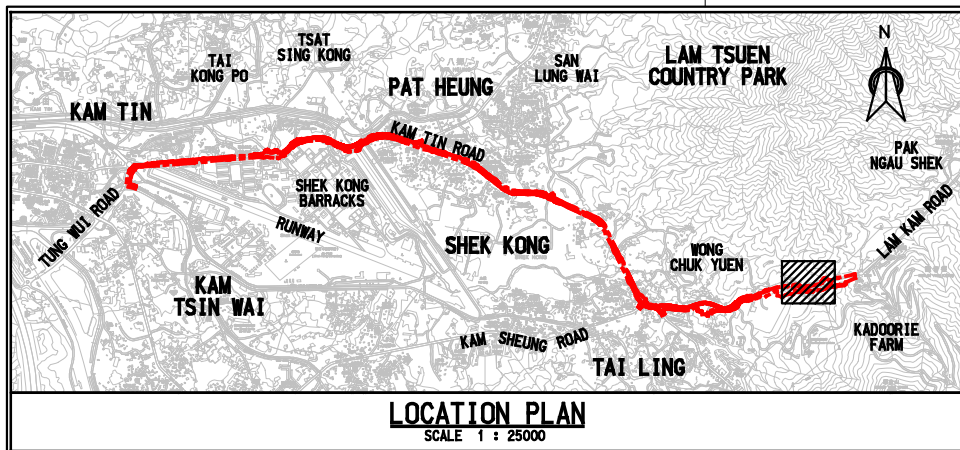

- LEGEND :**
- CHA 1+00.00 CHAINAGE
 - PROPOSED ALIGNMENT
 - Project Boundary
 - Inaccessible Site

Rev.	Description of Revision	Date	Ckd.

Client
 路政署
 HIGHWAYS DEPARTMENT
 WORKS DIVISION

The Engineer
MANNINGS
 (Asia) Consultants Limited

Project
 Agreement No. CE 76/2017 (HY)
 Upgrading of Remaining
 Sections of Kam Tin Road and
 Lam Kam Road

Title
 Location of Potential
 Contamination Site
 (Section of Lam Kam Road)

Scale 1:n A1 As Shown
 Drawing No. **Figure 8.10** Stage Rev.

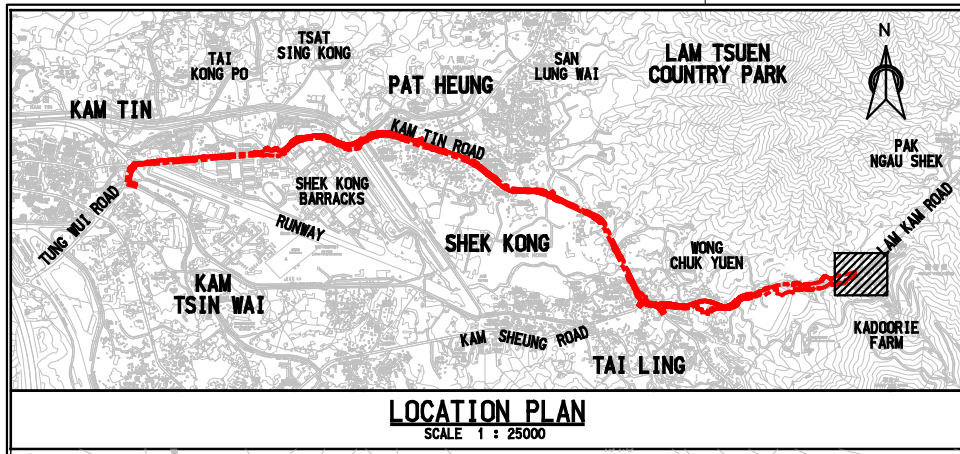

- LEGEND :**
- CHA 1+00.00 CHAINAGE
 - PROPOSED ALIGNMENT
 - Project Boundary
 - Inaccessible Site
 - Encroaching Area

Rev.	Description of Revision	Date	Ckd.

Client

路政署
HIGHWAYS DEPARTMENT
WORKS DIVISION

The Engineer

MANNINGS
(Asia) Consultants Limited

Project

**Agreement No. CE 76/2017 (HY)
Upgrading of Remaining
Sections of Kam Tin Road and
Lam Kam Road**

Title

**Location of Potential
Contamination Site
(Section of Lam Kam Road)**

(Sheet 16 of 16)

Scale 1:n A1	As Shown
Drawing No.	Stage Rev.
Figure 8.1p	