

KEY PLAN (1:40000)

LEGEND		Proposed Mitigation Measures (MM)
	MM1	Tree Protection and Preservation
	MM2	Tree Transplanting – Recipient Site
	MM3	Compensatory Planting and New Tree Planting – Planting Area
	MM4	Roadside Greening
	MM5	Screen Planting
	MM6	Landscape Treatment on Man Made Slope/ Retaining Structure
	MM7	Noise Barrier Treatments
	MM8	Minimise Light Pollution and Glare – *Applicable throughout project site and works
(Not on figure*)	MM9	Hoarding of Construction Works – Along works boundaries as required
	MM10	Enhancement of Semi-natural Stream
	MM11	Landscape Work & Green Roof for Infrastructure
	MM12	Woodland Enhancement Planting with Ecological Enhancement

*Mitigation Measure(s) (MM) does/ do not include in this plan is/are considered good practice throughout the Project

*Mitigation Measure(s) (MM) does/ do not include in this plan is/are considered good practice throughout the Project

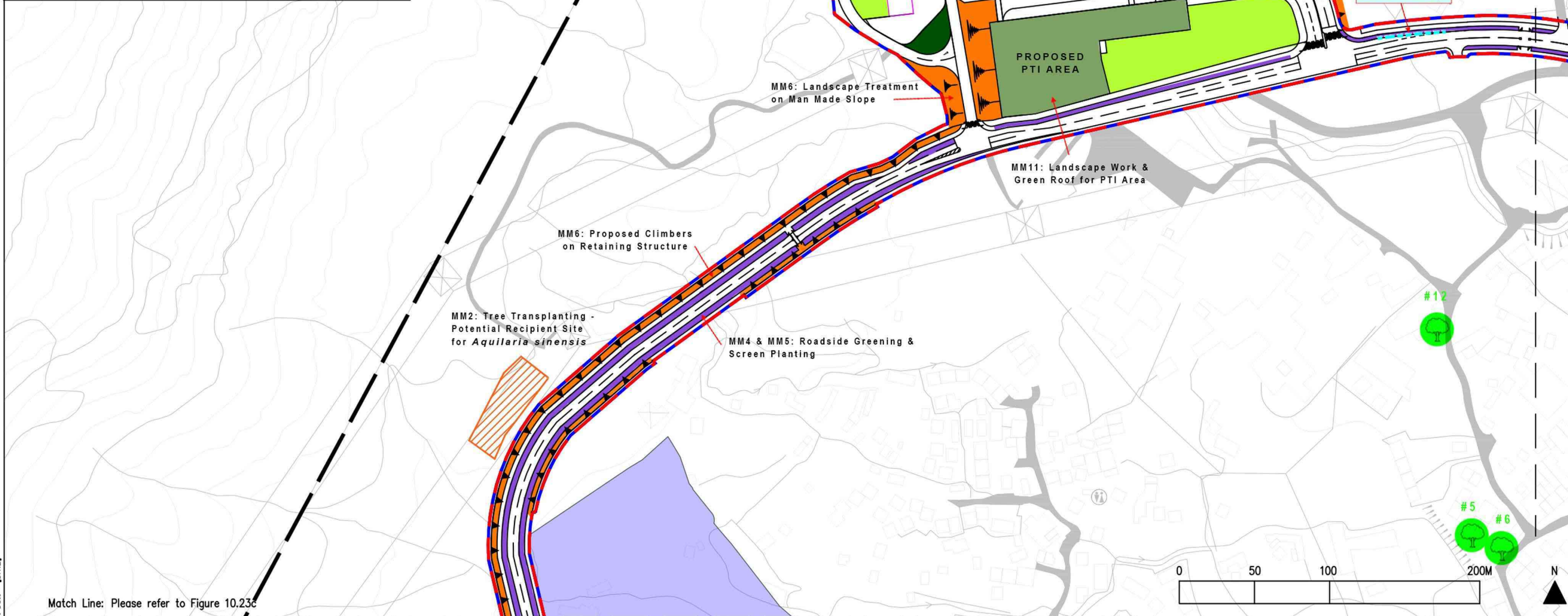

© Copyright by Black & Veatch Hong Kong Limited

Legend

- Proposed Development Area Boundary
- Project Site Boundary
- Interfacing Housing Sites Under Tuen Mun Area 54
- Retained Tree of Large Size
- Retaining Structure
- Slope
- Tentative Open Space
- Architectural Treatment for Project Proposed Built Structure

Note: The size of tree protection zone is indicative only, subject to the tree crown size

Remarks: The layout is for EIA purpose and subject to review and change

Revision	Date	Description	Initial
06	07/07/2020	Design	Gordon Li
07	28/05/2020	Draw	Gordon Li

Approved: _____

Project title: AGREEMENT NO. CE68/2017 (CE) SITE FORMATION AND INFRASTRUCTURAL WORKS FOR THE DEVELOPMENT AT SAN HING ROAD AND HONG PO ROAD, TUEN MUN – FEASIBILITY STUDY

Drawing title: Landscape Mitigation Plan (Sheet 1 of 5)

Drawing No. Figure 10.24a	Scale 1:3000 (in A3)
---------------------------	----------------------

土木 工程 拓展 署
CEDD Civil Engineering and Development Department

BLACK & VEATCH HONG KONG LIMITED
博 達 工 程 有 限 公 司

Plot Date = \$DATE\$

CAD Filename = \$FILES\$