

- Legend**
- ▬ Proposed Development Area Boundary
 - ▬ Project Site Boundary
 - ⋯ Assessment Area for Cultural Heritage (50m)
 - ▬ Site of Archaeological Interest
 - ▬ Site Layout
 - ▨ Area1
 - ▨ Area2
 - ▨ Area3
 - ▨ Area4
 - ▨ Area5

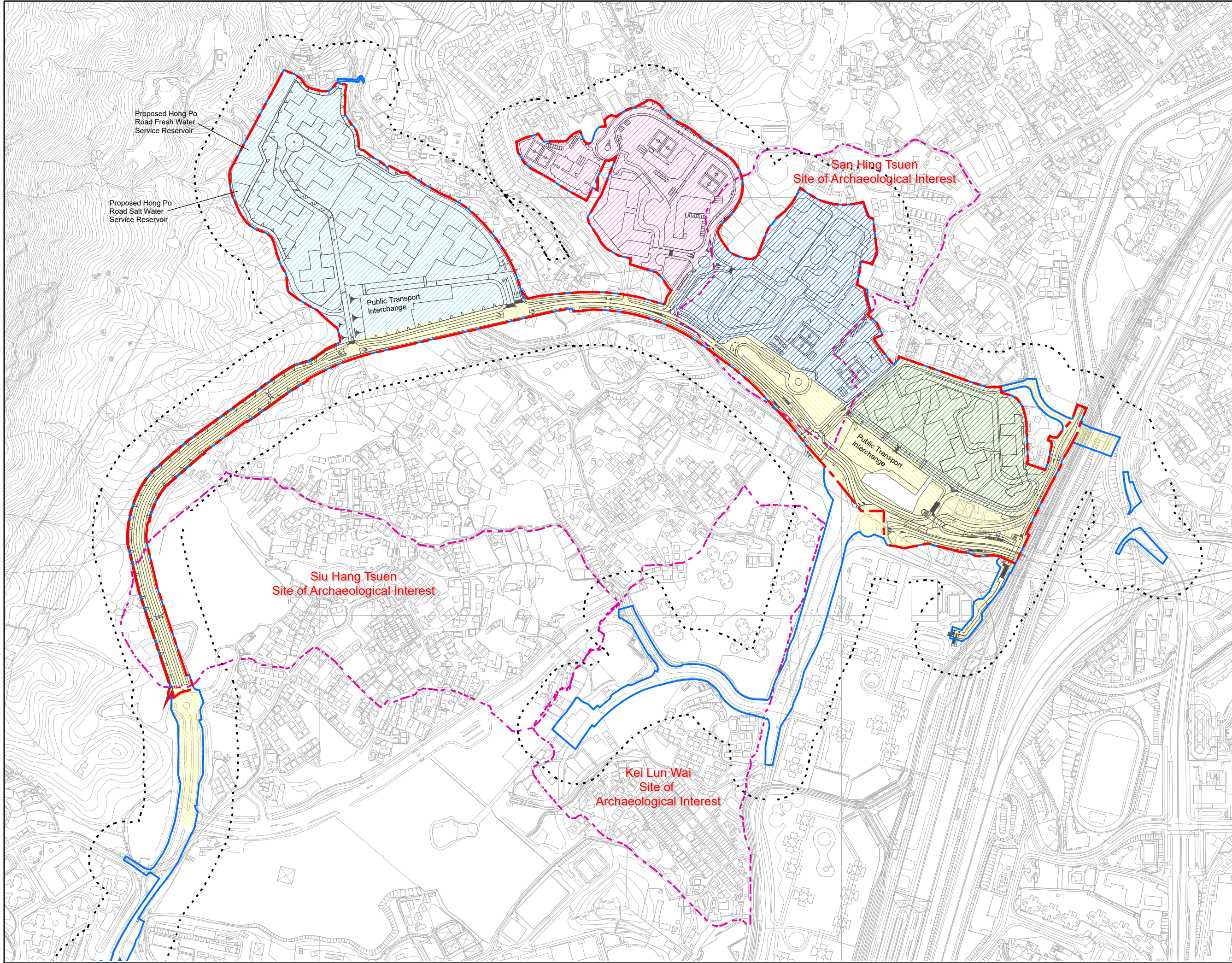

Note:
The layout is for EIA purpose and subject to review and change.

Revision	Description			
	Designed	Reviewed	Drawn	Checked
Initial	AA	ET	Wing	ET
Date	07/20	07/20	07/20	07/20

Approved

Agreement No. **CE68/2017 (CE)**

Project Title
Site Formation and Infrastructural Works for the Development at San Hing Road and Hong Po Road Tuen Mun - Feasibility Study

Figure Title
Housing Development, School Site and Associated Works (Area 1 - 5)

Drawing No. **Figure 13.1** Revision **-**

Scale
A3: 1:5,000

Client
CEDD 土木工程拓展署
Civil Engineering and Development Department

Consultant
BLACK & VEATCH