

- LEGEND :**
- BOUNDARY LINE OF NEW ACUTE HOSPITAL AT KAI TAK DEVELOPMENT AREA
  - PROPOSED ROOFTOP HELIPAD
  - ACUTE BLOCK
  - RESIDENTIAL (LAND USES ACCORDING TO THE APPROVED KAI TAK OUTLINE ZONING PLAN)
  - COMMERCIAL (LAND USES ACCORDING TO THE APPROVED KAI TAK OUTLINE ZONING PLAN)
  - E01 EXISTING NOISE SENSITIVE RECEIVERS
  - P01 PLANNED NOISE SENSITIVE RECEIVERS
  - 100mPD BUILDING HEIGHT RESTRICTION
  - APPROACH / TAKE-OFF ZONE
  - HELICOPTER NOISE CONTOUR LINE (LATERAL MOVEMENT) (Lmax, dB(A)) AT +118.2mPD

Rev	Amendment	By	Dk.	App.	Date

Client

Architect  
**WONG TUNG & PARTNERS LIMITED**  
 ARCHITECTS & PLANNERS  
  
 18th Floor, Cityplaza 3, Taikoo Shing, Hong Kong  
 T: 852 2803 9888 F: 852 2513 1728 www.wongtung.com

Project  
  
 Meinhardt Infrastructure and Environment Limited  
 邁達基環境工程顧問有限公司

Title  
 A ROOFTOP HELIPAD AT NEW ACUTE HOSPITAL AT KAI TAK DEVELOPMENT AREA

HELIROPTER NOISE CONTOUR (LATERAL MOVEMENT) AT +118.2 MPD

Status		Checked		Approved	
Drawn	CAD				
Scale	AS SHOWN (A3)	CAD File Name		First Issued	MAY 2019
		Drawing No.		Rev.	

FIGURE 5.7a



- LEGEND :**
- BOUNDARY LINE OF NEW ACUTE HOSPITAL AT KAI TAK DEVELOPMENT AREA
  - PROPOSED ROOFTOP HELIPAD
  - ACUTE BLOCK
  - RESIDENTIAL (LAND USES ACCORDING TO THE APPROVED KAI TAK OUTLINE ZONING PLAN)
  - COMMERCIAL (LAND USES ACCORDING TO THE APPROVED KAI TAK OUTLINE ZONING PLAN)
  - E01 EXISTING NOISE SENSITIVE RECEIVERS
  - P01 PLANNED NOISE SENSITIVE RECEIVERS
  - 100mPD BUILDING HEIGHT RESTRICTION
  - APPROACH / TAKE-OFF ZONE
  - HELICOPTER NOISE CONTOUR LINE (LATERAL MOVEMENT) (Lmax, dB(A)) AT +98.2mPD

Rev	Amendment	By	Dk.	App.	Date

Client

Architect  
**WONG TUNG & PARTNERS LIMITED**  
 ARCHITECTS & PLANNERS  
  
 18th Floor, Cityplaza 3, Taikoo Shing, Hong Kong  
 T: 852 2803 9888 F: 852 2513 1728 www.wongtung.com

Project  
  
 Meinhardt Infrastructure and Environment Limited  
 邁達基環境工程顧問有限公司

Title  
 A ROOFTOP HELIPAD AT NEW ACUTE HOSPITAL AT KAI TAK DEVELOPMENT AREA

Status  
 HELICOPTER NOISE CONTOUR (LATERAL MOVEMENT) AT +98.2 MPD

Drawn	CAD	Checked	-	Approved	-
Scale	AS SHOWN (A3)	CAD File Name	First Issued	MAY 2019	
© Copyright Reserved		Drawing No.			

**FIGURE 5.7b**

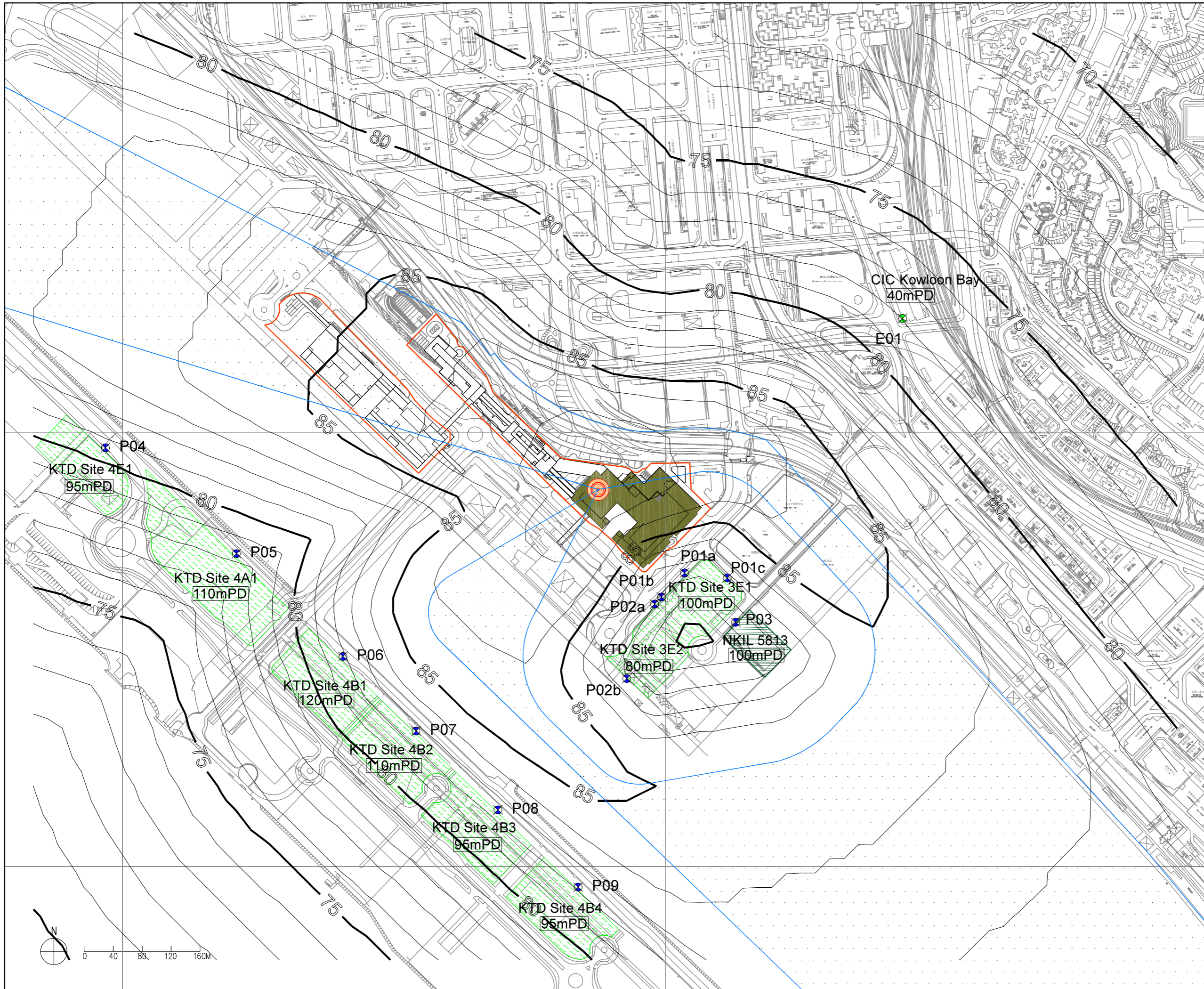

- LEGEND :**
- BOUNDARY LINE OF NEW ACUTE HOSPITAL AT KAI TAK DEVELOPMENT AREA
  - PROPOSED ROOFTOP HELIPAD
  - ACUTE BLOCK
  - RESIDENTIAL (LAND USES ACCORDING TO THE APPROVED KAI TAK OUTLINE ZONING PLAN)
  - COMMERCIAL (LAND USES ACCORDING TO THE APPROVED KAI TAK OUTLINE ZONING PLAN)
  - E01 EXISTING NOISE SENSITIVE RECEIVERS
  - P01 PLANNED NOISE SENSITIVE RECEIVERS
  - 100mPD BUILDING HEIGHT RESTRICTION
  - APPROACH / TAKE-OFF ZONE
  - HELICOPTER NOISE CONTOUR LINE (LATERAL MOVEMENT) (Lmax, dB(A)) AT +38.2mPD

Rev	Amendment	By	Dk.	App.	Date

Client

Architect  
**WONG TUNG & PARTNERS LIMITED**  
 ARCHITECTS & PLANNERS  
  
 18th Floor, Cityplaza 3, Taikoo Shing, Hong Kong  
 T: 852 2803 9888 F: 852 2513 1728 www.wongtung.com

Project  
  
 Meinhardt Infrastructure and Environment Limited  
 邁達基環境工程顧問有限公司

Title  
 A ROOFTOP HELIPAD AT NEW ACUTE HOSPITAL AT KAI TAK DEVELOPMENT AREA

HELIROPTER NOISE CONTOUR (LATERAL MOVEMENT) AT +38.2 MPD

Drawn	CAD	Checked	-	Approved	-
Scale	AS SHOWN (A3)	CAD File Name	First Issued	MAY 2019	
Copyright Reserved		Drawing No.	FIGURE 5.7c		

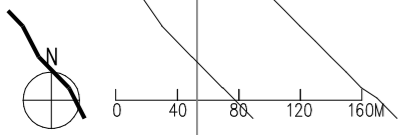

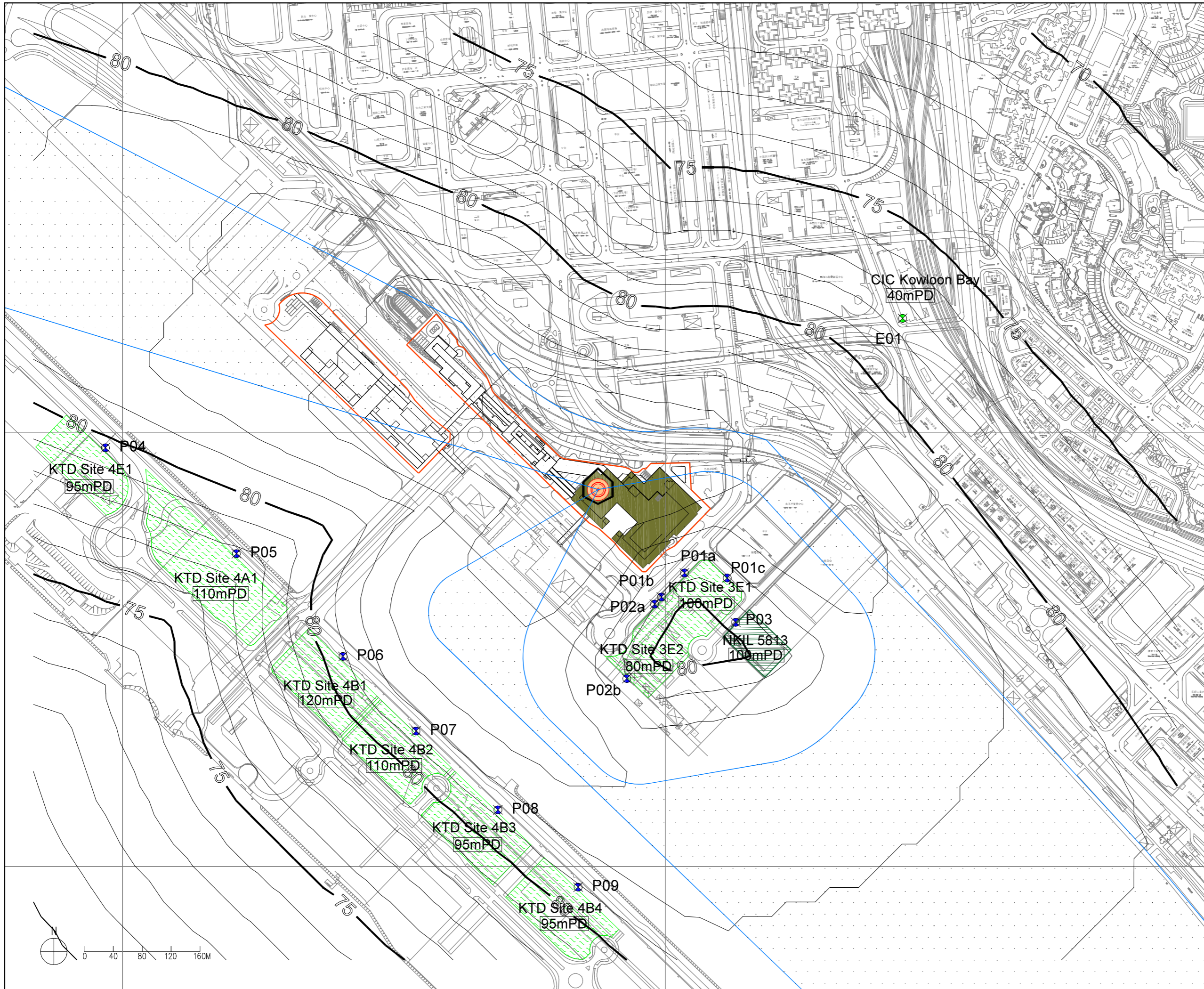

- LEGEND :**
- BOUNDARY LINE OF NEW ACUTE HOSPITAL AT KAI TAK DEVELOPMENT AREA
  - PROPOSED ROOFTOP HELIPAD
  - ACUTE BLOCK
  - RESIDENTIAL (LAND USES ACCORDING TO THE APPROVED KAI TAK OUTLINE ZONING PLAN)
  - COMMERCIAL (LAND USES ACCORDING TO THE APPROVED KAI TAK OUTLINE ZONING PLAN)
  - E01 EXISTING NOISE SENSITIVE RECEIVERS
  - P01 PLANNED NOISE SENSITIVE RECEIVERS
  - 100mPD BUILDING HEIGHT RESTRICTION
  - APPROACH / TAKE-OFF ZONE
  - HELICOPTER NOISE CONTOUR LINE (LATERAL MOVEMENT) (Lmax, dB(A)) AT +5.7mPD

Rev	Amendment	By	Dk.	App.	Date

Client

Architect  
**WONG TUNG & PARTNERS LIMITED**  
 ARCHITECTS & PLANNERS  
  
 18th Floor, Cityplaza 3, Taikoo Shing, Hong Kong  
 T: 852 2803 9888 F: 852 2513 1728 www.wongtung.com

Project  
  
 Meinhardt Infrastructure and Environment Limited  
 邁達基環境工程顧問有限公司

Title  
 A ROOFTOP HELIPAD AT NEW ACUTE HOSPITAL AT KAI TAK DEVELOPMENT AREA

HELIкоPTER NOISE CONTOUR (LATERAL MOVEMENT) AT +5.7 MPD

Status			
Drawn	CAD	Checked	Approved
Scale	AS SHOWN (A3)	CAD File Name	First Issued
			MAY 2019
		Drawing No.	Rev.

FIGURE 5.7d