

***Appendix 3.5 – Detailed Calculation of
Emissions from Portals, Underpass Top
Openings, Ventilation Building
and Ventilation Exhausts***

Calculation of Portal Emission and Emissions of Underpass Top Openings, Ventilation Buildings and Ventilation Exhausts

Description	Percentage from Portal	Length (m)	Source Name	Source ID	No. of Portal sources	No. of Non-Portal Sources	Area (m ²)	Hour	Total Emission Factor			Total Emission Rate			Emission Rate (from Portal Sources)			Emission rate (from Non-portal Sources)			Daily Emission Rate / Diurnal Profile (from 1st 50m for Each Portal Source)			Daily Emission Rate / Diurnal Profile (from 2nd 50m for Each Portal Source)			Daily Emission Rate / Diurnal Profile (Each Non-Portal Sources)			Emission Calculation Formula (Reference made to the supporting documents for the approved WKCD VEP (EP-453/2013/B))						
									Q (veh/hr)	NO _x (g/mile-veh)	NO ₂ (g/mile-veh)	RSP (g/mile-veh)	NO (g/s)	NO ₂ (g/s)	RSP (g/s)	NO (g/s)	NO ₂ (g/s)	RSP (g/s)	NO (g/s or g/m ² /s)	NO ₂ (g/s or g/m ² /s)	RSP (g/s or g/m ² /s)	NO (g/s) / %	NO ₂ (g/s) / %	RSP (g/s) / %	NO (g/s) / %	NO ₂ (g/s) / %	RSP (g/s) / %	NO (g/s or g/m ² /s)	NO ₂ (g/s or g/m ² /s)		RSP (g/s or g/m ² /s)					
Internal Road C at B1 Level	0%	502	V32 V34-V38	C1+C2	-	6	-	1	277	0.5676	0.0383	0.0090	1.365E-02	9.198E-04	2.173E-04	-	-	-	1.365E-02	9.198E-04	2.173E-04	-	-	-	-	-	-	2.8%	2.1%	1.9%						
								2	193	0.5980	0.0432	0.0099	9.826E-03	7.218E-04	1.633E-04	-	-	-	9.826E-03	7.218E-04	1.633E-04	-	-	-	-	-	-	-	-	-		2.0%	1.7%	1.5%		
								3	138	0.5984	0.0471	0.0102	7.158E-03	5.633E-04	1.220E-04	-	-	-	7.158E-03	5.633E-04	1.220E-04	-	-	-	-	-	-	-	-	-		-	1.5%	1.3%	1.1%	
								4	102	0.6148	0.0518	0.0109	5.444E-03	4.587E-04	9.647E-05	-	-	-	5.444E-03	4.587E-04	9.647E-05	-	-	-	-	-	-	-	-	-		-	1.1%	1.1%	0.9%	
								5	90	0.6402	0.0595	0.0124	5.013E-03	4.663E-04	9.689E-05	-	-	-	5.013E-03	4.663E-04	9.689E-05	-	-	-	-	-	-	-	-	-		-	-	1.0%	1.1%	0.9%
								6	101	0.6594	0.0681	0.0141	5.793E-03	5.984E-04	1.241E-04	-	-	-	5.793E-03	5.984E-04	1.241E-04	-	-	-	-	-	-	-	-	-		-	-	1.2%	1.4%	1.1%
								7	165	0.7171	0.0834	0.0173	1.025E-02	1.193E-03	2.470E-04	-	-	-	1.025E-02	1.193E-03	2.470E-04	-	-	-	-	-	-	-	-	-		-	-	2.1%	2.7%	2.2%
								8	325	0.7775	0.0988	0.0203	2.191E-02	2.785E-03	5.716E-04	-	-	-	2.191E-02	2.785E-03	5.716E-04	-	-	-	-	-	-	-	-	-		-	-	4.4%	6.4%	5.1%
								9	472	0.5859	0.0722	0.0174	2.397E-02	2.952E-03	7.114E-04	-	-	-	2.397E-02	2.952E-03	7.114E-04	-	-	-	-	-	-	-	-	-		-	-	4.9%	6.8%	6.3%
								10	437	0.4820	0.0410	0.0111	1.826E-02	1.554E-03	4.221E-04	-	-	-	1.826E-02	1.554E-03	4.221E-04	-	-	-	-	-	-	-	-	-		-	-	3.7%	3.6%	3.8%
								11	419	0.5033	0.0389	0.0102	1.925E-02	1.410E-03	3.701E-04	-	-	-	1.925E-02	1.410E-03	3.701E-04	-	-	-	-	-	-	-	-	-		-	-	3.7%	3.2%	3.9%
								12	441	0.5720	0.0537	0.0129	2.186E-02	2.051E-03	4.935E-04	-	-	-	2.186E-02	2.051E-03	4.935E-04	-	-	-	-	-	-	-	-	-		-	-	4.4%	4.7%	4.4%
								13	478	0.5354	0.0461	0.0116	2.219E-02	1.912E-03	4.820E-04	-	-	-	2.219E-02	1.912E-03	4.820E-04	-	-	-	-	-	-	-	-	-		-	-	4.5%	4.4%	4.3%
								14	484	0.5202	0.0441	0.0114	2.180E-02	1.948E-03	4.775E-04	-	-	-	2.180E-02	1.948E-03	4.775E-04	-	-	-	-	-	-	-	-	-		-	-	4.4%	4.3%	4.3%
								15	556	0.5224	0.0450	0.0117	2.515E-02	2.164E-03	5.630E-04	-	-	-	2.515E-02	2.164E-03	5.630E-04	-	-	-	-	-	-	-	-	-		-	-	5.1%	5.0%	5.0%
								16	623	0.4805	0.0424	0.0116	2.593E-02	2.287E-03	6.282E-04	-	-	-	2.593E-02	2.287E-03	6.282E-04	-	-	-	-	-	-	-	-	-		-	-	5.3%	5.3%	5.6%
								17	692	0.5033	0.0477	0.0129	3.017E-02	2.861E-03	7.665E-04	-	-	-	3.017E-02	2.861E-03	7.665E-04	-	-	-	-	-	-	-	-	-		-	-	6.1%	6.6%	6.9%
								18	786	0.4787	0.0451	0.0128	3.259E-02	3.071E-03	8.724E-04	-	-	-	3.259E-02	3.071E-03	8.724E-04	-	-	-	-	-	-	-	-	-		-	-	6.6%	7.1%	7.8%
								19	1010	0.5262	0.0571	0.0158	4.604E-02	4.996E-03	1.382E-03	-	-	-	4.604E-02	4.996E-03	1.382E-03	-	-	-	-	-	-	-	-	-		-	-	9.4%	11.5%	12.3%
								20	827	0.4385	0.0392	0.0123	3.142E-02	2.808E-03	8.799E-04	-	-	-	3.142E-02	2.808E-03	8.799E-04	-	-	-	-	-	-	-	-	-		-	-	6.4%	6.5%	7.6%
								21	594	0.5084	0.0329	0.0092	2.618E-02	1.693E-03	4.729E-04	-	-	-	2.618E-02	1.693E-03	4.729E-04	-	-	-	-	-	-	-	-	-		-	-	5.3%	3.9%	4.2%
								22	559	0.5379	0.0337	0.0089	2.603E-02	1.632E-03	4.312E-04	-	-	-	2.603E-02	1.632E-03	4.312E-04	-	-	-	-	-	-	-	-	-		-	-	5.3%	3.8%	3.8%
								23	532	0.5241	0.0279	0.0075	2.417E-02	1.296E-03	3.476E-04	-	-	-	2.417E-02	1.296E-03	3.476E-04	-	-	-	-	-	-	-	-	-		-	-	4.9%	3.0%	3.1%
								24	410	0.5436	0.0331	0.0083	1.929E-02	1.177E-03	2.949E-04	-	-	-	1.929E-02	1.177E-03	2.949E-04	-	-	-	-	-	-	-	-	-		-	-	3.9%	2.7%	2.6%
								Daily	-	-	-	-	-	-	-	-	-	-	-	-	-	-	-	-	-	-	-	-	8.206E-02	7.235E-03	1.872E-03					

Notes:
 [1] For short top openings (i.e. Openings CE, F and JKO1), it was assumed that 10% of the tunnel emissions would be released through the short top opening and the remaining 90% of emissions through the tunnel to the portal, as the worst scenario according to the approved WKCD EIA Report (AEIAR-178/2013).
 [2] For the other longer top opening (i.e. Opening B), 2/3 of the total tunnel emissions would be dispersed within the first 50m and the 1/3 of the total tunnel emissions within the second 50m according to the Permanent International Association of Road Congress Report. As Opening B is only 80.935m long, the 1/3 emission for the second portion (80.935m-50m=30.935m long) would be distributed on a pro-rata basis (i.e. 1/3*30.935/50).
 [3] Flow ratios of the road links involved in Opening JKO1 as provided by traffic consultant are as below.

From tunnel ID (Road ID)	To tunnel ID (Road ID)	%
J (116)	P (110)	88%
	L (112)	7%
72	K (114)	11%
	L (112)	89%
K (114)	P (110)	59%
	L (112)	59%

Calculation of Portal Emission and Emissions of Underpass Top Openings, Ventilation Buildings and Ventilation Exhausts

Hourly Profile for Portals

Hour	Portal D Underpass for Austin Road/Lin Cheung Road (NB)			Portal L Underpass at Lin Cheung Road (NB)			Portal M Landscape Deck at Lin Cheung Road (SB)			Portal N Landscape Deck at Lin Cheung Road (NB)			Portal P Austin Road West (WB)			Portal W West Harbour Crossing (for All Scenarios)		
	NO	NO _x	RSP	NO	NO _x	RSP	NO	NO _x	RSP	NO	NO _x	RSP	NO	NO _x	RSP	NO	NO _x	RSP
	Hour 1	2.4%	1.8%	2.2%	2.4%	1.8%	2.1%	2.4%	1.8%	1.7%	2.4%	1.8%	1.7%	2.6%	1.9%	2.3%	2.4%	1.9%
Hour 2	1.9%	1.5%	1.9%	1.9%	1.5%	1.7%	1.9%	1.5%	1.4%	1.9%	1.5%	1.4%	2.0%	1.6%	1.9%	1.9%	1.5%	1.9%
Hour 3	1.5%	1.3%	1.6%	1.6%	1.3%	1.5%	1.5%	1.3%	1.2%	1.5%	1.3%	1.2%	1.7%	1.4%	1.6%	1.5%	1.2%	1.5%
Hour 4	1.3%	1.1%	1.3%	1.3%	1.1%	1.3%	1.2%	1.1%	1.0%	1.2%	1.1%	1.0%	1.4%	1.2%	1.4%	1.2%	1.0%	1.3%
Hour 5	1.2%	1.1%	1.3%	1.3%	1.2%	1.3%	1.2%	1.1%	1.2%	1.1%	1.2%	1.1%	1.3%	1.2%	1.4%	1.1%	0.9%	1.1%
Hour 6	1.4%	1.4%	1.5%	1.5%	1.6%	1.6%	1.5%	1.6%	1.5%	1.5%	1.6%	1.5%	1.6%	1.6%	1.7%	1.2%	1.1%	1.3%
Hour 7	2.4%	2.5%	2.7%	2.7%	2.9%	2.9%	2.8%	3.3%	3.1%	2.8%	3.3%	3.1%	2.8%	3.0%	3.0%	1.9%	1.9%	2.0%
Hour 8	4.9%	5.5%	5.7%	5.8%	7.0%	6.6%	6.4%	8.0%	7.6%	6.4%	8.0%	7.6%	6.0%	7.1%	6.6%	3.9%	4.2%	4.2%
Hour 9	5.6%	6.0%	6.6%	6.8%	7.9%	8.0%	7.6%	9.3%	9.8%	7.6%	9.3%	9.8%	7.0%	7.9%	8.0%	4.3%	4.3%	4.7%
Hour 10	5.0%	5.1%	5.3%	5.7%	5.9%	5.8%	5.9%	5.8%	6.0%	5.9%	5.8%	6.0%	5.7%	5.7%	5.7%	4.0%	3.9%	4.0%
Hour 11	5.0%	5.3%	5.0%	5.4%	5.7%	5.2%	5.5%	5.4%	5.2%	5.5%	5.4%	5.2%	5.3%	5.4%	5.0%	4.2%	4.4%	4.0%
Hour 12	5.3%	5.8%	5.3%	5.8%	6.1%	5.5%	5.7%	6.1%	5.8%	5.7%	6.1%	5.8%	5.5%	5.9%	5.3%	4.8%	5.2%	4.6%
Hour 13	5.1%	5.5%	5.0%	5.2%	5.5%	5.1%	5.3%	5.4%	5.3%	5.4%	5.3%	5.4%	5.1%	5.4%	4.9%	4.9%	5.3%	4.7%
Hour 14	5.6%	6.3%	5.8%	5.3%	5.9%	5.4%	5.1%	5.4%	5.2%	5.1%	5.4%	5.2%	5.2%	5.7%	5.1%	5.6%	6.4%	5.5%
Hour 15	6.2%	7.2%	6.1%	5.8%	6.5%	5.8%	5.5%	6.0%	5.7%	5.5%	6.0%	5.7%	5.6%	6.4%	5.5%	6.5%	7.8%	6.3%
Hour 16	6.2%	7.2%	6.2%	5.6%	6.3%	5.7%	5.3%	5.9%	5.7%	5.3%	5.9%	5.7%	5.4%	6.2%	5.4%	6.7%	8.0%	6.6%
Hour 17	6.4%	7.5%	6.5%	5.7%	6.3%	6.0%	5.4%	6.0%	5.9%	5.4%	6.0%	5.9%	5.5%	6.2%	5.7%	7.3%	8.3%	7.3%
Hour 18	6.4%	6.9%	6.5%	5.6%	6.0%	6.0%	5.2%	5.6%	5.7%	5.2%	5.6%	5.7%	5.5%	5.9%	5.8%	7.5%	8.1%	7.7%
Hour 19	6.8%	7.1%	7.2%	6.1%	6.3%	6.8%	5.9%	6.4%	7.1%	5.9%	6.4%	7.1%	6.0%	6.3%	6.6%	8.1%	8.3%	8.7%
Hour 20	4.6%	4.0%	4.7%	4.3%	3.7%	4.6%	4.1%	3.7%	4.5%	4.1%	3.7%	4.5%	4.3%	3.8%	4.7%	5.5%	4.7%	5.9%
Hour 21	3.9%	2.8%	3.3%	3.7%	2.6%	3.1%	3.7%	2.5%	2.7%	3.7%	2.5%	2.7%	3.7%	2.7%	3.3%	4.4%	3.3%	4.1%
Hour 22	3.9%	2.6%	3.1%	3.7%	2.5%	2.9%	3.8%	2.5%	2.6%	3.8%	2.5%	2.6%	3.8%	2.6%	3.1%	4.1%	3.0%	3.7%
Hour 23	3.7%	2.3%	2.8%	3.7%	2.2%	2.7%	3.8%	2.2%	2.2%	3.8%	2.2%	2.2%	3.7%	2.4%	2.9%	3.9%	2.7%	3.5%
Hour 24	3.2%	2.3%	2.7%	3.2%	2.2%	2.5%	3.2%	2.2%	2.1%	3.2%	2.2%	2.1%	3.3%	2.3%	2.8%	3.3%	2.4%	3.1%

Hourly Profile for Underpass Top Openings

Hour	Underpass Top Opening B Underpass for Austin Road/Lin Cheung Road (NB)			Underpass Top Opening CE Underpass for Austin Road/Lin Cheung Road (NB)			Underpass Top Opening F Underpass for Austin Road/Lin Cheung Road (SB)			Underpass Top Opening JK01 Underpass at Austin Road (WB)		
	NO	NO _x	RSP	NO	NO _x	RSP	NO	NO _x	RSP	NO	NO _x	RSP
	Hour 1	2.4%	1.8%	2.2%	2.4%	1.8%	2.1%	2.4%	1.8%	2.1%	2.6%	1.9%
Hour 2	1.9%	1.5%	1.9%	1.9%	1.5%	1.8%	1.9%	1.5%	1.7%	2.1%	1.6%	2.0%
Hour 3	1.5%	1.3%	1.6%	1.5%	1.3%	1.5%	1.5%	1.2%	1.4%	1.7%	1.4%	1.7%
Hour 4	1.3%	1.1%	1.3%	1.3%	1.1%	1.3%	1.3%	1.1%	1.2%	1.4%	1.2%	1.4%
Hour 5	1.2%	1.1%	1.3%	1.2%	1.1%	1.3%	1.2%	1.1%	1.2%	1.4%	1.2%	1.4%
Hour 6	1.4%	1.4%	1.5%	1.4%	1.4%	1.5%	1.5%	1.5%	1.5%	1.6%	1.6%	1.7%
Hour 7	2.4%	2.5%	2.7%	2.6%	2.7%	2.7%	2.6%	2.9%	2.8%	2.8%	3.0%	3.0%
Hour 8	4.9%	5.5%	5.7%	5.4%	6.3%	6.0%	5.8%	7.0%	6.4%	5.9%	7.0%	6.5%
Hour 9	5.6%	6.0%	6.6%	6.2%	7.0%	7.2%	6.7%	7.8%	7.7%	6.9%	7.9%	7.9%
Hour 10	5.0%	5.1%	5.3%	5.4%	5.7%	5.6%	5.7%	6.1%	5.8%	5.7%	5.8%	5.8%
Hour 11	5.0%	5.3%	5.0%	5.3%	5.7%	5.2%	5.5%	6.0%	5.3%	5.3%	5.5%	5.0%
Hour 12	5.3%	5.8%	5.3%	5.5%	6.0%	5.4%	5.7%	6.3%	5.6%	5.5%	5.9%	5.3%
Hour 13	5.1%	5.5%	5.0%	5.2%	5.6%	5.1%	5.3%	5.7%	5.2%	5.1%	5.4%	4.9%
Hour 14	5.6%	6.3%	5.8%	5.5%	6.1%	5.5%	5.4%	6.0%	5.4%	5.2%	5.7%	5.1%
Hour 15	6.2%	7.2%	6.1%	6.0%	6.9%	6.0%	5.9%	6.7%	5.9%	5.6%	6.4%	5.5%
Hour 16	6.2%	7.2%	6.2%	5.9%	6.8%	6.0%	5.7%	6.4%	5.9%	5.4%	6.2%	5.4%
Hour 17	6.4%	7.5%	6.5%	6.1%	6.8%	6.3%	5.8%	6.3%	6.1%	5.5%	6.2%	5.7%
Hour 18	6.4%	6.9%	6.5%	6.0%	6.4%	6.3%	5.7%	5.9%	6.1%	5.5%	5.9%	5.8%
Hour 19	6.8%	7.1%	7.2%	6.4%	6.6%	7.0%	6.1%	6.1%	6.8%	6.0%	6.2%	6.6%
Hour 20	4.6%	4.0%	4.7%	4.5%	3.8%	4.7%	4.3%	3.6%	4.7%	4.4%	3.8%	4.7%
Hour 21	3.9%	2.8%	3.3%	3.8%	2.6%	3.2%	3.7%	2.5%	3.1%	3.8%	2.7%	3.3%
Hour 22	3.9%	2.6%	3.1%	3.8%	2.5%	3.0%	3.7%	2.4%	2.9%	3.8%	2.6%	3.1%
Hour 23	3.7%	2.3%	2.8%	3.7%	2.2%	2.8%	3.6%	2.2%	2.7%	3.8%	2.4%	3.0%
Hour 24	3.2%	2.3%	2.7%	3.2%	2.2%	2.6%	3.1%	2.1%	2.5%	3.3%	2.3%	2.8%

Hourly Profile for Ventilation Building and Ventilation Exhausts

Hour	Ventilation Building WHCVB West Harbour Crossing (for All Scenarios)			Ventilation Exhausts V25-V31, V33 Internal Road B			Ventilation Exhausts V32, V34- V38 Internal Road C		
	NO	NO _x	RSP	NO	NO _x	RSP	NO	NO _x	RSP
	Hour 1	2.4%	1.9%	2.4%	2.7%	2.0%	1.8%	2.7%	2.1%
Hour 2	1.9%	1.5%	1.9%	2.0%	1.6%	1.4%	1.9%	1.7%	1.5%
Hour 3	1.5%	1.2%	1.5%	1.5%	1.3%	1.1%	1.4%	1.3%	1.1%
Hour 4	1.2%	1.0%	1.3%	1.2%	1.1%	0.9%	1.1%	1.1%	0.9%
Hour 5	1.1%	0.9%	1.1%	1.1%	1.2%	0.9%	1.0%	1.1%	0.8%
Hour 6	1.2%	1.1%	1.3%	1.3%	1.5%	1.2%	1.2%	1.4%	1.0%
Hour 7	1.9%	1.9%	2.0%	2.3%	3.1%	2.4%	2.1%	2.7%	2.0%
Hour 8	3.9%	4.2%	4.2%	5.3%	7.8%	6.0%	4.5%	6.3%	4.4%
Hour 9	4.3%	4.3%	4.7%	6.2%	9.0%	8.3%	5.0%	6.7%	5.7%
Hour 10	4.0%	3.9%	4.0%	4.7%	4.5%	4.9%	3.7%	3.6%	3.8%
Hour 11	4.2%	4.4%	4.0%	4.4%	3.8%	3.9%	3.7%	3.3%	3.4%
Hour 12	4.8%	5.2%	4.6%	4.9%	5.1%	4.8%	4.4%	4.7%	4.2%
Hour 13	4.9%	5.3%	4.7%	4.8%	4.6%	4.5%	4.4%	4.4%	4.2%
Hour 14	5.6%	6.4%	5.5%	4.5%	4.2%	4.3%	4.4%	4.3%	4.3%
Hour 15	6.5%	7.8%	6.3%	4.9%	4.7%	4.8%	5.1%	5.0%	4.9%
Hour 16	6.7%	8.0%	6.6%	5.0%	5.0%	5.4%	5.3%	5.3%	5.7%
Hour 17	7.3%	8.3%	7.3%	5.3%	5.9%	6.2%	6.2%	6.6%	6.9%
Hour 18	7.5%	8.1%	7.7%	5.8%	6.1%	6.9%	6.8%	7.1%	8.0%
Hour 19	8.1%	8.3%	8.7%	7.7%	9.7%	10.4%	9.6%	11.4%	12.1%
Hour 20	5.5%	4.7%	5.9%	5.5%	5.6%	7.0%	6.5%	6.5%	7.9%
Hour 21	4.4%	3.3%	4.1%	4.8%	3.5%	3.8%	5.2%	4.0%	4.6%
Hour 22	4.1%	3.0%	3.7%	5.0%	3.4%	3.5%	5.1%	3.8%	4.0%
Hour 23	3.9%	2.7%	3.5%	4.8%	2.9%	3.0%	4.7%	3.0%	3.5%
Hour 24	3.3%	2.4%	3.1%	3.9%	2.6%	2.5%	3.8%	2.7%	2.9%

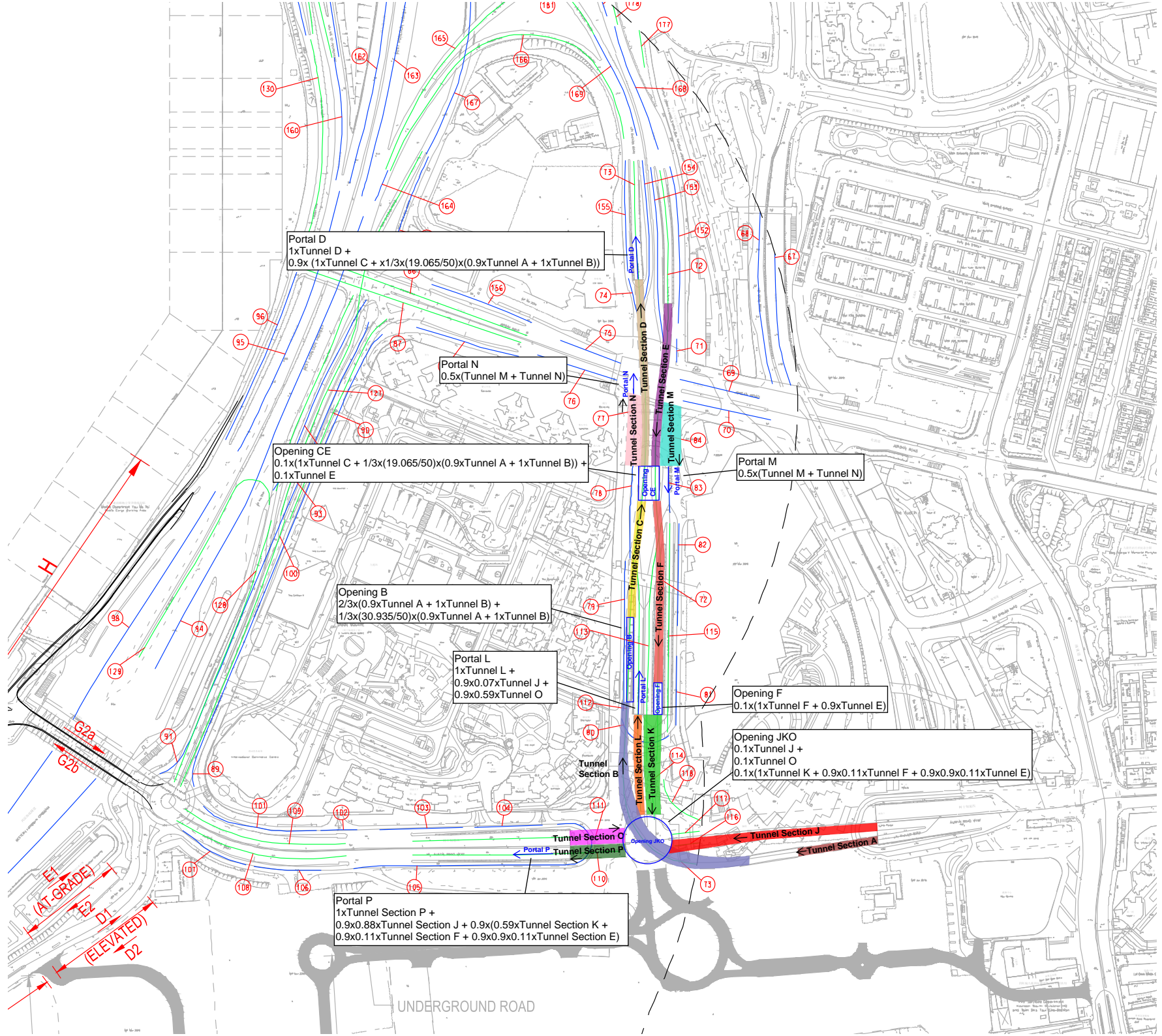

Portal D
 1xTunnel D +
 $0.9x(1xTunnel C + \frac{1}{3}x(19.065/50)x(0.9xTunnel A + 1xTunnel B))$

Portal N
 $0.5x(Tunnel M + Tunnel N)$

Opening CE
 $0.1x(1xTunnel C + \frac{1}{3}x(19.065/50)x(0.9xTunnel A + 1xTunnel B)) + 0.1xTunnel E$

Portal M
 $0.5x(Tunnel M + Tunnel N)$

Opening B
 $\frac{2}{3}x(0.9xTunnel A + 1xTunnel B) + \frac{1}{3}x(30.935/50)x(0.9xTunnel A + 1xTunnel B)$

Portal L
 $1xTunnel L + 0.9x0.07xTunnel J + 0.9x0.59xTunnel O$

Opening F
 $0.1x(1xTunnel F + 0.9xTunnel E)$

Opening JKO
 $0.1xTunnel J + 0.1xTunnel O + 0.1x(1xTunnel K + 0.9x0.11xTunnel F + 0.9x0.9x0.11xTunnel E)$

Portal P
 $1xTunnel Section P + 0.9x0.88xTunnel Section J + 0.9x(0.59xTunnel Section K + 0.9x0.11xTunnel Section F + 0.9x0.9x0.11xTunnel Section E)$

UNDERGROUND ROAD