

Annex C-2

Site Walkover Checklist

Site Walkover Dates: 20 and 25 February 2020

GENERAL SITE DETAILS

SITE OWNER/CLIENT Civil Engineering and Development Department

PROPERTY ADDRESS Revised Trunk Road T4 Project Area (except CEDD and HyD's site
depots at Lion Rock Tunnel Road)

PERSON CONDUCTING THE QUESTIONNAIRE

NAME Ms. Chloe Ng, Ms. Vanni Liu, Mr. Robert Yuen

POSITION Project / Graduate Environmental Consultant, AECOM

AUTHORIZED OWNER/CLIENT REPRESENTATIVE (IF APPLICABLE)

NAME Not Available

POSITION --

TELEPHONE --

SITE ACTIVITIES

Briefly describe activities carried out on site, including types of products/chemicals/materials handled.
Obtain a flow schematic if possible.

Number of employees: Full-time: N/A

Part-time: N/A

Temporary/Seasonal: N/A

Maximum no. of people on site at any time: N/A

Typical hours of operation: N/A

Number of shifts: N/A

Days per week: N/A

Weeks per year: N/A

Scheduled plant shut-down: N/A

Annex C1

Site Walkover Checklist

Describe the topography of the area (flat terrain, rolling hills, mountains, by a large body of water, vegetation, etc.).

Generally Flat terrain.

State the size and location of the nearest residential communities.

The River Park (approx. 10m southwest of the site, area of about 8,800m²), Pok Hon Estate (approx. 10m northeast of the site, area of about 63,000m²), Tung Lo Wan (approx. 10m north of the site, area of about 10,600m²).

Are there any sensitive habitats nearby, such as nature reserves, parks, wetlands or sites of special scientific interest?

No.

Questionnaire with Existing/Previous Site Owner or Occupier

	Yes/No	Notes*
1. What are the main activities/operations at the above address?	--	Car parks, refuse collection point, playground / sitting-out area, MTR East Rail, open area, footpaths / cycling tracks, subways, Shing Mun River Channel, roads, agricultural land and vegetation.
2. How long have you been occupying the site?	N/A	
3. Were you the first occupant on site? (If yes, what was the usage of the site prior to occupancy.)	N/A	
4. Prior to your occupancy, who occupied the site?	N/A	
5. What were the main activities/operations during their occupancy?	N/A	
6. Have there been any major changes in operations carried out at the site in the last 10 years?	N/A	
7. Have any polluting activities been carried out in the vicinity of the site in the past?	N/A	
8. To the best of your knowledge, has the site ever been used as a petrol filling station/car service garage?	N/A	Based on site observation, a petrol filling station at Man Lam Road was observed within the Project Area.
9. Are there any boreholes/wells or natural springs either on the site or in the surrounding area?	N/A	
10. Do you have any registered hazardous installations as defined under relevant ordinances? (If yes, please provide details.)	N/A	No registered hazardous installations were observed on site.
11. Are any chemicals used in your daily operations? (If yes, please provide details.)	N/A	No chemicals were observed on site.
• Where do you store these chemicals?	N/A	
12. Material inventory lists, including quantities and locations available? (If yes, how often are these inventories updated?)	N/A	
13. Has the facility produced a separate hazardous substance inventory?	N/A	No hazardous substances were observed on site.
14. Have there ever been any incidents or accidents (e.g. spills, fires, injuries, etc.) involving any of these materials? (If yes, please provide details.)	N/A	

* No interview was able to be conducted. Notes shown are based on observation from site walkover.

	Yes/No	Notes*
15. How are materials received (e.g. rail, truck, etc.) and stored on site (e.g. drums, tanks, carboys, bags, silos, cisterns, vaults and cylinders)?	N/A	
16. Do you have any underground storage tanks? (If yes, please provide details.)	N/A	
• How many underground storage tanks do you have on site?	N/A	
• What are the tanks constructed of?	N/A	
• What are the contents of these tanks?	N/A	
• Are the pipelines above or below ground?	N/A	
• If the pipelines are below ground, has any leak and integrity testing been performed?	N/A	
• Have there been any spills associated with these tanks?	N/A	
17. Are there any disused underground storage tanks?	N/A	
18. Do you have regular check for any spillage and monitoring of chemicals handled? (If yes, please provide details.)	N/A	No chemicals were observed within the site.
19. How are the wastes disposed of?	N/A	
20. Have you ever received any notices of violation of environmental regulations or received public complaints? (If yes, please provide details.)	N/A	
21. Have any spills occurred on site? (If yes, please provide details.)	N/A	No traces of oil stains and stressed vegetation observed on site.
• When did the spill occur?	N/A	
• What were the substances spilled?	N/A	
• What was the quantity of material spilled?	N/A	
• Did you notify the relevant departments of the spill?	N/A	
• What were the actions taken to clean up the spill?	N/A	
• What were the areas affected?	N/A	
22. Do you have any records of major renovation of your site or re-arrangement of underground utilities, pipe work/underground tanks (If yes, please provide details.)	N/A	
23. Have disused underground tanks been removed or otherwise secured (e.g. concrete, sand, etc.)?	N/A	
24. Are there any known contaminations on site? (If yes, please provide details.)	N/A	
25. Has the site ever been remediated? (If yes, please provide details.)	N/A	

* No interview was able to be conducted. Notes shown are based on observation from site walkover.

Annex C1

Site Walkover Checklist

Observations

	Yes/No	Notes
1. Are chemical storage areas provided with secondary containment (i.e. bund walls and floors)?	N/A	No chemicals or chemical storage areas were observed on site.
2. What are the conditions of the bund walls and floors?	N/A	
3. Are any surface water drains located near to drum storage and unloading areas?	No	No drums observed.
4. Are any solid or liquid waste (other than wastewater) generated at the site? (If yes, please provide details.)	No	
5. Is there a storage site for the wastes?	Yes	A refuse collection point for general refuse was observed within the site.
6. Is there an on-site landfill?	No	
7. Were any stressed vegetation noted on site during the site reconnaissance? (If yes, please indicate location and approximate size.)	No	
8. Were any stained surfaces noted on-site during the site reconnaissance? (If yes, please provide details.)	No	
9. Are there any potential off-site sources of contamination?	No	
10. Does the site have any equipment which might contain polychlorinated biphenyls (PCBs)?	No	
11. Are there any sumps, effluent pits, interceptors or lagoons on site?	No	
12. Any noticeable odours during site walkover?	No	
13. Are any of the following chemicals used on site: fuels, lubricating oils, hydraulic fluids, cleaning solvents, used chemical solutions, acids, anti-corrosive paints, thinners, coal, ash, oily tanks and bilge sludge, metal wastes, wood preservatives and polyurethane foam?	No	

Site Walkover Checklist

GENERAL SITE DETAILS

SITE OWNER/CLIENT Civil Engineering and Development Department

PROPERTY ADDRESS Site Depot of Highways Department at Lion Rock Tunnel Road
(Land Lot No.: GLA-TST 400)

PERSON CONDUCTING THE QUESTIONNAIRE

NAME Ms. Chloe Ng, Ms. Vanni Liu, Mr. Robert Yuen

POSITION Project / Graduate Environmental Consultant, AECOM

AUTHORIZED OWNER/CLIENT REPRESENTATIVE (IF APPLICABLE)

NAME Mr. Will Ng

POSITION Senior Site Agent, China Road & Bridge Corporation

TELEPHONE 60186607

SITE ACTIVITIES

Briefly describe activities carried out on site, including types of products/chemicals/materials handled.
Obtain a flow schematic if possible.

Number of employees: Full-time: 40-50

Part-time: --

Temporary/Seasonal: --

Maximum no. of people on site at any time: 50

Typical hours of operation: 24 hours

Number of shifts: --

Days per week: 7

Weeks per year: 52

Scheduled plant shut-down: --

Detail the main sources of energy at the site:

Gas ~~Yes~~/No
Electricity Yes/~~No~~
Coal ~~Yes~~/No
Oil ~~Yes~~/No
Other ~~Yes~~/No

SITE DESCRIPTION

This section is intended to gather information on site setting and environmental receptors on, adjacent or close to the site.

What is the total site area: _____ Approx. 1,750 m²

What area of the site is covered by buildings (%): _____ Approx. 37 %

Please list all current and previous owners/occupiers if possible. _____ Highways Department

Is a site plan available? If yes, please attach. Yes/~~No~~

Are there any other parties on site as tenants or sub-tenants? ~~Yes~~/No

If yes, identify those parties: _____

Describe surrounding land use (residential, industrial, rural, etc.) and identify neighbouring facilities and types of industry.

North: CEDD's site office (Industrial)

South: Che Kung Miu Road

East: Lion Rock Tunnel Road

West: The Riverpark (Urban residential)

Annex C1

Site Walkover Checklist

Describe the topography of the area (flat terrain, rolling hills, mountains, by a large body of water, vegetation, etc.).

Generally Flat terrain.

State the size and location of the nearest residential communities.

The Riverpark (approx. 10m west of the site, area of about 8,800m²)

Are there any sensitive habitats nearby, such as nature reserves, parks, wetlands or sites of special scientific interest?

No.

Questionnaire with Existing/Previous Site Owner or Occupier

	Yes/No	Notes
1. What are the main activities/operations at the above address?	--	Site office for administrative work and management of road maintenance services, car parking.
2. How long have you been occupying the site?	N/A	4-5 years
3. Were you the first occupant on site? (If yes, what was the usage of the site prior to occupancy.)	No	
4. Prior to your occupancy, who occupied the site?	N/A	Government
5. What were the main activities/operations during their occupancy?	N/A	Unknown
6. Have there been any major changes in operations carried out at the site in the last 10 years?	N/A	No major changes in the last 5 years
7. Have any polluting activities been carried out in the vicinity of the site in the past?	No	
8. To the best of your knowledge, has the site ever been used as a petrol filling station/car service garage?	No	
9. Are there any boreholes/wells or natural springs either on the site or in the surrounding area?	No	
10. Do you have any registered hazardous installations as defined under relevant ordinances? (If yes, please provide details.)	No	
11. Are any chemicals used in your daily operations? (If yes, please provide details.)	No	
• Where do you store these chemicals?	N/A	
12. Material inventory lists, including quantities and locations available? (If yes, how often are these inventories updated?)	No	
13. Has the facility produced a separate hazardous substance inventory?	No	
14. Have there ever been any incidents or accidents (e.g. spills, fires, injuries, etc.) involving any of these materials? (If yes, please provide details.)	No	

	Yes/No	Notes
15. How are materials received (e.g. rail, truck, etc.) and stored on site (e.g. drums, tanks, carboys, bags, silos, cisterns, vaults and cylinders)?	N/A	No materials are used on site.
16. Do you have any underground storage tanks? (If yes, please provide details.)	No	
• How many underground storage tanks do you have on site?	N/A	
• What are the tanks constructed of?	N/A	
• What are the contents of these tanks?	N/A	
• Are the pipelines above or below ground?	N/A	
• If the pipelines are below ground, has any leak and integrity testing been performed?	N/A	
• Have there been any spills associated with these tanks?	N/A	
17. Are there any disused underground storage tanks?	No	
18. Do you have regular check for any spillage and monitoring of chemicals handled? (If yes, please provide details.)	No	
19. How are the wastes disposed of?	N/A	General refuse were collected recycled or disposed to the landfill.
20. Have you ever received any notices of violation of environmental regulations or received public complaints? (If yes, please provide details.)	No	
21. Have any spills occurred on site? (If yes, please provide details.)	No	
• When did the spill occur?	N/A	
• What were the substances spilled?	N/A	
• What was the quantity of material spilled?	N/A	
• Did you notify the relevant departments of the spill?	N/A	
• What were the actions taken to clean up the spill?	N/A	
• What were the areas affected?	N/A	
22. Do you have any records of major renovation of your site or re-arrangement of underground utilities, pipe work/underground tanks (If yes, please provide details.)	No	
23. Have disused underground tanks been removed or otherwise secured (e.g. concrete, sand, etc.)?	N/A	
24. Are there any known contaminations on site? (If yes, please provide details.)	No	
25. Has the site ever been remediated? (If yes, please provide details.)	No	

Annex C1

Site Walkover Checklist

Observations

	Yes/No	Notes
1. Are chemical storage areas provided with secondary containment (i.e. bund walls and floors)?	N/A	No chemicals or chemical storage areas were observed on site.
2. What are the conditions of the bund walls and floors?	N/A	
3. Are any surface water drains located near to drum storage and unloading areas?	No	No drums observed.
4. Are any solid or liquid waste (other than wastewater) generated at the site? (If yes, please provide details.)	No	
5. Is there a storage site for the wastes?	Yes	Bins for general wastes were observed within the site office.
6. Is there an on-site landfill?	No	
7. Were any stressed vegetation noted on site during the site reconnaissance? (If yes, please indicate location and approximate size.)	No	
8. Were any stained surfaces noted on-site during the site reconnaissance? (If yes, please provide details.)	No	
9. Are there any potential off-site sources of contamination?	No	
10. Does the site have any equipment which might contain polychlorinated biphenyls (PCBs)?	No	
11. Are there any sumps, effluent pits, interceptors or lagoons on site?	No	
12. Any noticeable odours during site walkover?	No	
13. Are any of the following chemicals used on site: fuels, lubricating oils, hydraulic fluids, cleaning solvents, used chemical solutions, acids, anti-corrosive paints, thinners, coal, ash, oily tanks and bilge sludge, metal wastes, wood preservatives and polyurethane foam?	No	

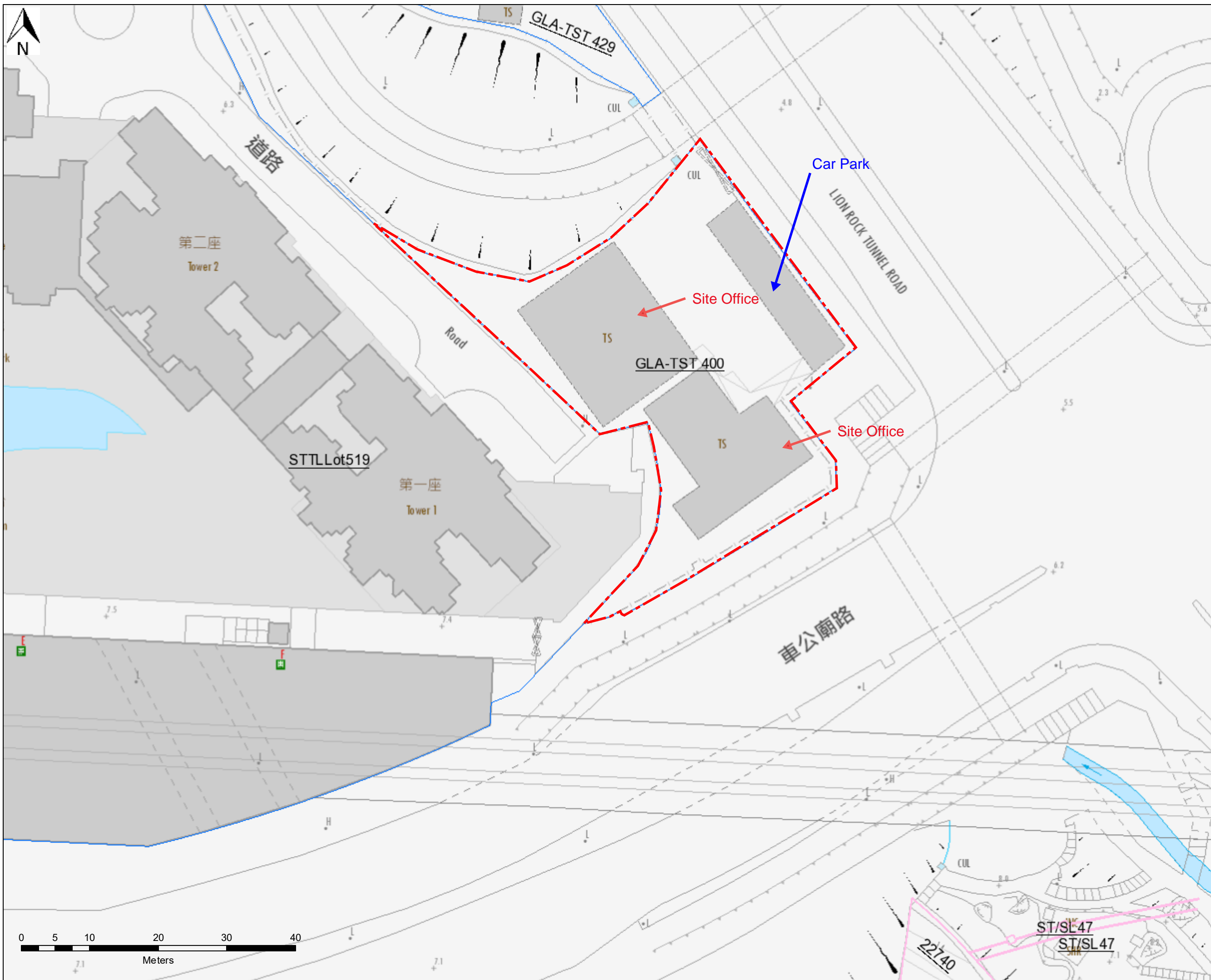

Legend:
 --- Site Depot of HyD

Division	
Scale	1:500
Date	24/02/2020

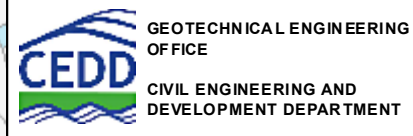

Annex C-2

Site Walkover Checklist

Site Walkover Date: 25 February 2020

GENERAL SITE DETAILS

SITE OWNER/CLIENT Civil Engineering and Development Department

PROPERTY ADDRESS Site Depot of Contract No. NE/2017/05 Road Widening and Retrofitting

Noise Barriers on Tai Po Road (Sha Tin Section) at Lion Rock Tunnel Road

(Land Lot No.: GLA-TST 429)

PERSON CONDUCTING THE QUESTIONNAIRE

NAME Ms. Chloe Ng, Ms. Vanni Liu, Mr. Robert Yuen

POSITION Project / Graduate Environmental Consultant, AECOM

AUTHORIZED OWNER/CLIENT REPRESENTATIVE (IF APPLICABLE)

NAME Mr. Joseph Chow

POSITION Resident Engineer, AECOM

TELEPHONE 60628214

SITE ACTIVITIES

Briefly describe activities carried out on site, including types of products/chemicals/materials handled.
Obtain a flow schematic if possible.

Number of employees: Full-time: 100 - 130

Part-time: --

Temporary/Seasonal: --

Maximum no. of people on site at any time: 130

Typical hours of operation: 8:30 a.m. - 5:30 p.m.

Number of shifts: --

Days per week: 6

Weeks per year: 52

Scheduled plant shut-down: Public Holidays

Detail the main sources of energy at the site:

Gas ~~Yes~~/No
Electricity Yes/~~No~~
Coal ~~Yes~~/No
Oil ~~Yes~~/No
Other ~~Yes~~/No

SITE DESCRIPTION

This section is intended to gather information on site setting and environmental receptors on, adjacent or close to the site.

What is the total site area: _____ Approx. 1,300 m²

What area of the site is covered by buildings (%): _____ Approx. 70 %

Please list all current and previous owners/occupiers if possible. _____ Civil Engineering and
Development Department (CEDD)

Is a site plan available? If yes, please attach. Yes/~~No~~

Are there any other parties on site as tenants or sub-tenants? ~~Yes~~/No

If yes, identify those parties: _____

Describe surrounding land use (residential, industrial, rural, etc.) and identify neighbouring facilities and types of industry.

North: Cycling track and Shing Mun River Channel

South: HyD Site Depot (Industrial)

East: Lion Rock Tunnel Road

West: Cycling track and The Riverpark (Urban residential)

Annex C1

Site Walkover Checklist

Describe the topography of the area (flat terrain, rolling hills, mountains, by a large body of water, vegetation, etc.).

Generally Flat terrain.

State the size and location of the nearest residential communities.

The Riverpark (approx. 30m southwest of the site, area of about 8,800m²)

Are there any sensitive habitats nearby, such as nature reserves, parks, wetlands or sites of special scientific interest?

No.

Questionnaire with Existing/Previous Site Owner or Occupier

	Yes/No	Notes
1. What are the main activities/operations at the above address?	--	Site office and car parking
2. How long have you been occupying the site?	N/A	Since August 2019
3. Were you the first occupant on site? (If yes, what was the usage of the site prior to occupancy.)	No	
4. Prior to your occupancy, who occupied the site?	N/A	CEDD's Contractor
5. What were the main activities/operations during their occupancy?	N/A	Site office of CEDD (Contract No. NE/2015/07) from 2015 to 2018
6. Have there been any major changes in operations carried out at the site in the last 10 years?	N/A	No major changes in the last 5 years with the same nature of operation as a site office.
7. Have any polluting activities been carried out in the vicinity of the site in the past?	No	
8. To the best of your knowledge, has the site ever been used as a petrol filling station/car service garage?	No	
9. Are there any boreholes/wells or natural springs either on the site or in the surrounding area?	No	
10. Do you have any registered hazardous installations as defined under relevant ordinances? (If yes, please provide details.)	No	
11. Are any chemicals used in your daily operations? (If yes, please provide details.)	No	
• Where do you store these chemicals?	N/A	
12. Material inventory lists, including quantities and locations available? (If yes, how often are these inventories updated?)	No	
13. Has the facility produced a separate hazardous substance inventory?	No	
14. Have there ever been any incidents or accidents (e.g. spills, fires, injuries, etc.) involving any of these materials? (If yes, please provide details.)	N/A	

	Yes/No	Notes
15. How are materials received (e.g. rail, truck, etc.) and stored on site (e.g. drums, tanks, carboys, bags, silos, cisterns, vaults and cylinders)?	No	No materials are used on site.
16. Do you have any underground storage tanks? (If yes, please provide details.)	No	
• How many underground storage tanks do you have on site?	N/A	
• What are the tanks constructed of?	N/A	
• What are the contents of these tanks?	N/A	
• Are the pipelines above or below ground?	N/A	
• If the pipelines are below ground, has any leak and integrity testing been performed?	N/A	
• Have there been any spills associated with these tanks?	N/A	
17. Are there any disused underground storage tanks?	No	
18. Do you have regular check for any spillage and monitoring of chemicals handled? (If yes, please provide details.)	No	
19. How are the wastes disposed of?	N/A	General refuse are collected recycled or disposed to the landfill.
20. Have you ever received any notices of violation of environmental regulations or received public complaints? (If yes, please provide details.)	No	
21. Have any spills occurred on site? (If yes, please provide details.)	No	
• When did the spill occur?	N/A	
• What were the substances spilled?	N/A	
• What was the quantity of material spilled?	N/A	
• Did you notify the relevant departments of the spill?	N/A	
• What were the actions taken to clean up the spill?	N/A	
• What were the areas affected?	N/A	
22. Do you have any records of major renovation of your site or re-arrangement of underground utilities, pipe work/underground tanks (If yes, please provide details.)	No	
23. Have disused underground tanks been removed or otherwise secured (e.g. concrete, sand, etc.)?	N/A	
24. Are there any known contaminations on site? (If yes, please provide details.)	No	
25. Has the site ever been remediated? (If yes, please provide details.)	No	

Annex C1

Site Walkover Checklist

Observations

	Yes/No	Notes
1. Are chemical storage areas provided with secondary containment (i.e. bund walls and floors)?	N/A	No chemicals or chemical storage areas were observed on site.
2. What are the conditions of the bund walls and floors?	N/A	
3. Are any surface water drains located near to drum storage and unloading areas?	No	No drums observed.
4. Are any solid or liquid waste (other than wastewater) generated at the site? (If yes, please provide details.)	No	
5. Is there a storage site for the wastes?	Yes	Bins for general wastes were observed within the site office.
6. Is there an on-site landfill?	No	
7. Were any stressed vegetation noted on site during the site reconnaissance? (If yes, please indicate location and approximate size.)	No	
8. Were any stained surfaces noted on-site during the site reconnaissance? (If yes, please provide details.)	No	
9. Are there any potential off-site sources of contamination?	No	
10. Does the site have any equipment which might contain polychlorinated biphenyls (PCBs)?	No	
11. Are there any sumps, effluent pits, interceptors or lagoons on site?	No	
12. Any noticeable odours during site walkover?	No	
13. Are any of the following chemicals used on site: fuels, lubricating oils, hydraulic fluids, cleaning solvents, used chemical solutions, acids, anti-corrosive paints, thinners, coal, ash, oily tanks and bilge sludge, metal wastes, wood preservatives and polyurethane foam?	No	

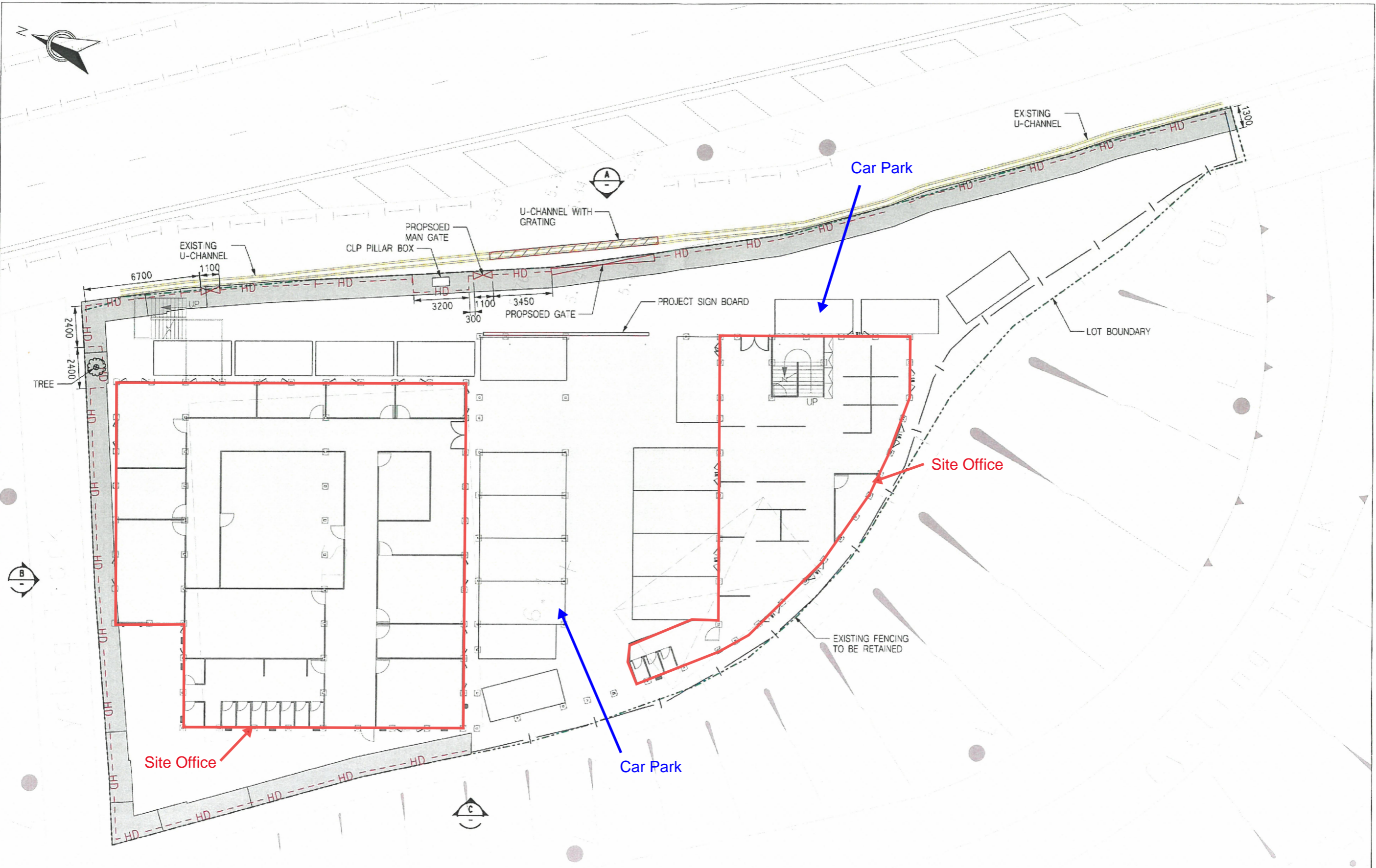

10/10/2019
 D:_2017_05\Sketch Drawings\SK-00445 (Hoarding Elevation of Works Area A)\TPR-TEC-SK-00445-1.dgn
 Filename:

Rev.	Description	Date	Checked
1	FIRST ISSUE	29/10/19	
			29OCT2019

中國中鐵-中鐵一局-振華工程聯營
 CHINA RAILWAY - CHINA RAILWAY FIRST GROUP - ZHEN HUA ENGINEERING JOINT VENTURE

CEDD CIVIL ENGINEERING AND DEVELOPMENT DEPARTMENT

MANNINGS YWL
 (Asia) Consultants Limited

Contract No. NE/2017/05
Road Widening and Retrofitting Noise Barriers on Tai Po Road (Sha Tin Section)
 HOARDING PLAN AT WORKS AREA A

TPR/TEC/SK/00445	
1 : 200 (IN A3)	1 OF 2
TPR-TEC-SK-00445-1.dgn	
NE/2017/05	1