

ISO A1 594mm x 841mm  
 Approved:  
 Checked:  
 Designer:  
 Project Management Initials:  
 2021/10/20  
 PATH PROJECTS\60579757\DRAWING\REPORT\R04\R04\_71Z.dgn  
 Plot File by: cam.xu

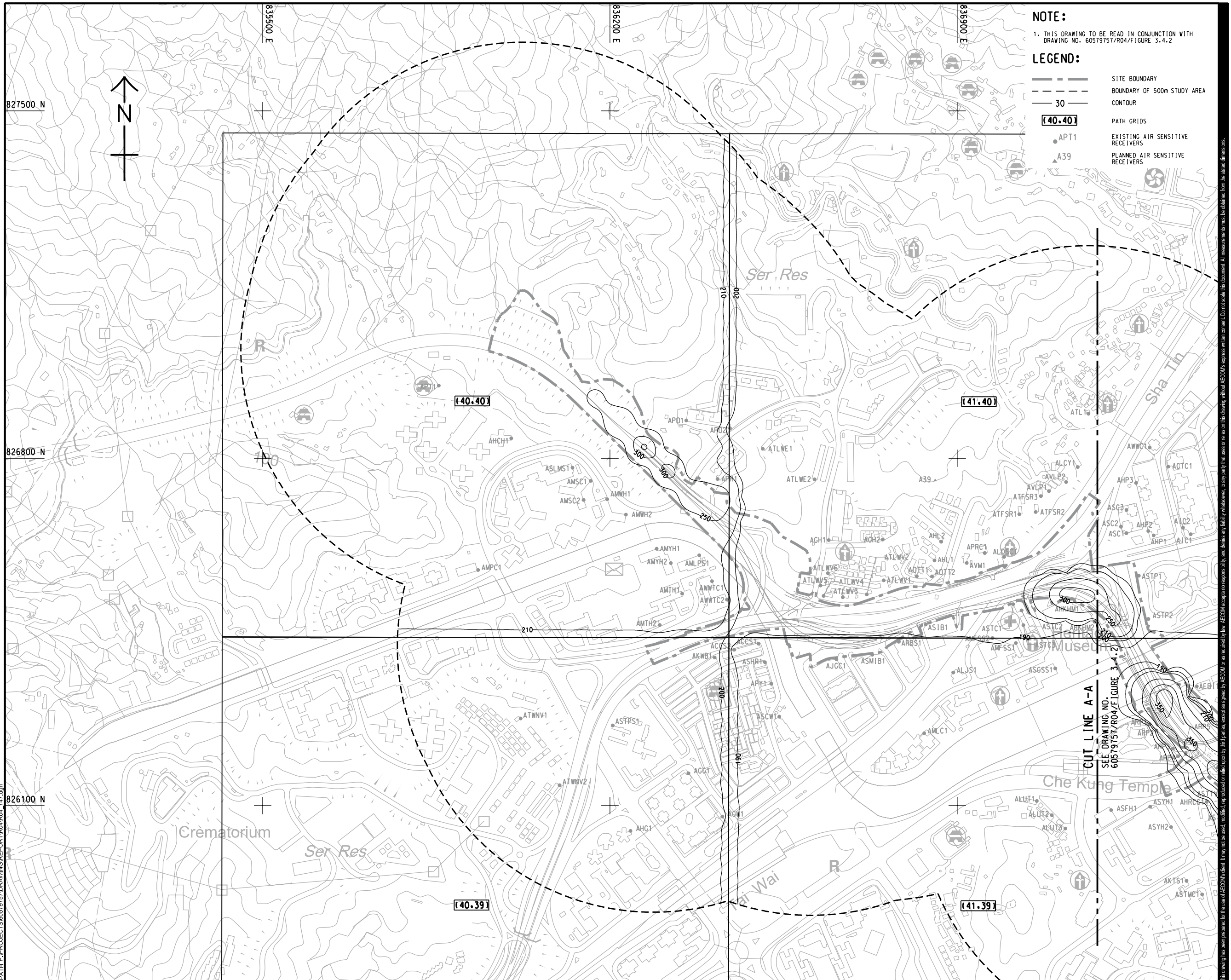

**NOTE:**  
 1. THIS DRAWING TO BE READ IN CONJUNCTION WITH DRAWING NO. 60579757/R04/FIGURE 3.4.2

**LEGEND:**

- SITE BOUNDARY
- BOUNDARY OF 500m STUDY AREA
- CONTOUR
- PATH GRIDS
- EXISTING AIR SENSITIVE RECEIVERS
- PLANNED AIR SENSITIVE RECEIVERS

**AECOM**

**PROJECT**  
 項目  
**REVISED TRUNK ROAD T4 IN SHA TIN**

**CLIENT**  
 業主  
 土木工程拓展署  
 Civil Engineering and Development Department

**CONSULTANT**  
 工程顧問公司  
 AECOM Asia Company Ltd.  
 www.aecom.com

**SUB-CONSULTANTS**  
 分判工程顧問公司

**ISSUE/REVISION**  
 修訂

IR	DATE	DESCRIPTION	CHK.

**STATUS**  
 階段

**SCALE**  
 比例  
 A3 1:7000

**DIMENSION UNIT**  
 尺寸單位  
 METRES

**KEY PLAN**  
 索引圖  
 A3 1:20000

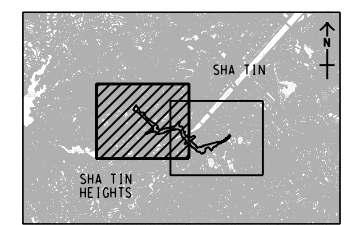

**PROJECT NO.**  
 項目編號  
 60579757

**AGREEMENT NO.**  
 協議編號  
 CE8/2018 (HY)

**SHEET TITLE**  
 圖紙名稱  
 CONTOURS OF CUMULATIVE MAXIMUM 1-HOUR TSP CONCENTRATION (µg/m³) AT 1.5mAG FOR THE WORST SCENARIO DURING CONSTRUCTION PHASE (YEAR 2023-YEAR 2028)

**SHEET NUMBER**  
 圖紙編號  
 60579757/R04/FIGURE 3.4.1

SHEET 1 OF 2

This drawing has been prepared for the use of AECOM's client. It may not be used, modified, reproduced or relied upon by third parties, except as agreed by AECOM or as required by law. AECOM accepts no responsibility, and disclaims any liability whatsoever, for any part, that is used or relied on in this drawing without AECOM's express written consent. All measurements must be obtained from the stated dimensions.