

ISO A1 594mm x 841mm
 Approved: 827500 N
 Checked: 826800 N
 Designer: 826100 N
 Project Management Initials: 826100 N
 2021/10/20
 PATH PROJECTS/60579757/DRAWING/REPORT/R04/R04_742.dgn
 Plot File by: cam.xu
 This drawing has been prepared for the use of AECOM's client. It may not be used, modified, reproduced or relied upon by third parties, except as agreed by AECOM or as required by law. AECOM accepts no responsibility, and disclaims any liability whatsoever, for any part, that is or is not on this drawing, without AECOM's express written consent. All measurements must be obtained from the stated dimensions.

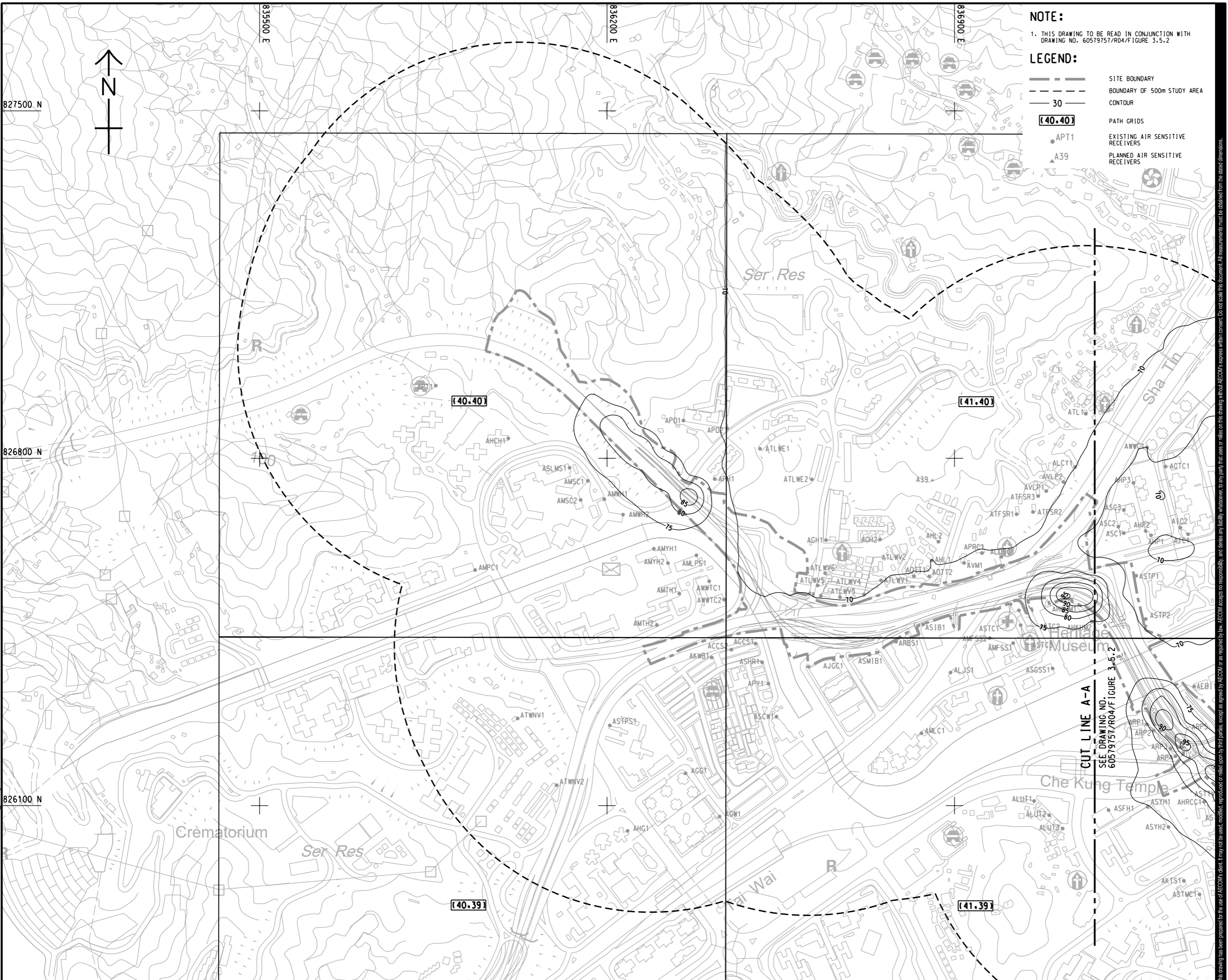

NOTE:
 1. THIS DRAWING TO BE READ IN CONJUNCTION WITH DRAWING NO. 60579757/R04/FIGURE 3.5.2

- LEGEND:**
- SITE BOUNDARY
 - BOUNDARY OF 500m STUDY AREA
 - CONTOUR
 - PATH GRIDS
 - EXISTING AIR SENSITIVE RECEIVERS
 - PLANNED AIR SENSITIVE RECEIVERS



PROJECT
 項目
REVISED TRUNK ROAD T4 IN SHA TIN

CLIENT
 業主
 土木工程拓展署
 Civil Engineering and Development Department

CONSULTANT
 工程顧問公司
 AECOM Asia Company Ltd.
 www.aecom.com

SUB-CONSULTANTS
 分判工程顧問公司

ISSUE/REVISION
 修訂

IR	DATE	DESCRIPTION	CHK.

STATUS
 階段

SCALE
 比例
 A3 1:7000

DIMENSION UNIT
 尺寸單位
 METRES

KEY PLAN
 索引圖
 A3 1:20000

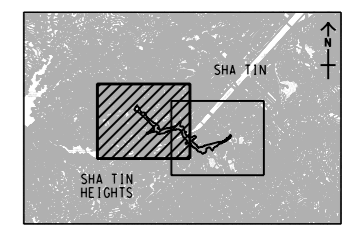

PROJECT NO.
 項目編號
 60579757

AGREEMENT NO.
 協議編號
 CE8/2018 (HY)

SHEET TITLE
 圖紙名稱
 CONTOURS OF CUMULATIVE 10th HIGHEST DAILY RSP CONCENTRATION (µg/m³) AT 1.5mAG FOR THE WORST SCENARIO DURING CONSTRUCTION PHASE (YEAR 2023-YEAR 2028)

SHEET 1 OF 2

SHEET NUMBER
 圖紙編號
 60579757/R04/FIGURE 3.5.1