

NAP ID	DESCRIPTION	LAND USE	NUMBER OF STOREYS
A16PH1	PLANNED PROPERTY DEVELOPMENT IN AREA 16	R	10
A16PH2	PLANNED PROPERTY DEVELOPMENT IN AREA 16	R	10
A16PH3	PLANNED PROPERTY DEVELOPMENT IN AREA 16	R	10
A16PH4	PLANNED PROPERTY DEVELOPMENT IN AREA 16	R	46
A16PH5	PLANNED PROPERTY DEVELOPMENT IN AREA 16	R	34
HSNPS	YAN CHAI HOSPITAL HO SIK NAM PRIMARY SCHOOL	E	7
OH1	TOWER 1, OCEANIA HEIGHTS	R	35
LMO1	BLOCK 13, LUNG MUN OASIS	R	32

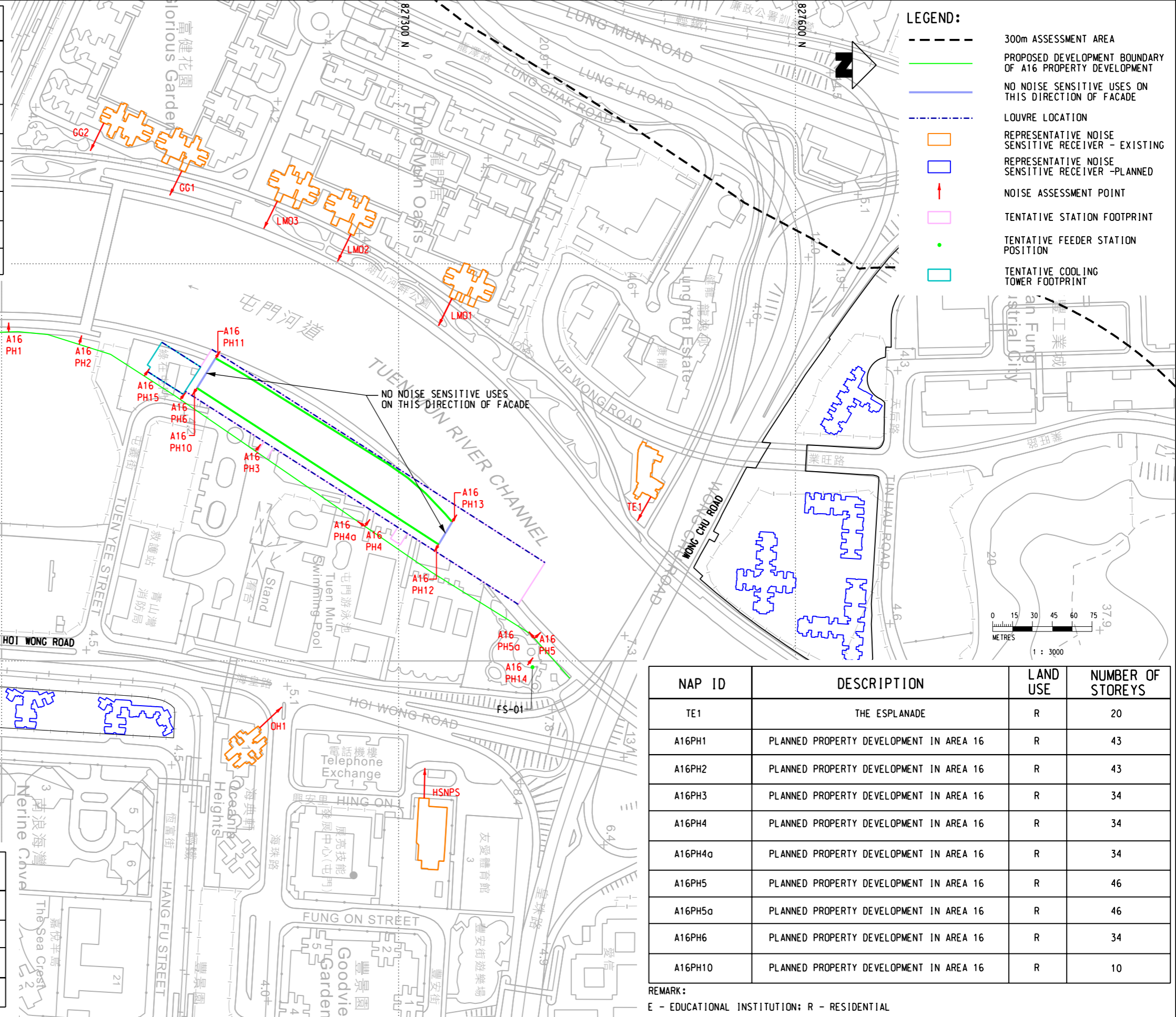

LEGEND:

- 300m ASSESSMENT AREA
- PROPOSED DEVELOPMENT BOUNDARY OF A16 PROPERTY DEVELOPMENT
- NO NOISE SENSITIVE USES ON THIS DIRECTION OF FACADE
- LOUVRE LOCATION
- REPRESENTATIVE NOISE SENSITIVE RECEIVER - EXISTING
- REPRESENTATIVE NOISE SENSITIVE RECEIVER - PLANNED
- ↑ NOISE ASSESSMENT POINT
- TENTATIVE STATION FOOTPRINT
- TENTATIVE FEEDER STATION POSITION
- TENTATIVE COOLING TOWER FOOTPRINT

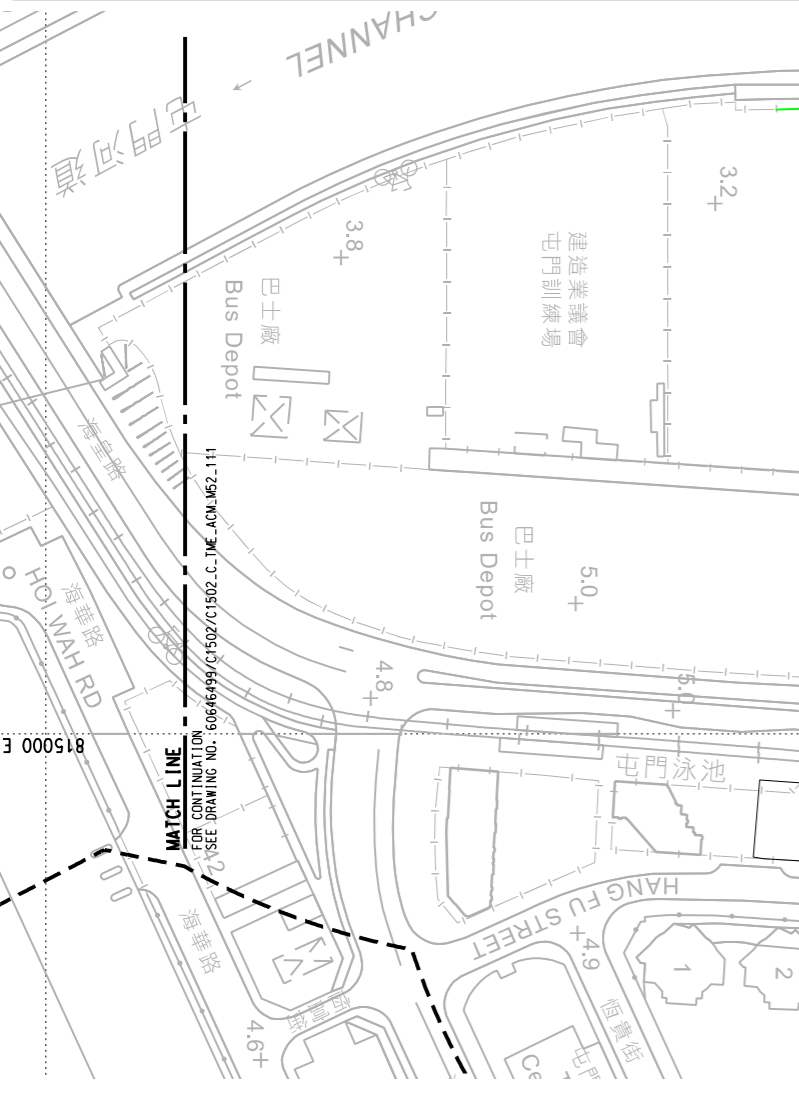

NAP ID	DESCRIPTION	LAND USE	NUMBER OF STOREYS
LMO2	BLOCK 15, LUNG MUN OASIS	R	30
LMO3	BLOCK 16, LUNG MUN OASIS	R	30
GG1	BLOCK 6, GLORIOUS GARDEN	R	28
GG2	BLOCK 7, GLORIOUS GARDEN	R	28







NAP ID	DESCRIPTION	LAND USE	NUMBER OF STOREYS
TE1	THE ESPLANADE	R	20
A16PH1	PLANNED PROPERTY DEVELOPMENT IN AREA 16	R	43
A16PH2	PLANNED PROPERTY DEVELOPMENT IN AREA 16	R	43
A16PH3	PLANNED PROPERTY DEVELOPMENT IN AREA 16	R	34
A16PH4	PLANNED PROPERTY DEVELOPMENT IN AREA 16	R	34
A16PH4a	PLANNED PROPERTY DEVELOPMENT IN AREA 16	R	34
A16PH5	PLANNED PROPERTY DEVELOPMENT IN AREA 16	R	46
A16PH5a	PLANNED PROPERTY DEVELOPMENT IN AREA 16	R	46
A16PH6	PLANNED PROPERTY DEVELOPMENT IN AREA 16	R	34
A16PH10	PLANNED PROPERTY DEVELOPMENT IN AREA 16	R	10

REMARK:
E - EDUCATIONAL INSTITUTION; R - RESIDENTIAL

Maps reproduced with permission of the Director of Lands, © Hong Kong Government

P:\PROJECTS\6064699\CAD_ADMIN\PLT_DRIVER\AS3_COLOUR.plt
 P:\PROJECTS\6064699\REPORT\REPORT\0502\0502_C.TME_ACM_M52_110.dgn
 PRINTED BY: rfvaco
 DATE: 2022/7/26
 PLOT DATE: 2022/7/26
 MODEL NAME: P:\PROJECTS\6064699\REPORT\REPORT\0502\0502_C.TME_ACM_M52_110.dgn
 FILE NAME:

<table border="1" style="width: 100%;"> <tr><td>DRAWN</td><td></td></tr> <tr><td>DESIGNED</td><td></td></tr> <tr><td>CHECKED</td><td></td></tr> <tr><td>APPROVED</td><td></td></tr> <tr><td>DATE</td><td></td></tr> </table> <p style="font-size: 8px;">DO NOT SCALE DRAWINGS. ALL DIMENSIONS SHALL BE VERIFIED ON SITE. © MTR CORPORATION LIMITED 2008 COPYRIGHT IN RESPECT OF THIS DRAWING / DOCUMENT IS OWNED BY THE MTR CORPORATION LIMITED OF HONG KONG. NO REPRODUCTION OF THE DRAWING / DOCUMENT OR ANY PART BY WHATEVER MEANS IS PERMITTED WITHOUT THE PRIOR WRITTEN CONSENT OF THE MTR CORPORATION LIMITED.</p>	DRAWN		DESIGNED		CHECKED		APPROVED		DATE			<p>TUEN MUN SOUTH EXTENSION</p> <p>AECOM</p>	<p>TITLE</p> <p>C1502</p> <p>TUEN MUN SOUTH EXTENSION</p> <p>LOCATIONS OF REPRESENTATIVE NOISE ASSESSMENT POINTS (FIXED PLANT NOISE)</p> <p>(SHEET 1 OF 2)</p>																				
DRAWN																																	
DESIGNED																																	
CHECKED																																	
APPROVED																																	
DATE																																	
<table border="1" style="width: 100%;"> <tr> <th>REV</th> <th>DESCRIPTION</th> <th>BY</th> <th>DATE</th> <th>APPROVED</th> <th>REV</th> <th>DESCRIPTION</th> <th>BY</th> <th>DATE</th> <th>APPROVED</th> </tr> <tr> <td> </td> <td> </td> <td> </td> <td> </td> <td> </td> <td> </td> <td> </td> <td> </td> <td> </td> <td> </td> </tr> </table>	REV	DESCRIPTION	BY	DATE	APPROVED	REV	DESCRIPTION	BY	DATE	APPROVED											<table border="1" style="width: 100%;"> <tr> <th>REV</th> <th>DESCRIPTION</th> <th>BY</th> <th>DATE</th> <th>APPROVED</th> </tr> <tr> <td> </td> <td> </td> <td> </td> <td> </td> <td> </td> </tr> </table>	REV	DESCRIPTION	BY	DATE	APPROVED						<p>CADD REF. C1502_C.TME_ACM_M52_110.dgn</p>	<p>SCALE 1 : 3000 (A3)</p> <p>FIGURE NO. C1502/C/TME/ACM/M52/110</p> <p>REV. A</p>
REV	DESCRIPTION	BY	DATE	APPROVED	REV	DESCRIPTION	BY	DATE	APPROVED																								
REV	DESCRIPTION	BY	DATE	APPROVED																													

- LEGEND:**
-  300m ASSESSMENT AREA
 -  LOUVRE LOCATION
 -  REPRESENTATIVE NOISE SENSITIVE RECEIVER - EXISTING
 -  REPRESENTATIVE NOISE SENSITIVE RECEIVER - PLANNED
 -  NOISE ASSESSMENT POINT
 -  TENTATIVE STATION FOOTPRINT

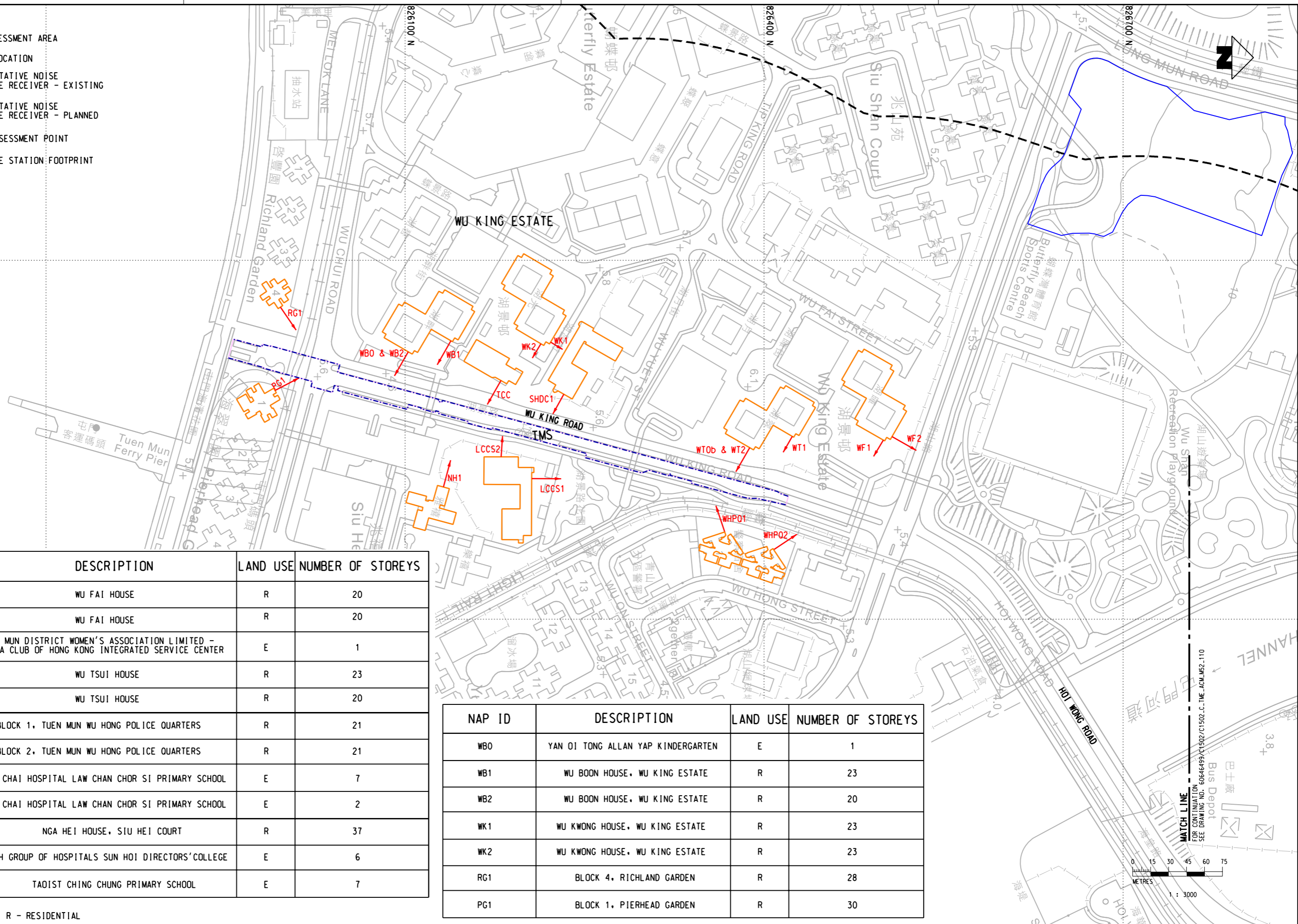

NAP ID	DESCRIPTION	LAND USE	NUMBER OF STOREYS
WF1	WU FAI HOUSE	R	20
WF2	WU FAI HOUSE	R	20
WTOb	TUEN MUN DISTRICT WOMEN'S ASSOCIATION LIMITED - ZONTA CLUB OF HONG KONG INTEGRATED SERVICE CENTER	E	1
WT1	WU TSUI HOUSE	R	23
WT2	WU TSUI HOUSE	R	20
WHP01	BLOCK 1, TUEN MUN WU HONG POLICE QUARTERS	R	21
WHP02	BLOCK 2, TUEN MUN WU HONG POLICE QUARTERS	R	21
LCCS1	YAN CHAI HOSPITAL LAW CHAN CHOR SI PRIMARY SCHOOL	E	7
LCCS2	YAN CHAI HOSPITAL LAW CHAN CHOR SI PRIMARY SCHOOL	E	2
NH1	NGA HEI HOUSE, SIU HEI COURT	R	37
SHDC1	TUNG WAH GROUP OF HOSPITALS SUN HOI DIRECTORS' COLLEGE	E	6
TCC	TAOIST CHING CHUNG PRIMARY SCHOOL	E	7

NAP ID	DESCRIPTION	LAND USE	NUMBER OF STOREYS
WBO	YAN OI TONG ALLAN YAP KINDERGARTEN	E	1
WB1	WU BOON HOUSE, WU KING ESTATE	R	23
WB2	WU BOON HOUSE, WU KING ESTATE	R	20
WK1	WU KWONG HOUSE, WU KING ESTATE	R	23
WK2	WU KWONG HOUSE, WU KING ESTATE	R	23
RG1	BLOCK 4, RICHLAND GARDEN	R	28
PG1	BLOCK 1, PIERHEAD GARDEN	R	30

REMARK:
E - EDUCATIONAL INSTITUTION; R - RESIDENTIAL

Maps reproduced with permission of the Director of Lands, © Hong Kong Government

P:\PROJECTS\6064699\CAD_ADMIN\PLT_DRIVER\A3_COLOUR.plt
 PRINTED BY: rfgccco
 P:\PROJECTS\6064699\REPORT\0502\0502_C.TME_ACM_M52.dgn
 15:56:58
 PLOT DRW:
 MODELNAME:
 FILENAME:

REV	DESCRIPTION	BY	DATE	APPROVED	REV	DESCRIPTION	BY	DATE	APPROVED

DRAWN	
DESIGNED	
CHECKED	
APPROVED	
DATE	

MTR

TUEN MUN SOUTH EXTENSION

AECOM

ORIGINATOR

CADD REF. C1502_C.TME_ACM_M52_111.dgn

TITLE
C1502
TUEN MUN SOUTH EXTENSION
LOCATIONS OF REPRESENTATIVE NOISE ASSESSMENT POINTS
(FIXED NOISE)
(SHEET 2 OF 2)

SCALE 1 : 3000 (A3) FIGURE NO. C1502/C/TME/ACM/M52/111 REV. A