

**Remarks:**  
 1. The drawing does not indicate precise number and locations of retained trees and compensatory trees.  
 2. The precise number of trees to be retained, transplanted, removed and compensated shall be determined and agreed separately with government during the Tree Preservation and Removal Application process under DEVB TC(W) No. 4/2020.  
 3. Landscaping features and forms of structures shown in the drawing are indicative only.

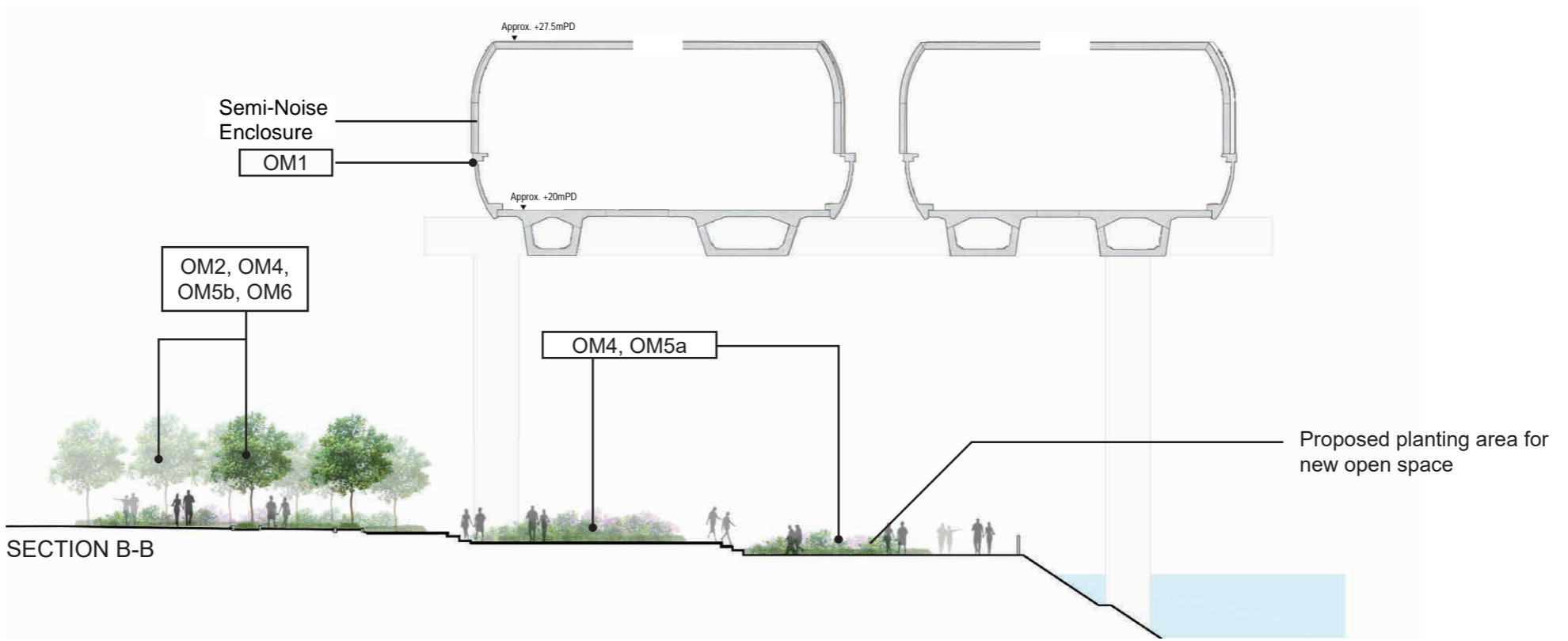
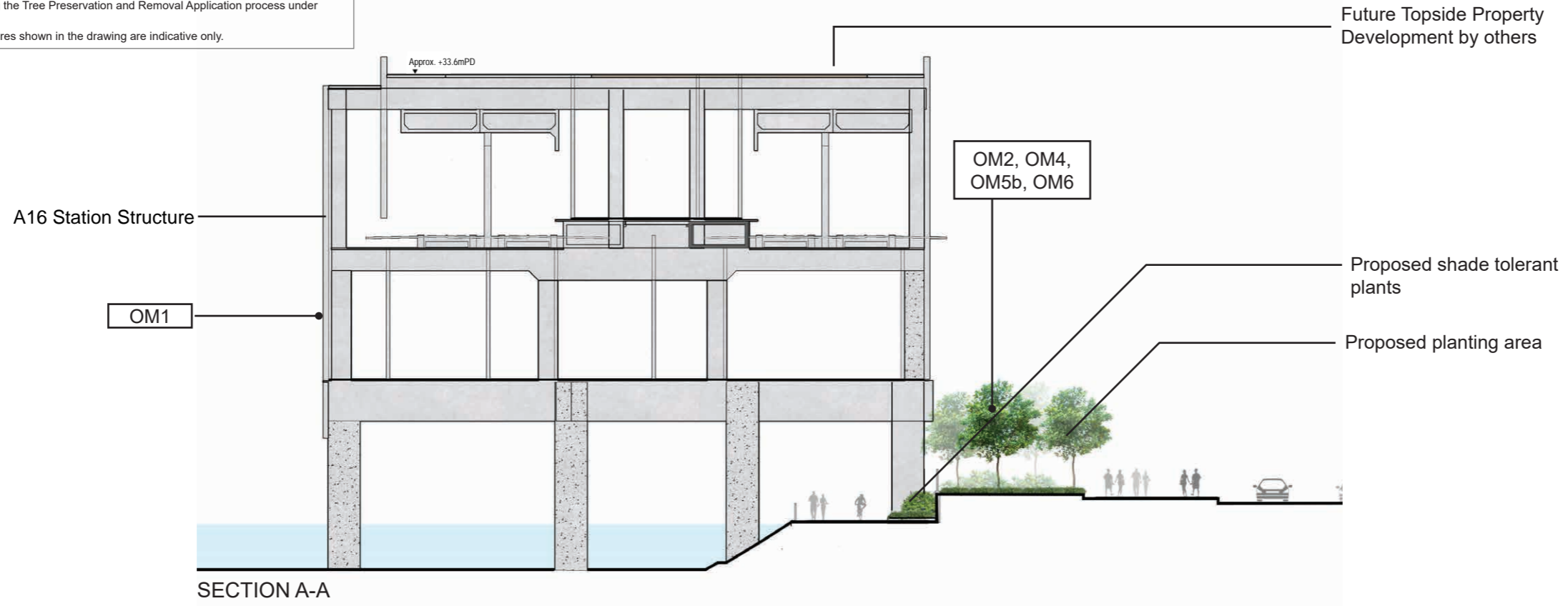

Maps reproduced with permission of the Director of Lands, © Hong Kong Government  
 P:\PROJECTS\60646499\CAD\_ADMIN\PLT\_DRIVER\A3\_COLOUR.plt 8:36:06  
 P:\PROJECTS\60646499\CAD\_ADMIN\PLT\_DRIVER\A3\_COLOUR.plt 8:36:06  
 P:\PROJECTS\60646499\CAD\_ADMIN\PLT\_DRIVER\A3\_COLOUR.plt 8:36:06  
 P:\PROJECTS\60646499\CAD\_ADMIN\PLT\_DRIVER\A3\_COLOUR.plt 8:36:06

REV	DESCRIPTION	BY	DATE	APPROVED	REV	DESCRIPTION	BY	DATE	APPROVED

DRAWN DESIGNED CHECKED APPROVED DATE	<b>MTR</b> TUEN MA EXTENSION <b>AECOM</b>	TITLE <b>C1502</b> TUEN MUN SOUTH EXTENSION IMPLEMENTATION OF MITIGATION MEASURES - SECTION (SHEET 1 OF 4)
DO NOT SCALE DRAWINGS. ALL DIMENSIONS SHALL BE VERIFIED ON SITE. © MTR CORPORATION LIMITED 2008. COPYRIGHT IN RESPECT OF THIS DRAWING / DOCUMENT IS OWNED BY THE MTR CORPORATION LIMITED OF HONG KONG. NO REPRODUCTION OF THE DRAWING / DOCUMENT OR ANY PART BY WHATEVER MEANS IS PERMITTED WITHOUT THE PRIOR WRITTEN CONSENT OF THE MTR CORPORATION LIMITED.	ORIGINATOR <b>AECOM</b>	SCALE N.T.S.
CADD REF. C1502_C_TME_ACM_M57_117.dgn	FIGURE NO. C1502/C/TME/ACM/M57/117	REV. A