

ISO A1 594mm x 841mm
 Approved:
 Checked:
 Designer:
 Project Management Initials:
 Plot File by: LingJ2
 PATH PROJECTS\60631587\DRAWING\REPORT\EA_TWN\EA_TWN_715.DGN
 16/02/2023

LEGEND:

	PROJECT BOUNDARY		SECTION 1 - 6		DIVISION OF CONSTRUCTION WORKS AREA
	DRY WEATHER FLOW INTERCEPTOR (CM4)				DECKS AND ACCESS POINTS WITH RAMPS & STEPPED SEATS
	UNDERGROUND WATER REPLENISHMENT PIPE				PROPOSED PLANTING AREA (OM3)
	CHANNEL BED MODIFICATION (CM6 & DM1)				RE-SURFACING & GREENING ALONG EMBANKMENT (OM1)
	CHANNEL BED MODIFICATION UNDER ROADS/FOOTBRIDGES (CM6 & DM1)				PROVISION OF GREENERY ALONG PARAPET PLANTERS (OM1)
	ENERGY DISSIPATION STRUCTURE AT UPSTREAM (OM1, CM2, CM3, CM4, CM5 & CM6)				PRESERVATION OF OLD & VALUABLE TREE (CM1)
	CHANNEL MODIFICATION WITH BANKSIDE WALKWAYS AND AMENITY AREAS (CM6 & OM1)				PRESERVATION OF TREES OF PARTICULAR INTEREST (CM1)
	IMPROVEMENT OF EXISTING WALKWAYS, LANDSCAPING AND MISCELLANEOUS (CM1, CM2, CM3, OM2 & OM4)				TREE PRESERVATION DURING CONSTRUCTION (CM1)
	IMPROVEMENT OF WALKWAYS: BANKSIDE SEATING AREA / ACCESS POINT WITH STEPPED SEATS (CM1, CM2, CM3, OM2 & OM4)				
	UV DISINFECTION SYSTEM				
	DESILTING WORKS (CM6)				
	UNDERGROUND WATER PUMP FACILITY				

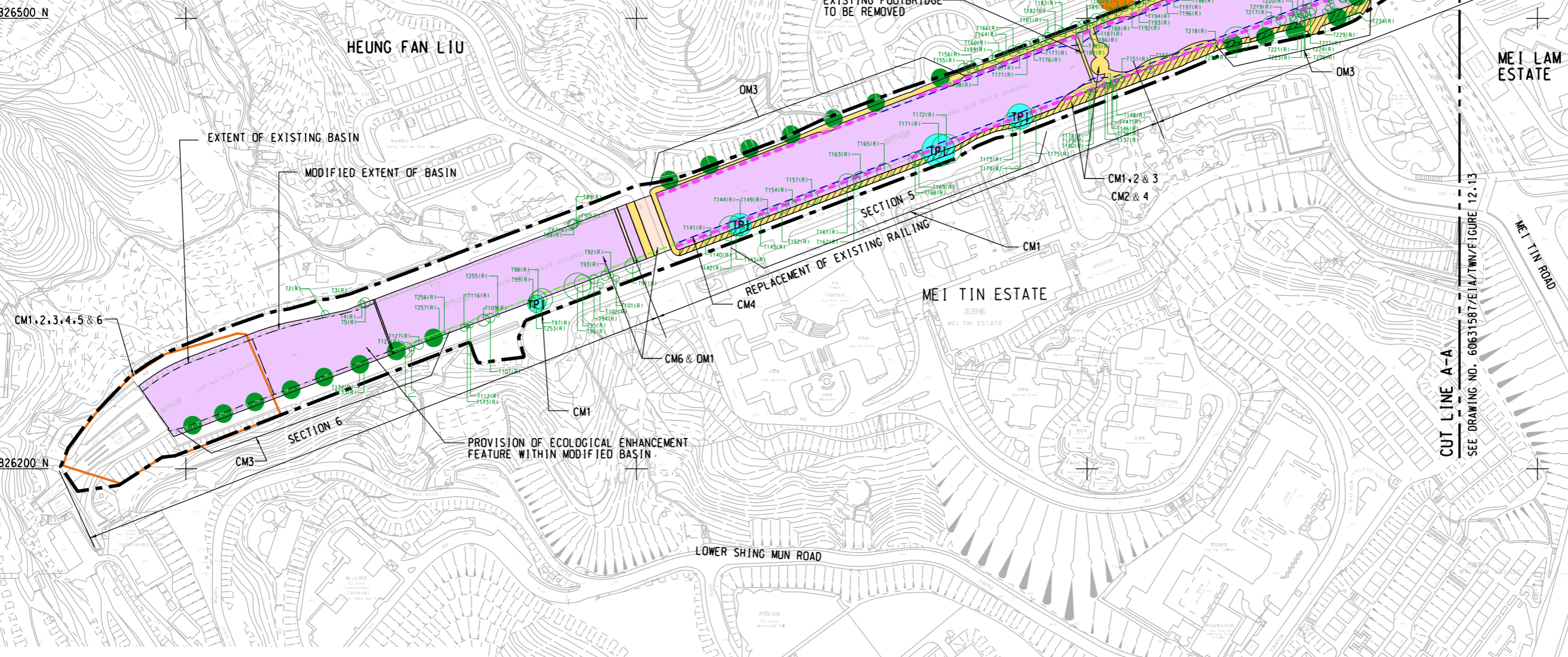

AECOM

PROJECT
 REVITALISATION OF TAI WAI NULLAH AND FO TAN NULLAH - INVESTIGATION

CLIENT
 渠務署
 Drainage Services Department

CONSULTANT
 AECOM Asia Company Ltd.
 www.aecom.com

SUB-CONSULTANTS
 分判工程顧問公司

ISSUE/REVISION

IR	DATE	DESCRIPTION	CHK.

STATUS
 01/1

SCALE
 1:3000

DIMENSION UNIT
 METRES

KEY PLAN
 1:3000

PROJECT NO.
 60631587

AGREEMENT NO.
 CE 54/2019 (DS)

SHEET TITLE
 LANDSCAPE AND VISUAL MITIGATION PLAN

SHEET NUMBER
 60631587/EIA/TWN/FIGURE 12.12

ID No.	LANDSCAPE AND VISUAL MITIGATION MEASURES
CONSTRUCTION PHASE	
CM1	TREE PRESERVATION DURING CONSTRUCTION
CM2	ERECTION OF DECORATIVE SCREEN HOARDING
CM3	CONTROL OF NIGHT-TIME LIGHTING GLARE
CM4	MANAGEMENT OF CONSTRUCTION ACTIVITIES AND FACILITIES
CM5	REINSTATEMENT OF TEMPORARILY DISTURBED LANDSCAPE AREAS
CM6	REINSTATEMENT OF TEMPORARILY DISTURBED WATERCOURSES
OPERATION PHASE	
OM1	GREENING ENHANCEMENT ALONG CHANNEL BED AND EMBANKMENT
OM2	PROVISION OF RECREATIONAL OPPORTUNITY ALONG NULLAH
OM3	COMPENSATORY TREE PLANTING
OM4	SENSITIVE AND AESTHETICALLY PLEASING DESIGN
OM5	TREE TRANSPLANTING

This drawing has been prepared for the use of AECOM's client. It may not be used, modified, reproduced or relied upon by third parties, except as agreed by AECOM or as required by law. AECOM accepts no responsibility, and denies any liability whatsoever, for any loss or damage in any way, that results or may result from the use of this drawing without AECOM's express written consent. All measurements must be obtained from the stated dimensions.