

ISO A1 594mm x 841mm  
 Approved:  
 Checked:  
 Designer:  
 Project Management Initials:

Plot File by: haiquan.zhao 11/02/2023  
 PATH: P:\PROJECTS\60670882\DRAWING\REPORT\A34\A34\_876.dgn

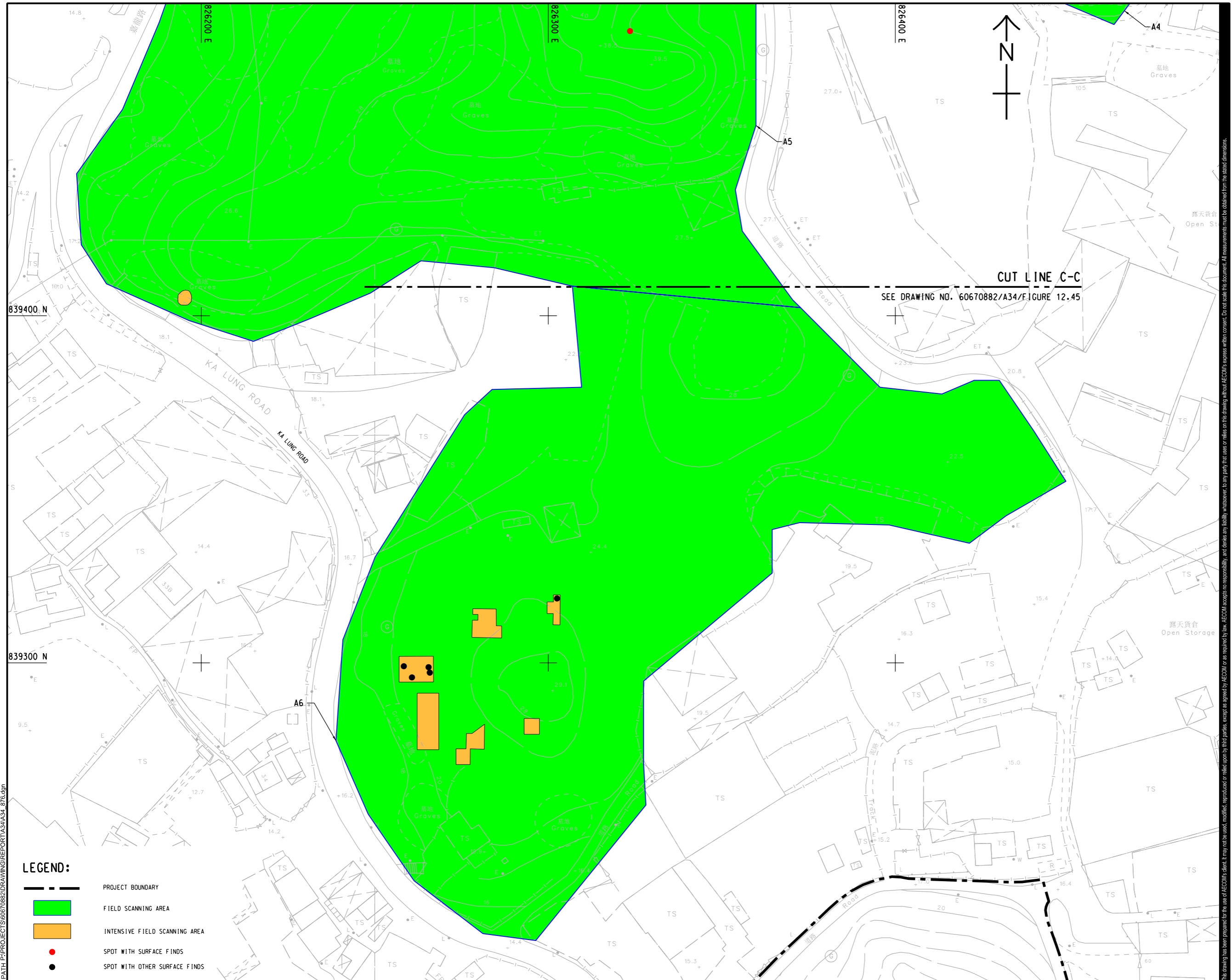

- LEGEND:**
- PROJECT BOUNDARY
  - FIELD SCANNING AREA
  - INTENSIVE FIELD SCANNING AREA
  - SPOT WITH SURFACE FINDS
  - SPOT WITH OTHER SURFACE FINDS



**CUT LINE C-C**  
 SEE DRAWING NO. 60670882/A34/FIGURE 12.45

**AECOM**

**PROJECT**  
 項目  
**FIRST PHASE DEVELOPMENT OF THE NEW TERRITORIES NORTH – SAN TIN / LOK MA CHAU DEVELOPMENT NODE – INVESTIGATION**

**CLIENT**  
 業主  
**土木工程拓展署**  
 Civil Engineering and Development Department  
**規劃署**  
 Planning Department

**CONSULTANT**  
 土庫顧問公司  
 AECOM Asia Company Ltd.  
 www.aecom.com

**SUB-CONSULTANTS**  
 分判土庫顧問公司

**ISSUE/REVISION**  
 修訂

IR	DATE	DESCRIPTION	CHK.

**STATUS**  
 階段

**SCALE**  
 比例  
 A3 1:1000

**DIMENSION UNIT**  
 尺寸單位  
 METRES

**KEY PLAN** A3 1:200000  
 索引圖

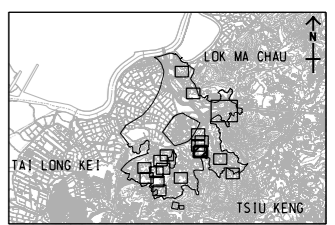

**PROJECT NO.**  
 項目編號  
 60670882

**AGREEMENT NO.**  
 協議編號  
 CE 20/2021

**SHEET TITLE**  
 圖紙名稱  
 FIELD SCANNING AREA A6

**SHEET NUMBER**  
 圖紙編號  
 60670882/A34/FIGURE 12.46

This drawing has been prepared for the use of AECOM's client. It may not be used, modified, reproduced or relied upon by third parties, except as agreed by AECOM or as required by law. AECOM accepts no responsibility, and denies any liability, whatsoever, to any party, that uses or relies on this drawing without AECOM's express written consent. Do not scale this document. All measurements must be obtained from the stated dimensions.