

ISO A1 594mm x 841mm
Approved:
Checked:
Designer:
Project Management Initials:
File Path: P:\PROJECTS\60670882\DRAWING\REPORT\A34\A34_2715.dgn
11/14/2023
11/14/2023
11/14/2023

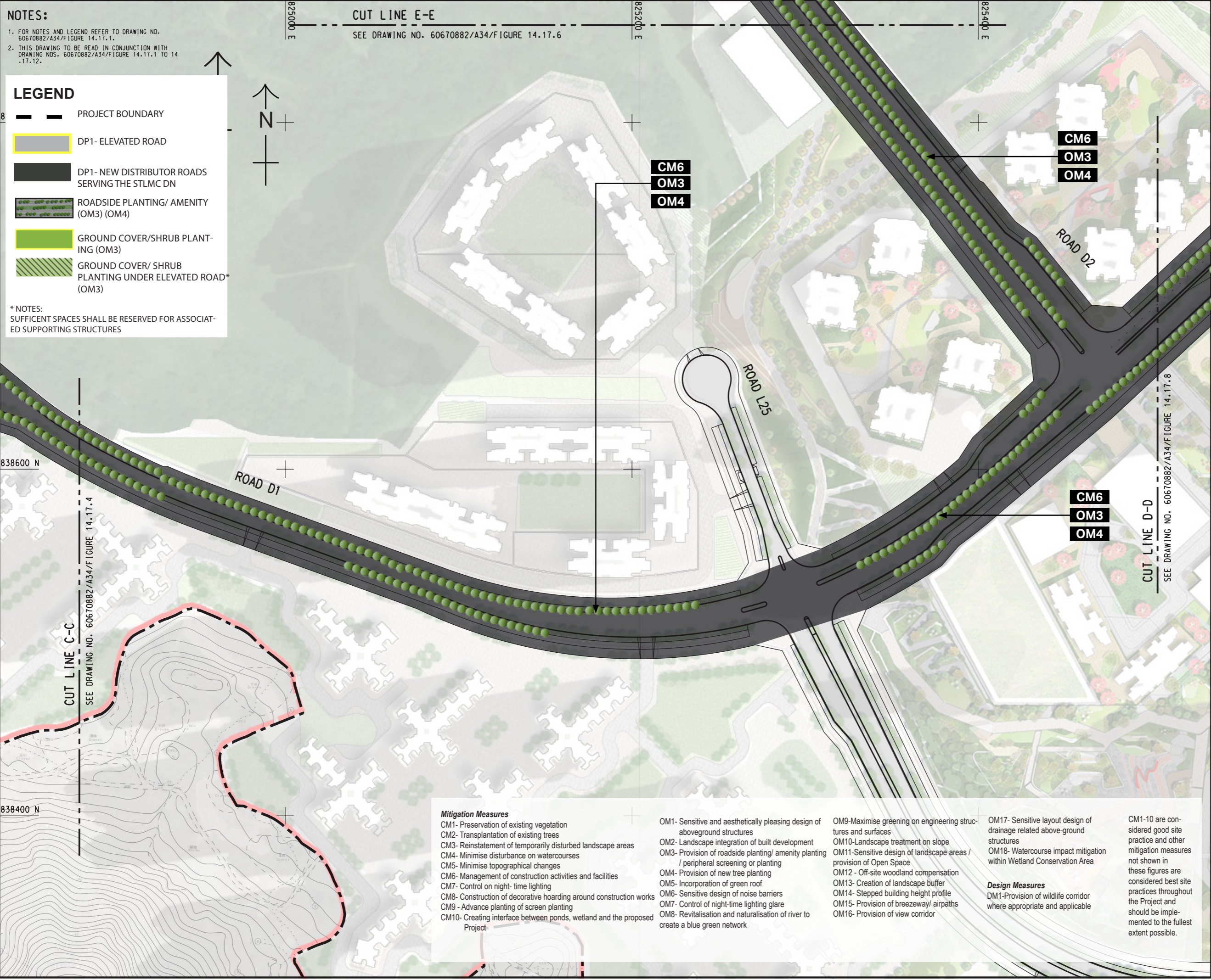

NOTES:

- FOR NOTES AND LEGEND REFER TO DRAWING NO. 60670882/A34/FIGURE 14.17.1.
- THIS DRAWING TO BE READ IN CONJUNCTION WITH DRAWING NOS. 60670882/A34/FIGURE 14.17.1 TO 14.17.12.

LEGEND

- PROJECT BOUNDARY
- DP1- ELEVATED ROAD
- DP1- NEW DISTRIBUTOR ROADS SERVING THE STLMC DN
- ROADSIDE PLANTING/ AMENITY (OM3) (OM4)
- GROUND COVER/SHRUB PLANTING (OM3)
- GROUND COVER/ SHRUB PLANTING UNDER ELEVATED ROAD* (OM3)

* NOTES:
SUFFICIENT SPACES SHALL BE RESERVED FOR ASSOCIATED SUPPORTING STRUCTURES

AECOM

PROJECT
FIRST PHASE DEVELOPMENT OF THE NEW TERRITORIES NORTH – SAN TIN / LOK MA CHAU DEVELOPMENT NODE – INVESTIGATION

CLIENT
CEDD 土木工程拓展署
Civil Engineering and Development Department
規劃署 Planning Department

CONSULTANT
AECOM Asia Company Ltd.
www.aecom.com

SUB-CONSULTANTS

ISSUE/REVISION

NO.	DATE	DESCRIPTION	CHK.

STATUS

SCALE
A3 1 : 2000

DIMENSION UNIT
METRES

KEY PLAN A3 1 : 200000

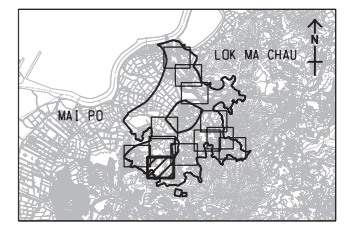

- Mitigation Measures**
- CM1- Preservation of existing vegetation
 - CM2- Transplantation of existing trees
 - CM3- Reinstatement of temporarily disturbed landscape areas
 - CM4- Minimise disturbance on watercourses
 - CM5- Minimise topographical changes
 - CM6- Management of construction activities and facilities
 - CM7- Control on night-time lighting
 - CM8- Construction of decorative hoarding around construction works
 - CM9 - Advance planting of screen planting
 - CM10- Creating interface between ponds, wetland and the proposed Project
- OM1- Sensitive and aesthetically pleasing design of aboveground structures
 - OM2- Landscape integration of built development
 - OM3- Provision of roadside planting/ amenity planting / peripheral screening or planting
 - OM4- Provision of new tree planting
 - OM5- Incorporation of green roof
 - OM6- Sensitive design of noise barriers
 - OM7- Control of night-time lighting glare
 - OM8- Revitalisation and naturalisation of river to create a blue green network
 - OM9- Maximise greening on engineering structures and surfaces
 - OM10- Landscape treatment on slope
 - OM11- Sensitive design of landscape areas / provision of Open Space
 - OM12 - Off-site woodland compensation
 - OM13- Creation of landscape buffer
 - OM14- Stepped building height profile
 - OM15- Provision of breezeway/ airpaths
 - OM16- Provision of view corridor
 - OM17- Sensitive layout design of drainage related above-ground structures
 - OM18- Watercourse impact mitigation within Wetland Conservation Area
- Design Measures**
- DM1- Provision of wildlife corridor where appropriate and applicable
- CM1-10 are considered good site practice and other mitigation measures not shown in these figures are considered best site practices throughout the Project and should be implemented to the fullest extent possible.

PROJECT NO.
60670882

AGREEMENT NO.
CE 20/2021

SHEET TITLE
Mitigation Measures for DP1

SHEET NUMBER
60670882/A34/FIGURE 14.17.5

SHEET 5 OF 12

This drawing has been prepared for the use of AECOM's client. It may not be used, modified, reproduced or relied upon by third parties, except as agreed by AECOM or as required by law. AECOM accepts no responsibility, and denies any liability whatsoever, to any party that uses or relies on this drawing without AECOM's express written consent. Do not scale this document. All measurements must be obtained from the stated dimensions.