

ISO A1 594mm x 841mm
Approved:
Checked:
Designer:
Project Management Initials:

NOTES:
1. FOR NOTES AND LEGEND REFER TO DRAWING NO. 60670882/A34/FIGURE 14.17.10
2. THIS DRAWING TO BE READ IN CONJUNCTION WITH DRAWING NOS. 60670882/A34/FIGURE 14.17.1 TO 14.17.12.

- LEGEND**
- PROJECT BOUNDARY
 - DP1- ELEVATED ROAD
 - DP1- NEW DISTRIBUTOR ROADS SERVING THE STLMC DN
 - ROADSIDE PLANTING/ AMENITY (OM3) (OM4)
 - GROUND COVER/SHRUB PLANTING (OM3)
 - GROUND COVER/ SHRUB PLANTING UNDER ELEVATED ROAD* (OM3)

* NOTES:
SUFFICIENT SPACES SHALL BE RESERVED FOR ASSOCIATED SUPPORTING STRUCTURES

CUT LINE I-I
SEE DRAWING NO. 60670882/A34/FIGURE 14.17.10

CUT LINE J-J
SEE DRAWING NO. 60670882/A34/FIGURE 14.17.11

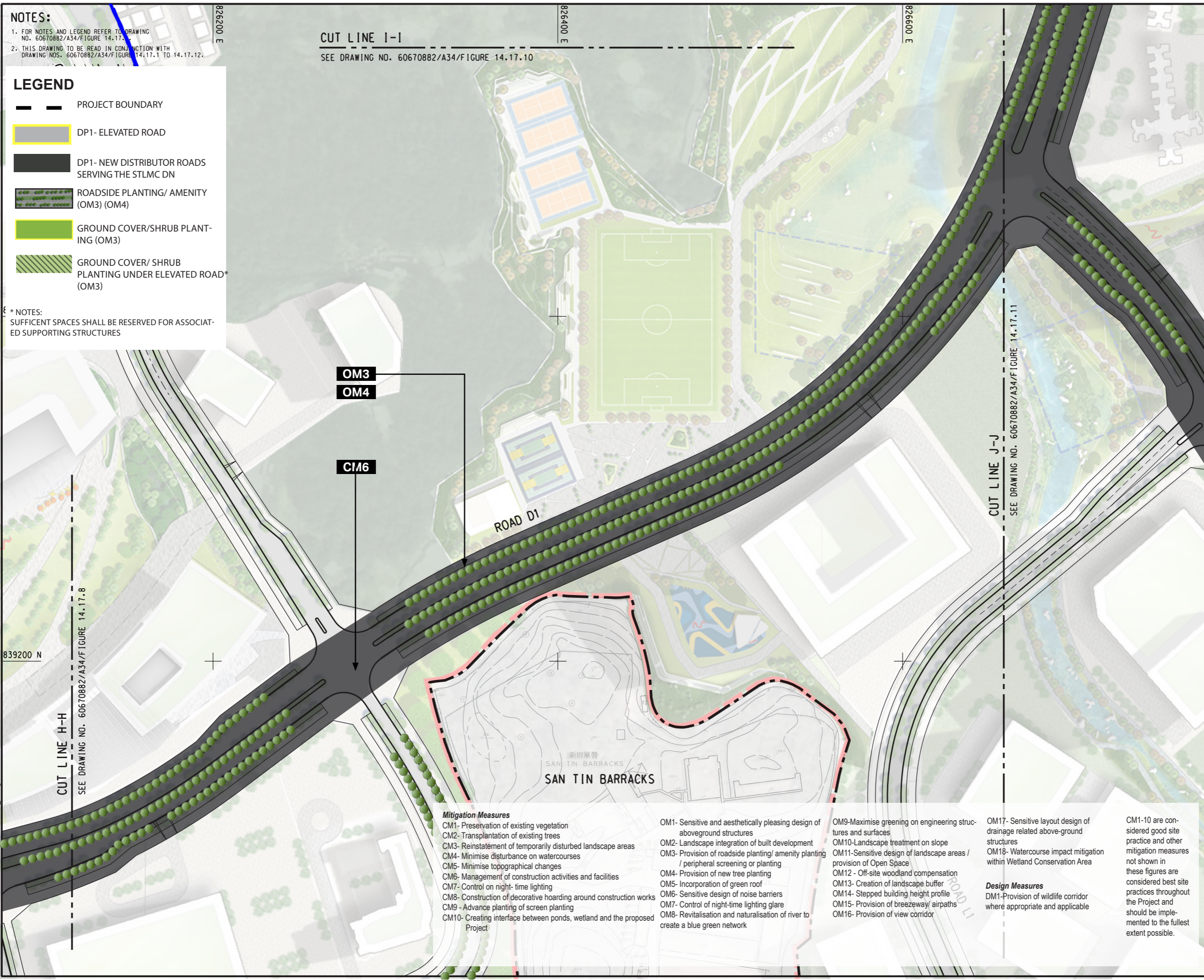

- Mitigation Measures**
- CM1- Preservation of existing vegetation
 - CM2- Transplantation of existing trees
 - CM3- Reinstatement of temporarily disturbed landscape areas
 - CM4- Minimise disturbance on watercourses
 - CM5- Minimise topographical changes
 - CM6- Management of construction activities and facilities
 - CM7- Control on night- time lighting
 - CM8- Construction of decorative hoarding around construction works
 - CM9- Advance planting of screen planting
 - CM10- Creating interface between ponds, wetland and the proposed Project

- OM1- Sensitive and aesthetically pleasing design of aboveground structures
- OM2- Landscape integration of built development
- OM3- Provision of roadside planting/ amenity planting / peripheral screening or planting
- OM4- Provision of new tree planting
- OM5- Incorporation of green roof
- OM6- Sensitive design of noise barriers
- OM7- Control of night-time lighting glare
- OM8- Revitalisation and naturalisation of river to create a blue green network

- OM9- Maximise greening on engineering structures and surfaces
- OM10- Landscape treatment on slope
- OM11- Sensitive design of landscape areas / provision of Open Space
- OM12 - Off-site woodland compensation
- OM13- Creation of landscape buffer
- OM14- Stepped building height profile
- OM15- Provision of breezeway/ airpaths
- OM16- Provision of view corridor

- OM17- Sensitive layout design of drainage related above-ground structures
 - OM18- Watercourse impact mitigation within Wetland Conservation Area
- Design Measures**
- DM1- Provision of wildlife corridor where appropriate and applicable

CM1-10 are considered good site practices and other mitigation measures not shown in these figures are considered best site practices throughout the Project and should be implemented to the fullest extent possible.



PROJECT
FIRST PHASE DEVELOPMENT OF THE NEW TERRITORIES NORTH – SAN TIN / LOK MA CHAU DEVELOPMENT NODE – INVESTIGATION

CLIENT
CEDD 土木工程拓展署
Civil Engineering and Development Department
規劃署
Planning Department

CONSULTANT
AECOM Asia Company Ltd.
www.aecom.com

SUB-CONSULTANTS

ISSUE/REVISION

NO.	DATE	DESCRIPTION	CHK.

STATUS
階段

SCALE 比例: A3 1 : 2000
DIMENSION UNIT 尺寸單位: METRES

KEY PLAN 索引圖: A3 1 : 200000

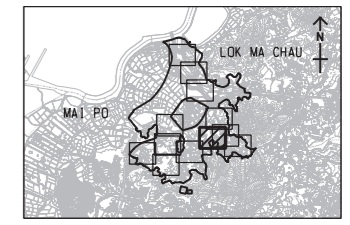

PROJECT NO. 項目編號: 60670882
AGREEMENT NO. 協議編號: CE 20/2021

SHEET TITLE 圖紙名稱: Mitigation Measures for DP1

SHEET NUMBER 圖紙編號: 60670882/A34/FIGURE 14.17.9

Plot File by: Yiting.Ci 11/4/2023
PATH: P:\PROJECTS\60670882\DRAWING\REPORT\TA3A34-279.dgn

This drawing has been prepared for the use of AECOM's client. It may not be used, modified, reproduced or relied upon by third parties, except as agreed by AECOM or as required by law. AECOM accepts no responsibility, and denies any liability, whatsoever, in any party that uses or relies on this drawing, without AECOM's express written consent. Do not scale. All measurements must be obtained from the stated dimensions.