

ISO A1 594mm x 841mm
Approved:
Checked:
Designer:
Project Management Initials:
Plot File by: Yifeng.CI 11/14/2023
PATH P:\PROJECTS\60670882\DRAWING\REPORT\A34\A34_385.dgn

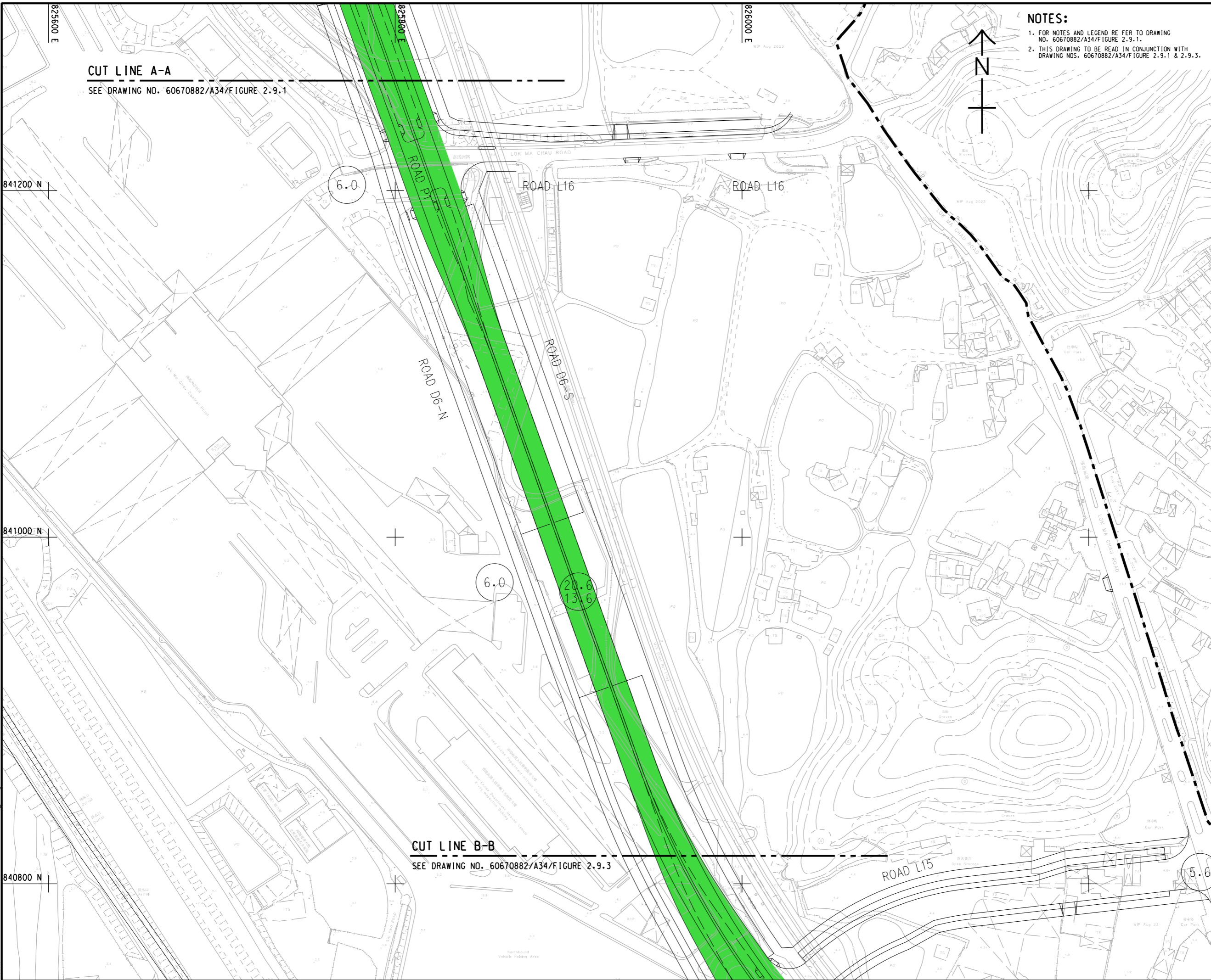

CUT LINE A-A

SEE DRAWING NO. 60670882/A34/FIGURE 2.9.1

CUT LINE B-B

SEE DRAWING NO. 60670882/A34/FIGURE 2.9.3

NOTES:

1. FOR NOTES AND LEGEND REFER TO DRAWING NO. 60670882/A34/FIGURE 2.9.1.
2. THIS DRAWING TO BE READ IN CONJUNCTION WITH DRAWING NOS. 60670882/A34/FIGURE 2.9.1 & 2.9.3.

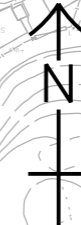

PROJECT

FIRST PHASE DEVELOPMENT OF THE NEW TERRITORIES NORTH – SAN TIN / LOK MA CHAU DEVELOPMENT NODE – INVESTIGATION

CLIENT



CONSULTANT

AECOM Asia Company Ltd.
www.aecom.com

SUB-CONSULTANTS

ISSUE/REVISION

IR	DATE	DESCRIPTION	CHK.

STATUS

SCALE

A3 1 : 2000

DIMENSION UNIT

METRES

KEY PLAN

A3 1 : 200000

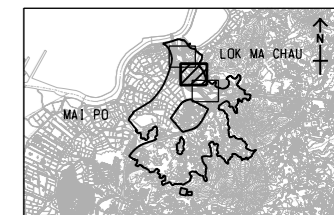

PROJECT NO.

60670882

AGREEMENT NO.

CE 20/2021

SHEET TITLE

GENERAL LAYOUT OF NEW DISTRICT DISTRIBUTOR ROAD (ROAD D6)

SHEET NUMBER

60670882/A34/FIGURE 2.9.2

This drawing has been prepared for the use of AECOM's client. It may not be used, modified, reproduced or relied upon by third parties, except as agreed by AECOM or as required by law. AECOM accepts no responsibility, and disclaims any liability whatsoever, for any part, that uses or relies on this drawing without AECOM's express written consent. All measurements must be obtained from the stated dimensions.