

ISO A1 594mm x 841mm
 Approved:
 Checked:
 Designer:
 Project Management Initials:
 31/12/2024
 PATH PROJECTS/60670882/DRAWING/REPORT/A34/A34_591.dwg

- LEGEND:**
- PROJECT BOUNDARY
 - 300m ASSESSMENT BOUNDARY
 - LOT SUBDIVISION
 - LOCATIONS OF FIXED NOISE SOURCES
 - LOCATIONS OF FIXED NOISE SOURCES FOR NOL PROJECT
 - EXISTING FIXED NOISE SOURCES
 - LINKED SITES

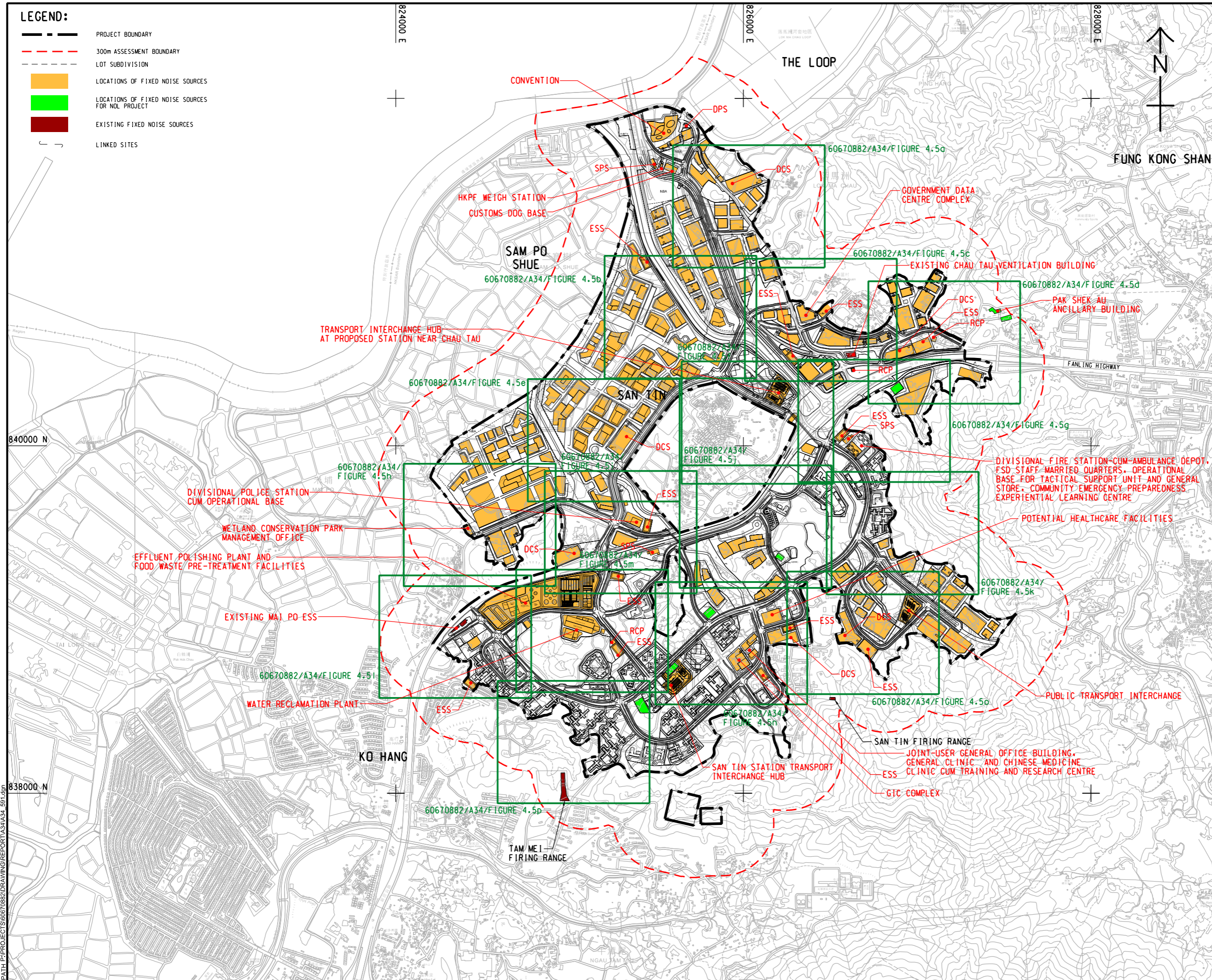

PROJECT
 項目
 FIRST PHASE DEVELOPMENT OF
 THE NEW TERRITORIES NORTH –
 SAN TIN / LOK MA CHAU
 DEVELOPMENT NODE –
 INVESTIGATION

CLIENT
 業主
 土木工程拓展署
 Civil Engineering and
 Development Department
 規劃署
 Planning Department

CONSULTANT
 顧問公司
 AECOM Asia Company Ltd.
 www.aecom.com

SUB-CONSULTANTS
 分包工程師/公司

ISSUE/REVISION
 修訂

IR	DATE	DESCRIPTION	CHK.

STATUS
 階段

SCALE **DIMENSION UNIT**
 比例 尺寸單位
 A3 1 : 20000 METRES

KEY PLAN
 索引圖

PROJECT NO. **AGREEMENT NO.**
 項目編號 協議編號
 60670882 CE 20/2021

SHEET TITLE
 圖紙名稱
 LOCATION OF FIXED NOISE SOURCES
 AND NOISE SENSITIVE RECEIVERS FOR
 FIXED NOISE IMPACT ASSESSMENT
 KEYPLAN

SHEET NUMBER
 圖紙編號
 60670882/A34/FIGURE 4.5

This drawing has been prepared for the use of AECOM's client. It may not be used, modified, reproduced or relied upon by third parties, except as agreed by AECOM or as required by law. AECOM accepts no responsibility, and disclaims any liability, whatsoever, for any part, that uses or relies on this drawing without AECOM's express written consent. All measurements must be obtained from the stated dimensions.

ISO A1 594mm x 841mm
 Approved:
 Checked:
 Designer:
 Project Management Initials:
 2023/12/27
 PATH PROJECTS/60670882/DRAWINGREPORT/A34/A34_592.dgn
 This drawing has been prepared for the use of AECOM's client. It may not be used, modified, reproduced or relied upon by third parties, except as agreed by AECOM or as required by law. AECOM accepts no responsibility, and denies any liability, whatsoever, to any party, that uses or relies on this drawing without AECOM's express written consent. All measurements must be obtained from the stated dimensions.

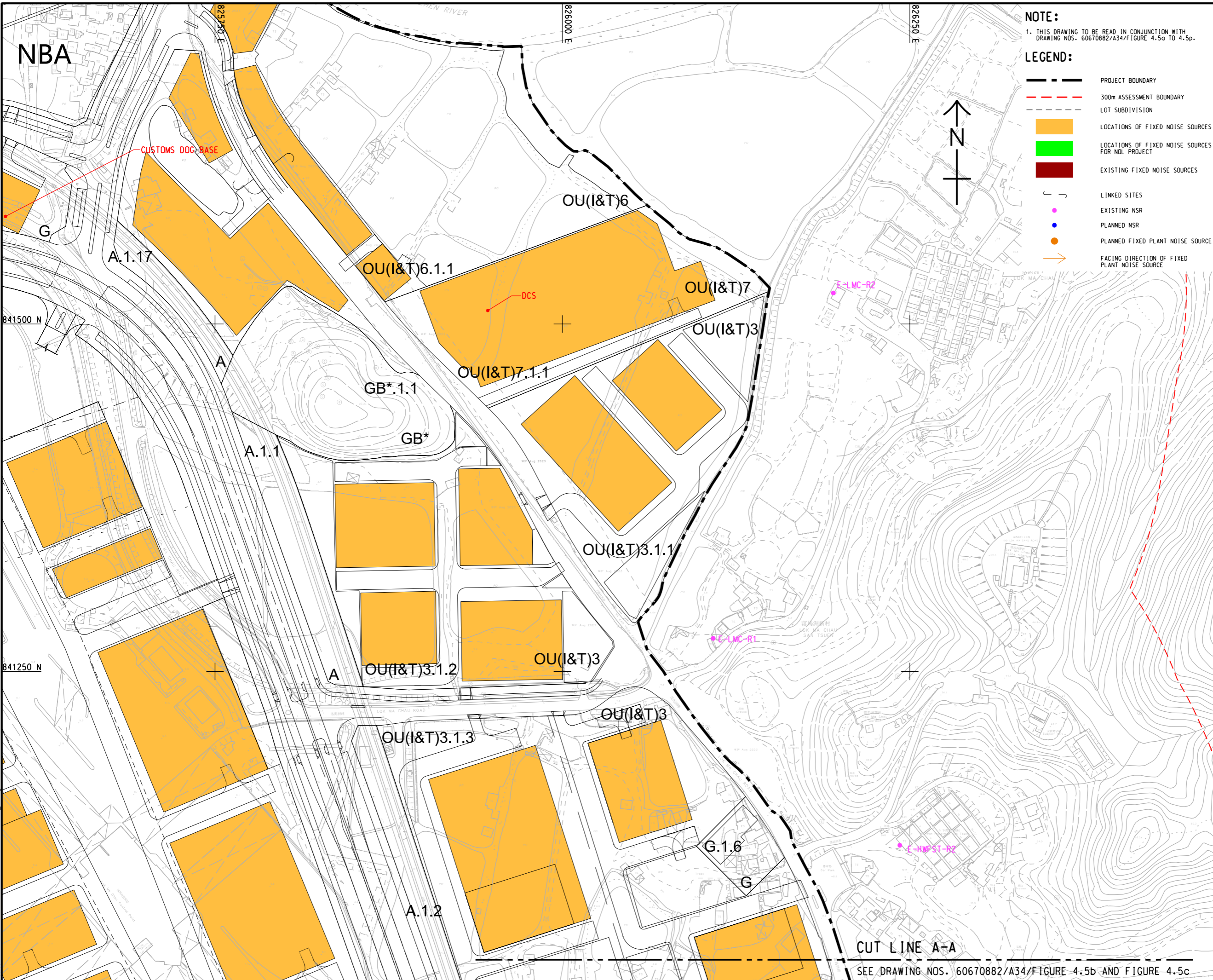

NOTE:
 1. THIS DRAWING TO BE READ IN CONJUNCTION WITH DRAWING NOS. 60670882/A34/F FIGURE 4.5a TO 4.5p.

- LEGEND:**
- PROJECT BOUNDARY
 - 300m ASSESSMENT BOUNDARY
 - LOT SUBDIVISION
 - LOCATIONS OF FIXED NOISE SOURCES
 - LOCATIONS OF FIXED NOISE SOURCES FOR NOL PROJECT
 - EXISTING FIXED NOISE SOURCES
 - LINKED SITES
 - EXISTING NSR
 - PLANNED NSR
 - PLANNED FIXED PLANT NOISE SOURCE
 - FACING DIRECTION OF FIXED PLANT NOISE SOURCE

AECOM

PROJECT
 項目
 FIRST PHASE DEVELOPMENT OF THE NEW TERRITORIES NORTH – SAN TIN / LOK MA CHAU DEVELOPMENT NODE – INVESTIGATION

CLIENT
 業主
 土木工程拓展署
 Civil Engineering and Development Department
 規劃署
 Planning Department

CONSULTANT
 工程顧問公司
 AECOM Asia Company Ltd.
 www.aecom.com

SUB-CONSULTANTS
 分判工程師/顧問公司

ISSUE/REVISION
 修訂

IR	DATE	DESCRIPTION	CHK.

STATUS
 階段

SCALE
 比例
 A3 1 : 2500

DIMENSION UNIT
 尺寸單位
 METRES

KEY PLAN A3 1 : 300000
 索引圖

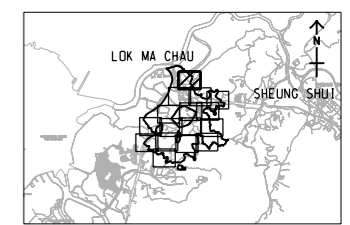

PROJECT NO.
 項目編號
 60670882

AGREEMENT NO.
 協議編號
 CE 20/2021

SHEET TITLE
 圖紙名稱
 LOCATION OF FIXED NOISE SOURCES AND NOISE SENSITIVE RECEIVERS FOR FIXED NOISE IMPACT ASSESSMENT
 SHEET 1 OF 16

SHEET NUMBER
 圖紙編號
 60670882/A34/FIGURE 4.5a

CUT LINE A-A
 SEE DRAWING NOS. 60670882/A34/F FIGURE 4.5b AND FIGURE 4.5c

ISO A1 594mm x 841mm
Approved:
Checked:
Designer:
Project Management Initials:

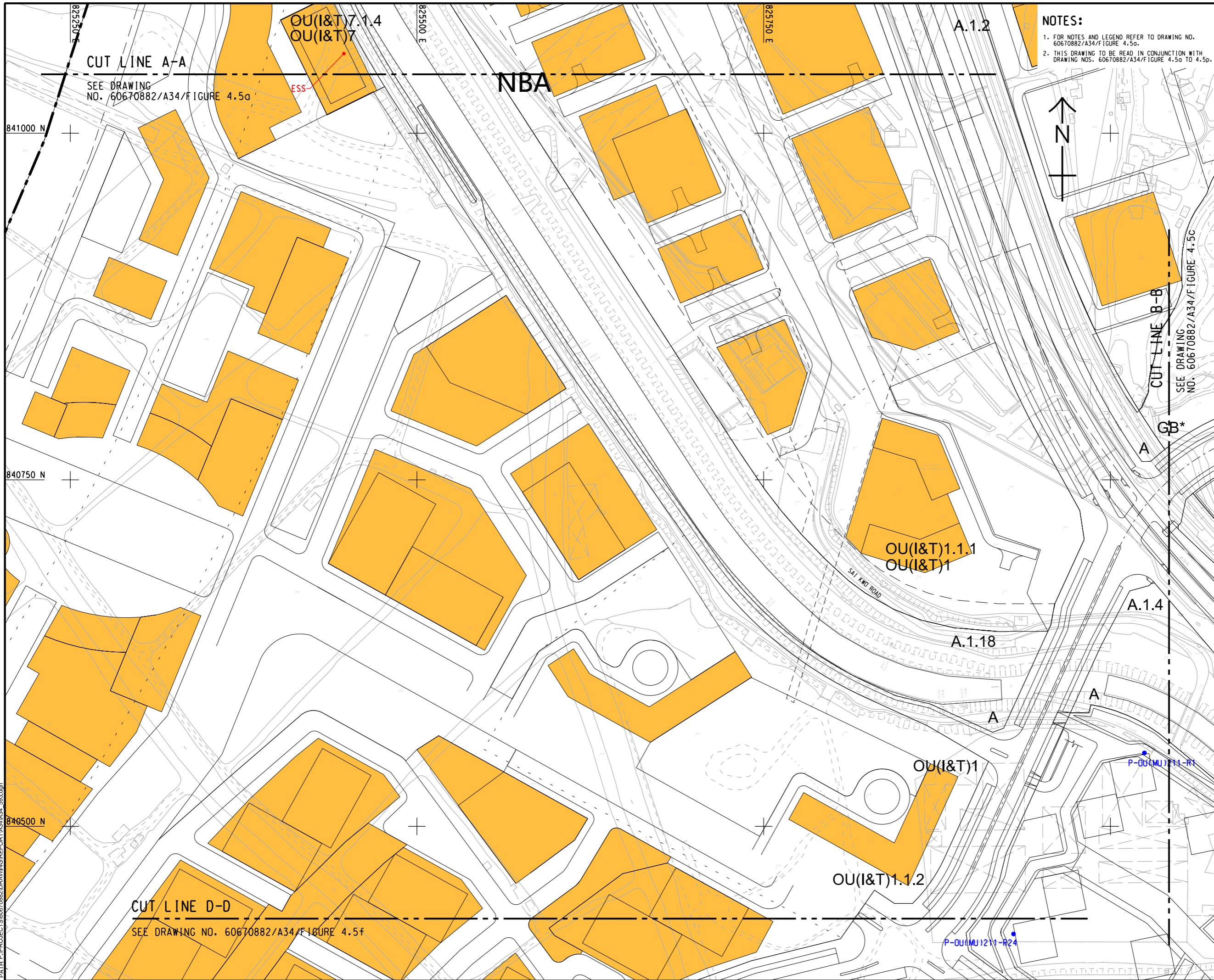

NOTES:
1. FOR NOTES AND LEGEND REFER TO DRAWING NO. 60670882/A34/Figure 4.5a.
2. THIS DRAWING TO BE READ IN CONJUNCTION WITH DRAWING NOS. 60670882/A34/Figure 4.5a TO 4.5p.

AECOM

PROJECT
FIRST PHASE DEVELOPMENT OF THE NEW TERRITORIES NORTH – SAN TIN / LOK MA CHAU DEVELOPMENT NODE – INVESTIGATION

CLIENT
土木工程拓展署
Civil Engineering and Development Department
規劃署
Planning Department

CONSULTANT
AECOM Asia Company Ltd.
www.aecom.com

SUB-CONSULTANTS

ISSUE/REVISION			
IR	DATE	DESCRIPTION	CHK.

STATUS

SCALE
A3 1 : 2500
DIMENSION UNIT
METRES

KEY PLAN
A3 1 : 300000

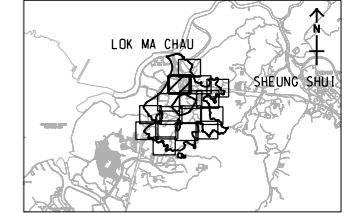

PROJECT NO.
60670882
AGREEMENT NO.
CE 20/2021

SHEET TITLE

LOCATION OF FIXED NOISE SOURCES AND NOISE SENSITIVE RECEIVERS FOR FIXED NOISE IMPACT ASSESSMENT
SHEET 2 OF 16

SHEET NUMBER
60670882/A34/FIGURE 4.5b

This drawing has been prepared for the use of AECOM's client. It may not be used, modified, reproduced or relied upon by third parties, except as agreed by AECOM in writing. AECOM accepts no responsibility, and disclaims any liability, whatsoever, for any part, that less or more on this drawing without AECOM's express written consent. All measurements must be obtained from the stated dimensions.

Plot File by: jlw
DATE: 2023/12/27
PATH: P:\PROJECTS\60670882\DRAWING\REPORT\A34_5b.dgn

ISO A1 594mm x 841mm
 Approved:
 Checked:
 Designer:
 Project Management Initials:
 2023/12/27
 PATH PROJECTS/60670882/DRAWINGREPORT/A34/A34_554.dgn

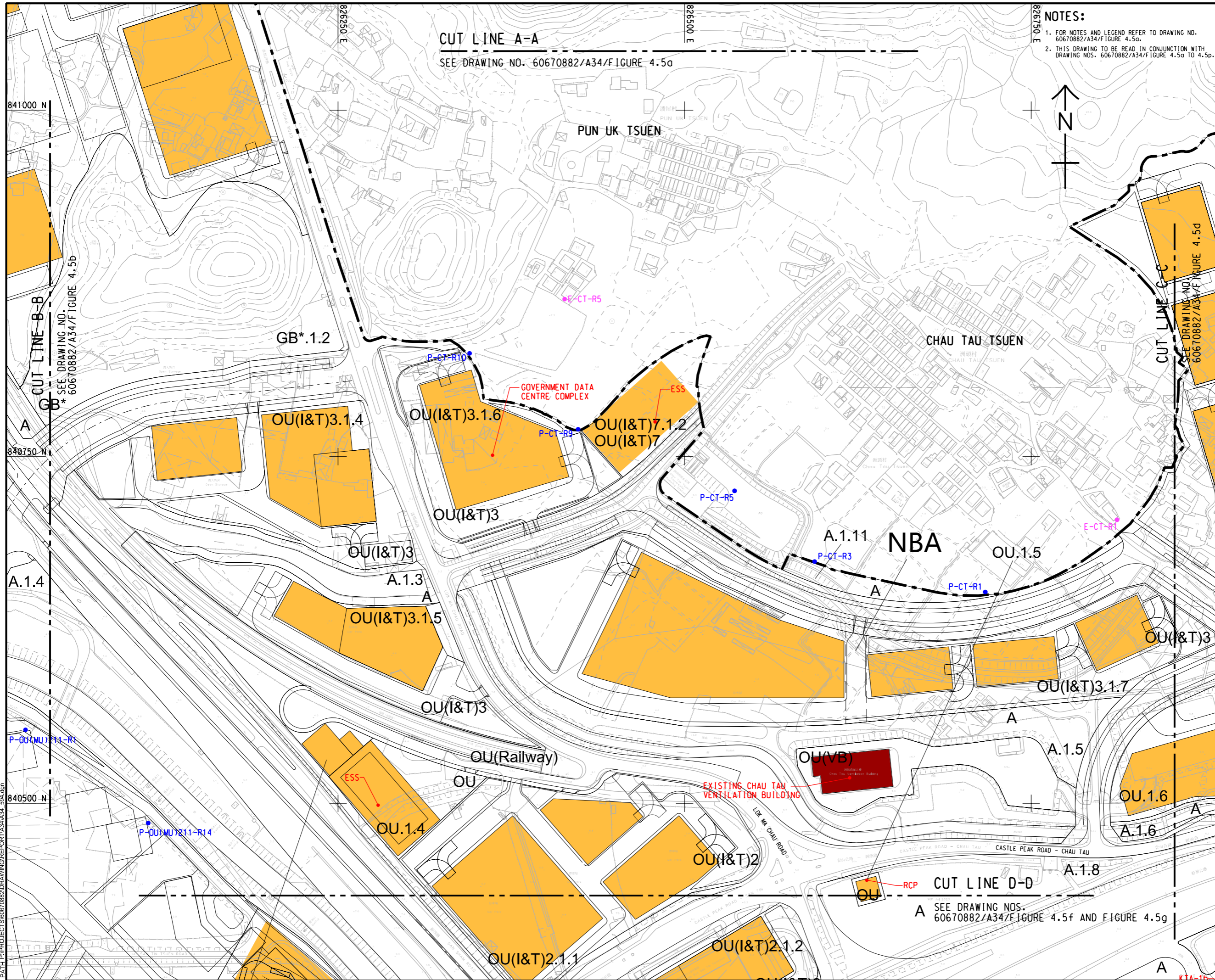

NOTES:

1. FOR NOTES AND LEGEND REFER TO DRAWING NO. 60670882/A34/FIGURE 4.5g.
2. THIS DRAWING TO BE READ IN CONJUNCTION WITH DRAWING NOS. 60670882/A34/FIGURE 4.5a TO 4.5p.

CUT LINE A-A
 SEE DRAWING NO. 60670882/A34/FIGURE 4.5g

CUT LINE C-C
 SEE DRAWING NO. 60670882/A34/FIGURE 4.5d

CUT LINE D-D
 A SEE DRAWING NOS. 60670882/A34/FIGURE 4.5f AND FIGURE 4.5g



PROJECT
 項目
 FIRST PHASE DEVELOPMENT OF THE NEW TERRITORIES NORTH - SAN TIN / LOK MA CHAU DEVELOPMENT NODE - INVESTIGATION

CLIENT
 業主
 土木工程拓展署
 Civil Engineering and Development Department
 規劃署
 Planning Department

CONSULTANT
 工程顧問公司
 AECOM Asia Company Ltd.
 www.aecom.com

SUB-CONSULTANTS
 分判工程顧問公司

ISSUE/REVISION
 修訂

IR	DATE	DESCRIPTION	CHK.

STATUS
 階段

SCALE
 比例
 A3 1 : 2500

DIMENSION UNIT
 尺寸單位
 METRES

KEY PLAN A3 1 : 300000
 索引圖

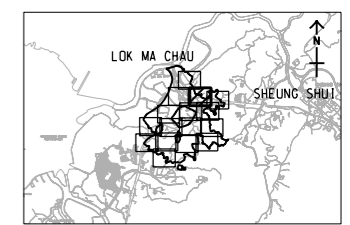

PROJECT NO.
 項目編號
 60670882

AGREEMENT NO.
 協議編號
 CE 20/2021

SHEET TITLE
 圖則名稱
 LOCATION OF FIXED NOISE SOURCES AND NOISE SENSITIVE RECEIVERS FOR FIXED NOISE IMPACT ASSESSMENT
 SHEET 3 OF 16

SHEET NUMBER
 圖則編號
 60670882/A34/FIGURE 4.5c

This drawing has been prepared for the use of AECOM's client. It may not be used, modified, reproduced or relied upon by third parties, except as agreed by AECOM or as required by law. AECOM accepts no responsibility, and denies any liability, whatsoever, for any part, that less or relies on this drawing without AECOM's express written consent. All measurements must be obtained from the stated dimensions.

ISO A1 594mm x 841mm
 Approved:
 Checked:
 Designer:
 Project Management Initials:
 2023/12/27
 PATH PROJECTS/60670882/DRAWINGREPORT/A34/A34_595.dgn
 This drawing has been prepared for the use of AECOM's client. It may not be used, modified, reproduced or relied upon by third parties, except as agreed by AECOM or as required by law. AECOM accepts no responsibility, and disclaims any liability, whatsoever, for any part, that uses or relies on this drawing without AECOM's express written consent. All measurements must be obtained from the stated dimensions.

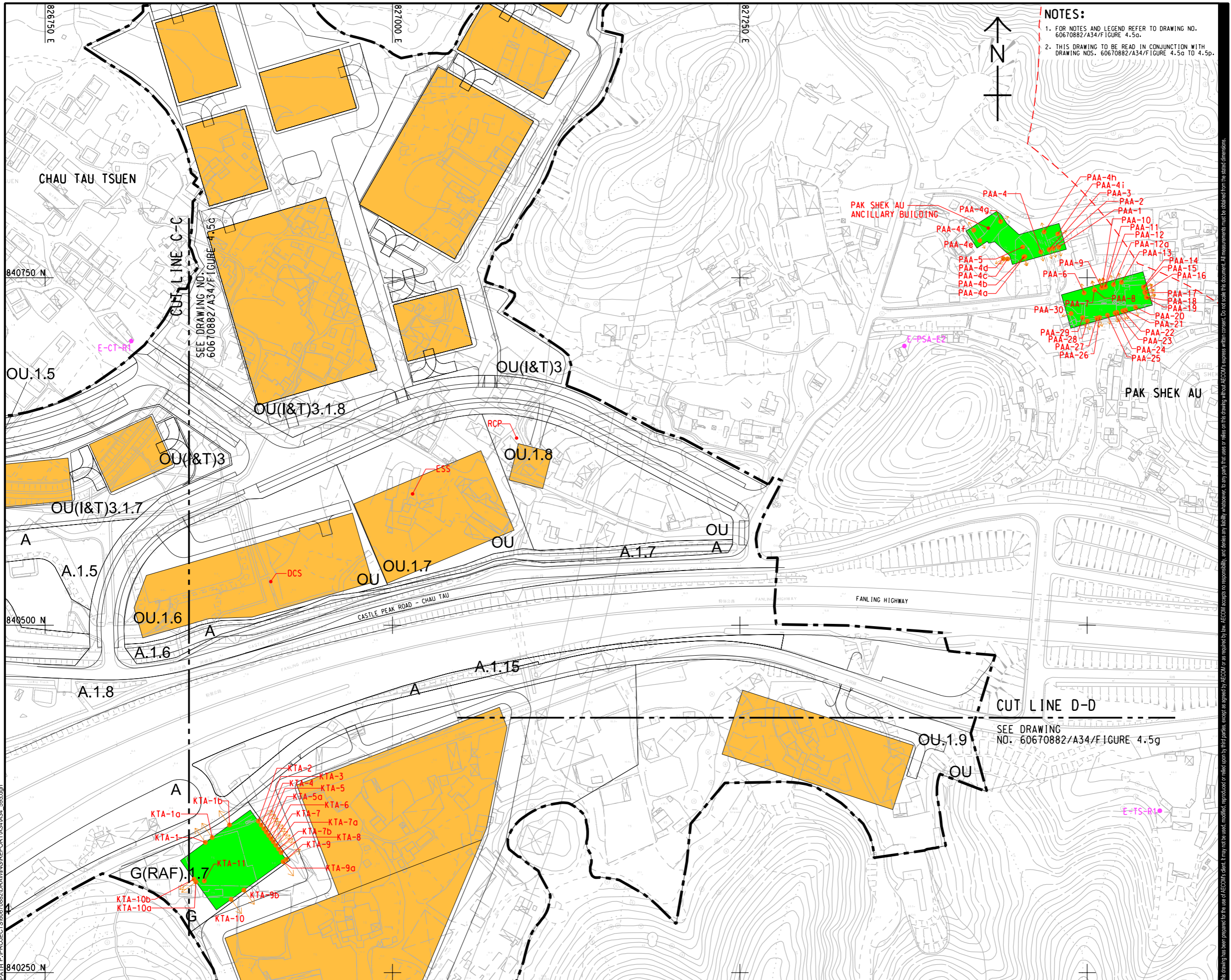

NOTES:
 1. FOR NOTES AND LEGEND REFER TO DRAWING NO. 60670882/A34/FIGURE 4.5a.
 2. THIS DRAWING TO BE READ IN CONJUNCTION WITH DRAWING NOS. 60670882/A34/FIGURE 4.5a TO 4.5p.



PROJECT
 項目
 FIRST PHASE DEVELOPMENT OF THE NEW TERRITORIES NORTH – SAN TIN / LOK MA CHAU DEVELOPMENT NODE – INVESTIGATION

CLIENT
 業主
 土木工程拓展署
 Civil Engineering and Development Department
 規劃署
 Planning Department

CONSULTANT
 顧問公司
 AECOM Asia Company Ltd.
 www.aecom.com

SUB-CONSULTANTS
 分包工程師/顧問公司

ISSUE/REVISION
 修訂

IR	DATE	DESCRIPTION	CHK.
修訂	日期	內容/描述	校核

STATUS
 階段

SCALE
 比例
 A3 1 : 2500

DIMENSION UNIT
 尺寸單位
 METRES

KEY PLAN
 索引圖
 A3 1 : 300000

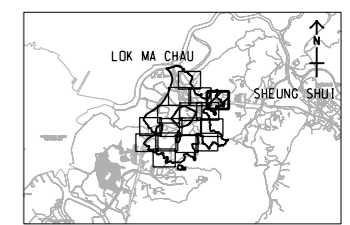

PROJECT NO.
 項目編號
 60670882

AGREEMENT NO.
 協議編號
 CE 20/2021

SHEET TITLE
 圖紙名稱
 LOCATION OF FIXED NOISE SOURCES AND NOISE SENSITIVE RECEIVERS FOR FIXED NOISE IMPACT ASSESSMENT
 SHEET 4 OF 16

SHEET NUMBER
 圖紙編號
 60670882/A34/FIGURE 4.5d

ISO A1 594mm x 841mm
 Approved:
 Checked:
 Designer:
 Project Management Initials:
 2023/12/27
 PATH P-PROJECTS/60670882/DRAWING/REPORT/A34/A34_596.dgn

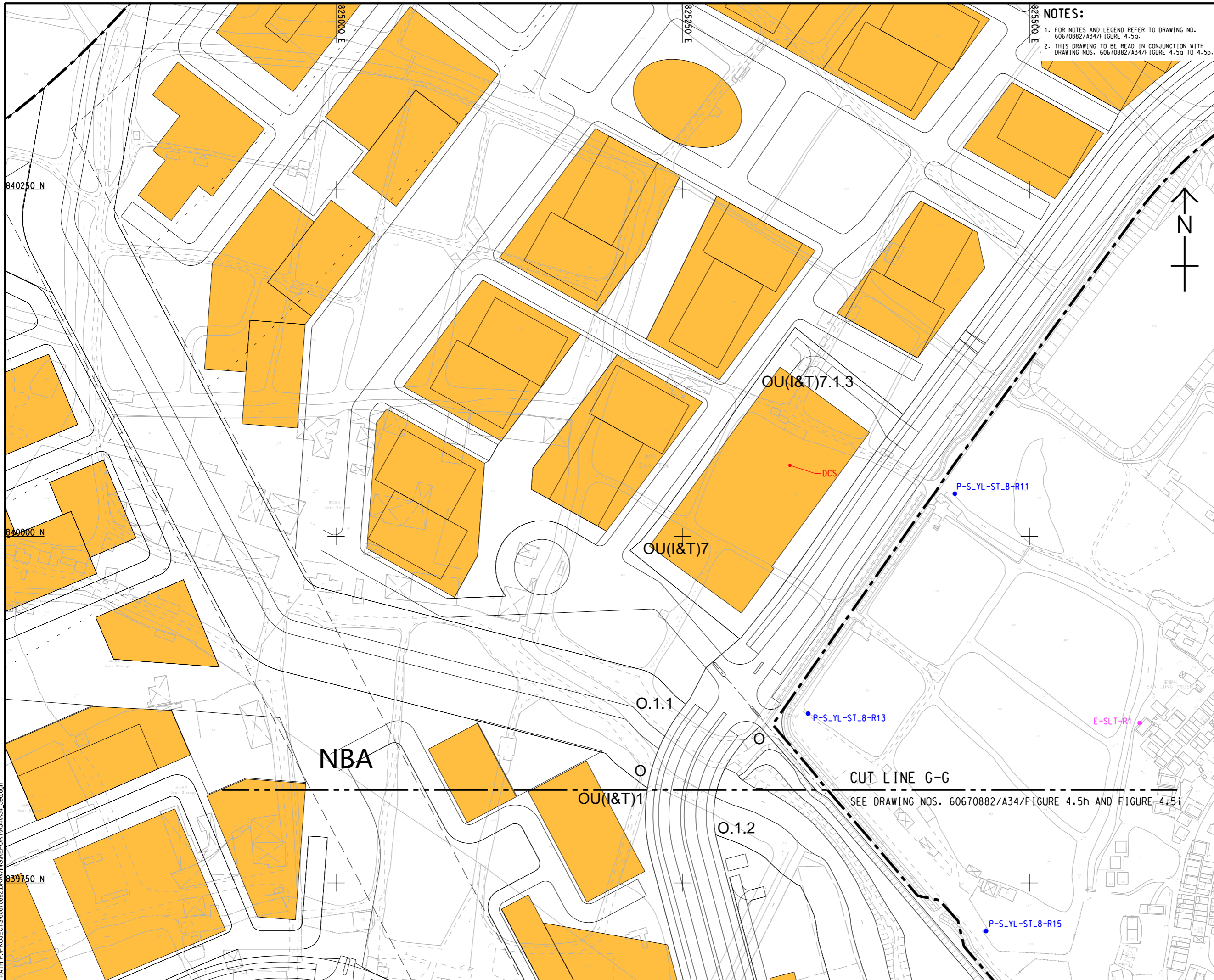

NOTES:

- FOR NOTES AND LEGEND REFER TO DRAWING NO. 60670882/A34/FIGURE 4.5g.
- THIS DRAWING TO BE READ IN CONJUNCTION WITH DRAWING NOS. 60670882/A34/FIGURE 4.5d TO 4.5f.



PROJECT
 項目
 FIRST PHASE DEVELOPMENT OF THE NEW TERRITORIES NORTH – SAN TIN / LOK MA CHAU DEVELOPMENT NODE – INVESTIGATION

CLIENT
 業主
 土木工程拓展署
 Civil Engineering and Development Department
 規劃署
 Planning Department

CONSULTANT
 工程顧問公司
 AECOM Asia Company Ltd.
 www.aecom.com

SUB-CONSULTANTS
 分判工程顧問公司

ISSUE/REVISION
 修訂

IR	DATE	DESCRIPTION	CHK.

STATUS
 階段

SCALE
 比例
 A3 1 : 2500

DIMENSION UNIT
 尺寸單位
 METRES

KEY PLAN A3 1 : 300000
 索引圖

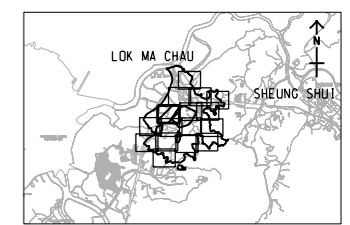

PROJECT NO.
 項目編號
 60670882

AGREEMENT NO.
 協議編號
 CE 20/2021

SHEET TITLE
 圖紙名稱
 LOCATION OF FIXED NOISE SOURCES AND NOISE SENSITIVE RECEIVERS FOR FIXED NOISE IMPACT ASSESSMENT
 SHEET 5 OF 16

SHEET NUMBER
 圖紙編號
 60670882/A34/FIGURE 4.5e

This drawing has been prepared for the use of AECOM's client. It may not be used, modified, reproduced or relied upon by third parties, except as agreed by AECOM or as required by law. AECOM accepts no responsibility, and disclaims any liability whatsoever, for any part, that less or relies on this drawing without AECOM's express written consent. Do not scale this document. All measurements must be obtained from the stated dimensions.

ISO A1 594mm x 841mm
Approved:
Checked:
Designer:
Project Management Initials:
3/1/2024
P:\PROJECTS\60670882\DRAWING\REPORT\A34\A34_697.dwg
Plot File by: YueFB

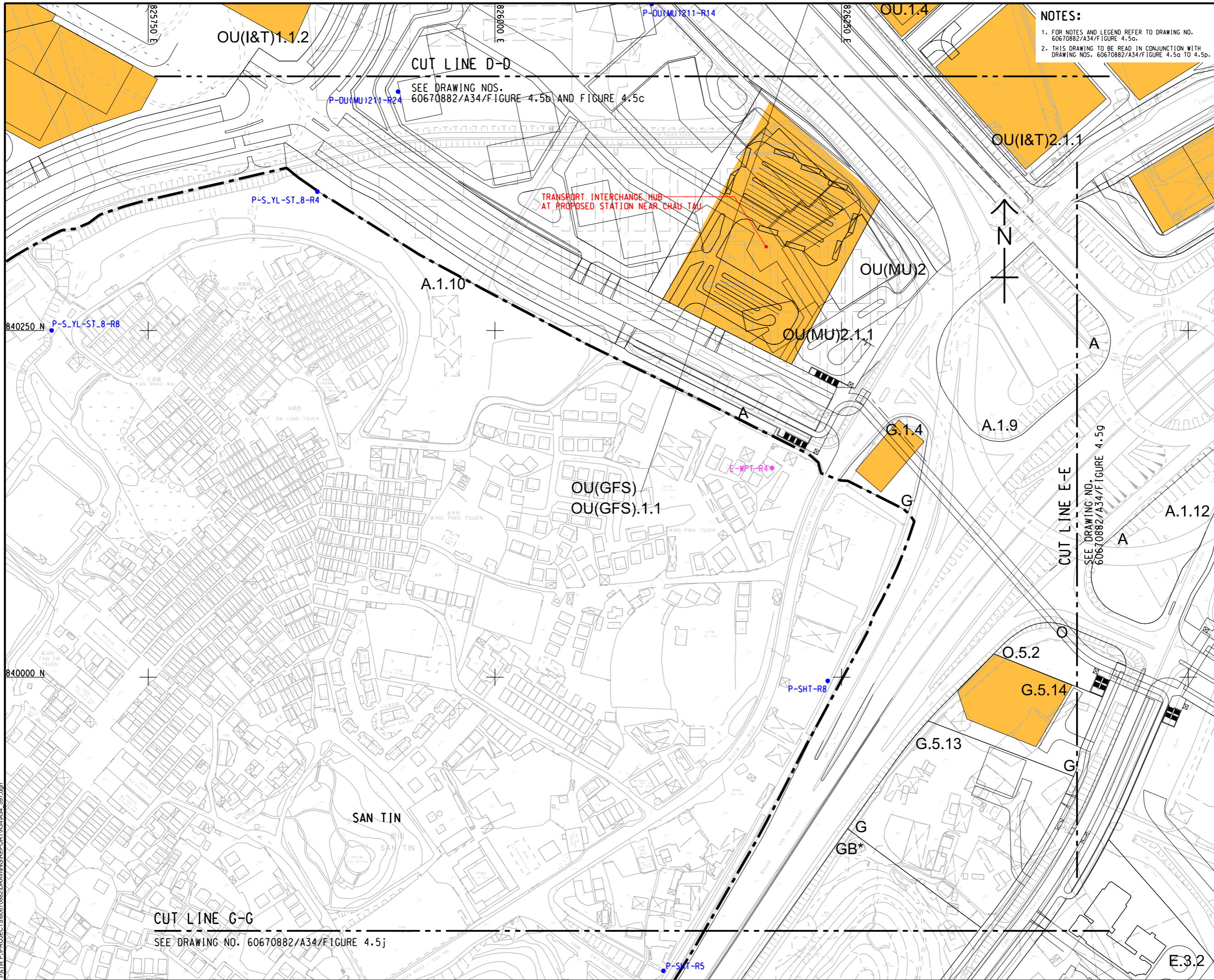

NOTES:
 1. FOR NOTES AND LEGEND REFER TO DRAWING NO. 60670882/A34/FIGURE 4.5a.
 2. THIS DRAWING TO BE READ IN CONJUNCTION WITH DRAWING NOS. 60670882/A34/FIGURE 4.5a TO 4.5p.

CUT LINE D-D
 SEE DRAWING NOS. 60670882/A34/FIGURE 4.5b AND FIGURE 4.5c

CUT LINE G-G
 SEE DRAWING NO. 60670882/A34/FIGURE 4.5j

TRANSPORT INTERCHANGE HUB
 AT PROPOSED STATION NEAR CHAU TAU



PROJECT
 項目
 FIRST PHASE DEVELOPMENT OF THE NEW TERRITORIES NORTH – SAN TIN / LOK MA CHAU DEVELOPMENT NODE – INVESTIGATION

CLIENT
 業主
 土木工程拓展署
 Civil Engineering and Development Department
 規劃署
 Planning Department

CONSULTANT
 工程顧問公司
 AECOM Asia Company Ltd.
 www.aecom.com

SUB-CONSULTANTS
 分判工程師有限公司

ISSUE/REVISION
 修訂

IR	DATE	DESCRIPTION	CHK.

STATUS
 階段

SCALE
 比例
 A3 1 : 2500

DIMENSION UNIT
 尺寸單位
 METRES

KEY PLAN A3 1 : 300000
 索引圖

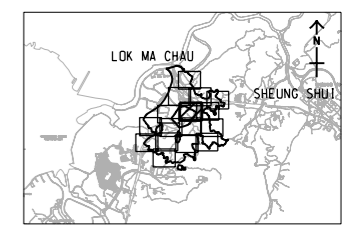

PROJECT NO.
 項目編號
 60670882

AGREEMENT NO.
 協議編號
 CE 20/2021

SHEET TITLE
 圖紙名稱
 LOCATION OF FIXED NOISE SOURCES AND NOISE SENSITIVE RECEIVERS FOR FIXED NOISE IMPACT ASSESSMENT
 SHEET 6 OF 16

SHEET NUMBER
 圖紙編號
 60670882/A34/FIGURE 4.5f

This drawing has been prepared for the use of AECOM's client. It may not be used, modified, reproduced or relied upon by third parties, except as agreed by AECOM or as required by law. AECOM accepts no responsibility, and disclaims any liability whatsoever, for any part, that less or relies on this drawing without AECOM's express written consent. All measurements must be obtained from the stated dimensions.

ISO A1 594mm x 841mm
 Approved:
 Checked:
 Designer:
 Project Management Initials:
 840250 N
 840000 N
 5.13
 2023/12/27
 PATH PROJECTS/60670882/DRAWINGREPORT/A34/A34_595.dgn
 This drawing has been prepared for the use of AECOM's client. It may not be used, modified, reproduced or relied upon by third parties, except as agreed by AECOM or as required by law. AECOM accepts no responsibility, and disclaims any liability, whatsoever, for any part, that is or may be used, without AECOM's express written consent. All measurements must be obtained from the stated dimensions.

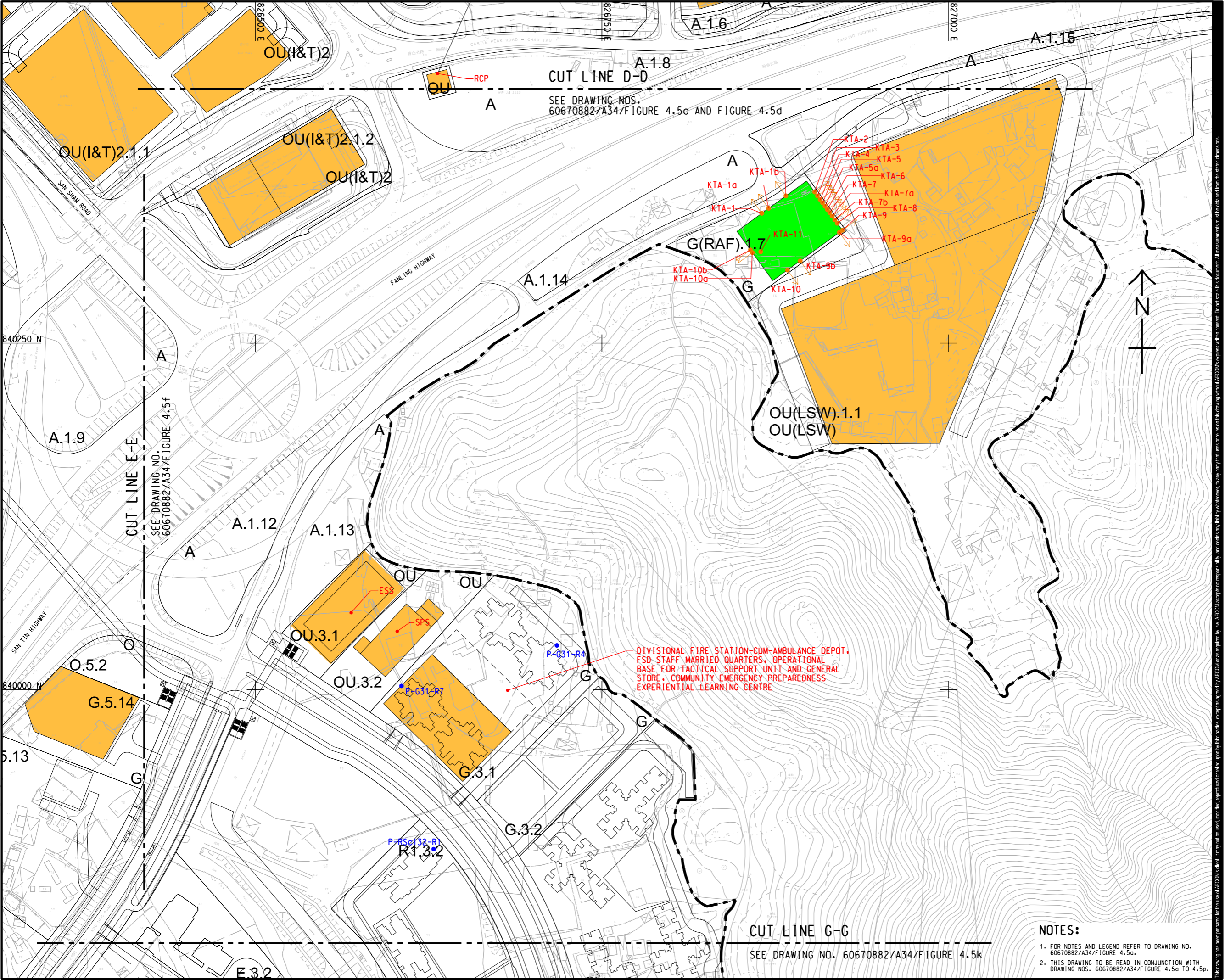

PROJECT
 項目
 FIRST PHASE DEVELOPMENT OF THE NEW TERRITORIES NORTH – SAN TIN / LOK MA CHAU DEVELOPMENT NODE – INVESTIGATION

CLIENT
 業主
 土木工程拓展署
 Civil Engineering and Development Department
 規劃署
 Planning Department

CONSULTANT
 工程顧問公司
 AECOM Asia Company Ltd.
 www.aecom.com

SUB-CONSULTANTS
 分判工程師/顧問公司

ISSUE/REVISION
 修訂

IR	DATE	DESCRIPTION	CHK.

STATUS
 階段

SCALE **DIMENSION UNIT**
 比例 尺寸單位
 A3 1 : 2500 METRES
 米/呎

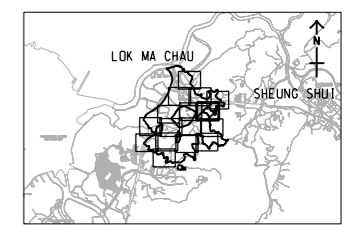

PROJECT NO. **AGREEMENT NO.**
 項目編號 協議編號
 60670882 CE 20/2021

SHEET TITLE
 圖紙名稱
 LOCATION OF FIXED NOISE SOURCES AND NOISE SENSITIVE RECEIVERS FOR FIXED NOISE IMPACT ASSESSMENT
 SHEET 7 OF 16
SHEET NUMBER
 圖紙編號
 60670882/A34/FIGURE 4.5g

NOTES:

- FOR NOTES AND LEGEND REFER TO DRAWING NO. 60670882/A34/FIGURE 4.5a.
- THIS DRAWING TO BE READ IN CONJUNCTION WITH DRAWING NOS. 60670882/A34/FIGURE 4.5a TO 4.5p.

CUT LINE G-G
 SEE DRAWING NO. 60670882/A34/FIGURE 4.5k

ISO A1 594mm x 841mm
 Approved:
 Checked:
 Designer:
 Project Management Initials:
 2023/12/27
 Plot File by: jliw
 PATH: P:\PROJECTS\60670882\DRAWING\REPORT\A34\A34_595.dgn

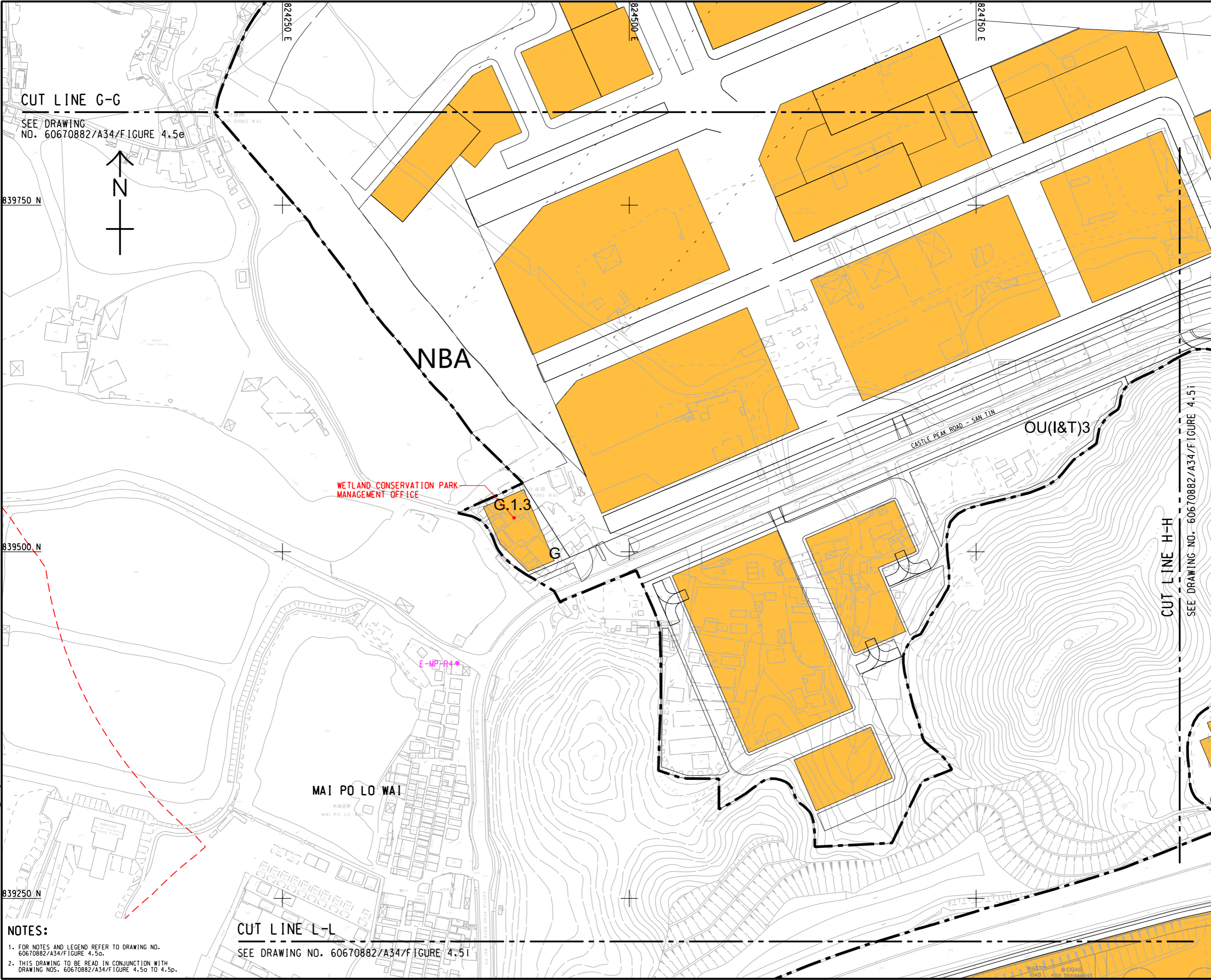

NOTES:

- FOR NOTES AND LEGEND REFER TO DRAWING NO. 60670882/A34/FIGURE 4.5g.
- THIS DRAWING TO BE READ IN CONJUNCTION WITH DRAWING NOS. 60670882/A34/FIGURE 4.5g TO 4.5p.

CUT LINE L-L
 SEE DRAWING NO. 60670882/A34/FIGURE 4.5i



PROJECT
 項目
FIRST PHASE DEVELOPMENT OF THE NEW TERRITORIES NORTH – SAN TIN / LOK MA CHAU DEVELOPMENT NODE – INVESTIGATION

CLIENT
 業主
 土木工程拓展署
 Civil Engineering and Development Department
 規劃署
 Planning Department

CONSULTANT
 顧問公司
 AECOM Asia Company Ltd.
 www.aecom.com

SUB-CONSULTANTS
 分判工程師/顧問公司

ISSUE/REVISION
 修訂

IR	DATE	DESCRIPTION	CHK.
修訂	日期	內容描述	核對

STATUS
 階段

SCALE
 比例
 A3 1 : 2500

DIMENSION UNIT
 尺寸單位
 METRES

KEY PLAN A3 1 : 300000
 索引圖

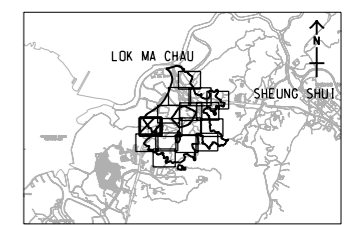

PROJECT NO.
 項目編號
 60670882

AGREEMENT NO.
 協議編號
 CE 20/2021

SHEET TITLE
 圖紙名稱
LOCATION OF FIXED NOISE SOURCES AND NOISE SENSITIVE RECEIVERS FOR FIXED NOISE IMPACT ASSESSMENT
 SHEET 8 OF 16

SHEET NUMBER
 圖紙編號
 60670882/A34/FIGURE 4.5h

This drawing has been prepared for the use of AECOM's client. It may not be used, modified, reproduced or relied upon by third parties, except as agreed by AECOM or as required by law. AECOM accepts no responsibility, and denies any liability whatsoever, to any party that uses or relies on this drawing without AECOM's express written consent. All measurements must be obtained from the stated dimensions.

ISO A1 594mm x 841mm
 Approved:
 Checked:
 Designer:
 Project Management Initials:
 2023/12/27
 PATH PROJECTS/60670882/DRAWINGREPORT/A34/A34_600.dgn
 Plot File by: jlw
 This drawing has been prepared for the use of AECOM's client. It may not be used, modified, reproduced or relied upon by third parties, except as agreed by AECOM or as required by law. AECOM accepts no responsibility and disclaims any liability whatsoever, for any loss or damage, that results or arises from this drawing without AECOM's express written consent. All measurements must be obtained from the stated dimensions.

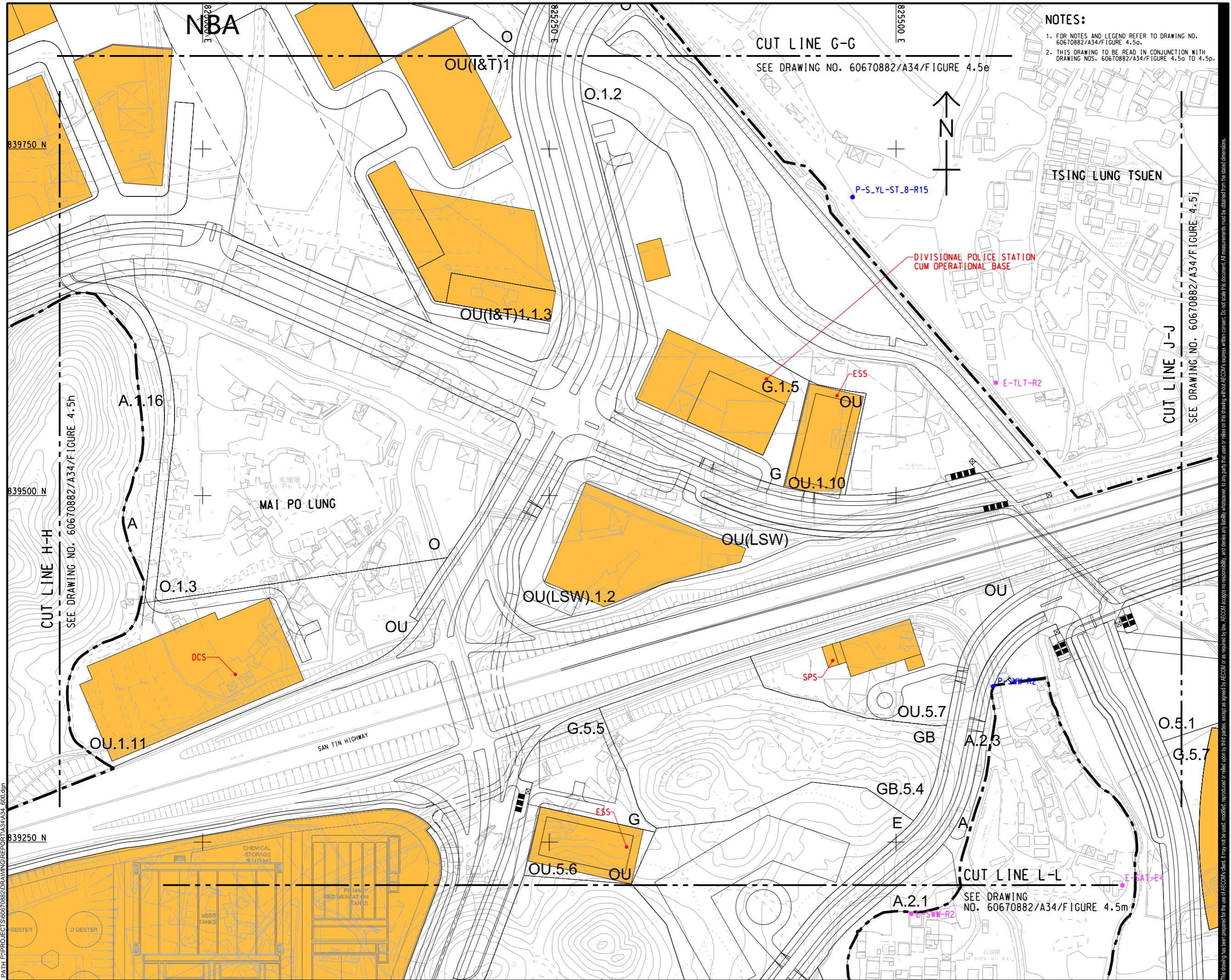

NOTES:

- FOR NOTES AND LEGEND REFER TO DRAWING NO. 60670882/A34/FIGURE 4.5a.
- THIS DRAWING TO BE READ IN CONJUNCTION WITH DRAWING NOS. 60670882/A34/FIGURE 4.5a TO 4.5p.



PROJECT
 項目
 FIRST PHASE DEVELOPMENT OF THE NEW TERRITORIES NORTH – SAN TIN / LOK MA CHAU DEVELOPMENT NODE – INVESTIGATION

CLIENT
 業主
 CEDD 土木工程拓展署
 Civil Engineering and Development Department
 規劃署
 Planning Department

CONSULTANT
 工程顧問公司
 AECOM Asia Company Ltd.
 www.aecom.com

SUB-CONSULTANTS
 分包工程顧問公司

ISSUE/REVISION
 修訂

NO.	DATE	DESCRIPTION	CHK.

STATUS
 階段

SCALE
 比例
 A3 1:2500
DIMENSION UNIT
 尺寸單位
 METRES

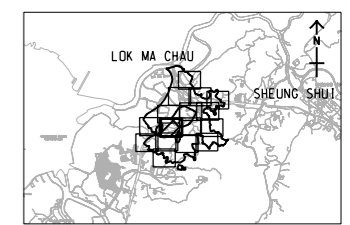

PROJECT NO.
 項目編號
 60670882
AGREEMENT NO.
 協議編號
 CE 20/2021

SHEET TITLE
 圖紙名稱
 LOCATION OF FIXED NOISE SOURCES AND NOISE SENSITIVE RECEIVERS FOR FIXED NOISE IMPACT ASSESSMENT
 SHEET 9 OF 16

SHEET NUMBER
 圖紙編號
 60670882/A34/FIGURE 4.5i

ISO A1 594mm x 841mm
 Approved:
 Checked:
 Designer:
 Project Management Initials:
 Plot File by: jlw 2023/12/27
 PATH: P:\PROJECTS\60670882\DRAWING\REPORT\A34\A34_601.dwg

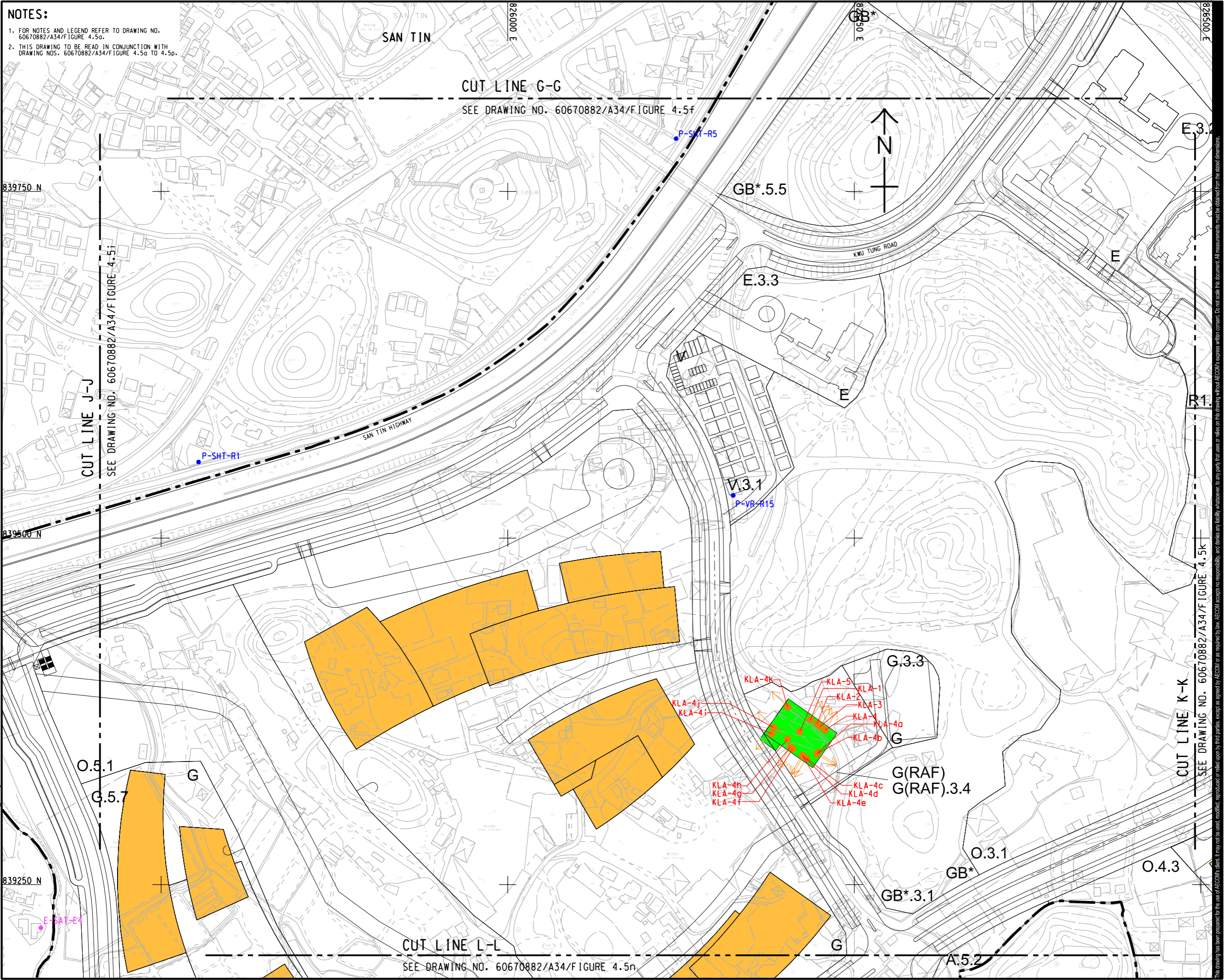

PROJECT
 項目
FIRST PHASE DEVELOPMENT OF THE NEW TERRITORIES NORTH – SAN TIN / LOK MA CHAU DEVELOPMENT NODE – INVESTIGATION

CLIENT
 業主
 **土木工程拓展署**
 Civil Engineering and Development Department
 **規劃署**
 Planning Department

CONSULTANT
 工程顧問公司
 AECOM Asia Company Ltd.
 www.aecom.com

SUB-CONSULTANTS
 分判工程顧問公司

ISSUE/REVISION
 修訂

IR	DATE	DESCRIPTION	CHK.

STATUS
 階段

SCALE
 比例
 A3 1:2500

DIMENSION UNIT
 尺寸單位
 METRES

KEY PLAN A3 1:300000
 索引圖

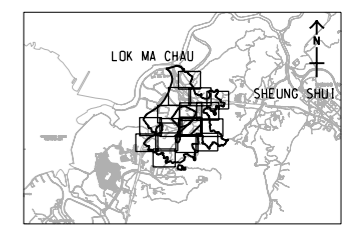

PROJECT NO.
 項目編號
 60670882

AGREEMENT NO.
 協議編號
 CE 20/2021

SHEET TITLE
 圖紙名稱
LOCATION OF FIXED NOISE SOURCES AND NOISE SENSITIVE RECEIVERS FOR FIXED NOISE IMPACT ASSESSMENT
 SHEET 10 OF 16

SHEET NUMBER
 圖紙編號
 60670882/A34/FIGURE 4.5j

This drawing has been prepared for the use of AECOM's client. It may not be used, modified, reproduced or relied upon by third parties, except as agreed by AECOM or as required by law. AECOM accepts no responsibility, and disclaims any liability, whatsoever, for any part, that less or more than this drawing, without AECOM's express written consent. All measurements must be obtained from the stated dimensions.

ISO A1 594mm x 841mm
 Approved:
 Checked:
 Designer:
 Project Management Initials:
 2023/12/27
 PATH PROJECTS/60670882/DRAWINGREPORT/A34/A34_602.dgn
 This drawing has been prepared for the use of AECOM's client. It may not be used, modified, reproduced or relied upon by third parties, except as agreed by AECOM or as required by law. AECOM accepts no responsibility, and denies any liability whatsoever, to any party that uses or relies on this drawing without AECOM's express written consent. All measurements must be obtained from the stated dimensions.

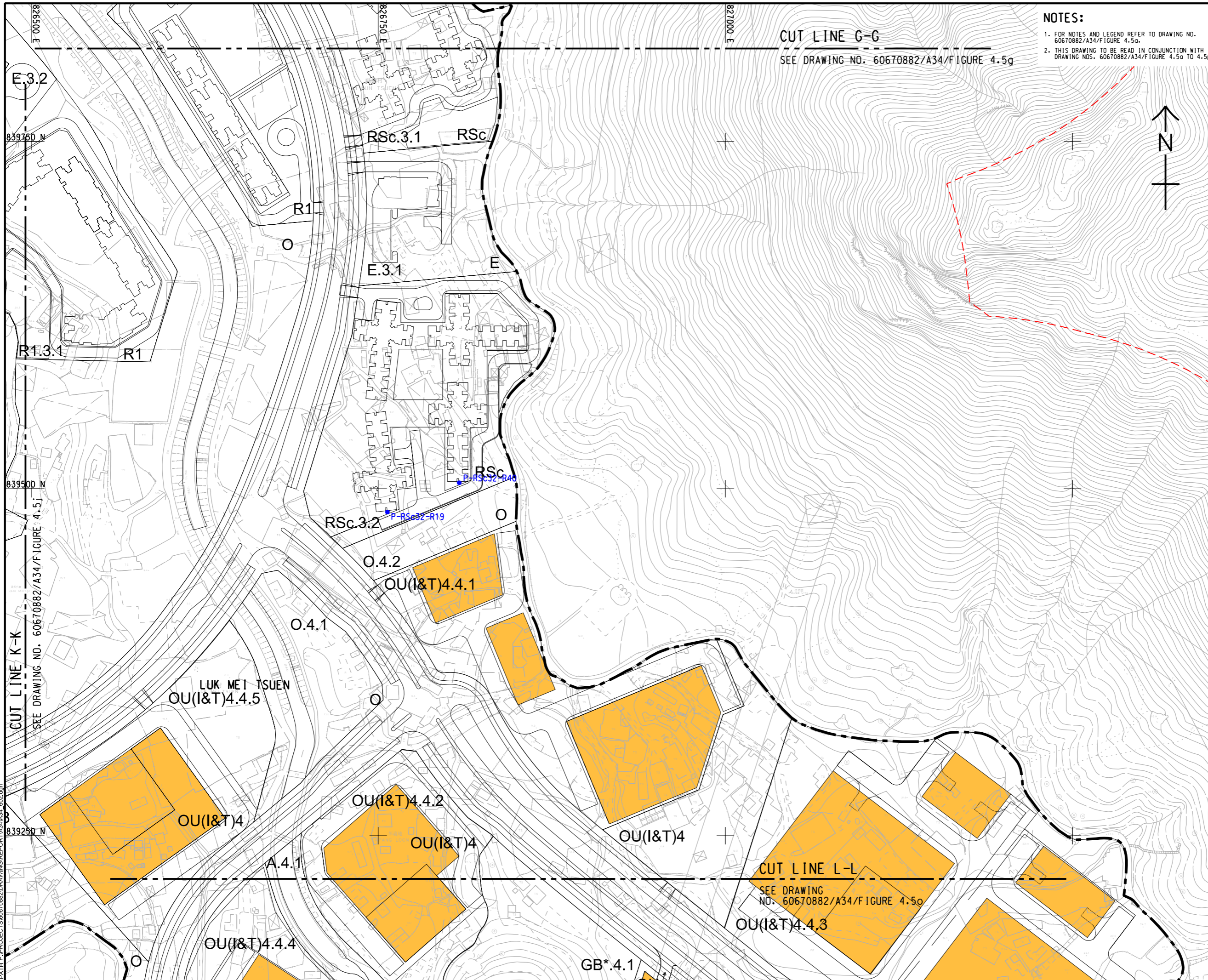

NOTES:
 1. FOR NOTES AND LEGEND REFER TO DRAWING NO. 60670882/A34/FIGURE 4.5a.
 2. THIS DRAWING TO BE READ IN CONJUNCTION WITH DRAWING NOS. 60670882/A34/FIGURE 4.5a TO 4.5p.

CUT LINE G-G
 SEE DRAWING NO. 60670882/A34/FIGURE 4.5g

CUT LINE L-L
 SEE DRAWING NO. 60670882/A34/FIGURE 4.5o



PROJECT
 項目
 FIRST PHASE DEVELOPMENT OF THE NEW TERRITORIES NORTH – SAN TIN / LOK MA CHAU DEVELOPMENT NODE – INVESTIGATION

CLIENT
 業主
 土木工程拓展署
 Civil Engineering and Development Department
 規劃署
 Planning Department

CONSULTANT
 工程顧問公司
 AECOM Asia Company Ltd.
 www.aecom.com

SUB-CONSULTANTS
 分包工程顧問公司

ISSUE/REVISION
 修訂

IR	DATE	DESCRIPTION	CHK.

STATUS
 階段

SCALE
 比例
 A3 1 : 2500

DIMENSION UNIT
 尺寸單位
 METRES

KEY PLAN A3 1 : 300000

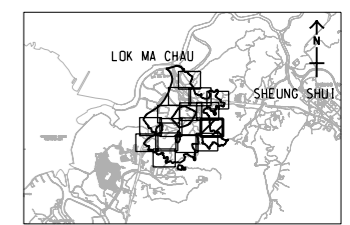

PROJECT NO.
 項目編號
 60670882

AGREEMENT NO.
 協議編號
 CE 20/2021

SHEET TITLE
 圖紙名稱
 LOCATION OF FIXED NOISE SOURCES AND NOISE SENSITIVE RECEIVERS FOR FIXED NOISE IMPACT ASSESSMENT
 SHEET 11 OF 16

SHEET NUMBER
 圖紙編號
 60670882/A34/FIGURE 4.5k

ISO A1 594mm x 841mm
 Approved:
 Checked:
 Designer:
 Project Management Initials:
 Plot File by: vicky.xia1
 PATH: P:\PROJECTS\60670882\DRAWING\REPORT\A34\A34_603.dgn

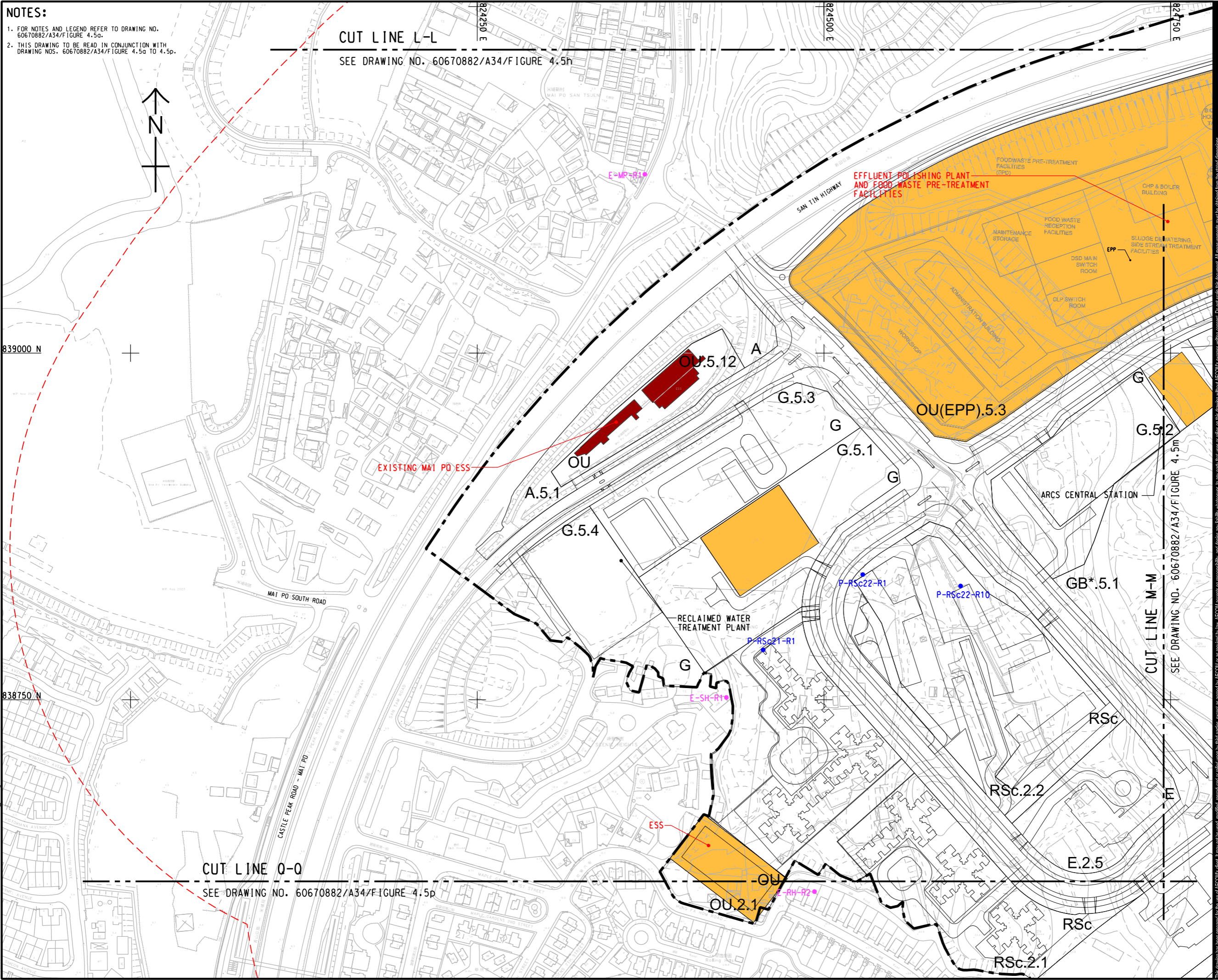

NOTES:

- FOR NOTES AND LEGEND REFER TO DRAWING NO. 60670882/A34/FIGURE 4.5a.
- THIS DRAWING TO BE READ IN CONJUNCTION WITH DRAWING NOS. 60670882/A34/FIGURE 4.5a TO 4.5p.

CUT LINE L-L
 SEE DRAWING NO. 60670882/A34/FIGURE 4.5h

CUT LINE Q-Q
 SEE DRAWING NO. 60670882/A34/FIGURE 4.5p



PROJECT
 項目
 FIRST PHASE DEVELOPMENT OF THE NEW TERRITORIES NORTH - SAN TIN / LOK MA CHAU DEVELOPMENT NODE - INVESTIGATION

CLIENT
 業主
 土木工程拓展署
 Civil Engineering and Development Department
 規劃署
 Planning Department

CONSULTANT
 顧問公司
 AECOM Asia Company Ltd.
 www.aecom.com

SUB-CONSULTANTS
 分包工程師/顧問公司

ISSUE/REVISION
 修訂

NO.	DATE	DESCRIPTION	CHK.

STATUS
 階段

SCALE
 比例
 A3 1:2500
KEY PLAN
 索引圖
 A3 1:300000

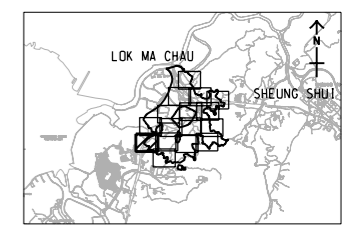

PROJECT NO.
 項目編號
 60670882
AGREEMENT NO.
 協議編號
 CE 20/2021

SHEET TITLE
 圖紙名稱
 LOCATION OF FIXED NOISE SOURCES AND NOISE SENSITIVE RECEIVERS FOR FIXED NOISE IMPACT ASSESSMENT
 SHEET 12 OF 16

SHEET NUMBER
 圖紙編號
 60670882/A34/FIGURE 4.5I

This drawing has been prepared for the use of AECOM's client. It may not be used, modified, reproduced or relied upon by third parties, except as agreed by AECOM or as required by law. AECOM accepts no responsibility, and denies any liability, whatsoever, to any party, that uses or relies on this drawing without AECOM's express written consent. All measurements must be obtained from the stated dimensions.

ISO A1 594mm x 841mm
 Approved:
 Checked:
 Designer:
 Project Management Initials:
 Plot File by: vicky.xia1
 PATH: P:\PROJECTS\60670882\DRAWING\REPORT\A34\A34_606.dgn

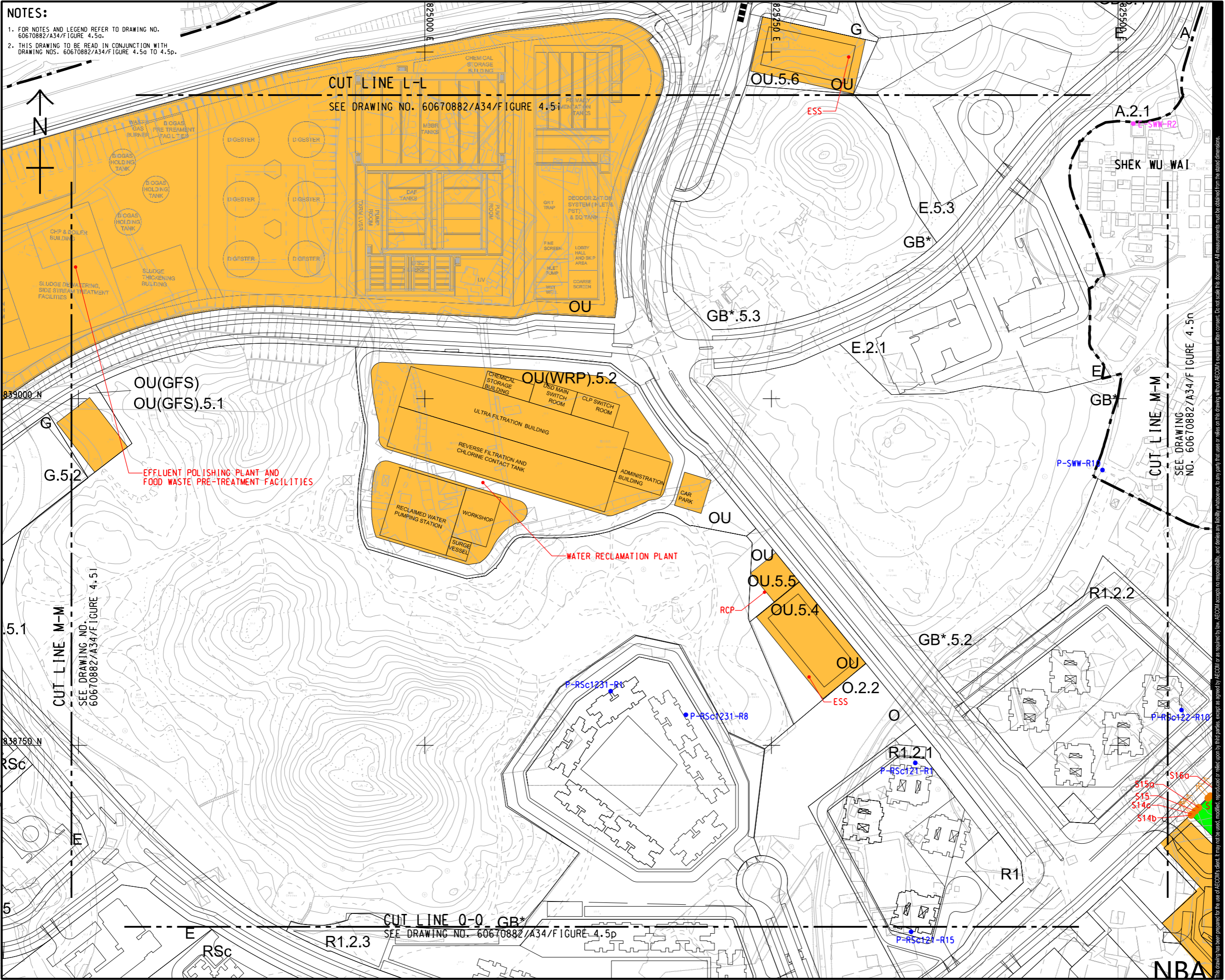

NOTES:

- FOR NOTES AND LEGEND REFER TO DRAWING NO. 60670882/A34/Figure 4.5a.
- THIS DRAWING TO BE READ IN CONJUNCTION WITH DRAWING NOS. 60670882/A34/Figure 4.5a TO 4.5p.



PROJECT
 項目
 FIRST PHASE DEVELOPMENT OF THE NEW TERRITORIES NORTH – SAN TIN / LOK MA CHAU DEVELOPMENT NODE – INVESTIGATION

CLIENT
 業主
 土木工程拓展署
 Civil Engineering and Development Department
 規劃署
 Planning Department

CONSULTANT
 顧問公司
 AECOM Asia Company Ltd.
 www.aecom.com

SUB-CONSULTANTS
 分包工程師/顧問公司

ISSUE/REVISION
 修訂

IR	DATE	DESCRIPTION	CHK.

STATUS
 階段

SCALE
 比例
 A3 1:2500

DIMENSION UNIT
 尺寸單位
 METRES

KEY PLAN A3 1:300000
 索引圖

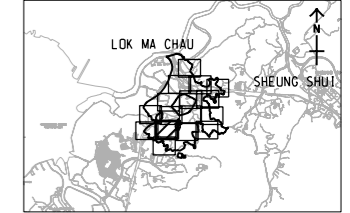

PROJECT NO.
 項目編號
 60670882

AGREEMENT NO.
 協議編號
 CE 20/2021

SHEET TITLE
 圖紙名稱
 LOCATION OF FIXED NOISE SOURCES AND NOISE SENSITIVE RECEIVERS FOR FIXED NOISE IMPACT ASSESSMENT
 SHEET 13 OF 16

SHEET NUMBER
 圖紙編號
 60670882/A34/FIGURE 4.5m

This drawing has been prepared for the use of AECOM's client. It may not be used, modified, reproduced or relied upon by third parties, except as agreed by AECOM in writing. AECOM accepts no responsibility, and disclaims any liability, whatsoever, for any gain, loss or damage on this drawing without AECOM's express written consent. All measurements must be obtained from the stated dimensions.

ISO A1 594mm x 841mm
Approved:
Checked:
Designer:
Project Management Initials:

NOTES:
1. FOR NOTES AND LEGEND REFER TO DRAWING NO. 60670882/A34/Figure 4.5g.
2. THIS DRAWING TO BE READ IN CONJUNCTION WITH DRAWING NOS. 60670882/A34/Figure 4.5g TO 4.5p.

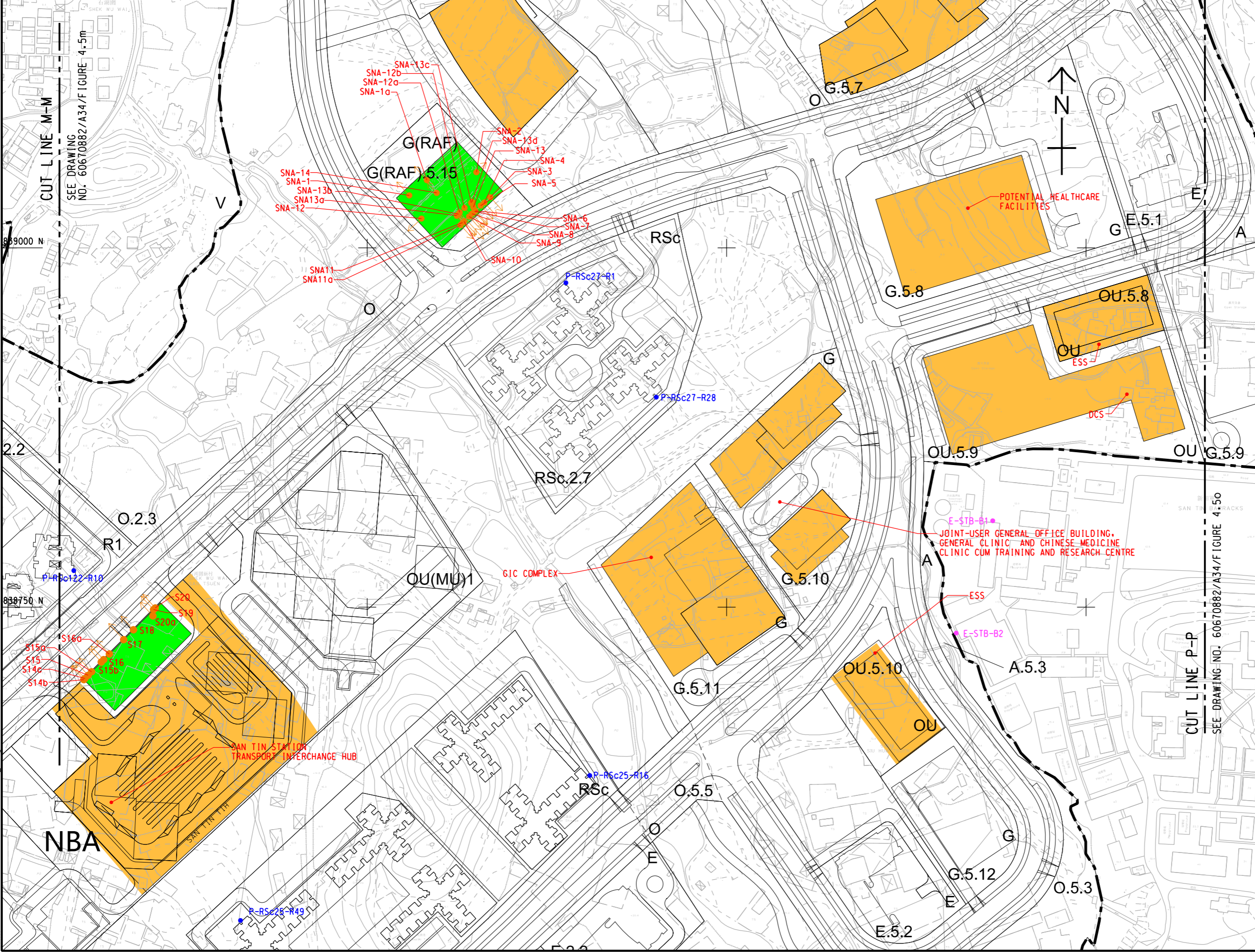

PROJECT
FIRST PHASE DEVELOPMENT OF THE NEW TERRITORIES NORTH – SAN TIN / LOK MA CHAU DEVELOPMENT NODE – INVESTIGATION

CLIENT
土木工程拓展署
Civil Engineering and Development Department
規劃署
Planning Department

CONSULTANT
AECOM Asia Company Ltd.
www.aecom.com

SUB-CONSULTANTS

ISSUE/REVISION

NO.	DATE	DESCRIPTION	CHK.

STATUS

SCALE
A3 1:2500
DIMENSION UNIT
METRES

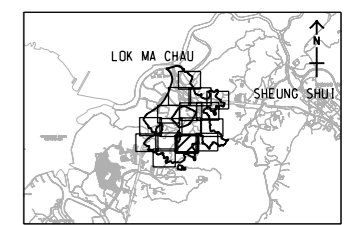

PROJECT NO. 60670882
AGREEMENT NO. CE 20/2021



SHEET TITLE
LOCATION OF FIXED NOISE SOURCES AND NOISE SENSITIVE RECEIVERS FOR FIXED NOISE IMPACT ASSESSMENT
SHEET 14 OF 16
SHEET NUMBER
60670882/A34/FIGURE 4.5n

This drawing has been prepared for the use of AECOM's client. It may not be used, modified, reproduced or relied upon by third parties, except as agreed by AECOM in writing. AECOM accepts no responsibility, and disclaims any liability, whatsoever, for any loss or damage, in any form, that results from the use of this drawing without AECOM's express written consent. All measurements must be obtained from the stated dimensions.

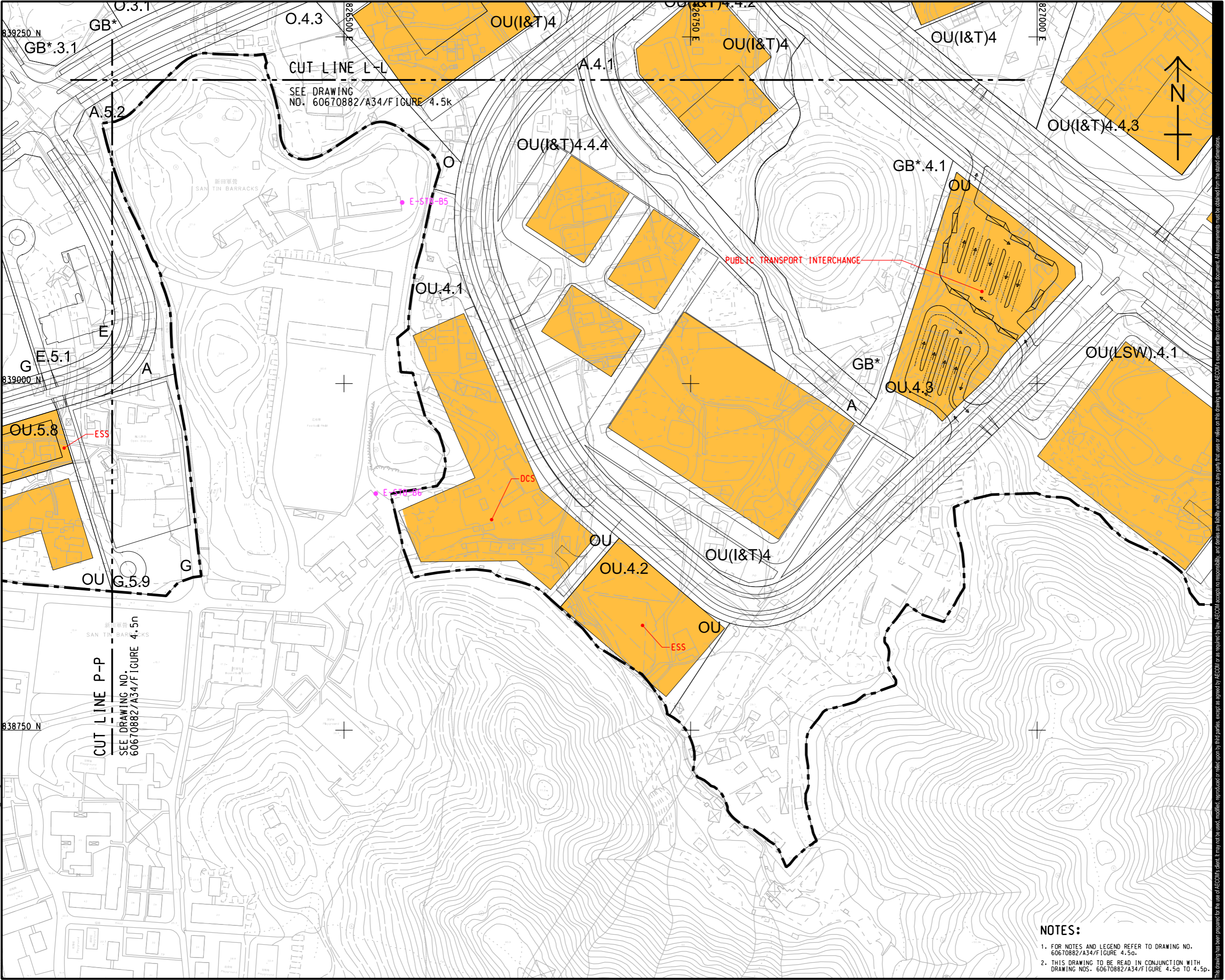
ISO A1 594mm x 841mm
 Approved:
 Checked:
 Designer:
 Project Management Initials:
 31/12/2024
 YZF
 60670882/DR/REPORT/A34/A34_606.dgn



PROJECT
 項目
 FIRST PHASE DEVELOPMENT OF THE NEW TERRITORIES NORTH – SAN TIN / LOK MA CHAU DEVELOPMENT NODE – INVESTIGATION

CLIENT
 業主
 土木工程拓展署
 Civil Engineering and Development Department
 規劃署
 Planning Department

CONSULTANT
 顧問公司
 AECOM Asia Company Ltd.
 www.aecom.com

SUB-CONSULTANTS
 分包工程師/顧問公司

ISSUE/REVISION
 修訂

IR	DATE	DESCRIPTION	CHK.
修訂	日期	內容摘要	核對

STATUS
 階段

SCALE
 比例
 A3 1 : 2500

DIMENSION UNIT
 尺寸單位
 METRES

KEY PLAN
 索引圖
 A3 1 : 300000

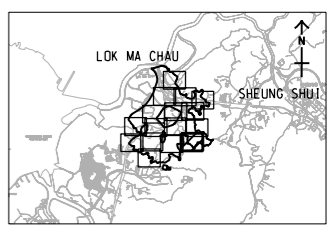

PROJECT NO.
 項目編號
 60670882

AGREEMENT NO.
 協議編號
 CE 20/2021

SHEET TITLE
 圖紙名稱
 LOCATION OF FIXED NOISE SOURCES AND NOISE SENSITIVE RECEIVERS FOR FIXED NOISE IMPACT ASSESSMENT
 SHEET 15 OF 16

SHEET NUMBER
 圖紙編號
 60670882/A34/FIGURE 4.5o

- NOTES:**
- FOR NOTES AND LEGEND REFER TO DRAWING NO. 60670882/A34/FIGURE 4.5g.
 - THIS DRAWING TO BE READ IN CONJUNCTION WITH DRAWING NOS. 60670882/A34/FIGURE 4.5a TO 4.5p.

This drawing has been prepared for the use of AECOM's client. It may not be used, modified, reproduced or relied upon by third parties, except as agreed by AECOM or as required by law. AECOM accepts no responsibility, and disclaims any liability whatsoever, for any part that is used or relied on in this drawing without AECOM's express written consent. Do not scale this document. All measurements must be obtained from the stated dimensions.

ISO A1 594mm x 841mm
Approved:
Checked:
Designer:
Project Management Initials:

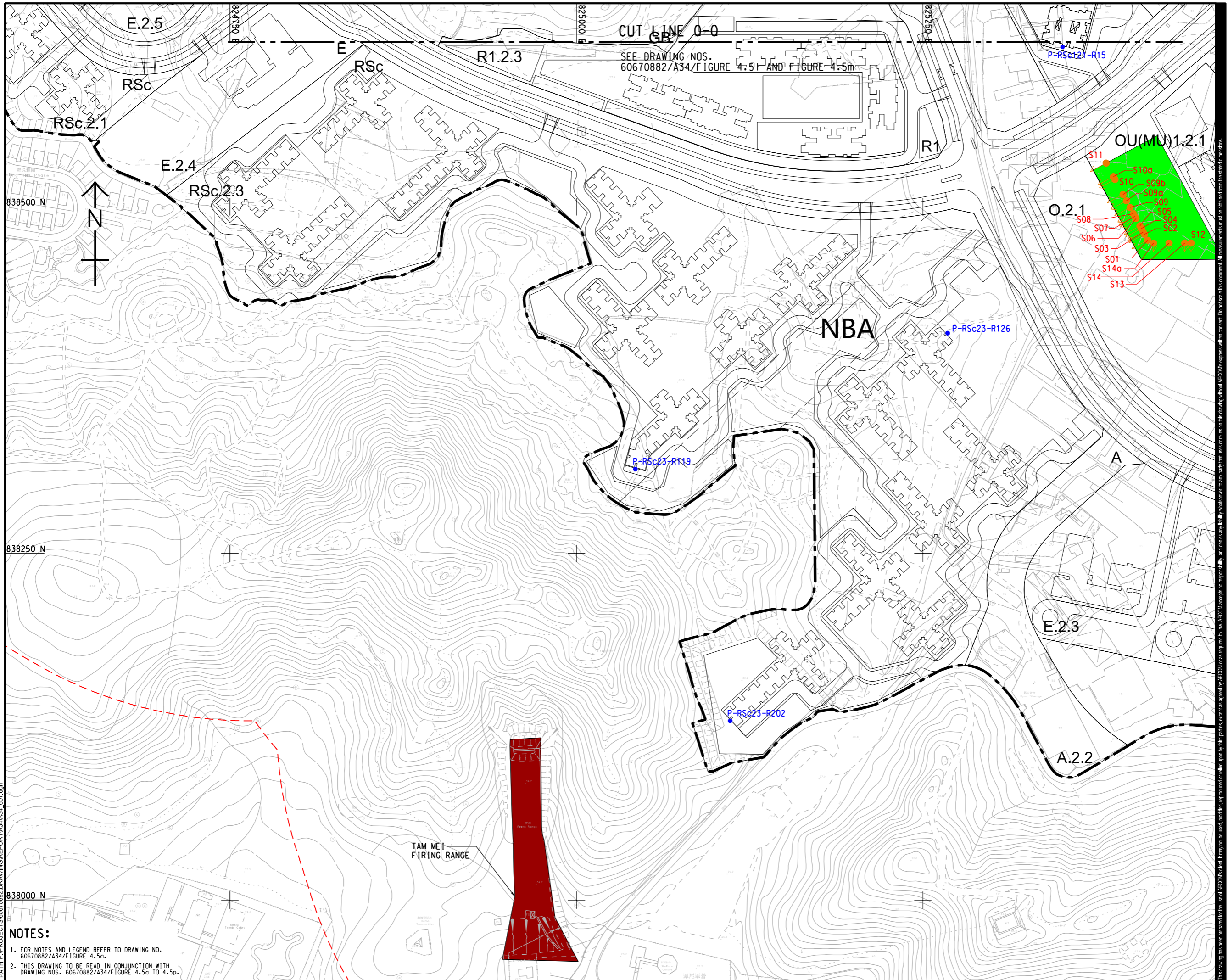

CUT LINE 0-0
SEE DRAWING NOS.
60670882/A34/FIGURE 4.5f AND FIGURE 4.5m

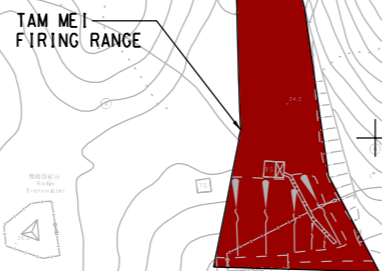
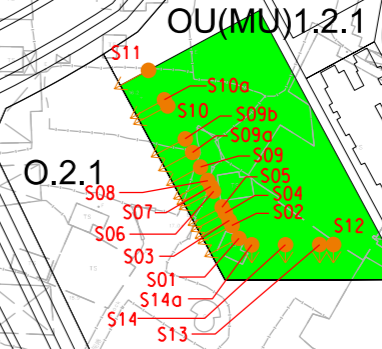

- NOTES:**
- FOR NOTES AND LEGEND REFER TO DRAWING NO. 60670882/A34/FIGURE 4.5a.
 - THIS DRAWING TO BE READ IN CONJUNCTION WITH DRAWING NOS. 60670882/A34/FIGURE 4.5a TO 4.5p.



PROJECT
項目
FIRST PHASE DEVELOPMENT OF THE NEW TERRITORIES NORTH – SAN TIN / LOK MA CHAU DEVELOPMENT NODE – INVESTIGATION

CLIENT
業主
 土木工程拓展署
 Civil Engineering and Development Department
 規劃署
 Planning Department

CONSULTANT
顧問公司
AECOM Asia Company Ltd.
www.aecom.com

SUB-CONSULTANTS
分包工程師有限公司

ISSUE/REVISION
修訂

IR	DATE	DESCRIPTION	CHK.

STATUS
階段

SCALE
比例
A3 1 : 2500

DIMENSION UNIT
尺寸單位
METRES

KEY PLAN A3 1 : 300000
索引圖

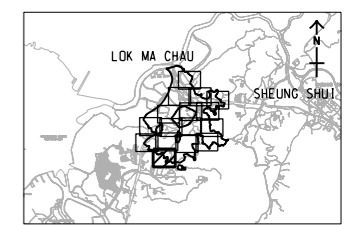

PROJECT NO.
項目編號
60670882

AGREEMENT NO.
協議編號
CE 20/2021

SHEET TITLE
圖紙名稱
LOCATION OF FIXED NOISE SOURCES AND NOISE SENSITIVE RECEIVERS FOR FIXED NOISE IMPACT ASSESSMENT
SHEET 16 OF 16

SHEET NUMBER
圖紙編號
60670882/A34/FIGURE 4.5p

Plot File by: jliw 2023/12/27
PATH: P:\PROJECTS\60670882\DRAWING\REPORT\A34\A34_607.dgn

This drawing has been prepared for the use of AECOM's client. It may not be used, modified, reproduced or relied upon by third parties, except as agreed by AECOM or as required by law. AECOM accepts no responsibility, and denies any liability whatsoever, to any party that uses or relies on this drawing without AECOM's express written consent. Do not scale this document. All measurements must be obtained from the stated dimensions.