

ISO A1 594mm x 841mm
Approved:
Checked:
Designer:
Project Management Initials:
Plot File by: haiquan.zhao 11/14/2023
PATH: P:\PROJECTS\60670882\DRAWING\REPORT\A34\A34_556.dgn

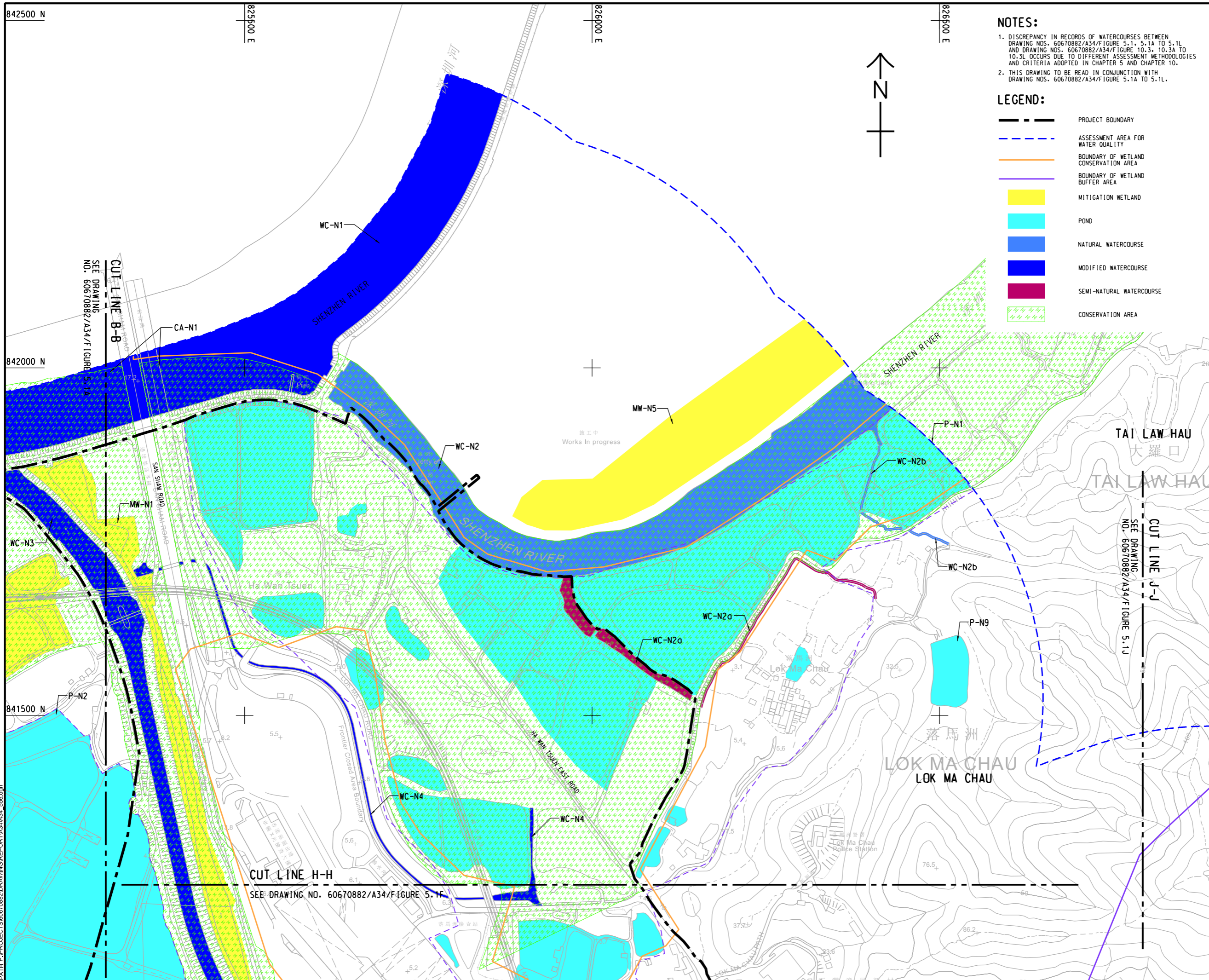

NOTES:

- DISCREPANCY IN RECORDS OF WATERCOURSES BETWEEN DRAWING NOS. 60670882/A34/Figure 5.1, 5.1A TO 5.1L AND DRAWING NOS. 60670882/A34/Figure 10.3, 10.3A TO 10.3L OCCURS DUE TO DIFFERENT ASSESSMENT METHODOLOGIES AND CRITERIA ADOPTED IN CHAPTER 5 AND CHAPTER 10.
- THIS DRAWING TO BE READ IN CONJUNCTION WITH DRAWING NOS. 60670882/A34/Figure 5.1A TO 5.1L.

LEGEND:

- PROJECT BOUNDARY
- ASSESSMENT AREA FOR WATER QUALITY
- BOUNDARY OF WETLAND CONSERVATION AREA
- BOUNDARY OF WETLAND BUFFER AREA
- MITIGATION WETLAND
- POND
- NATURAL WATERCOURSE
- MODIFIED WATERCOURSE
- SEMI-NATURAL WATERCOURSE
- CONSERVATION AREA



PROJECT
項目
FIRST PHASE DEVELOPMENT OF THE NEW TERRITORIES NORTH – SAN TIN / LOK MA CHAU DEVELOPMENT NODE – INVESTIGATION

CLIENT
業主
 土木工程拓展署
 Civil Engineering and Development Department
 規劃署
 Planning Department

CONSULTANT
顧問公司
AECOM Asia Company Ltd.
www.aecom.com

SUB-CONSULTANTS
分判工程師/顧問公司

ISSUE/REVISION
修訂

IR	DATE	DESCRIPTION	CHK.

STATUS
階段

SCALE
比例
A3 1:5000

DIMENSION UNIT
尺寸單位
METRES

KEY PLAN A3 1:250000
索引圖

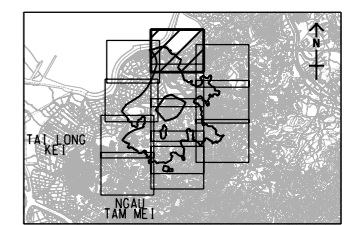

PROJECT NO.
項目編號
60670882

AGREEMENT NO.
協議編號
CE 20/2021

SHEET TITLE
圖紙名稱
LOCATIONS OF WATER SENSITIVE RECEIVERS

SHEET NUMBER
圖紙編號
60670882/A34/FIGURE 5.1E

This drawing has been prepared for the use of AECOM's client. It may not be used, modified, reproduced or relied upon by third parties, except as agreed by AECOM or as required by law. AECOM accepts no responsibility, and disclaims any liability, whatsoever, for any part, that less or relies on this drawing without AECOM's express written consent. All measurements must be obtained from the stated dimensions.