

**ENVIRONMENTAL IMPACT ASSESSMENT ORDINANCE (CAP. 499)**  
**SECTION 5 (7)**

**ENVIRONMENTAL IMPACT ASSESSMENT STUDY BRIEF NO. ESB-215/2010**

**PROJECT TITLE :** **PHASE III REDEVELOPMENT OF THE HONG KONG  
FEDERATION OF YOUTH GROUPS JOCKEY CLUB SAI  
KUNG OUTDOOR TRAINING CAMP**  
(hereinafter known as the "Project")

**NAME OF APPLICANT :** **THE HONG KONG FEDERATION OF YOUTH GROUPS**  
(hereinafter known as the "Applicant")

**1. BACKGROUND**

1.1 An application for Permission to Apply Directly for Environmental Permit (DIR) under section 5(11) of the Environmental Impact Assessment Ordinance (EIAO) was submitted by the Applicant on 6 August 2010 with a project profile (No. PP-419/2010) (the Project Profile). The Director is of the view that DIR is not appropriate for this project because of its scale of development within the Sai Kung West Country Park, protected flora and fauna species were found on site and the potential landscape and visual impacts that would require mitigation measures beyond normal good work practices

1.2 The Project is to redevelop the existing Jockey Club Sai Kung Outdoor Training Camp and increase the number of dormitories in order to meet the increasing public demand. The redevelopment works include the construction of eight number of houses comprising a total of 19 units on the lower portion of slope west of the existing houses; a new canteen block at the centre of the camp comprising a dining hall, a cafeteria, activity rooms and a drop off point for arrival of visitors; two platform decks for outdoor activities; and a new wastewater treatment and reuse system.

Location of the Project and the General Layout as given in the Project Profile are reproduced in Figure 1 and Figure 2 of this study brief. The proposed location of the redevelopment is partly within the existing camp and Sai Kung West Country

Park.

1.3 The Project consists of the following designated projects under Part I, Schedule 2 of the EIAO:

- (i) Item F.4 – An activity for the reuse of treated sewage effluent from a treatment plant; and
- (ii) Item Q.1 earthworks and building works partly or wholly in an existing country park.

1.4 Pursuant to section 5(7)(a) of the EIAO, the Director of Environmental Protection (the Director) issues this EIA study brief to the Applicant to carry out an EIA study.

1.5 The purpose of this EIA study is to provide information on the nature and extent of environmental impacts arising from the construction and operation of the Project and related activities that take place concurrently. This information will contribute to decisions by the Director on :

- (i) the acceptability of any adverse environmental consequences that are likely to arise as a result of the Project;
- (ii) the conditions and requirements for the design, construction and operation of the Project to mitigate against adverse environmental consequences; and
- (iii) the acceptability of residual impacts after the proposed mitigation measures are implemented.

## **2. OBJECTIVES OF THE EIA STUDY**

2.1 The objectives of the EIA study are as follows :

- (i) to describe the Project and associated works together with the requirements and environmental benefits for carrying out the Project and the types of designated projects to be covered by the Project;
- (ii) to identify and describe elements of community and environment likely to be affected by the Project and/or likely to cause adverse impacts to the Project, including natural and man-made environment and the associated

environmental constraints;

- (iii) to provide information on the consideration of alternative options of the design, layout, location, scale and extent of the Project and the construction methods with a view to avoiding or minimizing potential environmental impacts to environmentally sensitive areas and sensitive uses; to compare the environmental benefits and disbenefits of different options; to provide reasons for selecting the preferred option(s) and to describe the part environmental factors played in the selection of preferred option(s);
- (iv) to identify and quantify emission sources (including gaseous pollutant emission, noise, waste generation waste water and sewage discharge, etc. as appropriate) and determine the significance of impacts on sensitive receivers and potential affected uses;
- (v) to identify and quantify any potential loss or damage and other potential impacts to ecology and fisheries resources, flora, fauna and natural habitats and to propose measures to mitigate these impacts;
- (vi) to identify any potential landscape and visual impacts and to propose measures to mitigate these impacts;
- (vii) to identify any potential human health impacts and to propose measures to mitigate these impacts;
- (viii) to propose provision of mitigation measures so as to minimize pollution, environmental disturbance and nuisance during construction and operation of Project;
- (ix) to investigate the feasibility, practicability, effectiveness and implications of the proposed mitigation measures;
- (x) to identify, predict and evaluate the residual environmental impacts (i.e. after practicable mitigation) and the cumulative effects expected to arise during the construction and operation phases of the Project in relation to the sensitive receivers and potential affected uses;
- (xi) to identify, assess and specify methods, measures and standards, to be

included in the detailed design, construction and operation of the Project which are necessary to mitigate these environmental impacts and cumulative effects and reduce them to acceptable levels;

- (xii) to investigate the extent of the secondary environmental impacts that may arise from the proposed mitigation measures and to identify constraints associated with the mitigation measures recommended in the EIA study, as well as the provision of any necessary modification; and
- (xiii) to design and specify environmental monitoring and audit requirements to check the effective implementation of the recommended environmental protection and pollution control measures.

### **3. DETAILED REQUIREMENTS OF THE EIA STUDY**

#### **3.1 The Purpose**

- 3.1.1 The purpose of this study brief is to scope the key issues of the EIA study and to specify the environmental issues that are required to be reviewed and assessed in the EIA report. The Applicant has to demonstrate in the EIA report that the criteria in the relevant sections of the Technical Memorandum on the Environmental Impact Assessment Process of the Environmental Impact Assessment Ordinance (hereinafter referred to as “the TM”) are complied with.

#### **3.2 The Scope**

- 3.2.1 The scope of this EIA study shall cover the Project and associated works proposed in the Project Profile (No. PP- 419/2010) and mentioned in Section 1.2 above. The EIA study shall address the likely key issues described below, together with any other key issues identified during the course of the EIA study:

- (i) potential air quality on the sensitive receivers (including residential uses in Tai Mong Tsai Village, etc) during construction and operation of the Project, in particular construction dust during construction and odour impact during the operation of the sewage treatment and reuse system.
- (ii) potential noise impacts on the sensitive receivers (including the residential

uses in Tai Mong Tsai Village, etc) during construction and operation of the Project, in particular construction noise of the Project and noise generating from the sewage treatment and reuse system;

- (iii) potential water quality impacts on water system(s) to the relevant water body and relevant water sensitive receivers, bathing beaches, secondary contact recreation subzones, during construction and operation of the Project, in particular arising from the effluent discharge from the sewage treatment and reuse system and emergency discharge from the sewage treatment system ;
- (iv) potential waste management issues and impacts during construction and operation of the Project, in particular arising from handling and disposal of construction & demolition materials, sewage sludge and screening waste;
- (v) potential impacts to both terrestrial and marine ecological resources including green belt areas, coastal protection areas and country park, in particular the mangrove, intertidal and coral communities, woodland, species of conservation interest such as Incense Tree, Brown Fish Owl and Blue Whistling Thrush and Short-nosed Fruit Bat during construction and operation of the Project;
- (vi) potential landscape and visual impacts arising from the Project, in particular the landscape character along Tai Mong Tsai Road and inshore water landscape due to construction of the proposed redevelopment and operation of the Project.
- (vii) potential human health impacts during the effluent reuse activities; and
- (viii) potential cumulative impacts of the Project, through interaction or in combination with other existing, committed and planned projects in the vicinity of the Project.

### **3.3 Consideration of Alternatives**

#### **3.3.1 Need of the Project**

The Applicant shall provide information on the need of the Project, including the purpose, objectives and environmental benefits of the Project, and describe the

scenarios with and without the Project.

### 3.3.2 Consideration of Alternative Design and Layout

The Applicant shall present in the EIA report the consideration of alternative design and layout of the Project, Other factors or constraints affecting the design and layout of the Project shall be stated. The Applicant shall also present in the EIA report the consideration of practice.

### 3.3.3 Consideration of Alternative Construction Methods and Sequences of Works

Taking into consideration of the combined effect with respect to the severity and duration of the construction impacts to the affected sensitive receivers, the EIA study shall explore different construction methods and sequences of works of the Project with a view to avoiding or minimizing adverse environmental impacts during construction of the Project. A comparison of the environmental benefits and disbenefits of applying different construction methods and sequences of works shall be included in the EIA study.

## 3.4 **Technical Requirements**

3.4.1 The Applicant shall conduct the EIA study to address the environmental aspects described in Sections 3.1, 3.2 and 3.3 above. The assessment shall be based on the best and latest information available during the course of the EIA study. The Applicant shall include in the EIA report details of the construction programme and methodologies. The Applicant shall assess the cumulative environmental impacts from the Project and interacting projects as identified in the EIA study. The EIA study shall include the following technical requirements on specific impacts.

### 3.4.1 **Air Quality Impact**

3.4.1.1 The Applicant shall follow the criteria and guidelines for evaluating and assessing air quality impact as stated in section 1 of Annex 4 and Annex 12 of the TM.

3.4.1.2 The assessment area for air quality impact assessment shall be defined by a distance of 500 meters from the boundary of the Project site shown in Figure 1 of this study brief or other locations as identified in the EIA study, with consideration to be extended to include major existing, planned and committed air pollutant, including

odour emission sources that may have a bearing on the environmental acceptability of the Project. The assessment shall cover the air sensitive receivers at Tai Mong Tsai Village.

3.4.1.3 If the Applicant anticipates significant construction and/or operational phase air quality impact that will likely cause exceedance of the recommended limits in the Technical Memorandum (TM) at the air sensitive receivers (ASRs) despite incorporation of the mitigation measures, a quantitative assessment should be carried out to evaluate the air quality impact. The detailed requirement of the quantitative air quality impact assessment for construction and operation shall be agreed with the Director.

### 3.4.2 **Noise Impact**

3.4.2.1 The Applicant shall follow the criteria and guidelines for evaluating and assessing noise impact as stated in Annexes 5 and 13 of the TM.

3.4.2.2 The assessment area for the noise impact assessment shall generally include areas within 300m from the boundary of the Project site shown in Figure 1 of this study brief or other locations as identified in the EIA study. Subject to the agreement of the Director, the assessment area could be reduced accordingly if the first layer of noise sensitive receivers (NSRs), closer than 300m from the outer Project limit, provides acoustic shielding to those receivers at distances further away from the Project. The assessment area shall be expanded to include noise sensitive receivers (NSRs) at distances over 300m from the Project which are affected by the construction and operation of the Project.

3.4.2.3 If the Applicant anticipates significant construction and/or operational phase noise impact that will likely cause exceedance of the recommended limits in the TM at the NSRs despite incorporation of the mitigation measures, a quantitative assessment should be carried out to evaluate the noise impact. The detailed requirement of the quantitative noise impact assessment for construction and operation shall be agreed with the Director.

### 3.4.3 **Water Quality Impact**

3.4.3.1 The Applicant shall follow the criteria and guidelines for evaluating and assessing water pollution as stated in Annexes 6 and 14 of the TM.

3.4.3.2 The study area for the water quality impact assessment shall cover the Port Shelter Water Control Zone as designated under the Water Pollution Control Ordinance (Cap 358) and water sensitive receivers (WSRs) including, but not limiting to fish culture zone, habitat of mangrove and coral, recreational uses and coastal protection area in the vicinity of the Project. The study area shall be extended to include other areas if they are found also being impacted during the course of the EIA study and have a bearing on the environmental acceptability of the Project.

3.4.3.3 If the Applicant anticipates a significant construction and/or operation phase water quality impact that will likely cause exceedance of the recommended limits in the TM at the WSRs despite incorporation of the mitigation measures, a quantitative assessment should be carried out to evaluate the water quality impact. The detail requirement of the quantitative water quality impact assessment for construction and operation shall be agreed with the Director.

#### 3.4.4 **Waste Management Implication**

3.4.4.1 The Applicant shall follow the criteria and guidelines for evaluating and assessing waste management implications as stated in Annexes 7 and 15 of the TM.

3.4.4.2 The assessment of waste management implications shall cover the following:

(i) **Analysis of Activities and Waste Generation**

The Applicant shall identify the quantity, quality and timing of the wastes arising as a result of the construction and operation activities of the Project, based on the sequence and duration of these activities, e.g. construction and demolition materials and other wastes which would be generated during construction and operation stages. The Applicant shall adopt appropriate design, general layout, construction methods and programme to minimize the generation of public fill/inert construction and demolition (C&D) materials and maximize the use of public fill/inert C&D materials for other construction works.

(ii) **Proposal for Waste Management**

- (a) Prior to considering the disposal options for various types of wastes, opportunities for reducing waste generation, on-site or off-site re-use



and recycling shall be fully evaluated. Measures that can be taken in the planning and design stages e.g. by modifying the design approach and in the construction stage for maximizing waste reduction shall be separately considered.

- (b) After considering the opportunities for reducing waste generation and maximizing re-use, the types and quantities of the wastes required to be disposed of as a consequence shall be estimated and the disposal methods/options for each type of wastes shall be described in detail. The disposal methods/options recommended for each type of wastes shall take into account the result of the assessment in (c) below; and
- (c) The impact caused by handling (including stockpiling, labelling, packaging and storage), collection, transportation and re-use/disposal of wastes shall be addressed in detail and appropriate mitigation measures shall be proposed

### 3.4.5 **Ecological Impact (Terrestrial and Marine)**

- 3.4.5.1 The Applicant shall follow the criteria and guidelines for evaluating and assessing ecological impact as stated in Annexes 8 and 16 of the TM.
- 3.4.5.2 The assessment area for terrestrial and marine ecological impact shall include areas within 500m distance from the boundary of the Project and any other areas likely to be impacted by the Project. Areas of ecological or conservation values in Tai Mong Tsai stream, Sai Kung West Country Park, coastal protection area, etc shall be included and assessed in the ecological impact assessment.
- 3.4.5.3 The ecological impact assessment for construction and operation of the Project shall follow the detailed technical requirements given in Appendix A.

### 3.4.6 **Landscape and Visual Impacts**

- 3.4.6.1 The Applicant shall follow the criteria and guidelines as stated in Annexes 10 and 18 of the TM and the EIAO Guidance Note No.8/2002 on “Preparation of Landscape and Visual Impact Assessment under the Environmental Impact Assessment Ordinance” for evaluating and assessing the landscape and visual impacts.

3.4.6.2 The assessment area for landscape impact assessment shall include all areas within a 500m distance from the site boundary of the Project. The assessment area for the visual impact assessment shall be defined by the visual envelope of the Project.

3.4.6.3 The landscape and visual impact assessments for construction and operation of the Project shall follow the detailed technical requirements given in Appendix B.

### 3.4.7 **Summary of Environmental Outcomes**

3.4.7.1 The EIA report shall contain a summary of key environmental outcomes arising from the EIA study, including environmental benefits of the Project and the environmental protection measures recommended, population and environmentally sensitive areas protected, recommended environmentally friendly designs, key environmental problems avoided and any compensation areas included.

### 3.4.8 **Environmental Monitoring and Audit (EM&A) Requirements**

3.4.8.1 The Applicant shall identify and justify in the EIA study whether there is any need for EM&A activities during the construction and operation phases of the Project and, if affirmative, define the scope of EM&A requirements for the Project in the EIA study.

3.4.8.2 Subject to the confirmation of the EIA study findings, the Applicant shall follow the guidelines for an EM&A programme as stated in Annex 21 of the TM.

3.4.8.3 The Applicant shall prepare a Project Implementation Schedule in the form of a checklist as shown in Appendix C of this EIA study brief. It shall contain the EIA study recommendations and mitigation measures with reference to the implementation programme.

## 4. **DURATION OF VALIDITY**

4.1 The Applicant shall notify the Director of the commencement of the EIA study. If the EIA study does not commence within 36 months after the date of issue of this EIA study brief, the Applicant shall apply to the Director for a fresh EIA study brief before commencement of the EIA study.

## **5. REPORT REQUIREMENTS**

- 5.1 In preparing the EIA report, the Applicant shall refer to Annex 11 of the TM for the contents of an EIA report. The Applicant shall also refer to Annex 20 of the TM, which stipulates the guidelines for the review of an EIA report.
- 5.2 The Applicant shall supply the Director with hard and electronic copies of the EIA report and the executive summary in accordance with the requirements given in Appendix D. The Applicant shall, upon request, make additional copies of EIA report/documents available to the public, subject to payment by the interested parties of full costs of printing.

## **6. OTHER PROCEDURAL REQUIREMENTS**

- 6.1 If there is any change in the name of Applicant for this EIA study brief during the course of the EIA study, the Applicant must notify the Director immediately.
- 6.2 If there is any key change in the scope of the Project mentioned in Section 1.2 of this EIA study brief and in Project Profile (No. PP-419/2010), the Applicant must seek confirmation from the Director in writing on whether or not the scope of issues covered by this EIA study brief can still cover the key changes, and the additional issues, if any, that the EIA study must also address. If the changes to the Project fundamentally alter the key scope of the EIA study brief, the Applicant shall apply to the Director for a fresh EIA study brief.

--- END OF EIA STUDY BRIEF ---

September 2010  
Environmental Assessment Division  
Environmental Protection Department

## **Appendix A**

### **Requirements for Ecological Impact Assessment**

1. In the ecological impact assessment, the Applicant shall examine the flora, fauna and other components of the ecological habitats within the assessment area. The aim shall be to protect, maintain or rehabilitate the natural environment. In particular, the Project shall avoid or minimize impacts on recognized sites of conservation importance such as Coastal Protection Areas, country park, and wildlife groups or species of conservation interest (e.g. Brown Fish Owl, Short-nosed Fruit Bat, Blue Whistling Thrush and Incense Tree), intertidal habitats and coral communities. The assessment shall identify and quantify as far as possible the potential ecological impacts to the natural environment and the associated wildlife groups and habitats/species arising from the Project including its construction and operational phases as well as the subsequent management and maintenance of the proposals.

2. The assessment shall include the followings:

Review of the findings of relevant studies/surveys and collection of the available information regarding the ecological characters of the assessment area;

- (i) Review of the findings of relevant studies/surveys and collection of the available information regarding the ecological characters of the assessment area;
- (ii) Evaluation of information collected and identification of any information gap relating to the assessment of potential ecological impact;
- (iii) Carrying out necessary field surveys (the duration of which shall be at least 6 months, covering both wet and dry seasons, with full justification) and investigations to verify the information collected in (ii) above, to fill the information gaps identified and to fulfill the objectives of the EIA study. The field surveys shall include but not be limited to flora, fauna, corals, benthic communities, intertidal habitats and any other habitats/species of conservation importance;
- (iv) Establishment of the general ecological profile of the Study Area based on data of relevant previous studies/surveys and results of the ecological field surveys, and description of the characteristics of each habitat found; major

information to be provided shall include :

- (a) description of the physical environment, including all recognized sites of conservation importance, and assessment of whether these sites will be affected by the Project or not;
- (b) habitat maps of suitable scale showing the types and locations of habitats/species in the assessment area with special attention to those with conservation interests, including the followings :
  - coral communities;
  - intertidal habitats;
  - woodland;
  - species of conservation interest including Brown Fish Owl, Short-nosed Fruit Bat, Blue Whistling Thrush and Incense Tree and
  - any other habitats/species identified as having special conservation interest by this EIA study.
- (c) ecological characteristics of each habitat type such as extent, substrate, size, type, species present, dominant species found, species diversity and abundance, community structure, ecological value and inter-dependence of the habitats and species, and presence of any features of ecological importance;
- (d) representative colour photos of each habitat type and any important ecological features identified; and
- (e) species found that are rare, endangered and/or listed under local legislation, international conventions for conservation of wildlife/habitats or red data books.
- (v) Investigation and description of the existing wildlife uses of the various habitats with special attention to those wildlife groups and species with conservation interests, and any other habitats and wildlife groups identified as having special conservation interests, in the context of the Project;
- (vi) Using suitable methodology and considering also other works activities from other projects reasonably likely to occur at the same time, identification and quantification as far as possible of any direct (e.g. loss of habitats due to the

Project), indirect (e.g. changes in water qualities, noise, glare and other disturbance generated by the construction and operational activities, etc), on-site, off-site, primary, secondary and cumulative ecological impacts such as destruction of habitats, reduction of species abundance/diversity, loss of feeding and breeding grounds, reduction of ecological carrying capacity, habitat fragmentation, and in particular the followings :

- (a) Potential destruction or disturbance to ecological habitats including the Sai Kung West Country Park and Coastal Protection Areas;
  - (b) Potential impacts to marine ecology due to construction and operation of the Project; and
  - (c) Potential impacts to habitats/species of conservation value discovered during the course of the EIA study;
- (vii) Evaluation of ecological impact based on the best and latest information available during the course of the EIA study, using quantitative approach as far as practicable and covering construction and operational phases of the Project as well as the subsequent management and maintenance requirement of the Project. Potential cumulative ecological impact on habitats and species of conservation interest arising from the Project and interacting projects as identified in the EIA study shall be evaluated;
- (viii) Recommendations for possible alternatives, such as modification/change of layout, construction methods, and practicable mitigation measures to avoid, minimize and/or compensate for the adverse ecological impacts identified during construction and operation of the Project;
- (ix) Evaluation of the feasibility and effectiveness of the recommended mitigation measures and definition of the scope, type, location, implementation arrangement, resources requirement, subsequent management and maintenance of such measures;
- (x) Determination and quantification as far as possible of the residual ecological impacts after implementation of the proposed mitigation measures;
- (xi) Evaluation of the significance and acceptability of the residual ecological

impacts by making reference to the criteria in Annex 8 of the TM; and

- (xii) Review of the need for and recommendation on any ecological monitoring programme required.

## **Appendix B**

### **Requirements for Landscape and Visual Impact Assessments**

1. The Applicant shall review relevant plan(s) and/or studies which may identify areas of high landscape value and recommend country park, coastal protection area, green belt and conservation area designations. Any guidelines on landscape and urban design strategies and frameworks that may affect the appreciation of the Project shall also be reviewed. The aim is to gain an insight to the future outlook of the area affected so as to assess whether the Project can fit into the surrounding setting. Any conflict with the statutory town plan(s) and any published land use plans shall be highlighted and appropriate follow-up action shall be recommended.
2. The Applicant shall describe, appraise, analyse and evaluate the existing and planned landscape resources and character of the assessment area. A system shall be derived for judging landscape and visual impact significance. Annotated oblique aerial photographs and plans of suitable scale showing the baseline landscape character areas and landscape resources and mapping of impact assessment shall be extensively used to present the findings of impact assessment. Descriptive text shall provide a concise and reasoned judgment from a landscape and visual point of view. The sensitivity of the landscape framework and its ability to accommodate change shall be particularly focused on. The Applicant shall identify the degree of compatibility of the Project with the existing and planned landscape setting, recreation and tourism related uses, and scenic spot. The landscape impact assessment shall quantify the potential landscape impact as far as possible so as to illustrate the significance of such impacts arising from the proposed development. Clear mapping of the landscape impact is required. Tree survey shall be carried out and the impacts on existing trees shall be addressed. Cumulative landscape and visual impacts of the Project with other committed and planned developments shall be assessed.
3. The Applicant shall assess the visual impacts of the Project. Clear illustration including mapping of visual impact is required. The assessment shall include the following:
  - (i) identification and plotting of visual envelope of the Project;
  - (ii) identification of the key groups of existing and planned sensitive receivers within the visual envelope with regard to views from ground level, sea level



- and elevated vantage points;
- (iii) description of the visual compatibility of the Project with the surrounding and the planned setting, and its obstruction and interference with the key views of the study areas;
  - (iv) identification of the severity of visual impacts in terms of distance, nature and number of sensitive receivers. The visual impacts of the Project with and without mitigation measures shall be included so as to demonstrate the effectiveness of the proposed mitigation measures;
4. The Applicant shall evaluate the merits of preservation in totality, in parts or total destruction of existing landscape and the establishment of a new landscape character area. In addition, alternative location, layout, design, built-form and construction method that will avoid or reduce the identified landscape and visual impacts shall be evaluated for comparison before adopting other mitigation or compensatory measures to alleviate the impacts. The mitigation measures proposed shall not only be concerned with damage reduction but shall also include consideration of potential enhancement of existing landscape and visual quality. The Applicant shall recommend mitigation measures to minimize adverse effects identified above, including provision of a master landscape plan.
  5. The mitigation measures shall also include the preservation of vegetation, transplanting of mature trees, provision of screen planting, re-vegetation of disturbed lands, compensatory planting, woodland restoration, design of structure, provision of finishes to structure, colour scheme and texture of material used and any measures to mitigate the impact on the existing and planned land use and visually sensitive receivers. Parties shall be identified for the on going management and maintenance of the proposed mitigation works to ensure their effectiveness throughout the construction phase and operation phase of the Project, associated works, supporting facilities and essential infrastructures. A practical programme and funding proposal for the implementation of the recommendation measures shall be provided.
  6. Annotated illustration materials such as colour perspective drawings, plans and section/elevation diagrams, annotated oblique aerial photographs, photographs taken at vantage points, and computer-generated photomontage shall be adopted to fully illustrate the landscape and visual impacts of the Project. In particular, the landscape and visual impacts of the Project with and without mitigation measures from

representative viewpoints, particularly from views of the most severely affected visually sensitive receivers (i.e. worst case scenario), shall be properly illustrated in existing and planned setting at four stages (existing condition, Day 1 with no mitigation measures, Day 1 with mitigation measures and Year 10 with mitigation measures) by computer-generated photomontage so as to demonstrate the effectiveness of the proposed mitigation measures. Computer graphics shall be compatible with Microstation DGN file format. The Applicant shall record the technical details in preparing the illustration, which may need to be submitted for verification of the accuracy of the illustration.

**Appendix C**

**Implementation Schedule of Recommended Mitigation Measures**

EIA Ref.	EM&A Ref.	Recommended Mitigation Measures	Objectives of the Recommended Measure & Main Concerns to address	Who to implement the measure?	Location of the measure	When to implement the measure?	What requirements or standards for the measure to achieve

## **Appendix D**

### **Requirements for EIA Report Documents**

1. The Applicant shall supply the Director with the following number of copies of the EIA report and the executive summary :
  - (i) 50 copies of the EIA report and 80 copies of the bilingual (in both English and Chinese) executive summary as required under section 6(2) of the EIAO to be supplied at the time of application for approval of the EIA report.
  - (ii) When necessary, addendum to the EIA report and the executive summary submitted in item (i) above as required under section 7(1) of the EIAO, to be supplied upon advice by the Director for public inspection.
  - (iii) 20 copies of the EIA report and 50 copies of the bilingual (in both English and Chinese) executive summary with or without Addendum as required under section 7(5) of the EIAO, to be supplied upon advice by the Director for consultation with the Advisory Council on the Environment.
2. To facilitate public inspection of EIA report via EIAO Internet Website, the Applicant shall provide electronic copies of both the EIA report and executive summary prepared in HyperText Markup Language (HTML) (version 4.0 or later) and in Portable Document Format (PDF version 4.0 or later), unless otherwise agreed by the Director. For the HTML version, a content page capable of providing hyperlink to each section and sub-section of the EIA report and executive summary shall be included in the beginning of the document. Hyperlinks to figures, drawings and tables in the EIA report and executive summary shall be provided in the main text from where respective references are made. Graphics in the report shall be in interlaced GIF format unless otherwise agreed by the Director.
3. The electronic copies of the EIA report and the executive summary shall be submitted to the Director at the time of application for approval of the EIA report.
4. When the EIA report and the executive summary are made available for public inspection under section 7(1) of the EIAO, the content of the electronic copies of the EIA report and the executive summary must be the same as the hard copies and the Director shall be provided with the most updated electronic copies.

5. To promote environmentally friendly and efficient dissemination of information, both hardcopies and electronic copies of future EM&A reports recommended by the EIA study shall be required and their format shall be agreed by the Director.

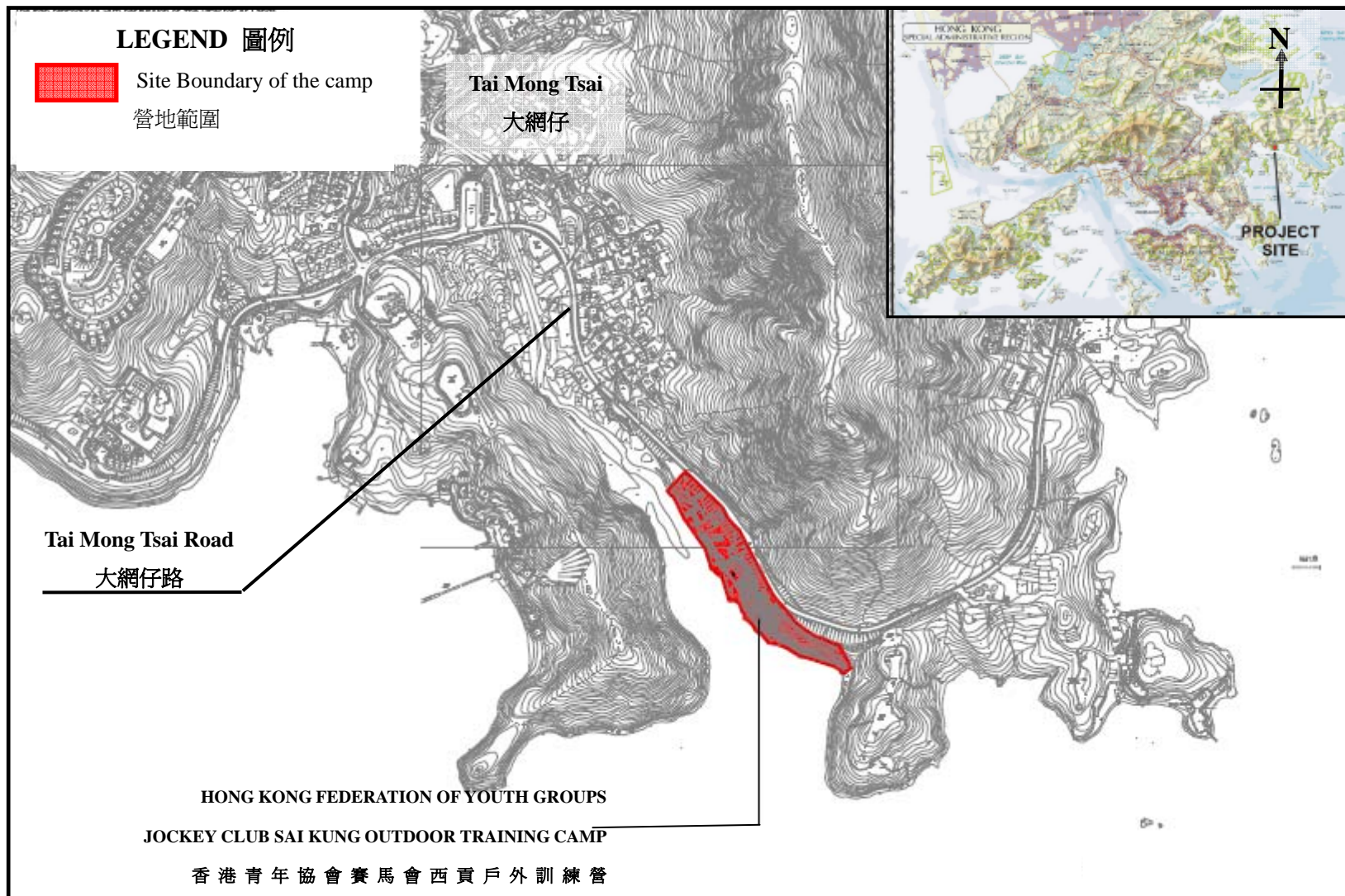

**Phase III Redevelopment of The Hong Kong Federation of Youth Groups  
Jockey Club Sai Kung Outdoor Training Camp**

香港青年協會賽馬會西貢戶外訓練營第三期擴建工程

**Figure 1: Site Location Plan**

圖一： 位置圖



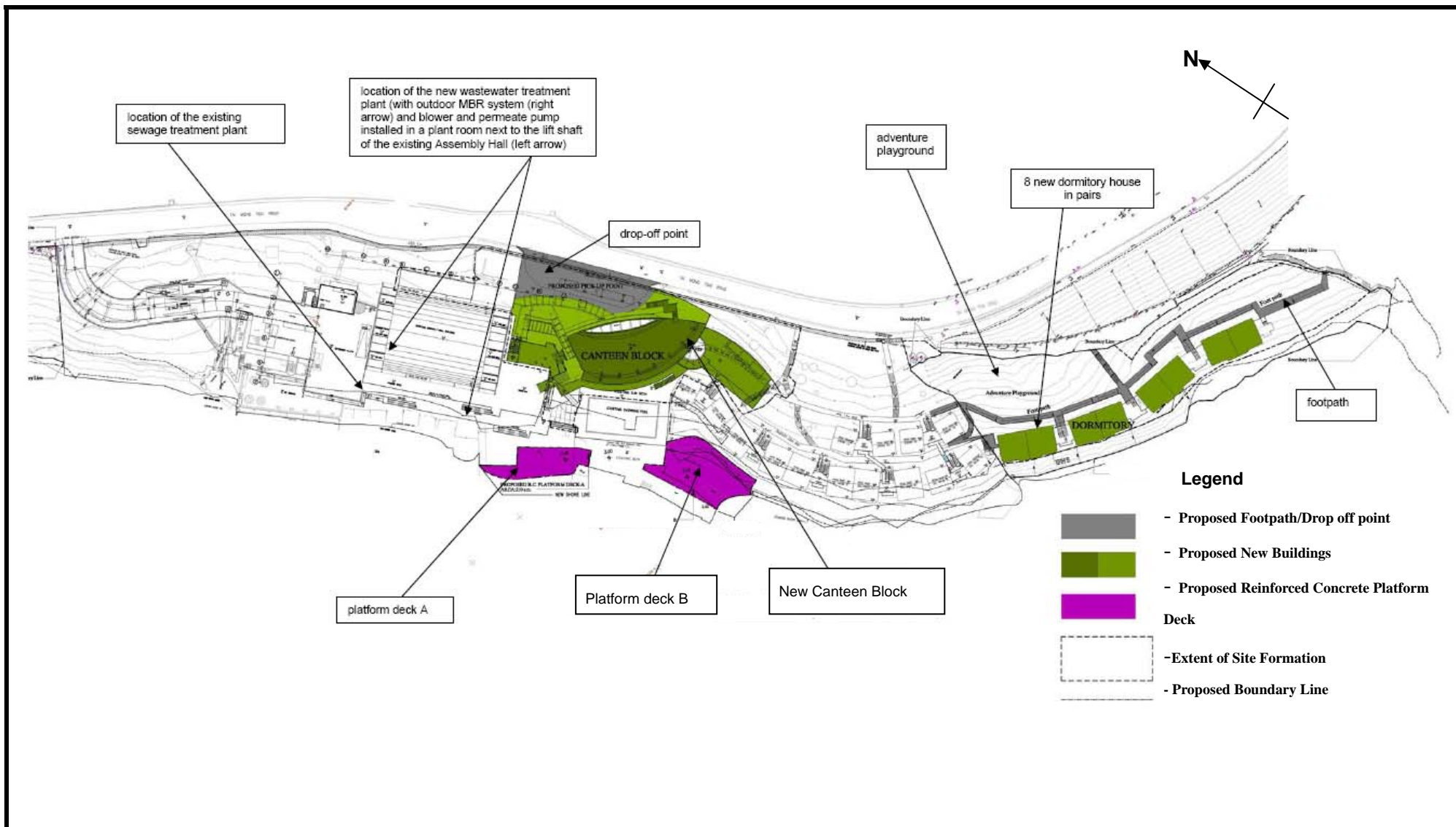

**Phase III Redevelopment of The Hong Kong Federation of Youth Groups Jockey Club Sai Kung Outdoor Training Camp**

香港青年協會賽馬會西貢戶外訓練營第三期擴建工程

**Figure 2: Master Layout Plan**

圖二： 總綱發展藍圖

