

**ENVIRONMENTAL IMPACT ASSESSMENT ORDINANCE (CAP. 499)
SECTION 5 (7)**

ENVIRONMENTAL IMPACT ASSESSMENT STUDY BRIEF NO. ESB-241/2012

**PROJECT TITLE : EFFLUENT POLISHING SCHEME AT YUEN LONG
SEWAGE TREATMENT WORKS
(hereinafter known as the "Project")**

**NAME OF APPLICANT : DRAINAGE SERVICES DEPARTMENT
(hereinafter known as the "Applicant")**

1. BACKGROUND

1.1 An application (No. ESB-241/2012) for an Environmental Impact Assessment (EIA) study brief under section 5(1) of the Environmental Impact Assessment Ordinance (EIAO) was submitted by the Applicant on 27 February 2012 with a project profile (No. PP-458/2012) (the Project Profile).

1.2 The Project is to upgrade Yuen Long Sewage Treatment Works (STW) by carrying out the following main works :

- (i) Upgrading the treatment level and modifying the existing treatment facilities of Yuen Long STW; and
- (ii) Construction of disinfection facilities.

The Project location is shown in Appendix A.

1.3 The Project consists of the following designated projects under Part I, Schedule 2 of the EIAO:

- (i) Item F.1. – *Sewage treatment works with an installed capacity of more than 15 000 m³ per day.*

1.4 Pursuant to section 5(7)(a) of the EIAO, the Director of Environmental Protection (the Director) issues this EIA study brief to the Applicant to carry out an EIA study.

1.5 The purpose of this EIA study is to provide information on the nature and extent of environmental impacts arising from the construction and operation of the Project and related activities that take place concurrently. This information will contribute to decisions by the Director on :

- (i) the acceptability of any adverse environmental consequences that are likely to arise as a result of the Project;
- (ii) the conditions and requirements for the design, construction and operation of the Project to mitigate against adverse environmental consequences; and
- (iii) the acceptability of residual impacts after the proposed mitigation measures are implemented.

2. OBJECTIVES OF THE EIA STUDY

2.1 The objectives of the EIA study are as follows :

- (i) to describe the Project and associated works together with the requirements and environmental benefits for carrying out the Project;
- (ii) to identify and describe elements of community and environment likely to be affected by the Project and/or likely to cause adverse impacts to the Project, including natural and man-made environment and the associated environmental constraints;
- (iii) to provide information on the consideration of alternative options of the design, layout, location, scale and extent of the Project and the construction methods with a view to avoiding or minimizing potential environmental impacts to environmentally sensitive areas and sensitive uses; to compare the environmental benefits and disbenefits of different options; to provide reasons for selecting the preferred option(s) and to describe the part environmental factors played in the selection of preferred option(s);
- (iv) to identify and quantify emission sources (including air quality, noise, water quality and waste, etc. as appropriate) and determine the significance of impacts on sensitive receivers and potential affected uses;
- (v) to identify and quantify any potential loss or damage and other potential impacts to ecology, flora, fauna and natural habitats and to propose measures to mitigate these impacts;
- (vi) to identify any potential landscape and visual impacts and to propose measures to mitigate these impacts;
- (vii) to propose provision of mitigation measures so as to minimize pollution, environmental disturbance and nuisance during construction and operation of Project;

- (viii) to investigate the feasibility, practicability, effectiveness and implications of the proposed mitigation measures;
- (ix) to identify, predict and evaluate the residual environmental impacts (i.e. after practicable mitigation) and the cumulative effects expected to arise during the construction and operation phases of the Project in relation to the sensitive receivers and potential affected uses;
- (x) to identify, assess and specify methods, measures and standards, to be included in the detailed design, construction and operation of the Project which are necessary to mitigate these environmental impacts and cumulative effects and reduce them to acceptable levels;
- (xi) to investigate the extent of the secondary environmental impacts that may arise from the proposed mitigation measures and to identify constraints associated with the mitigation measures recommended in the EIA study, as well as the provision of any necessary modification; and
- (xii) to design and specify environmental monitoring and audit requirements to check the effective implementation of the recommended environmental protection and pollution control measures.

3. DETAILED REQUIREMENTS OF THE EIA STUDY

3.1 The Purpose

- 3.1.1 The purpose of this study brief is to scope the key issues of the EIA study and to specify the environmental issues that are required to be reviewed and assessed in the EIA report. The Applicant has to demonstrate in the EIA report that the criteria in the relevant sections of the Technical Memorandum on the Environmental Impact Assessment Process of the Environmental Impact Assessment Ordinance (hereinafter referred to as “the TM”) are complied with.

3.2 The Scope

- 3.2.1 The scope of this EIA study shall cover the Project and associated works proposed in the Project Profile and mentioned in Section 1.2 above. The EIA study shall address the likely key issues described below, together with any other key issues identified during the course of the EIA study:
 - (i) potential water quality impacts on water system(s) including the Deep Bay Water Control Zone and relevant water sensitive receivers (e.g. Shan Pui

River), during construction and operation of the Project, in particular arising from the effluent discharge from the operating Yuen Long STW;

- (ii) potential air quality and noise impacts on the sensitive receivers during construction and operation of the Project, in particular arising from odour and noise emissions from the operating STW and construction dust and noise during construction of the Project;
- (iii) potential waste management issues and impacts during construction and operation of the Project, in particular arising from handling and disposal of construction & demolition materials, sewage sludge and screenings;
- (iv) potential ecological and fisheries impacts during construction and operation of the Project;
- (v) potential landscape impact arising from the Project and potential visual impact arising from the above-ground structures of the Project;
- (vi) potential cumulative impacts of the Project, through interaction or in combination with other existing, committed and planned projects in the vicinity of the Project.

3.3 Consideration of Alternatives

3.3.1 Purposes and Objective of the Project

The Applicant shall provide information on the need of the Project, including the purpose, objectives and environmental benefits of the Project, and describe the scenarios with and without the Project.

3.3.2 Consideration of Alternative Design and Layout

The Applicant shall present in the EIA report the consideration of alternative design and layout of the Project, including alternative treatment processes and internal layouts, alternative locations for the new treatment facilities, alternative/ phased installation for different flow projections, alternative designs to avoid or minimise emergency discharges and alternative scale/size of the above-ground structures, with a view to avoiding or reducing air quality, noise, water quality, ecological, landscape and visual impacts during construction and operation of the Project. Other factors or constraints affecting the design and layout of the Project shall be stated.

3.3.3 Consideration of Alternative Construction Methods and Sequences of Works

Taking into consideration of the combined effect with respect to the severity and duration of the construction impacts to the affected sensitive receivers, the EIA study shall explore different construction methods and sequences of works of the Project with a view to avoiding or minimizing adverse environmental impacts during construction of the Project. A comparison of the environmental benefits and disbenefits of applying different construction methods and sequences of works shall be included in the EIA study.

3.4 **Technical Requirements**

The Applicant shall conduct the EIA study to address the environmental aspects described in Sections 3.1, 3.2 and 3.3 above. The assessment shall be based on the best and latest information available during the course of the EIA study. The Applicant shall include in the EIA report details of the construction programme and methodologies. The Applicant shall assess the cumulative environmental impacts from the Project and interacting projects as identified in the EIA study. The EIA study shall include the following technical requirements on specific impacts.

3.4.1 **Air Quality Impact**

3.4.1.1 The Applicant shall follow the criteria and guidelines for evaluating and assessing air quality impact as stated in section 1 of Annex 4 and Annex 12 of the TM.

3.4.1.2 The study area for air quality impact assessment shall be defined by a distance of 500 meters from the boundary of the Project site or other project locations as identified in the EIA, which shall be extended to include major existing, planned and committed air pollutant emission sources that may have a bearing on the environmental acceptability of the Project. The assessment shall include the existing, planned and committed sensitive receivers within the study area as well as areas where air quality may be potentially affected by the Project. The assessment shall be based on the best available information at the time of the assessment.

3.4.1.3 The assessment of air quality impact arising from the construction and operation of the Project shall be conducted in accordance with the technical requirements in Appendix B of this EIA Study Brief.

3.4.2 **Noise Impact**

3.4.2.1 The Applicant shall follow the criteria and guidelines for evaluating and assessing noise impact as stated in Annexes 5 and 13 of the TM.

3.4.2.2 The assessment area for the noise impact assessment shall generally include areas within 300m from the boundary of the Project site. Subject to the agreement of the Director, the assessment area could be reduced accordingly if the first layer of noise sensitive receivers (NSRs), closer than 300m from the outer Project limit, provides acoustic shielding to those receivers at distances further away from the Project. The assessment area shall be expanded to include NSRs at distances over 300m from the Project which are affected by the construction and operation of the Project. NSRs shall be included and assessed in the noise impact assessment.

3.4.2.3 The noise impact assessment for construction and operation of the Project shall follow the detailed technical requirements given in Appendix C.

3.4.3 Water Quality Impact

3.4.3.1 The Applicant shall follow the criteria and guidelines for evaluating and assessing water pollution as stated in Annexes 6 and 14 of the TM.

3.4.3.2 The study area for the water quality impact assessment shall cover the Deep Bay Water Control Zone as designated under the Water Pollution Control Ordinance (Cap 358) and water sensitive receivers in the vicinity of the Project. The study area shall be extended to include other areas if they are found also being impacted during the course of the EIA study and have a bearing on the environmental acceptability of the Project.

3.4.3.3 The water quality impact assessment for construction and operation of the Project shall follow the detailed technical requirements given in Appendix D.

3.4.4 Waste Management Implication and Land Contamination

3.4.4.1 The Applicant shall follow the criteria and guidelines for evaluating and assessing waste management implication as stated in Annexes 7 and 15 of the TM.

3.4.4.2 The assessment of the waste management implication arising from construction and operation of the Project shall follow the detailed technical requirements given in Appendix E.

3.4.4.3 The Applicant shall follow the guidelines for evaluating and assessing potential land contamination issue as stated in Section 3.1 of Annex 19 of the TM.

3.4.4.4 The assessment of the potential land contamination issue shall follow the detailed requirements given in Appendix E.

3.4.5 Ecological Impact (Terrestrial and Aquatic)

- 3.4.5.1 The Applicant shall follow the criteria and guidelines for evaluating and assessing ecological impact as stated in Annexes 8 and 16 of the TM.
- 3.4.5.2 The assessment area for the purpose of this ecological impact assessment shall include areas within 500m distance from the boundary of the Project and any other areas likely to be impacted by the Project. For aquatic ecology, the assessment area shall be the same as the water quality impact assessment described in section 3.4.3.
- 3.4.5.3 The ecological impact assessment for construction and operation of the Project shall follow the detailed technical requirements given in Appendix F.

3.4.6 Fisheries Impact

- 3.4.6.1 The applicant shall follow the criteria and guidelines for evaluating and assessing fisheries impact as stated in Annexes 9 and 17 of the Technical Memorandum under EIA Ordinance.
- 3.4.6.2 The assessment area shall include all areas within a distance of 500m from the site boundaries of the Project. This assessment area shall be extended to include other areas if they are also found being impacted by the construction or operation of the Project during the course of the EIA study. Special attention should be given to pond culture resources and activities as well as any water courses which serve as water sources for fish ponds.
- 3.4.6.3 The fisheries impact assessment for construction and operation of the Project shall follow the detailed technical requirements given in Appendix G.

3.4.7 Landscape and Visual Impacts

- 3.4.7.1 The Applicant shall follow the criteria and guidelines as stated in Annexes 10 and 18 of the TM and the EIAO Guidance Note No.8/2010 on “Preparation of Landscape and Visual Impact Assessment under the Environmental Impact Assessment Ordinance” for evaluating and assessing the landscape and visual impacts.
- 3.4.7.2 The assessment area for landscape impact assessment shall include all areas within a 500m distance from the site boundary of the Project. The assessment area for the visual impact assessment shall be defined by the visual envelope of the Project.

3.4.7.3 The landscape and visual impact assessments for construction and operation of the Project shall follow the detailed technical requirements given in Appendix H.

3.4.8 Summary of Environmental Outcomes

3.4.9.1 The EIA report shall contain a summary of key environmental outcomes arising from the EIA study, including environmental benefits of the Project and the environmental protection measures recommended, population and environmentally sensitive areas protected, recommended environmentally friendly designs, key environmental problems avoided and any compensation areas included.

3.4.9 Environmental Monitoring and Audit (EM&A) Requirements

3.4.9.1 The Applicant shall identify and justify in the EIA study whether there is any need for EM&A activities during the construction and operation phases of the Project and, if affirmative, define the scope of EM&A requirements for the Project in the EIA study.

3.4.9.2 Subject to the confirmation of the EIA study findings, the Applicant shall follow the guidelines for an EM&A programme as stated in Annex 21 of the TM.

3.4.9.3 The Applicant shall prepare a Project Implementation Schedule in the form of a checklist as shown in Appendix I of this EIA study brief. It shall contain the EIA study recommendations and mitigation measures with reference to the implementation programme.

4. DURATION OF VALIDITY

4.1 The Applicant shall notify the Director of the commencement of the EIA study. If the EIA study does not commence within 36 months after the date of issue of this EIA study brief, the Applicant shall apply to the Director for a fresh EIA study brief before commencement of the EIA study.

5. REPORT REQUIREMENTS

5.1 In preparing the EIA report, the Applicant shall refer to Annex 11 of the TM for the contents of an EIA report. The Applicant shall also refer to Annex 20 of the TM, which stipulates the guidelines for the review of an EIA report.

5.2 The Applicant shall supply the Director with hard and electronic copies of the EIA report and the executive summary in accordance with the requirements given in Appendix J. The Applicant shall, upon request, make additional copies of EIA report/documents available to the public, subject to payment by the interested parties of full costs of printing.

6. OTHER PROCEDURAL REQUIREMENTS

- 6.1 If there is any change in the name of Applicant for this EIA study brief during the course of the EIA study, the Applicant must notify the Director immediately.

- 6.2 If there is any key change in the scope of the Project mentioned in Section 1.2 of this EIA study brief and in Project Profile (No. PP-458/2012), the Applicant must seek confirmation from the Director in writing on whether or not the scope of issues covered by this EIA study brief can still cover the key changes, and the additional issues, if any, that the EIA study must also address. If the changes to the Project fundamentally alter the key scope of the EIA study brief, the Applicant shall apply to the Director for a fresh EIA study brief.

--- END OF EIA STUDY BRIEF ---

April 2012
Environmental Assessment Division
Environmental Protection Department

Appendix A

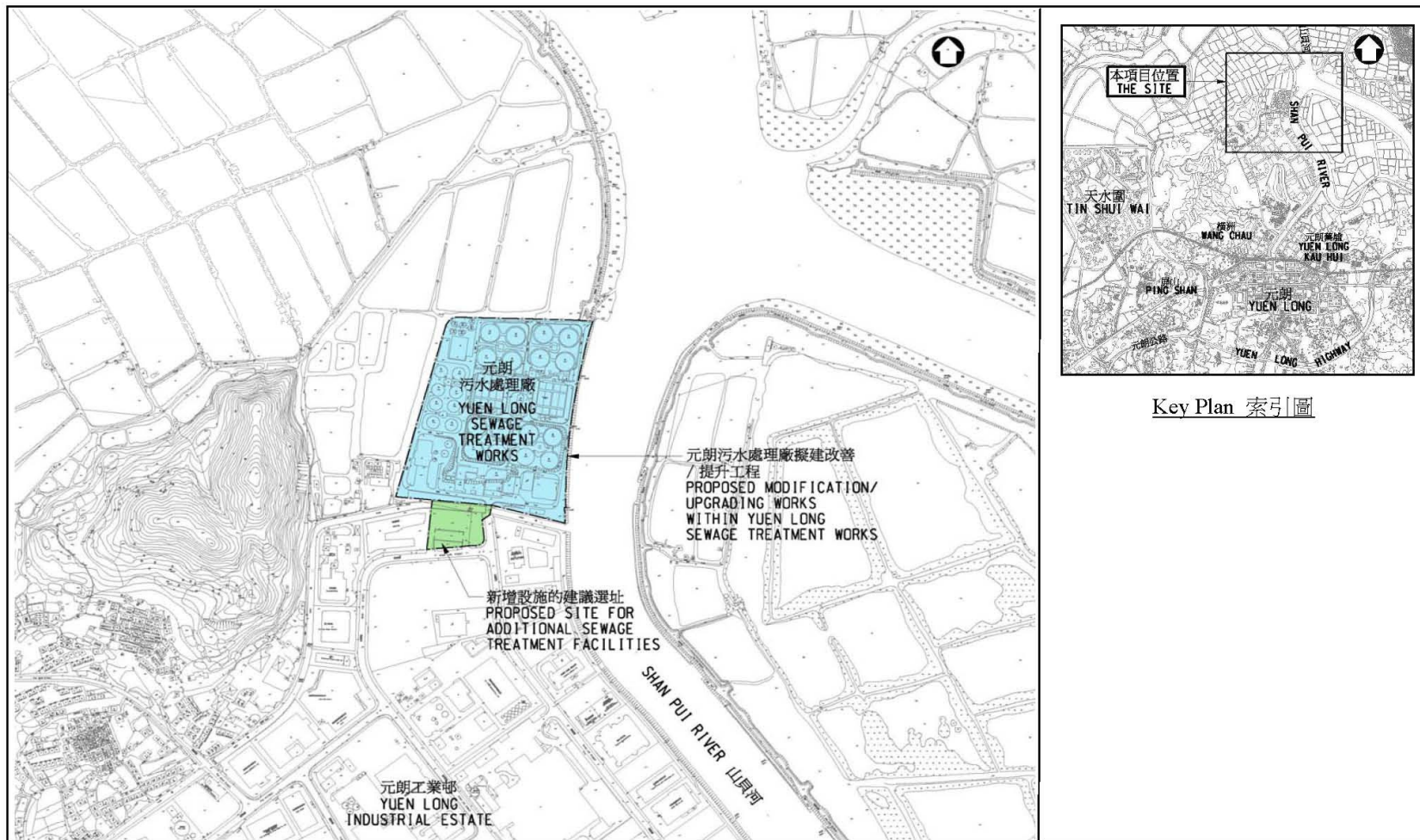

Key Plan 索引圖

Project Title : Effluent Polishing Scheme at Yuen Long Sewage Treatment Works

工程名稱 : 元朗污水處理廠加強處理工程

EIA Study Brief No.: **ESB-241/2012**
環評研究概要編號

Appendix A : Project Location Plan
附錄 A : 工程項目位置圖



Requirements for Air Quality Impact Assessment

The air quality impact assessment shall include the following:

1. Background and Analysis of Activities
 - (i) Provision of background information relating to air quality issues relevant to the Project, e.g. description of the types of activities of the Project that may affect air quality during construction and operation stages of the Project.
 - (ii) Provision of an account, where appropriate, of the consideration/ measures that have been taken into consideration during the planning of the Project to abate the air pollution impact. The Applicant shall consider alternative locations of the new treatment facilities, alternative treatment processes of STW and alternative construction methods to minimize the air quality impact during construction and operation stages of the Project.
 - (iii) Presentation of background air quality levels in the study area for the purpose of evaluating cumulative air quality impacts during construction and operation stages of the Project.
2. Identification of Air Sensitive Receivers (ASRs) and Examination of Emission/ Dispersion Characteristics
 - (i) Identification and description of existing, planned and committed ASRs that would likely be affected by the Project, including those earmarked on the relevant Outline Zoning Plans, Development Permission Area Plans, Outline Development Plans and Layout Plans and other relevant published land use plans, including plans and drawings published by Lands Department and any land use and development applications approved by the Town Planning Board. The Applicant shall select the assessment points of the identified ASRs that represent the worst impact point of these ASRs. A map clearly showing the location and description such as name of buildings, their uses and height of the selected assessment points shall be given. The separation distances of these ASRs from the nearest emission sources shall also be given.
 - (ii) Provision of a list of air pollution emission sources, including any nearby emission sources which are likely to have impact related to the Project based on the analysis of the construction and operation activities in Section 1 above. Confirmation regarding the validity of the assumptions adopted and the magnitude of the activities (e.g. volume of construction material handled, etc.)

shall be obtained from the relevant government departments/authorities and documented.

- (iii) The emissions from any concurrent projects identified as relevant during the course of the EIA study shall be taken into account as contributing towards the overall cumulative air quality impact. The impact as affecting the existing, committed and planned ASRs within the study area shall be assessed, based on the best information available at the time of assessment.

3. Construction Phase Air Quality Impact

- (i) The Applicant shall follow the requirements stipulated under the Air Pollution Control (Construction Dust) Regulation to ensure that construction dust impacts are controlled within the relevant standards as stipulated in Section 1 of Annex 4 of the TM. A monitoring and audit programme for the construction phase of the Project shall be devised to verify the effectiveness of the proposed control measures so as to ensure proper control of fugitive dust emission.
- (ii) If the Applicant anticipates that the Project will give rise to significant construction dust impacts likely to exceed recommended limits in the TM at the ASRs despite the incorporation of the dust control measures proposed, a quantitative assessment should be carried out to evaluate the construction dust impact at the identified ASRs. The Applicant shall follow the methodology set out in Section 5 below when carrying out the quantitative assessment.
- (iii) The applicant shall ensure that any odour emission resulting from the construction activities of the Project is properly controlled and meet the relevant criteria as stipulated in Section 1 of Annex 4 of the TM. A monitoring and audit programme for the construction phase of the Project shall be devised to verify the effectiveness of the proposed control measures so as to ensure proper odour emission control.

4. Operational Phase Air Quality Impact

- (i) The Applicant shall assess the potential air quality impact arising from the activities in the proposed Project site, including odour from the sewage treatment works and sludge generated, during the operational phase based on assumed reasonably worst case scenario under normal operating condition.
- (ii) If the Applicant anticipates that the Project will give rise to significant operational phase air quality impacts likely to exceed the recommended limits in the TM at the ASRs, a quantitative assessment should be carried out to

evaluate the operational phase air quality impacts at the identified ASRs. The Applicant shall follow the methodology set out in Section 5 below when carrying out the quantitative assessment. A monitoring and audit programme for the operational stage shall be devised to verify the effectiveness of the control measures proposed so as to ensure proper operational odour control.

5. Quantitative Assessment Methodology

- (i) The Applicant shall apply the general principles enunciated in the modeling guidelines in Appendices B1 to B3 while making allowance for the specific characteristic of the Project. This specific methodology must be documented in such level of details, preferably assisted with tables and diagrams, to allow the readers of the EIA report to grasp how the model has been set up to simulate the situation under study without referring to the model input files. Detailed calculations of air pollutants emission rates for input to the model shall be presented in the EIA report. The Applicant must ensure consistency between the text description and the model files at every stage of submissions for review. In case of doubt, prior agreement between the Applicant and the Director on the specific modelling details should be sought.
- (ii) The Applicant shall identify the key/representative air pollution parameters (types of pollutants and averaging time concentrations) to be evaluated and provide explanation for selecting such parameters for assessing the impact from the Project.
- (iii) The Applicant shall calculate the overall cumulative air quality impact at the ASRs identified under Section 2 above and compare these results against the criteria set out in section 1 of Annex 4 in the TM. The predicted air quality impacts (both unmitigated and mitigated) shall be presented in the form of summary table(s) and pollution contours, to be evaluated against the relevant air quality standards and on any effect they may have on the land use implications. Plans of a suitable scale should be used to present pollution contours to allow buffer distance requirements to be determined properly.
- (iv) For the quantitative assessment of the odour emission impact upon the identified ASRs, the odour emission strength/ rates shall be based on the results of odorous air sampling/ measurement conducted directly at the odour emission sources within the Project boundary. The details of such odorous air sampling/ measurement, including the methodology and calculation of the odour emission strength/rates, shall be presented in the EIA report.

6. Mitigation Measures for Non-compliance

The Applicant shall propose remedies and mitigating measures where the predicted air quality impact exceeds the criteria set in Section 1 of Annex 4 in the TM. These measures and any constraints on future land use planning shall be agreed with the relevant government departments/authorities and documented. The Applicant shall demonstrate quantitatively whether the residual impacts after incorporation of the proposed mitigating measures will comply with the criteria stipulated in Section 1 of Annex 4 in the TM.

7. Submission of Model Files

All input and output files of the model run(s), including those files for the generation of pollution contours as well as the emissions calculation worksheets, shall be submitted to the Director in electronic format together with the submission of the EIA report.

Guidelines on Choice of Models and Model Parameters

[The information contained in this Appendix is only meant to assist the Applicant in performing the air quality assessment. The Applicant must exercise professional judgment in applying this general information for the Project.]

1. Introduction

1.1 To expedite the review process by the Authority and to assist project proponents or environmental consultants with the conduct of air quality modelling exercise which are frequently called for as part of environmental impact assessment studies, this paper describes the usage and requirements of a few commonly used air quality models.

2. Choice of Models

2.1 The models which have been most commonly used in air quality impact assessments, due partly to their ease of use and partly to the quick turn-around time for results, are of Gaussian type and designed for use in simple terrain under uniform wind flow. There are circumstances when these models are not suitable for ambient concentration estimates and other types of models such as physical, numerical or mesoscale models will have to be used. In situations where topographic, terrain or obstruction effects are minimal between source and receptor, the following Gaussian models can be used to estimate the near-field impacts of a number of source types including dust, traffic and industrial emissions.

<u>Model</u>	<u>Applications</u>
FDM	for evaluating fugitive and open dust source impacts (point, line and area sources)
CALINE4	for evaluating mobile traffic emission impacts (line sources)
ISCST3	for evaluating industrial chimney releases as well as area and volumetric sources (point, area and volume sources); line sources can be approximated by a number of volume sources.

These frequently used models are also referred to as Schedule 1 models (see attached list).

2.2 Note that both FDM and CALINE4 have a height limit on elevated sources (20 m and 10m, respectively). Source of elevation above these limits will have to be modelled using the ISCST3 model or suitable alternative models. In using the latter, reference should be made to the 'Guidelines on the Use of Alternative Computer Models in Air Quality Assessment' in Appendix B-3.

- 2.3 The models can be used to estimate both short-term (hourly and daily average) and long-term (annual average) ambient concentrations of air pollutants. The model results, obtained using appropriate model parameters (refer to Section 3) and assumptions, allow direct comparison with the relevant air quality standards such as the Air Quality Objectives (AQOs) for the relevant pollutant and time averaging period.

3 Model Input Requirements

3.1 Meteorological Data

- 3.1.1 At least 1 year of recent meteorological data (including wind speed, wind direction, stability class, ambient temperature and mixing height) from a weather station either closest to or having similar characteristics as the study site should be used to determine the highest short-term (hourly, daily) and long-term (annual) impacts at identified air sensitive receivers in that period. The amount of valid data for the period should be no less than 90 percent.

- 3.1.2 Alternatively, the meteorological conditions as listed below can be used to examine the worst case short-term impacts:

Day time: stability class D; wind speed 1 m/s (at 10m height); worst-case wind angle; mixing height 500 m

Night time: stability class F; wind speed 1 m/s (at 10m height); worst case wind angle; mixing height 500 m

This is a common practice with using the CALINE4 model due to its inability to handle lengthy data set.

- 3.1.3 For situations where, for example, (i) the model (such as CALINE4) does not allow easy handling of one full year of meteorological data; or (ii) model run time is a concern, the followings can be adopted in order to determine the daily and annual average impacts:

- (i) perform a frequency occurrence analysis of one year of meteorological data to determine the actual wind speed (to the nearest unit of m/s), wind direction (to the nearest 10°) and stability (classes A to F) combinations and their frequency of occurrence;
- (ii) determine the short term hourly impact under all of the identified wind speed, wind direction and stability combinations; and
- (ii) apply the frequency data with the short term results to determine the long term (daily /annual) impacts.

Apart from the above, any alternative approach that will capture the worst possible impact values (both short term and long term) may also be considered.

- 3.1.4 Note that the anemometer height (relative to a datum same for the sources and receptors) at which wind speed measurements were taken at a selected station should be correctly entered in the model. These measuring positions can vary greatly from station to station and the vertical wind profile employed in the model can be grossly distorted from the real case if incorrect anemometer height is used. This will lead to unreliable concentration estimates.
- 3.1.5 An additional parameter, namely, the standard deviation of wind direction, σ_{θ} , needs to be provided as input to the CALINE4 model. Typical values of σ_{θ} range from 12° for rural areas to 24° for highly urbanised areas under 'D' class stability. For semi-rural such as new development areas, 18° is more appropriate under the same stability condition. The following reference can be consulted for typical ranges of standard deviation of wind direction under different stability categories and surface roughness conditions.

Ref.(1): Guideline On Air Quality Models (Revised), EPA-450/2-78-027R, United States Environmental Protection Agency, July 1986.

3.2 Emission Sources

All the identified sources relevant to a process plant or a study site should be entered in the model and the emission estimated based on emission factors compiled in the AP-42 (Ref. 2) or other suitable references. The relevant sections of AP-42 and any parameters or assumptions used in deriving the emission rates (in units g/s, g/s/m or g/s/m²) as required by the model should be clearly stated for verification. The physical dimensions, location, release height and any other emission characteristics such as efflux conditions and emission pattern of the sources input to the model should also correspond to site data.

If the emission of a source varies with wind speed, the wind speed-dependent factor should be entered.

Ref.(2): Compilation of Air Pollutant Emission Factors, AP-42, 5th Edition, United States Environmental Protection Agency, January 1995.

3.3 Urban/Rural Classification

Emission sources may be located in a variety of settings. For modelling purposes these are classed as either rural or urban so as to reflect the enhanced mixing that occurs over urban areas due to the presence of buildings and urban heat effects. The selection of either rural or urban dispersion coefficients in a specific application should follow a land use classification procedure. If the land use types including industrial, commercial and residential uses account

for 50% or more of an area within 3 km radius from the source, the site is classified as urban; otherwise, it is classed as rural.

3.4 Surface Roughness Height

This parameter is closely related to the land use characteristics of a study area and associated with the roughness element height. As a first approximation, the surface roughness can be estimated as 3 to 10 percent of the average height of physical structures. Typical values used for urban and new development areas are 370 cm and 100 cm, respectively.

3.5 Receptors

These include discrete receptors representing all the identified air sensitive receivers at their appropriate locations and elevations and any other discrete or grid receptors for supplementary information. A receptor grid, whether Cartesian or Polar, may be used to generate results for contour outputs.

3.6 Particle Size Classes

In evaluating the impacts of dust-emitting activities, suitable dust size categories relevant to the dust sources concerned with reasonable breakdown in TSP ($< 30 \mu\text{m}$) and RSP ($< 10 \mu\text{m}$) compositions should be used.

3.7 NO₂ to NO_x Ratio

The conversion of NO_x to NO₂ is a result of a series of complex photochemical reactions and has implications on the prediction of near field impacts of traffic emissions. Until further data are available, three approaches are currently acceptable in the determination of NO₂:

- (a) Ambient Ratio Method (ARM) - assuming 20% of NO_x to be NO₂; or
- (b) Discrete Parcel Method (DPM, available in the CALINE4 model); or
- (c) Ozone Limiting Method (OLM) - assuming the tailpipe NO₂ emission to be 7.5% of NO_x and the background ozone concentration to be in the range of 57 to 68 $\mu\text{g}/\text{m}^3$ depending on the land use type (see also the EPD reference paper 'Guidelines on Assessing the 'TOTAL' Air Quality Impacts' in [Appendix B-2](#)).

3.8 Odour Impact

In assessing odour impacts, a much shorter time-averaging period of 5 seconds is required due to the shorter exposure period tolerable by human receptors. Conversion of model computed hourly average results to 5-second values is therefore necessary to enable comparison against recommended standard. The hourly concentration is first converted to 3-minute average value according to a power law relationship which is stability dependent (Ref. 3) and a result of the statistical nature of atmospheric turbulence. Another conversion factor (10 for unstable

conditions and 5 for neutral to stable conditions) is then applied to convert the 3-minute average to 5-second average (Ref. 4). In summary, to convert the hourly results to 5-second averages, the following factors can be applied:

<u>Stability Category</u>	<u>1-hour to 5-sec Conversion Factor</u>
A & B	45
C	27
D	9
E & F	8

Under 'D' class stability, the 5-second concentration is approximately 10 times the hourly average result. Note, however, that the combined use of such conversion factors together with the ISCST results may not be suitable for assessing the extreme close-up impacts of odour sources.

Ref.(3): Richard A. Duffee, Martha A. O'Brien and Ned Ostojic, 'Odor Modeling – Why and How', Recent Developments and Current Practices in Odor Regulations, Controls and Technology, Air & Waste Management Association, 1991.

Ref.(4): A.W.C. Keddie, 'Dispersion of Odours', Odour Control – A Concise Guide, Warren Spring Laboratory, 1980.

3.9 Plume Rise Options

The ISCST3 model provides by default a list of the U.S. regulatory options for concentration calculations. These are all applicable to the Hong Kong situations except for the 'Final Plume Rise' option. As the distance between sources and receptors are generally fairly close, the non-regulatory option of 'Gradual Plume Rise' should be used instead to give more accurate estimate of near-field impacts due to plume emission. However, the 'Final Plume Rise' option may still be used for assessing the impacts of distant sources.

3.10 Portal Emissions

These include traffic emissions from tunnel portals and any other similar openings and are generally modelled as volume sources according to the PIARC 91 (or more up-to-date version) recommendations (Ref. 5, section III.2). For emissions arising from underpasses or any horizontal openings of the like, these are treated as area or point sources depending on the source physical dimensions. In all these situations, the ISCST3 model or more sophisticated models will have to be used instead of the CALINE4 model. In the case of portal emissions with significant horizontal exit velocity which cannot be handled by the ISCST3 model, the impacts may be estimated by the TOP model (Ref. 6) or any other suitable models subject to prior agreement with EPD. The EPD's 'Guidelines on the Use of Alternative Computer Models in Air Quality Assessment' should also be referred to in [Appendix B-3](#).

Ref.(5): XIXth World Road Congress Report, Permanent International Association of Road Congresses (PIARC), 1991.

Ref.(6): N. Ukegunchi, H. Okamoto and Y. Ide "Prediction of vehicular emission pollution around a tunnel mouth", Proceedings 4th International Clean Air Congress, pp. 205-207, Tokyo, 1977.

3.11 Background Concentrations

Background concentrations are required to account for far-field sources which cannot be estimated by the model. These values, to be used in conjunction with model results for assessing the total impacts, should be based on long term average of monitoring data at location representative of the study site. Please make reference to the paper 'Guidelines on Assessing the 'TOTAL' Air Quality Impacts' in Appendix B-2 for further information.

3.12 Output

The highest short-term and long-term averages of pollutant concentrations at prescribed receptor locations are output by the model and to be compared against the relevant air quality standards specified for the relevant pollutant. Contours of pollutant concentration are also required for indicating the general impacts of emissions over a study area.

Copies of model files in electronic format should also be provided for EPD's reference.

Schedule 1

Air Quality Models Generally Accepted by Hong Kong Environmental Protection Department for Regulatory Applications as at 1 July 1998*

Industrial Source Complex Dispersion Model - Short Term Version 3 (ISCST3) or the latest version developed by U.S. Environmental Protection Agency

California Line Source Dispersion Model Version 4 (CALINE4) or the latest version developed by Department of Transportation, State of California, U.S.A.

Fugitive Dust Model (FDM) or the latest version developed by U.S. Environmental Protection Agency

EPD is continually reviewing the latest development in air quality models and will update this Schedule accordingly.

- END -

Appendix B-2**Guidelines on Assessing the 'TOTAL' Air Quality Impacts**

[The information contained in this Appendix is only meant to assist the Applicant in performing the air quality assessment. The Applicant must exercise professional judgment in applying this general information for the Project.]

1. Total Impacts - 3 Major Contributions

1.1 In evaluating the air quality impacts of a proposed project upon air sensitive receivers, contributions from three classes of emission sources depending on their distance from the site should be considered. These are:

Primary contributions:	project induced
Secondary contributions:	pollutant-emitting activities in the immediate neighbourhood
Other contributions: (Background contributions)	pollution not accounted for by the previous two

2. Nature of Emissions**2.1 Primary contributions**

In most cases, the project-induced emissions are fairly well defined and quite often (but not necessarily) the major contributor to local air quality impacts. Examples include those due to traffic network, building or road construction projects.

2.2 Secondary contributions

Within the immediate neighbourhood of the project site, there are usually pollutant emitting activities contributing further to local air quality impacts. For most local scale projects, any emission sources in an area within 500m radius of the project site with notable impacts should be identified and included in an air quality assessment to cover the short-range contributions. In the exceptional cases where there is one or more significant sources nearby, the study area may have to be extended or alternative estimation approach employed to ensure these impacts are reasonably accounted for.

2.3 Background contributions

The above two types of emission contributions should account for, to a great extent, the air quality impacts upon local air sensitive receivers, which are often amenable to estimation by the 'Gaussian Dispersion' type of models. However, a background air quality level should be prescribed to indicate the baseline air quality in the region of the project site, which would

account for any pollution not covered by the two preceding contributions. The emission sources contributing to the background air quality would be located further afield and not easy to identify. In addition, the transport mechanism by which pollutants are carried over long distances (ranging from 1km up to tens or hundreds of kms) is rather complex and cannot be adequately estimated by the 'Gaussian' type of models.

3 Background Air Quality - Estimation Approach

3.1 The approach

In view of the difficulties in estimating background air quality using the air quality models currently available, an alternative approach based on monitored data is suggested. The essence of this approach is to adopt the long-term (5-year) averages of the most recent monitored air quality data obtained by EPD. These background data would be reviewed yearly or biennially depending on the availability of the monitored data. The approach is a first attempt to provide a reasonable estimate of the background air quality level for use in conjunction with EIA air quality assessment to address the cumulative impacts upon a locality. This approach may be replaced or supplemented by superior modelling efforts such as that entailed in PATH (Pollutants in the Atmosphere and their Transport over Hong Kong), a comprehensive territory-wide air quality modelling system currently being developed for Hong Kong. Notwithstanding this, the present approach is based on measured data and their long term regional averages; the background values so derived should therefore be indicative of the present background air quality. In the absence of any other meaningful way to estimate a background air quality for the future, this present background estimate should also be applied to future projects as a first attempt at a comprehensive estimate until a better approach is formulated.

3.2 Categorisation

The monitored air quality data, by 'district-averaging' are further divided into three categories, viz, Urban, Industrial and Rural/New Development. The background pollutant concentrations to be adopted for a project site would depend on the geographical constituency to which the site belongs. The categorization of these constituencies is given in Section 3.4. The monitoring stations suggested for the 'district-averaging'(arithmetic means) to derive averages for the three background air quality categories are listed as follows:

Urban: Kwun Tong, Sham Shui Po, Tsim Sha Tsui and Central/Western
 Industrial: Kwun Tong, Tsuen Wan and Kwai Chung
 Rural/New Development: Sha Tin, Tai Po, Junk Bay, Hong Kong South and Yuen Long

The averaging would make use of data from the above stations wherever available. The majority of the monitoring stations are located some 20m above ground.

3.3 Background pollutant values

Based on the above approach, background values for the 3 categories have been obtained for a few major air pollutants as follows:

POLLUTANT	URBAN	INDUSTRIAL	RURAL / NEW DEVELOPMENT
NO ₂	59	57	39
SO ₂	21	26	13
O ₃	62	68	57
TSP	98	96	87
RSP	60	58	51

All units are in micrograms per cubic metre. The above values are derived from 1992 to 1996 annual averages with the exception of ozone which represent annual average of daily hourly maximum values for year 1996.

In cases where suitable air quality monitoring data representative of the study site such as those obtained from a nearby monitoring station or on-site sampling are not available for the prescription of background air pollution levels, the above tabulated values can be adopted instead. Strictly speaking, the suggested values are only appropriate for long term assessment. However, as an interim measure and until a better approach is formulated, the same values can also be used for short term assessment. This implies that the short term background values will be somewhat under-estimated, which compensates for the fact that some of the monitoring data are inherently influenced by secondary sources because of the monitoring station location.

Indeed, if good quality on-site sampling data which cover at least one year period are available, these can be used to derive both the long term (annual) and short term (daily / hourly) background values, the latter are usually applied on an hour to hour, day to day basis.

3.4 Site categories

The categories to which the 19 geographical constituencies belong are listed as follows:

DISTRICT	AIR QUALITY CATEGORY
Islands	Rural / New Development
Southern	Rural / New Development
Eastern	Urban
Wan Chai	Urban
Central & Western	Urban
Sai Kung	Rural / New Development

Kwun Tong	Industrial
Wong Tai Sin	Urban
Kowloon City	Urban
Yau Tsim	Urban
Mong Kok	Urban
Sham Shui Po	Urban
Kwai Tsing	Industrial
Sha Tin	Rural / New Development
Tsuen Wan	Industrial
Tuen Mun	Rural / New Development
Tai Po	Rural / New Development
Yuen Long	Rural / New Development
Northern	Rural / New Development

3.5 Provisions for 'double-counting'

The current approach is, by no means, a rigorous treatment of background air quality but aims to provide an as-realistic-as-possible approximation based on limited field data. 'Double-counting' of 'secondary contributions' may be apparent through the use of such 'monitoring-based' background data as some of the monitoring stations are of close proximity to existing emission sources. 'Primary contributions' due to a proposed project (which is yet to be realized) will not be double-counted by such an approach. In order to avoid over-estimation of background pollutant concentrations, an adjustment to the values given in Section 3.3 is possible and optional by multiplying the following factor:

$$(1.0 - E_{\text{Secondary contributions}}/E_{\text{Territory}})$$

where E stands for emission.

The significance of this factor is to eliminate the fractional contribution to background pollutant level of emissions due to 'secondary contributions' out of those from the entire territory. In most cases, this fractional contribution to background pollutant levels by the secondary contributions is minimal.

4 Conclusions

- 4.1 The above described approach to estimating the total air quality impacts of a proposed project, in particular the background pollutant concentrations for air quality assessment, should be adopted with immediate effect. Use of short term monitoring data to prescribe the background concentrations is no longer acceptable.

- END -

Appendix B-3**Guidelines on the Use of Alternative Computer Models in Air Quality Assessment**

[The information contained in this Appendix is only meant to assist the Applicant in performing the air quality assessment. The Applicant must exercise professional judgment in applying this general information for the Project.]

1. Background

1.1 In Hong Kong, a number of Gaussian plume models are commonly employed in regulatory applications such as application for specified process licences and environmental impact assessments (EIAs). These frequently used models (as listed in Schedule 1 attached; hereafter referred to as Schedule 1 models) have no regulatory status but form the basic set of tools for local-scale air quality assessment in Hong Kong.

1.2 However, no single model is sufficient to cover all situations encountered in regulatory applications. In order to ensure that the best model available is used for each regulatory application and that a model is not arbitrarily applied, the project proponent (and/or its environmental consultants) should assess the capabilities of various models available and adopt one that is most suitable for the project concerned.

1.3 Examples of situations where the use of an alternative model is warranted include:

- (i) the complexity of the situation to be modelled far exceeds the capability of the Schedule 1 models; and
- (ii) the performance of an alternative model is comparable or better than the Schedule 1 models.

1.4 This paper outlines the demonstration / submission required in order to support the use of an alternative air quality model for regulatory applications for Hong Kong.

2. Required Demonstration / Submission

2.1 Any model that is proposed for air quality applications and not listed amongst the Schedule 1 models will be considered by EPD on a case-by-case basis. In such cases, the proponent will have to provide the followings for EPD's review :

- (i) Technical details of the proposed model; and
- (ii) Performance evaluation of the proposed model

Based on the above information, EPD will determine the acceptability of the proposed model

for a specific or general applications. The onus of providing adequate supporting materials rests entirely with the proponent.

2.2 To provide technical details of the proposed model, the proponent should submit documents containing at least the following information :

- (i) mathematical formulation and data requirements of the model;
- (ii) any previous performance evaluation of the model; and
- (iii) a complete set of model input and output file(s) in commonly used electronic format.

2.3 On performance evaluation, the required approach and extent of demonstration varies depending on whether a Schedule 1 model is already available and suitable in simulating the situation under consideration. In cases where no Schedule 1 model is found applicable, the proponent must demonstrate that the proposed model passes the screening test as set out in USEPA Document "Protocol for Determining the Best Performing Model" (Ref. 1).

Ref.(1): William M. Cox, 'Protocol for Determining the Best Performing Model'; Publication No. EPA-454/R-92-025; U.S. Environmental Protection Agency, Research Triangle Park, NC.

2.4 For cases where a Schedule 1 model is applicable to the project under consideration but an alternative model is proposed for use instead, the proponent must demonstrate either that :

- (i) the highest and second highest concentrations predicted by the proposed model are within 2 percent of the estimates obtained from an applicable Schedule 1 model (with appropriate options chosen) for all receptors for the project under consideration; or
- (ii) the proposed model has superior performance against an applicable Schedule 1 model based on the evaluation procedure set out in USEPA Document "Protocol for Determining the Best Performing Model" (Ref. 1).

2.5 Should EPD find the information on technical details alone sufficient to indicate the acceptability of the proposed model, information on further performance evaluation as specified in Sections 2.3 and 2.4 above would not be necessary.

2.6 If the proposed model is an older version of one of the Schedule 1 models or was previously included in Schedule 1, the technical documents mentioned in Section 2.2 are normally not required. However, a performance demonstration of equivalence as stated in Section 2.4 (i) would become necessary.

2.7 If EPD is already in possession of some of the documents that describe the technical details of the proposed model, submission of the same by the proponent is not necessary. The proponent may check with EPD to avoid sending in duplicate information.

Schedule 1

**Air Quality Models Generally Accepted by
Hong Kong Environmental Protection Department for
Regulatory Applications as at 1 July 1998***

Industrial Source Complex Dispersion Model - Short Term Version 3 (ISCST3) or the latest version developed by U.S. Environmental Protection Agency

California Line Source Dispersion Model Version 4 (CALINE4) or the latest version developed by Department of Transportation, State of California, U.S.A.

Fugitive Dust Model (FDM) or the latest version developed by U.S. Environmental Protection Agency

EPD is continually reviewing the latest development in air quality models and will update this Schedule accordingly.

- END -

Requirements for Noise Impact Assessment

The noise impact assessment shall include the following:

1. Provision of Background Information

The Applicant shall provide background information relevant to the Project, including relevant previous or current studies.

2. Identification of Noise Sensitive Receivers

(a) The Applicant shall refer to Annex 13 of the TM when identifying the NSRs. The NSRs shall include existing NSRs and planned/committed noise sensitive developments and uses earmarked on the relevant Outline Zoning Plans, Outline Development Plans, Layout Plans and other relevant published land use plans, including plans and drawings published by Lands Department and any land use and development applications approved by the Town Planning Board. Photographs of existing NSRs shall be appended to the EIA report.

(b) The Applicant shall select assessment points to represent the identified NSRs for carrying out quantitative noise assessment described below. A map showing the locations and descriptions such as name of building, use, and floor of the selected assessment points shall be given.

3. Provision of an Emission Inventory of the Noise Sources

The Applicant shall provide an inventory of noise sources including representative construction equipment for the purpose of carrying out the construction noise assessment and electrical and mechanical equipment at STW for the purpose of carrying out the operational noise assessment. Confirmation of the validity of the inventory shall be obtained from the relevant government departments/authorities and documented in the EIA report.

4. Construction Noise Assessment

(a) The Applicant shall carry out assessment of noise impact from construction (excluding percussive piling) of the Project during daytime, i.e. 7am to 7pm, on weekdays other than general holidays in accordance with methodology in paragraphs 5.3 and 5.4 of Annex 13 of the TM. The criteria in Table 1B of Annex 5 of TM shall be adopted in the assessment.

- (b) To minimize the construction noise impact, alternative construction methods to replace percussive piling and blasting shall be proposed as far as practicable.
- (c) If the unmitigated construction noise levels are found exceeding the relevant criteria, the Applicant shall propose practicable direct mitigation measures (including movable barriers, enclosures, quieter alternative methods, rescheduling and restricting hours of operation of noisy tasks) to minimize the impact. If the mitigated noise levels still exceed the relevant criteria, the duration of the noise exceedance at the affected NSRs shall be given.
- (d) The Applicant shall, as far as practicable, formulate a reasonable construction programme so that no work will be required in restricted hours as defined under the Noise Control Ordinance (NCO). In case the Applicant needs to evaluate whether construction works in restricted hours as defined under the NCO are feasible or not in the context of programming construction works, reference should be made to relevant technical memoranda issued under the NCO. In case the Applicant considers that there is an unavoidable need to conduct certain type of construction works during the restricted hours, justifications shall be provided with the assessment of the degree and duration of the noise impact. Regardless of the results of construction noise impact assessment for restricted hours, the Noise Control Authority will process Construction Noise Permit (CNP) application, if necessary, based on the NCO, the relevant technical memoranda issued under the NCO, and the contemporary conditions/situations. This aspect shall be explicitly stated in the EIA report.
- (e) The assessment shall cover the cumulative noise impacts due to the construction works of the Project and other concurrent projects identified during the course of the EIA study.

5. Operation Noise Assessment of Fixed Noise Sources

(a) Assessment of Fixed Source Noise Levels

The Applicant shall calculate the expected noise using standard acoustics principles. Calculations for the expected noise shall be based on assumed plant inventories and utilization schedule for the worst-case scenario. The Applicant shall calculate noise levels taking into account correction of tonality, impulsiveness and intermittency in accordance with Technical Memorandum for the Assessment of Noise from Places other than Domestic Premises, Public Places or Construction Sites issued under the NCO. The Applicant shall provide justification for the sound power level of each type of fixed noise sources.

(b) Presentation of Noise Levels

The Applicant shall present the existing and future noise levels in L_{eq} (30 min) at the NSRs at various representative floor levels (in m P.D.) on tables and plans of suitable scale. A quantitative assessment at the NSRs for the fixed noise sources shall be carried out and compared against the criteria set out in Table 1A of Annex 5 of the TM.

(c) Proposals for Noise Mitigation Measures

The Applicant shall propose direct technical remedies within the Project limits in situations where the predicted noise level exceeds the criteria set out in Table 1A of Annex 5 of the TM to protect the affected NSRs.

6. Assessment of Side Effects and Constraints

The Applicant shall identify, assess and propose means to minimize any side effects and to resolve any potential constraints due to the inclusion of any recommended direct mitigation measures.

7. Evaluation of Constraints on Planned Noise Sensitive Developments/Land uses

For planned noise sensitive uses which will still be affected even with practicable direct mitigation measures in place, the Applicant shall propose, evaluate and confirm the practicability of additional measures within the planned noise sensitive uses and shall make recommendations on how these noise sensitive uses will be designed for the information of relevant parties.

The Applicant shall take into account agreed environmental requirements/ constraints identified by the EIA study to assess the development potential of concerned sites which shall be made known to the relevant parties.

Appendix D**Requirements for Water Quality Impact Assessment**

1. The Applicant shall identify and analyse physical, chemical and biological disruptions of the water system(s) arising from the construction and operation of the Project.
2. The Applicant shall predict, quantify and assess any water quality impacts arising from the construction and operation of the Project by appropriate mathematical modelling and/or other techniques proposed by the Applicant and approved by the Director. The mathematical modelling requirements are set out in Appendix D-1. Possible impacts due to the [dredging, fill extraction, backfilling, transportation and disposal of dredged materials, other marine works activities, effluent discharge, thermal/cooling water and biocide discharge, overflow of sewage pumping stations and site runoff] shall include changes in hydrology, flow regime, sediment erosion and deposition patterns, morphological change of seabed profile, water quality and sediment quality. The prediction shall include possible different construction stages or sequences of the Project. Affected sensitive receivers shall be identified by the assessment tool with indications of degree of severity.
3. The assessment shall include, but not be limited to the following:
 - (i) the water quality impacts of the site run-off generated during the construction stage such as the effluents generated from dewatering associated with piling activities, grouting and concrete washing and those specified in the ProPECC Practice Note 1/94;
 - (ii) the assessment on operation stage shall have regard to the frequency, duration, volume and flow rate of the discharges and its pollutant;
 - (iii) the water quality impacts of temporary, accidental and emergency discharges at the STW during construction and operation stages of the Project; and
 - (iv) the water quality impacts of chemical spillage during construction and operation stages of the Project in particular the accidental spillage associated with transfer and storage of chemicals during operation of the Project.
4. The Applicant shall address water quality impacts due to the construction phase and operational phase of the Project. Essentially, the assessment shall address the following :

- (i) collect and review background information on affected existing and planned water systems, their respective catchments and sensitive receivers which might be affected by the Project;
- (ii) characterize water quality of the water systems and sensitive receivers, which might be affected by the Project based on existing best available information or through appropriate site survey and tests;
- (iii) identify and analyse relevant existing and planned future activities, beneficial uses and water sensitive receivers related to the affected water system(s). The Applicant should refer to, *inter alia*, those developments and uses earmarked on the relevant Outline Zoning Plans, Development Permission Area Plans, Outline Development Plans and Layout Plans, and any other relevant published landuse plans;
- (iv) identify pertinent water quality objectives and establish other appropriate water quality criteria or standards for the water system(s) and the sensitive receivers identified in (i), (ii) & (iii) above;
- (v) review the specific construction methods and configurations, and operation of the Project to identify and predict the likely water quality impacts arising from the Project;
- (vi) identify any alternation of any water courses, natural streams, ponds, wetlands, flow regimes of water bodies, catchment types or areas, erosion or sedimentation due to the Project and any other hydrological changes in the study area;
- (vii) identify and quantify existing and likely future water pollution sources, including point discharges and non-point sources to surface water runoff, sewage from workforce and polluted discharge generated from the Project;
- (viii) provide an emission inventory on the quantities and characteristics of those existing and future pollution sources in the study area. Field investigation and laboratory test, shall be conducted as appropriate to fill relevant information gaps;
- (ix) predict and quantify the water quality impacts arising from those alternations and changes identified in (vi) to (viii) above. The prediction shall take into account and include possible different construction and operation stages of the Project;

- (x) assess the cumulative impacts due to other related concurrent and planned projects, activities or pollution sources within the study area that may have a bearing on the environmental acceptability of the Project;
- (xi) analyze the provision and adequacy of existing and planned future facilities to reduce pollution arising from the point and non-point sources identified in (vii) above;
- (xii) develop effective infrastructure upgrading or provision, contingency plan, water pollution prevention and mitigation measures to be implemented during construction and operation stages, including emergency sewage discharge in the case of sewage treatment works and sewage pumping stations, so as to reduce the water quality impacts to within standards. Effluent generated from the Project shall require appropriate collection, treatment and disposal to ensure that there is no net increase in pollution load to Deep Bay. Requirements to be incorporated in the Project contract document shall also be proposed;
- (xiii) investigate and develop best management practices to reduce storm water and non-point source pollution as appropriate;
- (xiv) evaluate and quantify residual impacts on water system(s) and the sensitive receivers with regard to the appropriate water quality objectives, criteria, standards or guidelines;
- (xv) evaluate, predict and characterize the effluent characteristics of the Project with different levels of treatment and disinfection processes. The Applicant shall predict the effluent characteristics by making reference to the influent characteristics, anticipated performance of the treatment and disinfection process at the proposed sewage treatment works, the finding of previous studies, and conducting additional samplings and tests;
- (xvi) devise mitigation measures to avoid or minimize the impacts identified above. The residual water quality impacts of the water systems with regard to the relevant water quality objectives, criteria, standards or guidelines shall be assessed and quantified using appropriate mathematical models set out in Appendix D-1 to this study brief; and
- (xvii) recommend appropriate mitigation measures, including a contingency plan, to minimise the duration and impact of emergency overflow discharges during operation stage of the Project.

Hydrodynamic and Water Quality Modelling RequirementsModelling software general

1. The modelling software shall be fully 3-dimensional capable of accurately simulating the stratified condition, salinity transport, and effects of wind and tide on the water body within the model area.
2. The modelling software shall consist of hydrodynamic, water quality, sediment transport, thermal and particle dispersion modules. All modules shall have been proven with successful applications locally and overseas.
3. The hydrodynamic, water quality, sediment transport and thermal modules shall be strictly mass conserved at all levels.
4. An initial dilution model shall be used to characterize the initial mixing of the effluent discharge, and to feed the terminal level and size of the plume into the far field water quality modules where necessary. The initial dilution model shall have been proven with successful applications locally and overseas.

Model details – Calibration & Validation

1. The models shall be properly calibrated and validated against applicable existing and/or newly collected field data before their use in this study in the Hong Kong waters, the Pearl Estuary and the Dangan (Lema) Channel. The field data set for calibration and validation shall be agreed with EPD.
2. Tidal data shall be calibrated and validated in both frequency and time domain manner.
3. For the purpose of calibration and validation, the model shall run for not less than 15 days of real sequence of tide (excluding model spin up) in both dry and wet seasons with due consideration of the time required to establish initial conditions.
4. In general the hydrodynamic models shall be calibrated to the following criteria:

<u>Criteria</u>	<u>Level of fitness with field data</u>
• tidal elevation (@)	< 8 %
• maximum phase error at high water and low water	< 20 minutes
• maximum current speed deviation	< 30 %

- maximum phase error at peak speed < 20 minutes
 - maximum direction error at peak speed < 15 degrees
 - maximum salinity deviation < 2.5 ppt
- @ Root mean square of the error including the mean and fluctuating components shall meet the criteria at no less than 80% of the monitoring stations in the model domain

5. The consultants shall be responsible for acquiring/developing and calibration of the models for use in this study themselves. They may make reference to the models developed under the Update on Cumulative Water Quality and Hydrological Effect of Coastal Developments and Upgrading of Assessment Tool (Agreement No. CE 42/97). They may also propose to use other models subject to agreement with EPD.

Model details – Simulation

1. The water quality modelling results shall be qualitatively explainable, and any identifiable trend and variations in water quality shall be reproduced by the model. The water quality model shall be able to simulate and take account of the interaction of dissolved oxygen, phytoplankton, organic and inorganic nitrogen, phosphorus, silicate, BOD, temperature, suspended solids, contaminants release of dredged and disposed material, air-water exchange, *E. coli* and benthic processes. It shall also simulate salinity. Salinity results simulated by hydrodynamic models and water quality models shall be demonstrated to be consistent.
2. The sediment transport module for assessing impacts of sediment loss due to marine works shall include the processes of settling, deposition and re-erosion. The values of the modelling parameters shall be agreed with EPD. Contaminants release and DO depletion during dredging and dumping shall be simulated by the model.
3. The models shall at least cover the Hong Kong waters, the Pearl Estuary and the Dangan Channel to incorporate all major influences on hydrodynamic and water quality. A fine grid model may be used for detailed assessment of this study. It shall either be linked to a far field model or form part of a larger model by gradual grid refinement. The coverage of the fine grid model shall be properly designed such that it is remote enough so that the boundary conditions will not be affected by the project. The model coverage area shall be agreed with EPD.
4. In general, grid size at the area affected by the project shall be less than 400 m in open waters and less than 75 m around sensitive receivers. The grid shall also be able to reasonably represent coastal features existing and proposed in the project. The grid schematization shall be agreed with EPD.

Modelling assessment

1. The assessment shall include the construction and operation phases of the project. Where

appropriate, the assessment shall also include maintenance dredging. Scenarios to be assessed shall cover the baseline condition and scenarios with various different options proposed by the Applicant in order to quantify the environmental impacts and improvements that will be brought about by these options. Corresponding pollution load, bathymetry and coastline shall be adopted in the model set up.

2. Hydrodynamic, water quality, sediment transport and thermal modules, where appropriate, shall be run for (with proper model spin up) at least a real sequence of 15 days spring-neap tidal cycle in both the dry season and the wet season.
3. For assessing temporary discharges via the emergency outfall, the Applicant shall estimate discharge loading, pattern and duration. The worst case scenario shall include discharge near slack water of neap tide. A period of at least 15 days spring-neap cycle in wet season, but long enough for recovery of the receiving water, shall be simulated. Detailed methodology shall be agreed with EPD.
4. The results shall be assessed for compliance of Water Quality Objectives.
5. The impact on all sensitive receivers shall be assessed.
6. Cumulative impacts due to other projects, activities or pollution sources within a boundary to the agreement of EPD shall also be predicted and quantified.

Requirements for Assessment of Waste Management Implication and Land Contamination

The assessment of waste management implication and land contamination shall cover the following:

1. Analysis of Activities and Waste Generation

The Applicant shall identify the quantity, quality and timing of the wastes arising as a result of the construction and operation activities of the Project based on the sequence, duration, method and process of these activities, e.g. any dredged/excavated sediment/mud, construction and demolition materials, floating refuse, sewage sludge, screening, grits, chemical waste and other wastes which will be generated during construction and operation stages. The Applicant shall adopt appropriate design, general layout, construction methods and programme to minimize the generation of public fill/inert construction and demolition (C&D) materials and maximize the use of public fill/inert C&D materials for other construction works.

2. Proposal for Waste Management

- (i) Prior to considering the disposal options for various types of wastes, opportunities for reducing waste generation, on-site or off-site re-use and recycling shall be evaluated. Measures that can be taken in the planning and design stages e.g. by modifying the design approach and in the construction stage for maximizing waste reduction shall be separately considered;
- (ii) After considering the opportunities for reducing waste generation and maximizing re-use, the types and quantities of the wastes required to be disposed of as a consequence shall be estimated and the disposal methods/options for each type of wastes shall be described. The disposal methods/options recommended for each type of wastes shall take into account the result of the assessment in Section 2 (iv) below;
- (iii) The EIA report shall state the transportation routings and the frequency of the trucks/vessels involved, any barging point or conveyor system to be used, the stockpiling areas and the disposal outlets for the wastes identified; and
- (iv) The impact caused by handling (including stockpiling, labelling, packaging & storage), collection, transportation and re-use/disposal of wastes shall be addressed and appropriate mitigation measures shall be proposed. This assessment shall cover the following areas:

- potential hazard;
- air and odour emissions;
- noise;
- wastewater discharge;
- ecology; and
- public transport.

3. Land Contamination

- (i) The Applicant shall identify land lots and sites within the Project boundary which, due to their past or present land uses, are potentially contaminated sites. A detailed account of the present activities and past land use history in relation to possible land contamination shall be provided.
- (ii) The list of potential contaminants which are anticipated to be found in these potentially contaminated sites shall be provided and relevant remediation options shall be presented.

Requirements for Ecological Impact Assessment (Terrestrial and Aquatic)

1. In the ecological impact assessment, the Applicant shall examine the flora, fauna and other components of the ecological habitats within the assessment area. The aim shall be to protect, maintain or rehabilitate the natural environment. In particular, the Project shall avoid or minimise impacts on recognised sites of conservation importance and other ecologically sensitive areas such as the Mai Po Inner Deep Bay Ramsar Site, Wetland Conservation Area (WCA) and Wetland Buffer Area (WBA) as defined in Town Planning Board Guideline 12b and mudflats / mangrove along the embankment and at confluence of Kam Tin River and Shan Pui River. The assessment shall identify and quantify as far as possible the potential ecological impacts to the natural environment and the associated wildlife groups and habitats/species arising from the Project including its construction and operation phases as well as the subsequent management and maintenance of the proposals.
2. The assessment shall include the followings:
 - (i) Review of the findings of relevant studies/surveys and collection of the available information regarding the ecological characters of the assessment area;
 - (ii) Evaluation of information collected and identification of any information gap relating to the assessment of potential ecological impact, and determine the ecological field surveys and investigations that are needed for an impact assessment as required in the following sections;
 - (iii) Carrying out necessary field surveys and investigations to verify the information collected in (ii) above, to fill the information gaps identified and to fulfill the objectives of the EIA study;
 - (iv) Establishment of the general ecological profile of the assessment area based on data of relevant previous studies/surveys and results of the ecological field surveys, if any, and description of the characteristics of each habitat found; the data set should be representative covering the migratory bird overwintering season and the ardeid breeding season, and is valid for the purpose of this assessment. Major information to be provided shall include :
 - (a) description of the physical environment, including all recognized sites of conservation importance and other ecologically sensitive areas, and assessment of whether these sites/areas will be affected by the Project or not;

- (b) habitat maps of suitable scale (1:1000 to 1:5000) showing the types and locations of habitats/species in the assessment area;
 - (c) ecological characteristics of each habitat type such as size, type, species present, dominant species found, species diversity and abundance, community structure, seasonal pattern, ecological value and inter-dependence of the habitats and species, and presence of any features of ecological importance;
 - (d) representative colour photos of each habitat type and any important ecological features identified; and
 - (e) species found that are rare, endangered and/or listed under local legislation, international conventions for conservation of wildlife/habitats or red data books.
- (v) Investigation and description of the existing wildlife uses of the various habitats with special attention to those wildlife groups and habitats with conservation interests, including:
- (a) Natural and man-made wetland habitats including mudflat, mangrove, drainage channel, fishpond and others;
 - (b) migratory and overwintering waterbirds roosting and/or feeding in the wetland habitats above;
 - (c) breeding egrets and herons foraging in the wetland habitats above; and
 - (d) any other habitats or species identified as having special conservation interests by this study.
- (vi) Using suitable methodology and considering also other projects in the vicinity of the Project area reasonably likely to occur at the same time, identification and quantification as far as possible of any direct, indirect, on-site, off-site, primary, secondary and cumulative ecological impacts, reduction of species abundance/diversity, loss of feeding grounds, reduction of ecological carrying capacity, habitat fragmentation, and in particular the followings :
- (a) noise, glare and other human disturbance to wildlife in particular waterbirds and sensitive wetland habitats in the vicinity such as mudflats/mangroves along the embankments and at the confluence of Kam Tin River and Shan Pui River as well as fishpond/wetland habitats at Nam Sang Wai and WCA during construction and operation phases;
 - (b) indirect ecological impacts due to changes in the water quality,

hydrodynamics properties, sedimentation rates and pattern as well as hydrology as a result of surface run-off, discharge of treated effluent and any associated disinfection activities, temporary sewage overflow, accidental discharge of untreated sewage, etc. in the drainage channels, fishponds and other wetland habitats in the assessment area during construction and operation phases.

- (vii) Evaluation of ecological impact based on the best and latest information available during the course of the EIA study, using quantitative approach as far as practicable and covering construction and operation phases of the Project as well as the subsequent management and maintenance requirement of the Project;
- (viii) Recommendations for possible alternatives, such as locations and alignment of the Project and modification/change of construction methods and/or programme, and practicable mitigation measures to avoid, minimize and/or compensate for the adverse ecological impacts identified during construction and operation of the Project;
- (ix) Evaluation of the feasibility and effectiveness of the recommended mitigation measures and definition of the scope, type, location, implementation arrangement, resources requirement, subsequent management and maintenance of such measures;
- (x) Determination and quantification as far as possible of the residual ecological impacts after implementation of the proposed mitigation measures;
- (xi) Evaluation of the significance and acceptability of the residual ecological impacts by making reference to the criteria in Annex 8 of the TM; and
- (xii) Review of the need for and recommendation on any ecological monitoring programme required.

Appendix G**Requirements for Fisheries Impact Assessment**

1. The Applicant shall follow the criteria and guidelines for evaluating and assessing fisheries impact as stated in Annexes 9 and 17 of the Technical Memorandum under EIA Ordinance.
2. The assessment area shall include all areas within a distance of 500m from the site boundaries of the Project. This assessment area shall be extended to include other areas if they are also found being impacted by the construction or operation of the Project during the course of the EIA study. Special attention should be given to pond culture resources and activities as well as any water courses which serve as water sources for fish ponds.
3. Existing information regarding the assessment area shall be reviewed. Based on the review results, the assessment shall identify any data gap and determine if there is any need for field surveys to collect adequate baseline information. If field surveys are considered necessary, the assessment shall recommend appropriate methodology, duration and timing for such surveys.
4. The assessment shall cover any potential impact on culture fisheries during construction and operation of the Project.
5. The fisheries impact assessment shall include the following major tasks:
 - (i) description of the physical environmental background;
 - (ii) description and quantification of the existing culture fisheries activities;
 - (iii) description and quantification of the existing culture fisheries resources;
 - (iv) identification of parameters (e.g. water quality parameters) and areas of culture fisheries importance;
 - (v) prediction and evaluation of any direct/indirect and on-site/off-site impacts on culture fisheries such as permanent loss or temporary occupation of fish ponds, deterioration of water quality in fish ponds and any surrounding water courses, hydrological disruptions and draw-down of water table, disruption or disturbance of pond culture related activities;
 - (vi) evaluation of cumulative impacts on culture fisheries particularly aquaculture sites and aquaculture production in the North West New Territories;
 - (vii) proposal of practicable alternatives or mitigation measures with details on justification, description of scope and programme feasibility as well as staff and financial implications including those related to subsequent management and maintenance requirements of the measures; and
 - (viii) review for the need of monitoring during construction and operation phases of the Project and, if necessary, proposal of a monitoring and audit programme.

Appendix H**Requirements for Landscape and Visual Impact Assessments**

1. The Applicant shall review relevant plan(s) and/or studies which may identify areas of high landscape value and recommend country park, coastal protection area, green belt and conservation area designations. Any guidelines on landscape and urban design strategies and frameworks that may affect the appreciation of the Project shall also be reviewed. The aim is to gain an insight to the future outlook of the area affected so as to assess whether the Project can fit into the surrounding setting. Any conflict with the statutory town plan(s) and any published land use plans shall be highlighted and appropriate follow-up action shall be recommended.
2. The Applicant shall describe, appraise, analyse and evaluate the existing and planned landscape resources and character of the assessment area. A system shall be derived for judging landscape and visual impact significance. Annotated oblique aerial photographs and plans of suitable scale showing the baseline landscape character areas and landscape resources and mapping of impact assessment shall be extensively used to present the findings of impact assessment. Descriptive text shall provide a concise and reasoned judgment from a landscape and visual point of view. The sensitivity of the landscape framework and its ability to accommodate change shall be particularly focused on. The Applicant shall identify the degree of compatibility of the Project with the existing and planned landscape setting, recreation and tourism related uses, and scenic spot. The landscape impact assessment shall quantify the potential landscape impact as far as possible so as to illustrate the significance of such impacts arising from the proposed development. Clear mapping of the landscape impact is required. Tree survey shall be carried out and the impacts on existing trees shall be addressed. Cumulative landscape and visual impacts of the Project with other committed and planned developments shall be assessed.
3. The Applicant shall assess the visual impacts of the Project. Clear illustration including mapping of visual impact is required. The assessment shall include the following:
 - (i) identification and plotting of visual envelope of the Project;
 - (ii) identification of the key groups of existing and planned sensitive receivers within the visual envelope with regard to views from ground level, sea level and elevated vantage points;
 - (iii) description of the visual compatibility of the Project with the surrounding and the planned setting, and its obstruction and interference with the key views of the study areas;

- (iv) identification of the severity of visual impacts in terms of distance, nature and number of sensitive receivers. The visual impacts of the Project with and without mitigation measures shall be included so as to demonstrate the effectiveness of the proposed mitigation measures;
4. The Applicant shall evaluate the merits of preservation in totality, in parts or total destruction of existing landscape and the establishment of a new landscape character area. In addition, alternative location, layout, design, built-form and construction method that will avoid or reduce the identified landscape and visual impacts shall be evaluated for comparison before adopting other mitigation or compensatory measures to alleviate the impacts. The mitigation measures proposed shall not only be concerned with damage reduction but shall also include consideration of potential enhancement of existing landscape and visual quality. The Applicant shall recommend mitigation measures to minimize adverse effects identified above, including provision of a master landscape plan.
5. The mitigation measures shall also include the preservation of vegetation, transplanting trees in good condition and value, provision of screen planting, re-vegetation of disturbed lands, compensatory planting, woodland restoration, design of structure, provision of finishes to structure, colour scheme and texture of material used and any measures to mitigate the impact on the existing and planned land use and visually sensitive receivers. Parties shall be identified for the on going management and maintenance of the proposed mitigation works to ensure their effectiveness throughout the construction phase and operation phase of the Project, associated works, supporting facilities and essential infrastructures. A practical programme and funding proposal for the implementation of the recommendation measures shall be provided.
6. Annotated illustration materials such as colour perspective drawings, plans and section/elevation diagrams, annotated oblique aerial photographs, photographs taken at vantage points, and computer-generated photomontage shall be adopted to fully illustrate the landscape and visual impacts of the Project. In particular, the landscape and visual impacts of the Project with and without mitigation measures from representative viewpoints, particularly from views of the most severely affected visually sensitive receivers (i.e. worst case scenario), shall be properly illustrated in existing and planned setting at four stages (existing condition, Day 1 with no mitigation measures, Day 1 with mitigation measures and Year 10 with mitigation measures) by computer-generated photomontage so as to demonstrate the effectiveness of the proposed mitigation measures. Computer graphics shall be compatible with Microstation DGN file format. The Applicant shall record the technical details in preparing the illustration, which may need to be submitted for verification of the accuracy of the illustration.

Requirements for EIA Report Documents

1. The Applicant shall supply the Director with the following number of copies of the EIA report and the executive summary:
 - (i) 30 copies of the EIA report and 30 copies of the bilingual (in both English and Chinese) executive summary as required under section 6(2) of the EIAO to be supplied at the time of application for approval of the EIA report.
 - (ii) When necessary, addendum to the EIA report and the executive summary submitted in item (i) above as required under section 7(1) of the EIAO, to be supplied upon advice by the Director for public inspection.
 - (iii) 20 copies of the EIA report and 50 copies of the bilingual (in both English and Chinese) executive summary with or without Addendum as required under section 7(5) of the EIAO, to be supplied upon advice by the Director for consultation with the Advisory Council on the Environment.
2. To facilitate public inspection of EIA report via EIAO Internet Website, the Applicant shall provide electronic copies of both the EIA report and the executive summary prepared in HyperText Markup Language (HTML) (version 4.0 or later) and in Portable Document Format (PDF version 1.3 or later). For the HTML version, a content page capable of providing hyperlink to each section and sub-section of the EIA report and the executive summary shall be included in the beginning of the document. Hyperlinks to figures, drawings and tables in the EIA report and the executive summary shall be provided in the main text from where respective references are made. Graphics in the report shall be in interlaced GIF format.
3. The electronic copies of the EIA report and the executive summary shall be submitted to the Director at the time of application for approval of the EIA report.
4. When the EIA report and the executive summary are made available for public inspection under section 7(1) of the EIAO, the content of the electronic copies of the EIA report and the executive summary must be the same as the hard copies and the Director shall be provided with the most updated electronic copies.
5. To promote environmentally friendly and efficient dissemination of information, both hardcopies and electronic copies of future EM&A reports recommended by the EIA study shall be required.