

B (809800,826000)



500m Study Area

TAPs include Cl, HCl, F, P, Be, As, Mo, Sb, Pt, Se and Rh

TAP concentration = Emission Rate of the TAP (as stated in Section 3 of EIA) x Contour Value + Background (as stated in Section 3 of EIA)

A (809800,824600)



Scale: As shown

Figure B7-O1 Cumulative 4-hour TAPs Concentration ($\mu\text{g}/\text{m}^3$) (with Emission Rate of 1 g/s) at 8.5mPD emitted from Source Location A4 (Mitigated Scenario 2)

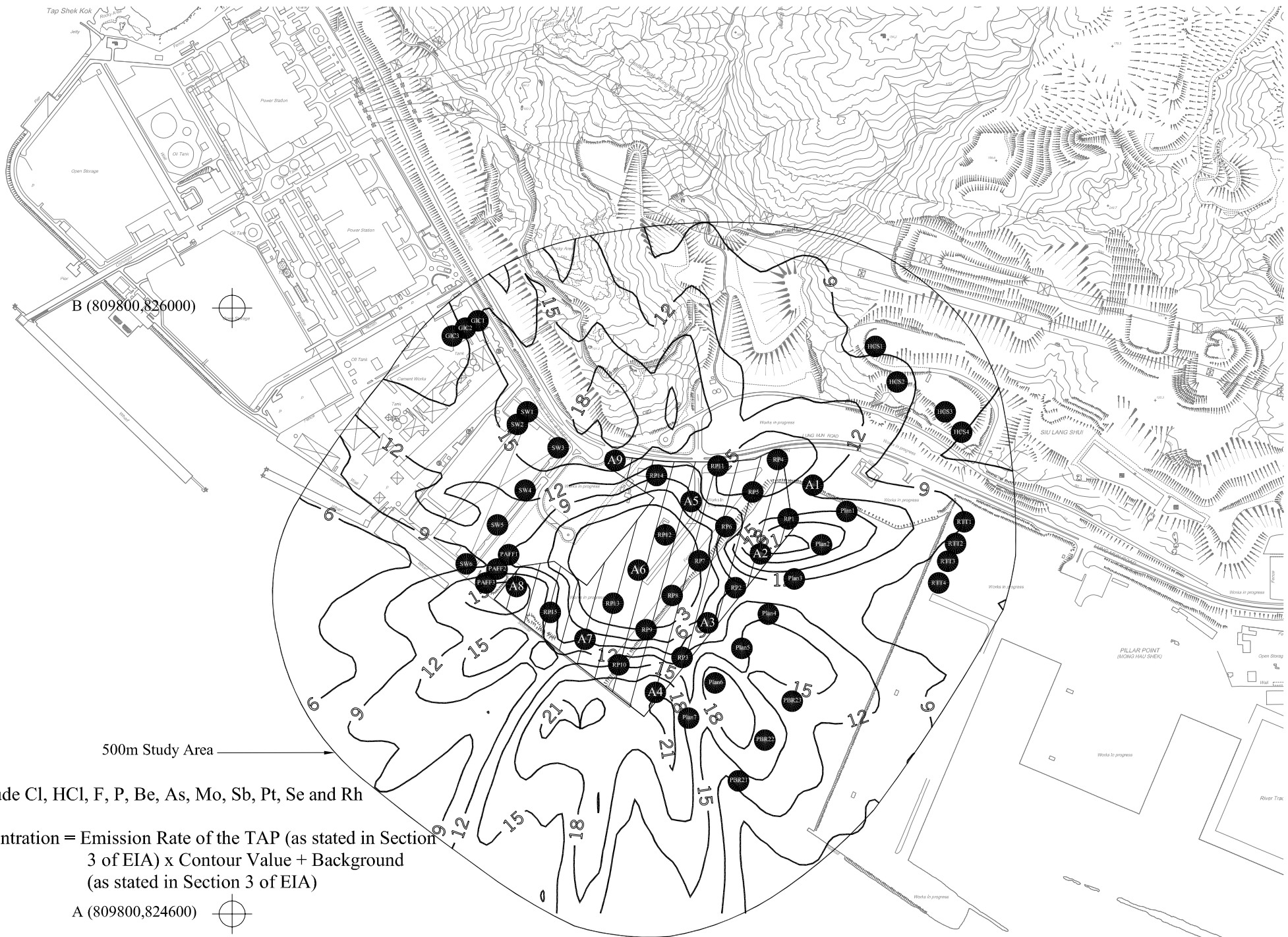

B (809800,826000)

500m Study Area

TAPs include Cl, HCl, F, P, Be, As, Mo, Sb, Pt, Se and Rh

TAP concentration = Emission Rate of the TAP (as stated in Section 3 of EIA) x Contour Value + Background (as stated in Section 3 of EIA)

A (809800,824600)

Scale: As shown

Figure B7-O2 Cumulative 4-hour TAPs Concentration ($\mu\text{g}/\text{m}^3$) (with Emission Rate of 1 g/s) at 8.5mPD emitted from Source Location A6 (Mitigated Scenario 2)

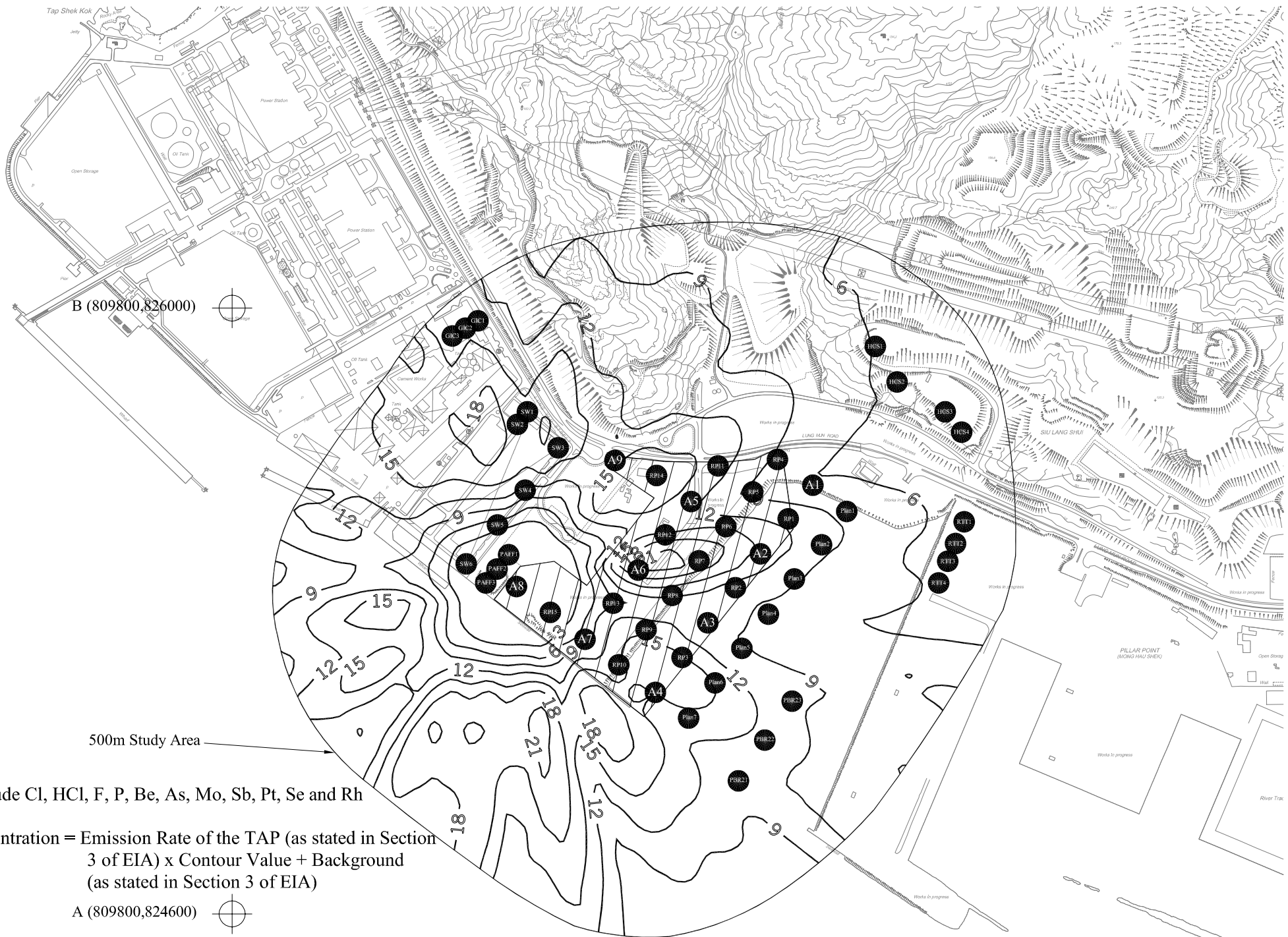

B (809800,826000)



500m Study Area

TAPs include Cl, HCl, F, P, Be, As, Mo, Sb, Pt, Se and Rh

TAP concentration = Emission Rate of the TAP (as stated in Section 3 of EIA) x Contour Value + Background (as stated in Section 3 of EIA)

A (809800,824600)



Scale: As shown

Figure B7-O3 Cumulative 4-hour TAPs Concentration ($\mu\text{g}/\text{m}^3$) (with Emission Rate of 1 g/s) at 8.5mPD emitted from Source Location A8 (Mitigated Scenario 2)

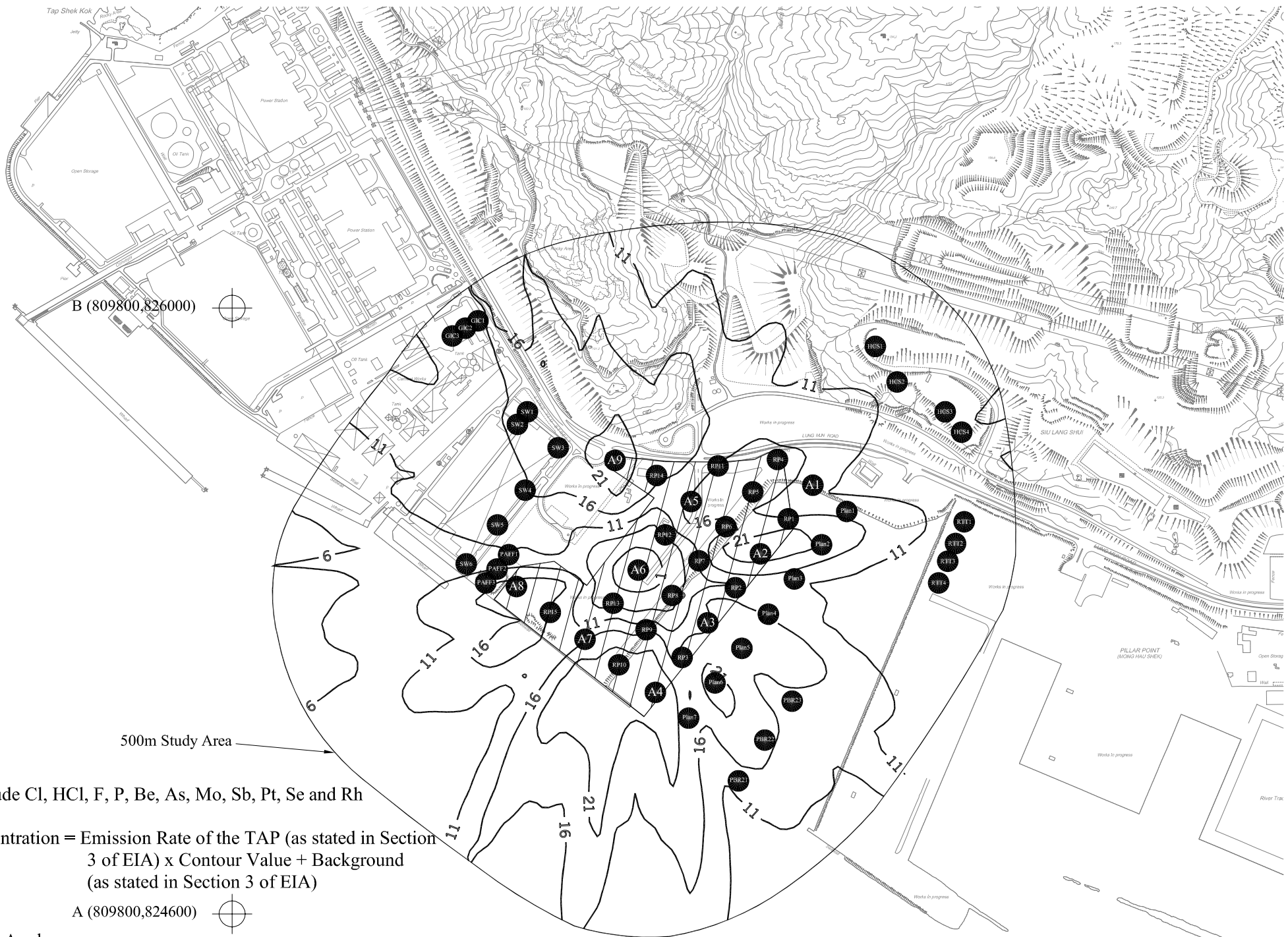

B (809800,826000)



500m Study Area

TAPs include Cl, HCl, F, P, Be, As, Mo, Sb, Pt, Se and Rh

TAP concentration = Emission Rate of the TAP (as stated in Section 3 of EIA) x Contour Value + Background (as stated in Section 3 of EIA)

A (809800,824600)



Scale: As shown

Figure 7-O4 Cumulative 4 Hour TAPs Concentration ($\mu\text{g}/\text{m}^3$) at 22.5mPD emitted from Source Location A6 (Mitigated Scenario 2)

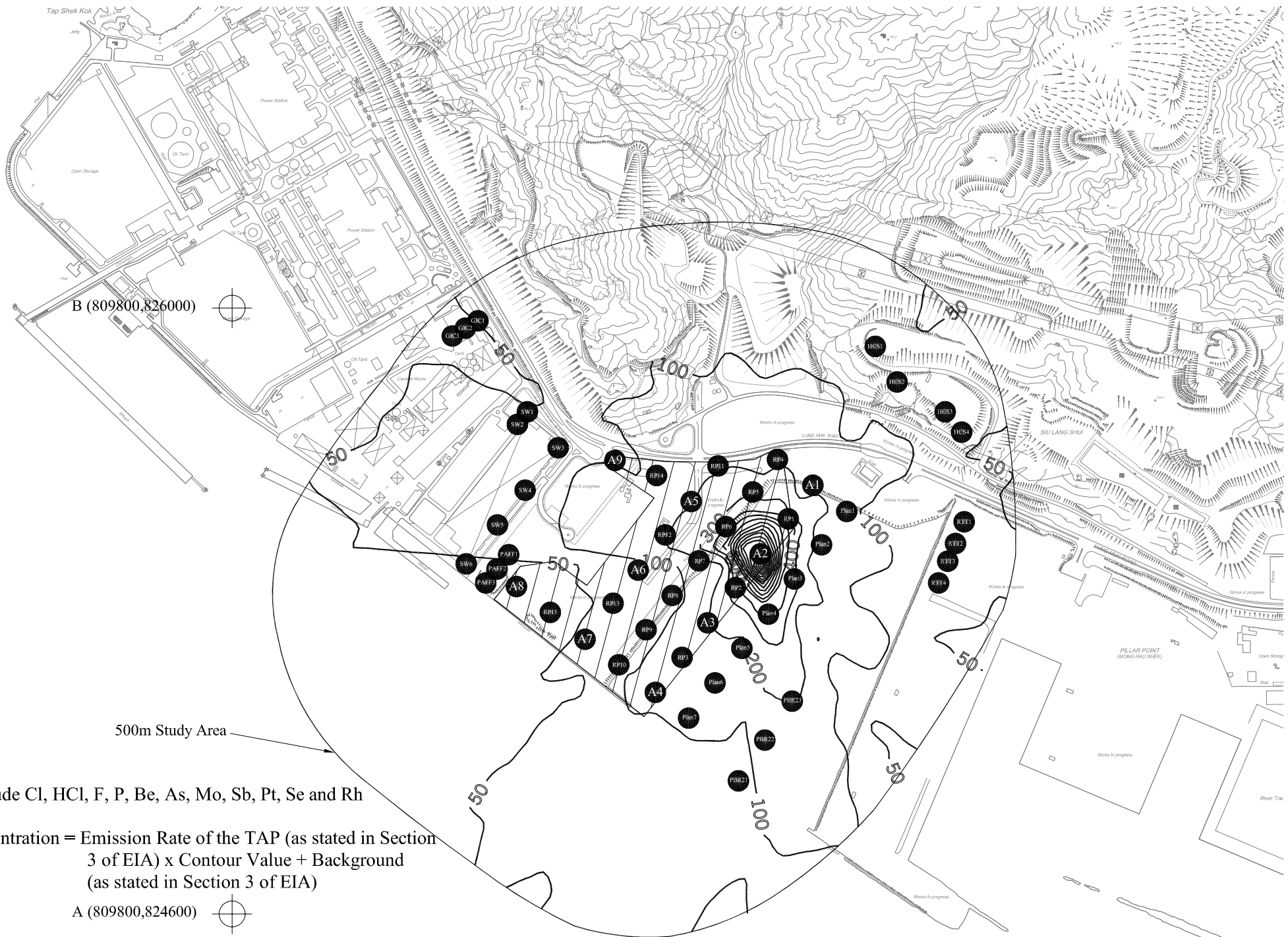

B (809800,826000)



500m Study Area

TAPs include Cl, HCl, F, P, Be, As, Mo, Sb, Pt, Se and Rh

TAP concentration = Emission Rate of the TAP (as stated in Section 3 of EIA) x Contour Value + Background (as stated in Section 3 of EIA)

A (809800,824600)



Scale: As shown

Figure B7-O5 Cumulative 4-hour TAPs Concentration ($\mu\text{g}/\text{m}^3$) (with Emission Rate of 1 g/s) at 61.5mPD emitted from Source Location A2 (Mitigated Scenario 2)

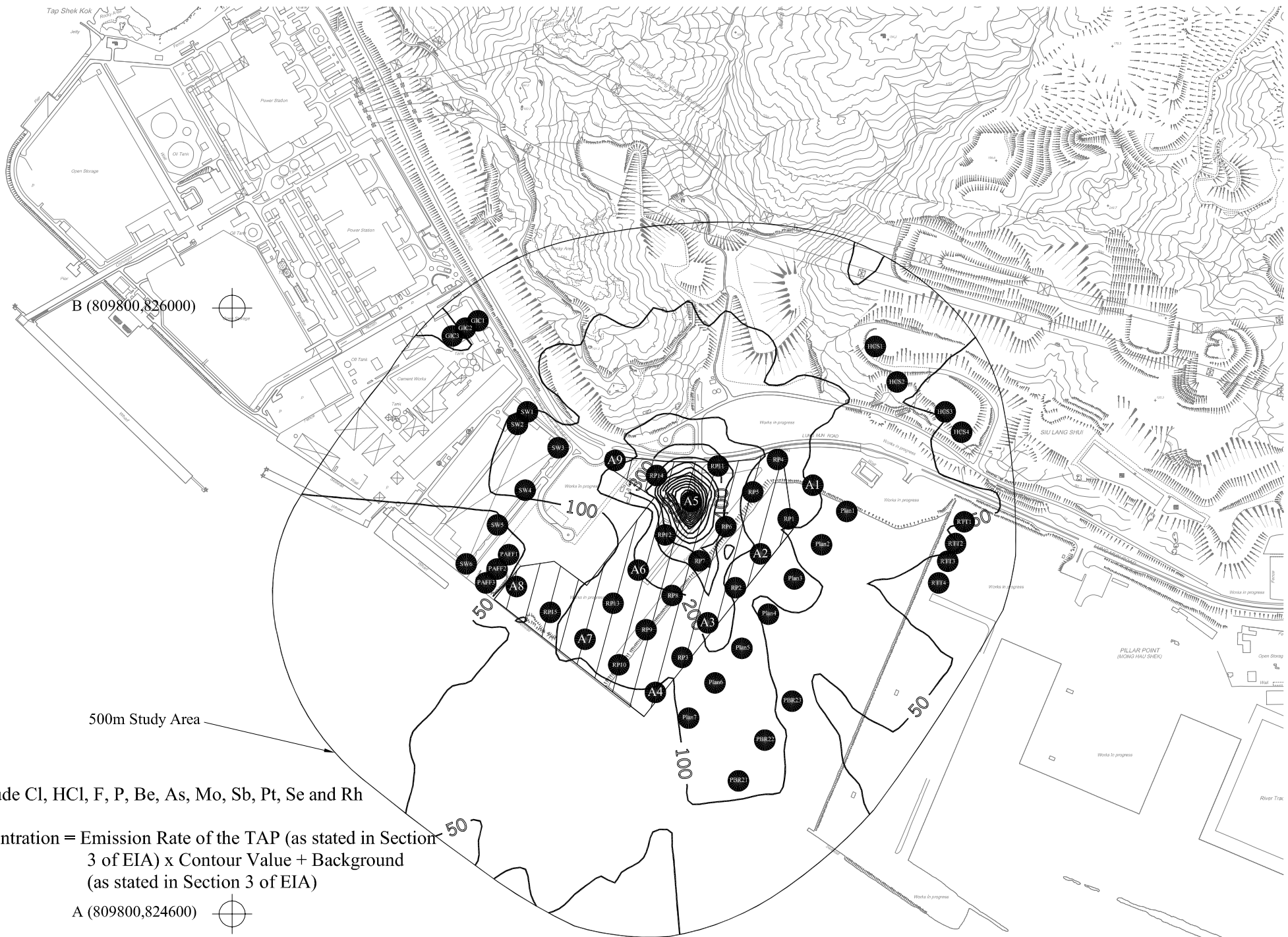

B (809800,826000)



500m Study Area

TAPs include Cl, HCl, F, P, Be, As, Mo, Sb, Pt, Se and Rh

TAP concentration = Emission Rate of the TAP (as stated in Section 3 of EIA) x Contour Value + Background (as stated in Section 3 of EIA)

A (809800,824600)



Scale: As shown

Figure B7-O6 Cumulative 4-hour TAPs Concentration ($\mu\text{g}/\text{m}^3$) (with Emission Rate of 1 g/s) at 61.5mPD emitted from Source Location A5 (Mitigated Scenario 2)