

Company Information of Hong Kong Green Printed Circuit Board Company (HKGPCB)

| | |
|--|--|
| Company Name | Hong Kong Green Printed Circuit Board Company (HKGPCB) |
| Business Nature | Manufacture of multi-layer printed circuit boards (PCB) |
| Products | PCB for computers, telecom equipment, automotive and industrial control |
| Major Markets / Clients | China, Asia, Europe, USA |
| Manufacturing Processes | First Cut / Board Cut → Inner Dry Film & Etching → Black Oxide → Pre-lay / Lay Up → Pressing → Second cut → tooling hole drilling, drilling and laser drilling → Deburr → Desmear → Vertical PTH and Panel plating → Pattern plating → Outerlayer etching and tin stripping → Soldermask → Surface finishing hot air levelling → Surface Finishing -- Electroless Nickel Immersion Gold → Surface Finishing -- Gold Finger Plating / Bondable Gold Plating → Component mark → ENTEK (organic coating on copper surface) → Routing → Ultrasonic Cleaning → packing → delivery |
| Address Office and Plant Locations | 2/F, 3/F., 50 Dai Wang Street, Tai Po Industrial Estate, Tai Po, New Territories, Hong Kong |
| Factory Areas | 2,000 m ² |
| No. of employees | 60 |
| Main facilities / equipment | <ol style="list-style-type: none"> 1. PCB plating and etching line 2. Board cutting machine 3. Drilling machine 4. Dry room for film developing 5. Boiler 6. Water cooling system 7. D.I. water generating system 8. Wastewater treatment plant 9. Air extraction and pollution control system 10. Air compressors 11. Warehouse 12. Laboratory |
| Surrounding Environment | 2 nd and 3 rd floors in a multi-storey industrial building located at Tai Po Industrial Estate. Neighbouring factories are metal moulding factory and concrete batching plant. |
| Potential Environmental Impacts from the Operations | <ul style="list-style-type: none"> • Wastewater discharge from etching, electroplating, cleaning, film developing and rinsing processes. Wastewater is discharged to public sewers of Tolo Water Control Zone. • Solid wastes include general refuse, papers, packaging bags, metal wastes, spent laminate sheets and rejected products, etc. • Chemical wastes from spent plating baths, dry film residues, sludge, spent lubricant oil and chemical containers. • Acid / alkaline / metal mists from chemical processing baths, VOC emission from use of solder mask, solvent and chemicals, etc. • Noise from board cutting and drilling processes, water pumps, air compressors, etc. • Significant use of electricity, water and chemical for production processes. |
| Special Client's Environmental Requirements | Nil |

Disclaimer : The information provided in this practical example is purely hypothetical and intended to illustrate the development and implementation of ISO 14001 EMS. Users will need to ensure that the information they insert is appropriate for their own situation.

Layout Plan – 2/F

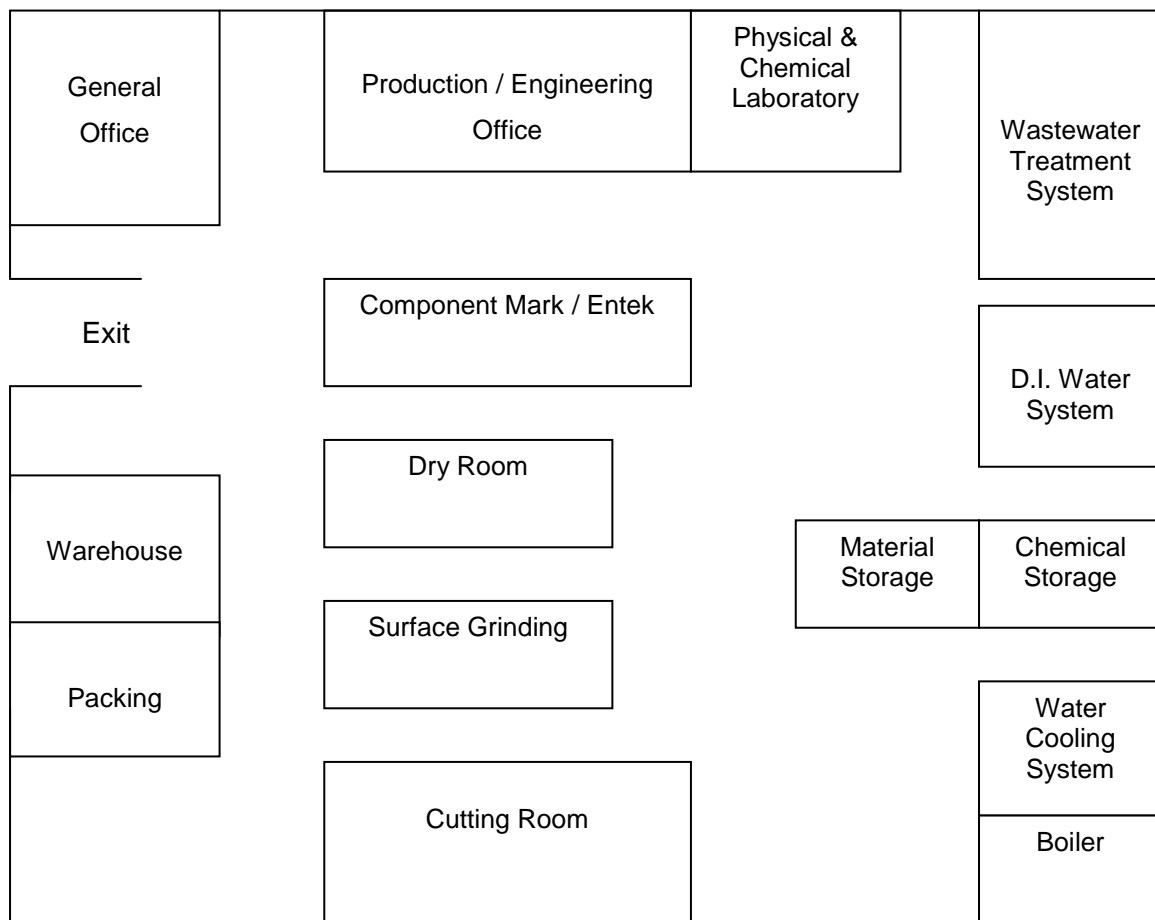

Layout plan – 3/F

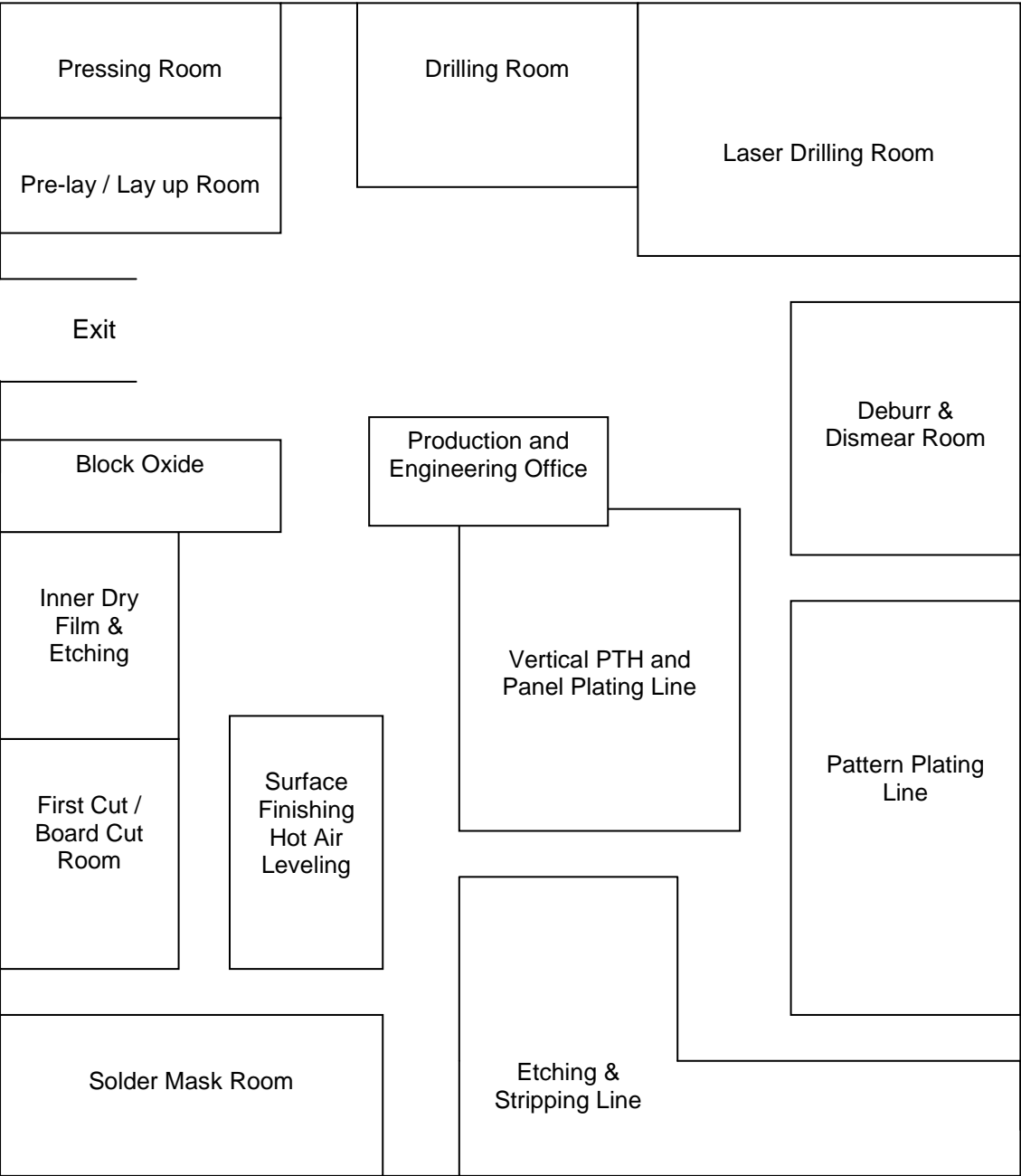

Process flow

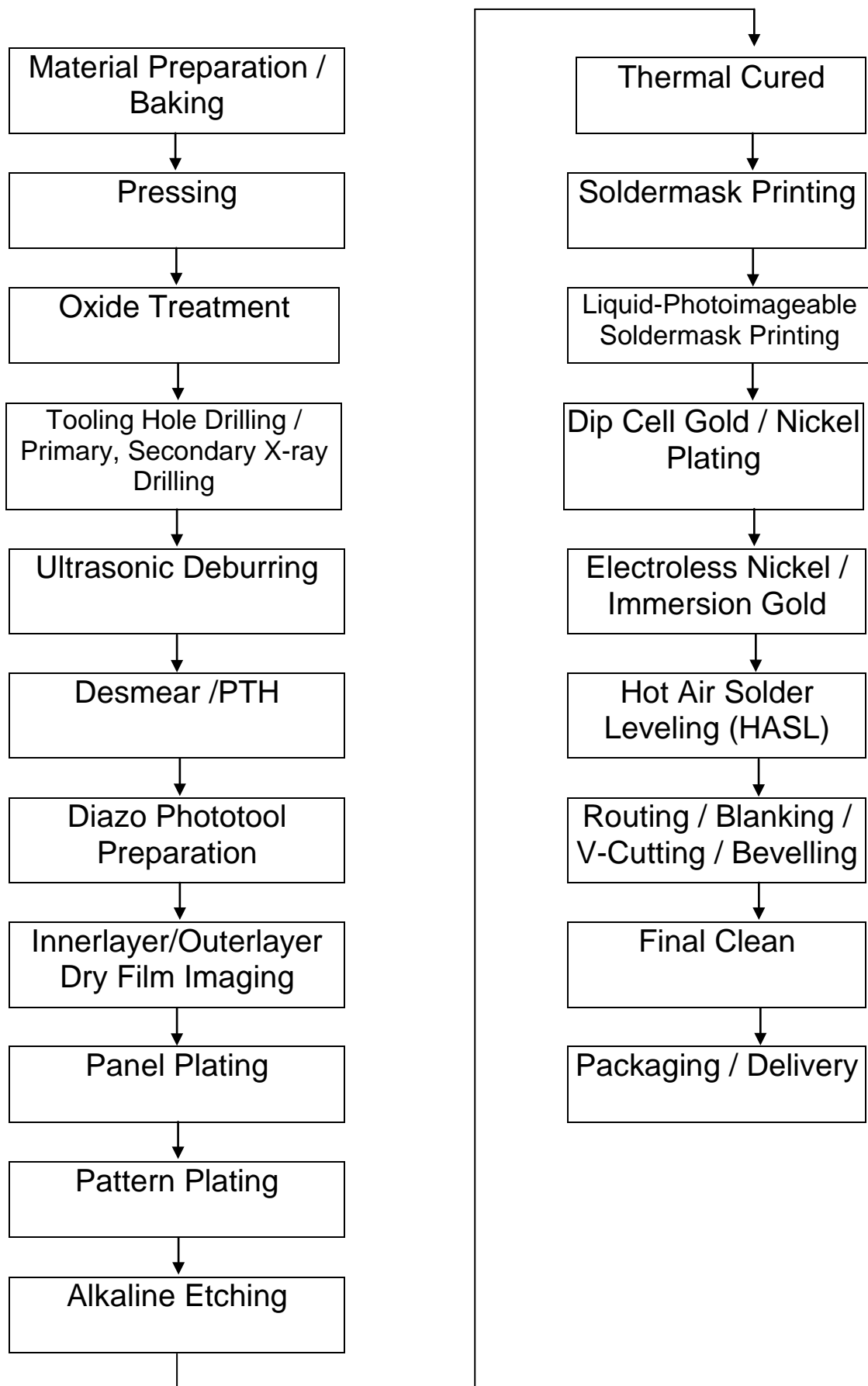

Location Map

2/F, 3/F., 50 Dai Wang Street, Tai Po Industrial Estate, Tai Po, New Territories, Hong Kong

