

**Company Information of Hong Kong Green Electronics Assembly Company (HKGEAC)**

<b>Company Name</b>	Hong Kong Green Electronics Assembly Company (HKGEAC)
<b>Business Nature</b>	Electronic assembly process
<b>Products</b>	Manufacture of electronic calculators
<b>Major Markets / Clients</b>	Good Electric Group (Japan)
<b>Manufacturing Processes</b>	Incoming materials preparation → PCB assembly → Soldering → In-circuit testing → Final Assembly → Functional Testing → Packaging → Delivery
<b>Address Office and Plant Locations</b>	Block A, 5/F, Yip Fat Factory Building, Hoi Yuen Rd Kwun Tong, Kowloon, Hong Kong
<b>Factory Areas</b>	600m <sup>2</sup>
<b>No. of employees</b>	60
<b>Main facilities / equipment</b>	Assembly line with conveyor belt Soldering tools Testing equipments Air compressor Warehouse
<b>Surrounding Environment</b>	Located in a multi-storey industrial building in Kwun Tong. Neighbour factories are trading companies and a textile company.  <b>(see site layout attached)</b>
<b>Potential Environmental Impacts from the Operations</b>	<ul style="list-style-type: none"> <li>• Wastewater discharge from air scrubber and rinsing processes. Wastewater is discharged to public sewers of Victoria Harbour (Phase One) Water Control Zone.</li> <li>• Solid wastes include general refuse, paper waste from office, packaging wastes, spent parts and rejected products (metal).</li> <li>• Chemical wastes from lubricant and chemical containers.</li> <li>• Air emission from soldering and printing processes</li> <li>• Noise from riveting, cutting, air compressors, and loading test, etc.</li> <li>• Significant use of electricity for production processes</li> </ul>
<b>Special Client's Environmental Requirements</b>	Good Electric Group (Japan) <ul style="list-style-type: none"> <li>– ISO 14001 certification required</li> <li>– disclosure of information on hazardous chemical substances</li> <li>– enables reuse, recycling and energy efficiency,</li> <li>– that contain no prohibited substances,</li> <li>– contain reduced amount of chemical substances,</li> </ul>

	<ul style="list-style-type: none"> <li>– with packaging material designed for resource conservation and with less hazardous substances</li> </ul>
<b>Relevant Legislation Related to Client's Environmental Requirements</b>	<ul style="list-style-type: none"> <li>• Revised Recycling Law (Formally known as the Law for Promotion of Effective Utilization of Resources)</li> <li>• Containers and Packaging Recycling Law (Formally known as Law for Promotion of Sorted Collection and Recycling of Containers and Packaging)</li> </ul>

*Disclaimer : The information provided in this practical example is purely hypothetical and intended to illustrate the development and implementation of ISO 14001 EMS. Users will need to ensure that the information they insert is appropriate for their own situation.*

# Factory Layout Plan

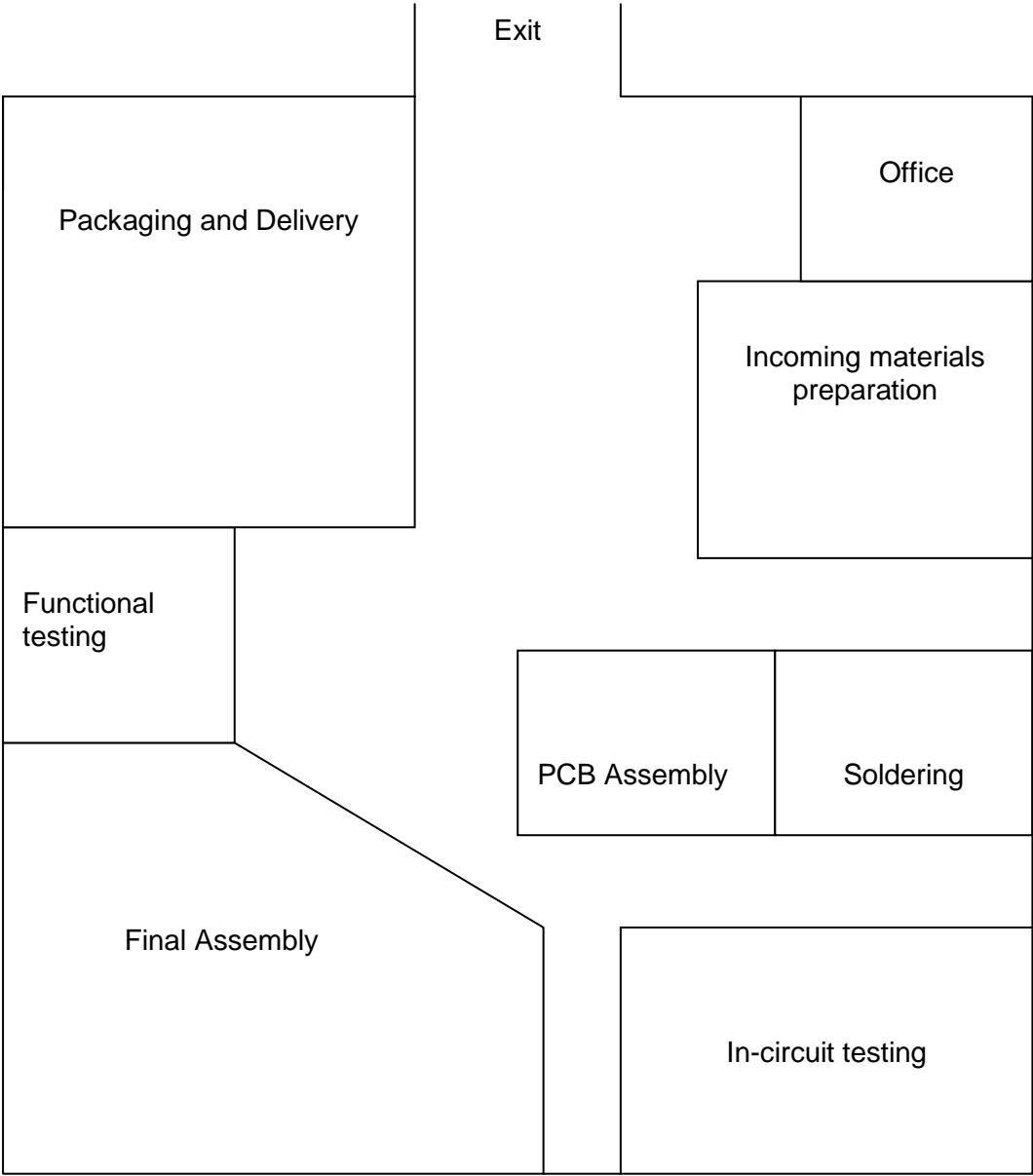

## Process flow

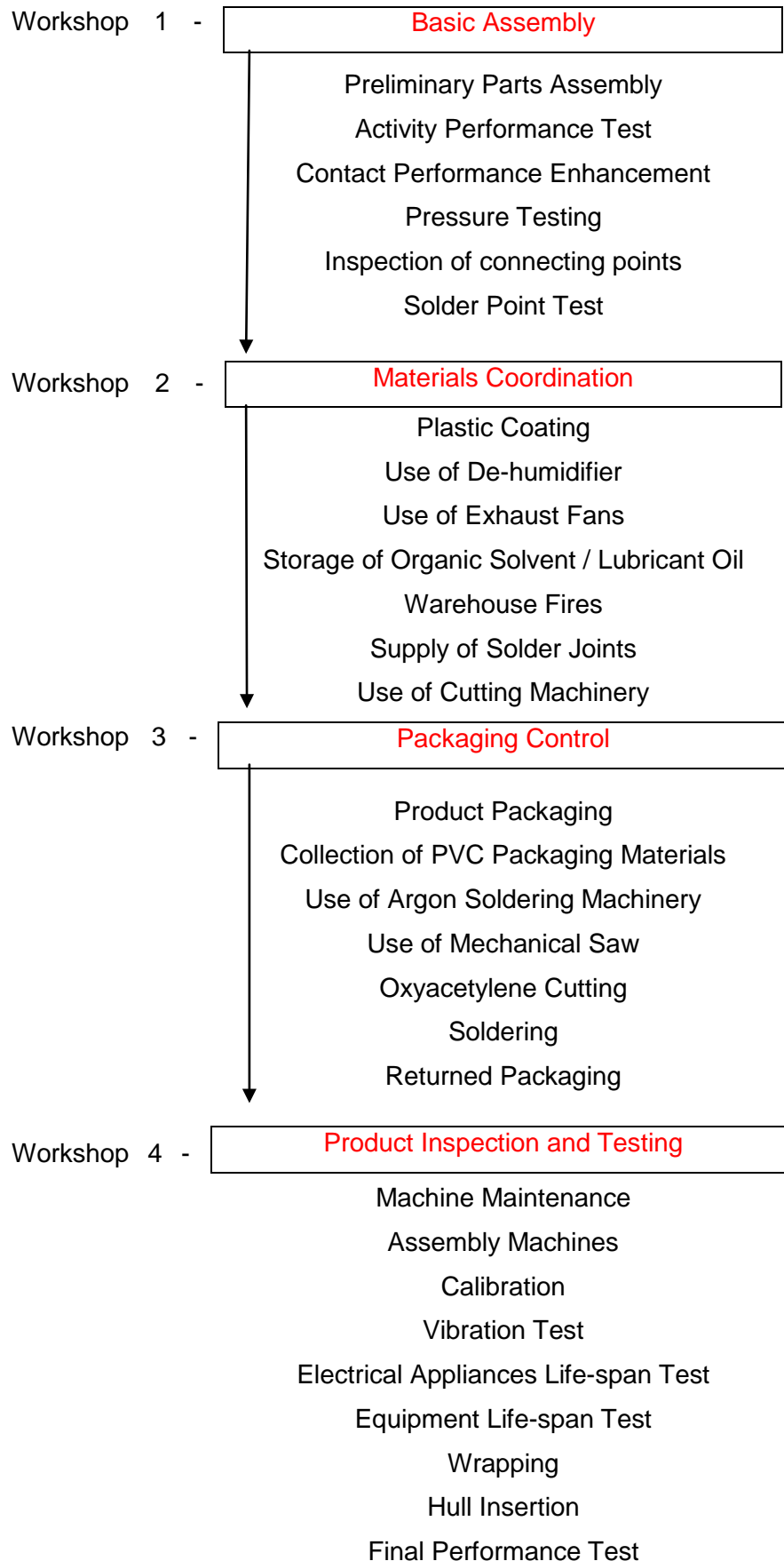

## Location of Hong Kong Green Electronics Assembly Company (HKGEAC)



Location of Hong Kong Green Electronics Assembly Company (HKGEAC):

Block A, 5/F, Yip Fat Factory Building, Hoi Yuen Rd  
Kwun Tong, Kowloon