

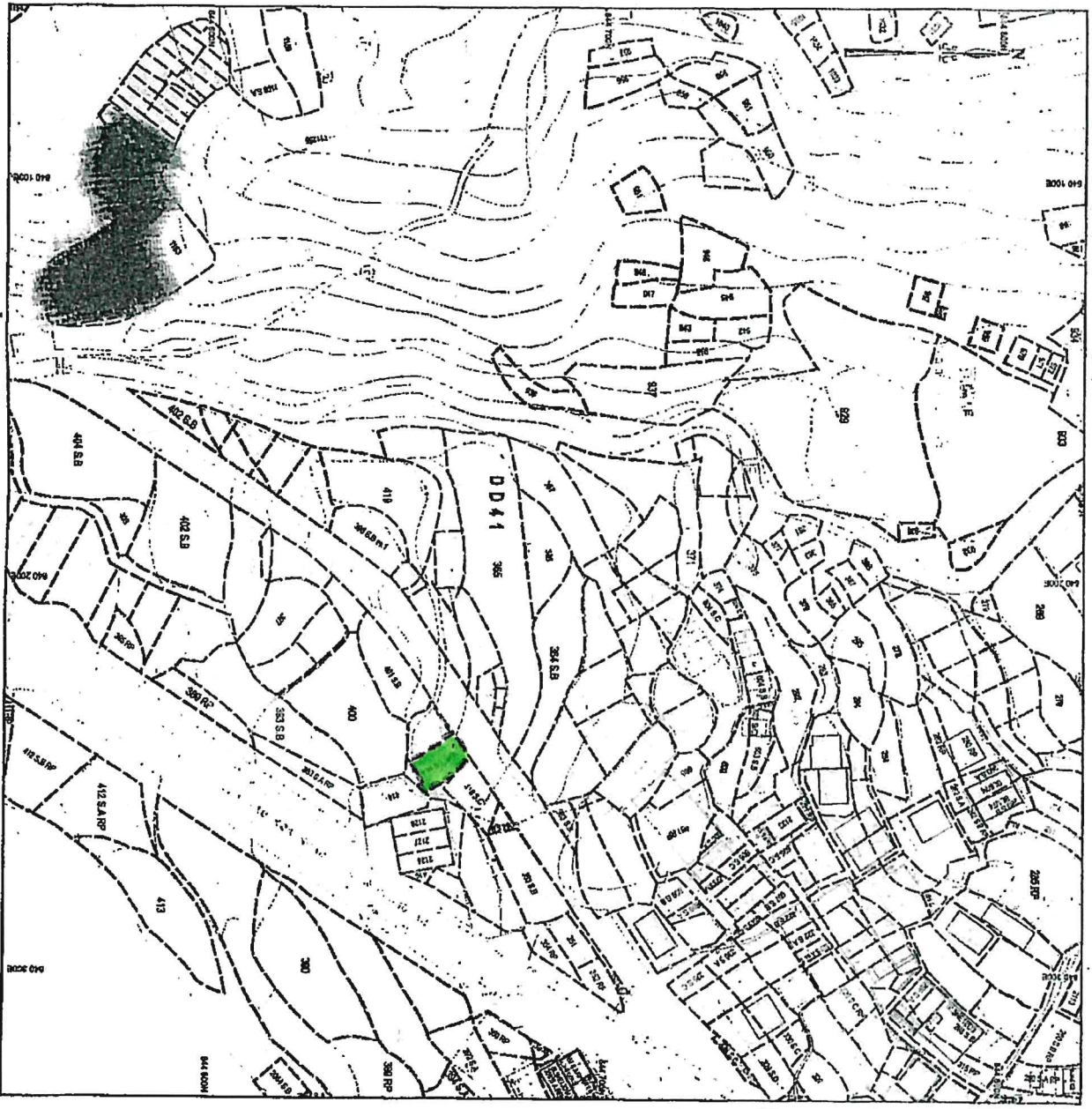

SD/CP/02
2020/09/11/0202 10



地段索引圖
LOT INDEX PLAN

— Boundary of Lot 417SB ss4

 Deposition Area (埋填範圍)

圖則說明：本圖則索引圖是在現有地籍圖上顯示了管理永久用途地段的
所有界址，包括土地所有權人、地役權、地役權的期限，以及不
本用途的土地。圖則索引圖上顯示的界址不應被視為不準確或
(2) 索引圖的更新應根據地籍圖的更新進行；(3) 索引圖中顯示
以作代辦之用，資料應在更新前，應由地籍圖中顯示的界址
負責證明；(4) 索引圖不準確時，應由地籍圖中顯示的界址
與地籍圖中顯示的界址一致，以作或不準確在何處負責。
Explanatory notes: This plan shows the graphical boundaries of different
permanent and temporary land holdings with the topographic map in the
The land holdings as shown may include private lots, government land and
short term leases and other permitted uses of land. It must be noted that
information shown on this plan is subject to updates without prior notice. It
may be time lag between an update and the related changes takes place; and
of their accuracy and reliability requires the advice from professional land
Disclaimers: The Government shall not be responsible for any loss or da
compensation arising from the use of this plan or in reliance upon its con
completeness, timeliness or accuracy.



地政總署測繪處
Survey and Mapping Office
Lands Department

香港特別行政區政府 版權所有
© Copyright reserved — Hong Kong SAR Government



Locality :
Lot Index Plan No. : sgs_S00000054668_0001
District Survey Office : Lands Information Center
Date : 11-Sep-2020
Reference No. : s41s20