

地段索引圖 LOT INDEX PLAN

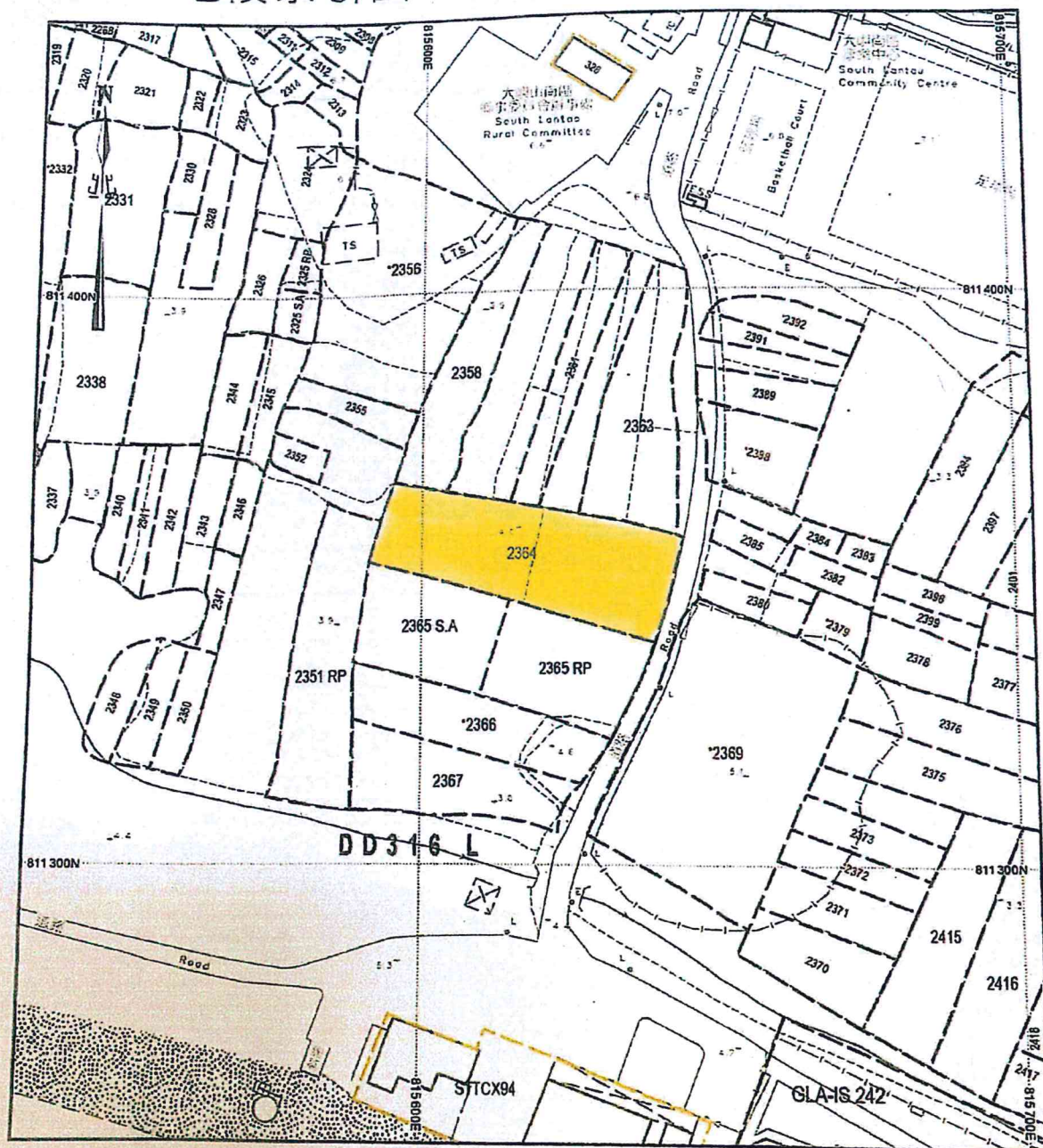

地政總署測繪處 Survey and Mapping Office, Lands Department

COPY

比例尺 SCALE 1:1 000

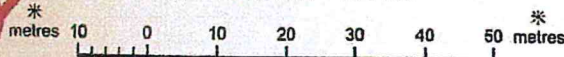

Locality: DD316 L

Lot Index Plan No.: TM0067112017

District Survey Office: Tuen Mun

Date: 20-Nov-2017

Reference No.: 14-NW-1A, 14-NW-1C

香港特別行政區政府 一 版權所有

© Copyright reserved - Hong Kong SAR Government

SMO-P01

20171120100927 10

免責聲明

本圖則乃地段索引圖的複本，顯示地段界線的大概位置，包括根據政府撥地、臨時政府撥地、短期租約及政府土地租用牌照而臨時佔用土地的位置。臨時佔用土地的情況可憑藉短期通知出現或終止，因此意向有關的分區地政專員核實。本圖則所示的資料必須透過實地測量予以核實；若有更佳或新的地界證據時，地段索引圖可能會被修訂而無須事先通知。

Disclaimer

This plan is a copy of the lot index plan showing the approximate location of lot boundaries, including the temporary occupation of land under Government Land Allocations, Temporary Government Land Allocations, Short Term Tenancies and Government Land Licences. The temporary occupation of land may be created or terminated at short notice and should be confirmed with the District Lands Officer. The information shown on this plan **MUST** be verified by field survey. The lot index plan may be revised without prior notification as better or new boundary evidence becomes available.